

ADVANTAGE ELEVATIONS

OIL FIELD SURVEYORS

BOX 8604 - PRATT, KS 67124
(620) 672-6491

422193

INVOICE NO.

LOTUS OPERATING CO LLC

OPERATOR

1

NO.

PERKINS

FARM

PRATT

COUNTY

13

S

29s

T

15w

R

330' FSL & 1320' FWL of Sec.

LOCATION

ELEVATION: 1998' GR

2000' Topo

LOTUS OPERATING CO LLC
100 S Main St. Ste 420
Wichita, KS 67202



AUTHORIZED BY: Tim Hellman

SCALE: 1" = 1000'

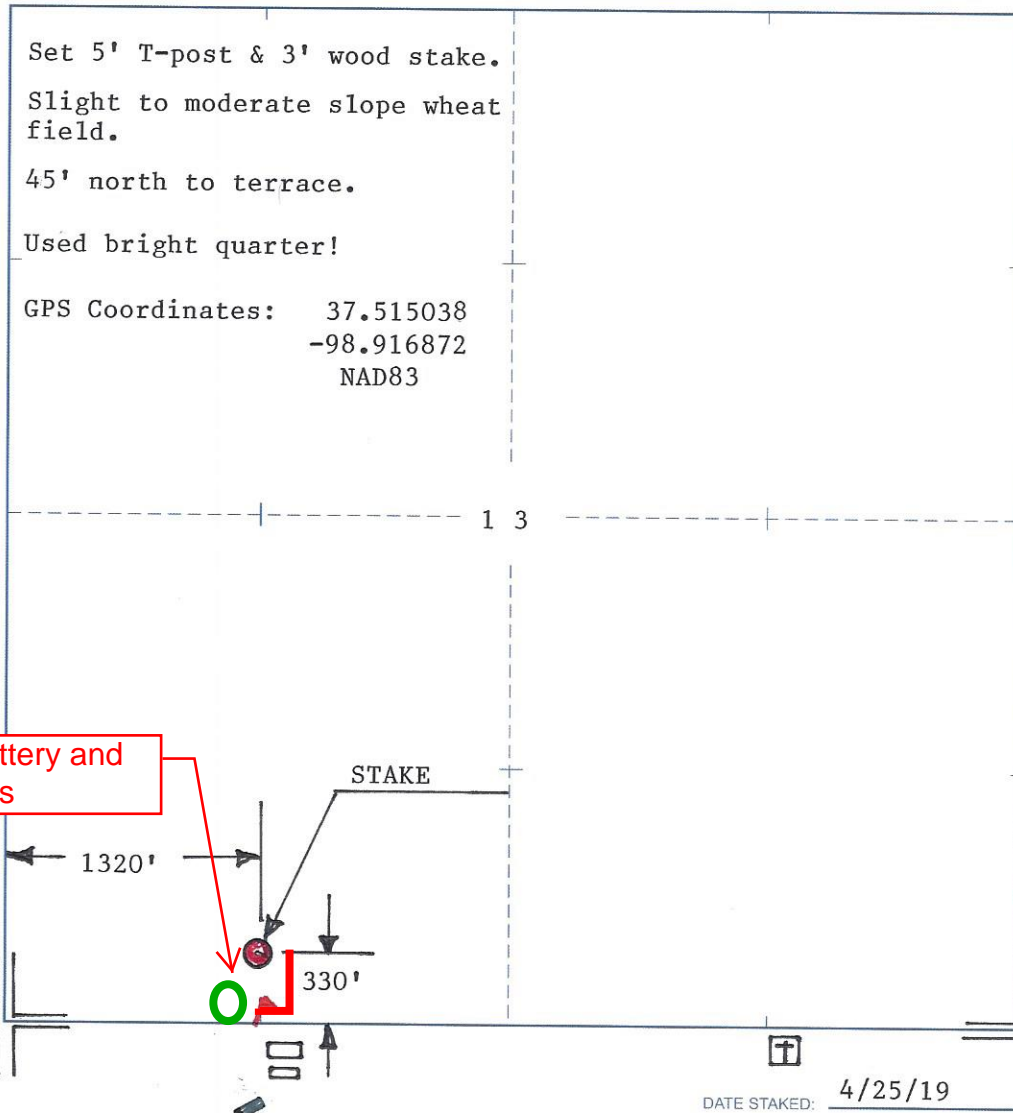

Tank Battery and lead lines

C/L

2016.5
GR EL

DATE STAKED: 4/25/19

4 mi. east to
Coats, KS

LOTUS OPERATING

PERKINS #1
330' FSL & 1320' FWL OF SEC.
PRATT CO, KS
GPS DATUM: NAD83

Legend

 37.515036 -98.916872

SW 100th Ave

 37.515036 -98.916872

SW 90th St