

For KCC Use:

Effective Date: _____

District # _____

SGA? Yes No

KANSAS CORPORATION COMMISSION
OIL & GAS CONSERVATION DIVISION

Form C-1

March 2010

Form must be Typed
Form must be Signed
All blanks must be Filled

NOTICE OF INTENT TO DRILL

Must be approved by KCC five (5) days prior to commencing well

Form KSONA-1, Certification of Compliance with the Kansas Surface Owner Notification Act, MUST be submitted with this form.

Expected Spud Date: _____
month day year

OPERATOR: License# _____

Name: _____

Address 1: _____

Address 2: _____

City: _____ State: _____ Zip: _____ + _____

Contact Person: _____

Phone: _____

CONTRACTOR: License# _____

Name: _____

Well Drilled For:

Well Class:

Type Equipment:

- | | | | |
|---|-----------------------------------|------------------------------------|-------------------------------------|
| <input type="checkbox"/> Oil | <input type="checkbox"/> Enh Rec | <input type="checkbox"/> Infield | <input type="checkbox"/> Mud Rotary |
| <input type="checkbox"/> Gas | <input type="checkbox"/> Storage | <input type="checkbox"/> Pool Ext. | <input type="checkbox"/> Air Rotary |
| | <input type="checkbox"/> Disposal | <input type="checkbox"/> Wildcat | <input type="checkbox"/> Cable |
| <input type="checkbox"/> Seismic ; _____ # of Holes | <input type="checkbox"/> Other | | |
| <input type="checkbox"/> Other: _____ | | | |

If OWWO: old well information as follows:

Operator: _____

Well Name: _____

Original Completion Date: _____ Original Total Depth: _____

Directional, Deviated or Horizontal wellbore? Yes No

If Yes, true vertical depth: _____

Bottom Hole Location: _____

KCC DKT #: _____

Spot Description: _____

_____ - _____ - _____ Sec. _____ Twp. _____ S. R. _____ E W
(Q/Q/Q/Q) _____ feet from N / S Line of Section

_____ feet from E / W Line of Section

Is SECTION: Regular Irregular?

(Note: Locate well on the Section Plat on reverse side)

County: _____

Lease Name: _____ Well #: _____

Field Name: _____

Is this a Prorated / Spaced Field? Yes No

Target Formation(s): _____

Nearest Lease or unit boundary line (in footage): _____

Ground Surface Elevation: _____ feet MSL

Water well within one-quarter mile: Yes No

Public water supply well within one mile: Yes No

Depth to bottom of fresh water: _____

Depth to bottom of usable water: _____

Surface Pipe by Alternate: I II

Length of Surface Pipe Planned to be set: _____

Length of Conductor Pipe (if any): _____

Projected Total Depth: _____

Formation at Total Depth: _____

Water Source for Drilling Operations:

Well Farm Pond Other: _____

DWR Permit #: _____

(Note: Apply for Permit with DWR)

Will Cores be taken? Yes No

If Yes, proposed zone: _____

AFFIDAVIT

The undersigned hereby affirms that the drilling, completion and eventual plugging of this well will comply with K.S.A. 55 et. seq.

It is agreed that the following minimum requirements will be met:

1. Notify the appropriate district office **prior** to spudding of well;
2. A copy of the approved notice of intent to drill **shall be** posted on each drilling rig;
3. The minimum amount of surface pipe as specified below **shall be set** by circulating cement to the top; in all cases surface pipe **shall be set** through all unconsolidated materials plus a minimum of 20 feet into the underlying formation.
4. If the well is dry hole, an agreement between the operator and the district office on plug length and placement is necessary **prior to plugging**;
5. The appropriate district office will be notified before well is either plugged or production casing is cemented in;
6. If an ALTERNATE II COMPLETION, production pipe shall be cemented from below any usable water to surface within **120 DAYS** of spud date. Or pursuant to Appendix "B" - Eastern Kansas surface casing order #133,891-C, which applies to the KCC District 3 area, alternate II cementing must be completed within 30 days of the spud date or the well shall be plugged. **In all cases, NOTIFY district office** prior to any cementing.

Submitted Electronically

For KCC Use ONLY

API # 15 - _____

Conductor pipe required _____ feet

Minimum surface pipe required _____ feet per ALT. I II

Approved by: _____

This authorization expires: _____
(This authorization void if drilling not started within 12 months of approval date.)

Spud date: _____ Agent: _____

Remember to:

- File Certification of Compliance with the Kansas Surface Owner Notification Act (KSONA-1) with Intent to Drill;
- File Drill Pit Application (form CDP-1) with Intent to Drill;
- File Completion Form ACO-1 within 120 days of spud date;
- File acreage attribution plat according to field proration orders;
- Notify appropriate district office 48 hours prior to workover or re-entry;
- Submit plugging report (CP-4) after plugging is completed (within 60 days);
- Obtain written approval before disposing or injecting salt water.
- If well will not be drilled or permit has expired (See: authorized expiration date) please check the box below and return to the address below.

Well will not be drilled or Permit Expired Date: _____

Signature of Operator or Agent: _____

E
 W

For KCC Use ONLY

API # 15 - _____

IN ALL CASES PLOT THE INTENDED WELL ON THE PLAT BELOW

In all cases, please fully complete this side of the form. Include items 1 through 5 at the bottom of this page.

Operator: _____

Lease: _____

Well Number: _____

Field: _____

Number of Acres attributable to well: _____

QTR/QTR/QTR/QTR of acreage: _____ - _____ - _____ - _____

Location of Well: County: _____

_____ feet from N / S Line of Section

_____ feet from E / W Line of Section

Sec. _____ Twp. _____ S. R. _____ E W

Is Section: Regular or Irregular

If Section is Irregular, locate well from nearest corner boundary.

Section corner used: NE NW SE SW

PLAT

Show location of the well. Show footage to the nearest lease or unit boundary line. Show the predicted locations of lease roads, tank batteries, pipelines and electrical lines, as required by the Kansas Surface Owner Notice Act (House Bill 2032). You may attach a separate plat if desired.

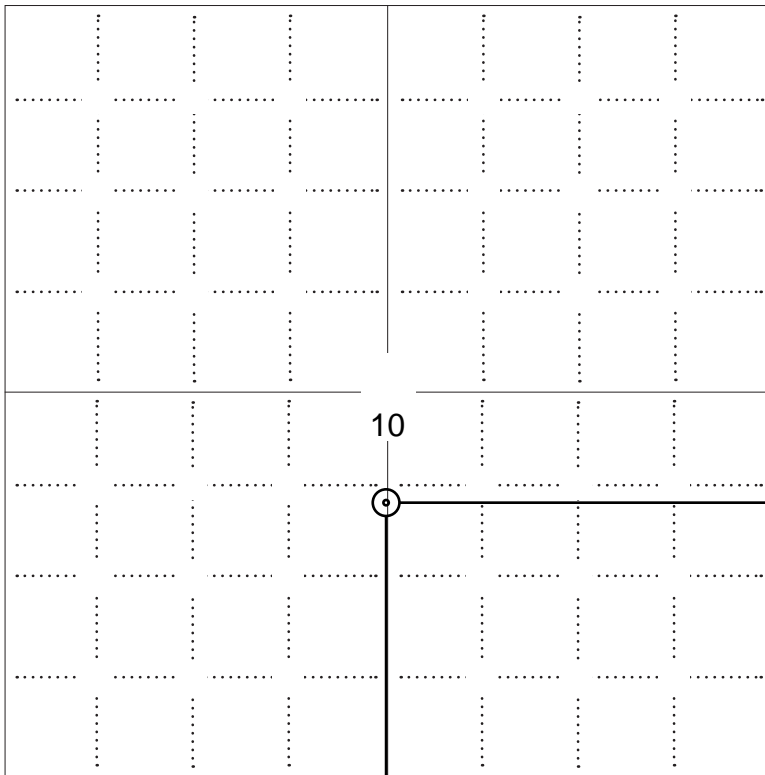

LEGEND

- Well Location
- Tank Battery Location
- Pipeline Location
- Electric Line Location
- Lease Road Location

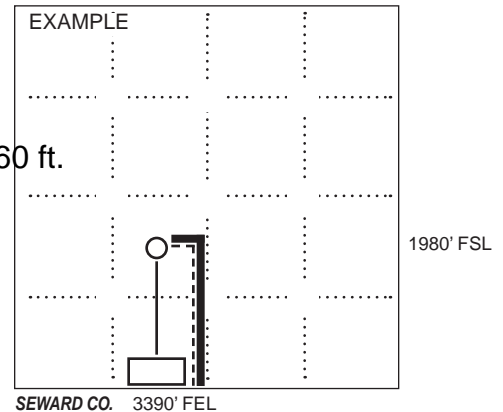

NOTE: In all cases locate the spot of the proposed drilling location.

1880 ft.

In plotting the proposed location of the well, you must show:

1. The manner in which you are using the depicted plat by identifying section lines, i.e. 1 section, 1 section with 8 surrounding sections, 4 sections, etc.
2. The distance of the proposed drilling location from the south / north and east / west outside section lines.
3. The distance to the nearest lease or unit boundary line (in footage).
4. If proposed location is located within a prorated or spaced field a certificate of acreage attribution plat must be attached: (C0-7 for oil wells; CG-8 for gas wells).
5. The predicted locations of lease roads, tank batteries, pipelines, and electrical lines.

**KANSAS CORPORATION COMMISSION
OIL & GAS CONSERVATION DIVISION
APPLICATION FOR SURFACE PIT**

Form CDP-1
May 2010
Form must be Typed

Submit in Duplicate

Operator Name: _____		License Number: _____	
Operator Address: _____			
Contact Person: _____		Phone Number: _____	
Lease Name & Well No.: _____		Pit Location (QQQQ): _____ - _____ - _____ - _____	
Type of Pit: <input type="checkbox"/> Emergency Pit <input type="checkbox"/> Burn Pit <input type="checkbox"/> Settling Pit <input type="checkbox"/> Drilling Pit <input type="checkbox"/> Workover Pit <input type="checkbox"/> Haul-Off Pit <i>(If WP Supply API No. or Year Drilled)</i>		Pit is: <input type="checkbox"/> Proposed <input type="checkbox"/> Existing If Existing, date constructed: _____ Pit capacity: _____ (bbls)	
Is the pit located in a Sensitive Ground Water Area? <input type="checkbox"/> Yes <input type="checkbox"/> No		Chloride concentration: _____ mg/l <i>(For Emergency Pits and Settling Pits only)</i>	
Is the bottom below ground level? <input type="checkbox"/> Yes <input type="checkbox"/> No		Artificial Liner? <input type="checkbox"/> Yes <input type="checkbox"/> No	
How is the pit lined if a plastic liner is not used?		_____	
Pit dimensions (all but working pits): _____ Length (feet) _____ Width (feet) <input type="checkbox"/> N/A: Steel Pits Depth from ground level to deepest point: _____ (feet) <input type="checkbox"/> No Pit			
If the pit is lined give a brief description of the liner material, thickness and installation procedure.		Describe procedures for periodic maintenance and determining liner integrity, including any special monitoring.	
Distance to nearest water well within one-mile of pit: _____ feet Depth of water well _____ feet		Depth to shallowest fresh water _____ feet. Source of information: <input type="checkbox"/> measured <input type="checkbox"/> well owner <input type="checkbox"/> electric log <input type="checkbox"/> KDWR	
Emergency, Settling and Burn Pits ONLY: Producing Formation: _____ Number of producing wells on lease: _____ Barrels of fluid produced daily: _____ Does the slope from the tank battery allow all spilled fluids to flow into the pit? <input type="checkbox"/> Yes <input type="checkbox"/> No		Drilling, Workover and Haul-Off Pits ONLY: Type of material utilized in drilling/workover: _____ Number of working pits to be utilized: _____ Abandonment procedure: _____ _____ Drill pits must be closed within 365 days of spud date.	
<h2>Submitted Electronically</h2>			

KCC OFFICE USE ONLY			
		<input type="checkbox"/> Liner <input type="checkbox"/> Steel Pit <input type="checkbox"/> RFAC <input type="checkbox"/> RFAS	
Date Received: _____	Permit Number: _____	Permit Date: _____	Lease Inspection: <input type="checkbox"/> Yes <input type="checkbox"/> No

KANSAS CORPORATION COMMISSION
OIL & GAS CONSERVATION DIVISION

Form KSONA-1
January 2014
Form Must Be Typed
Form must be Signed
All blanks must be Filled

**CERTIFICATION OF COMPLIANCE WITH THE
KANSAS SURFACE OWNER NOTIFICATION ACT**

This form must be submitted with all Forms C-1 (Notice of Intent to Drill); CB-1 (Cathodic Protection Borehole Intent); T-1 (Request for Change of Operator Transfer of Injection or Surface Pit Permit); and CP-1 (Well Plugging Application). Any such form submitted without an accompanying Form KSONA-1 will be returned.

Select the corresponding form being filed: C-1 (Intent) CB-1 (Cathodic Protection Borehole Intent) T-1 (Transfer) CP-1 (Plugging Application)

OPERATOR: License # _____
Name: _____
Address 1: _____
Address 2: _____
City: _____ State: _____ Zip: _____ + _____
Contact Person: _____
Phone: (_____) _____ Fax: (_____) _____
Email Address: _____

Well Location:
____ - ____ - ____ - ____ Sec. ____ Twp. ____ S. R. ____ East West
County: _____
Lease Name: _____ Well #: _____

If filing a Form T-1 for multiple wells on a lease, enter the legal description of the lease below:

Surface Owner Information:

Name: _____
Address 1: _____
Address 2: _____
City: _____ State: _____ Zip: _____ + _____

When filing a Form T-1 involving multiple surface owners, attach an additional sheet listing all of the information to the left for each surface owner. Surface owner information can be found in the records of the register of deeds for the county, and in the real estate property tax records of the county treasurer.

If this form is being submitted with a Form C-1 (Intent) or CB-1 (Cathodic Protection Borehole Intent), you must supply the surface owners and the KCC with a plat showing the predicted locations of lease roads, tank batteries, pipelines, and electrical lines. The locations shown on the plat are preliminary non-binding estimates. The locations may be entered on the Form C-1 plat, Form CB-1 plat, or a separate plat may be submitted.

Select one of the following:

- I certify that, pursuant to the Kansas Surface Owner Notice Act (House Bill 2032), I have provided the following to the surface owner(s) of the land upon which the subject well is or will be located: 1) a copy of the Form C-1, Form CB-1, Form T-1, or Form CP-1 that I am filing in connection with this form; 2) if the form being filed is a Form C-1 or Form CB-1, the plat(s) required by this form; and 3) my operator name, address, phone number, fax, and email address.
- I have not provided this information to the surface owner(s). I acknowledge that, because I have not provided this information, the KCC will be required to send this information to the surface owner(s). To mitigate the additional cost of the KCC performing this task, I acknowledge that I must provide the name and address of the surface owner by filling out the top section of this form and that I am being charged a \$30.00 handling fee, payable to the KCC, which is enclosed with this form.

If choosing the second option, submit payment of the \$30.00 handling fee with this form. If the fee is not received with this form, the KSONA-1 form and the associated Form C-1, Form CB-1, Form T-1, or Form CP-1 will be returned.

I Submitted Electronically

I

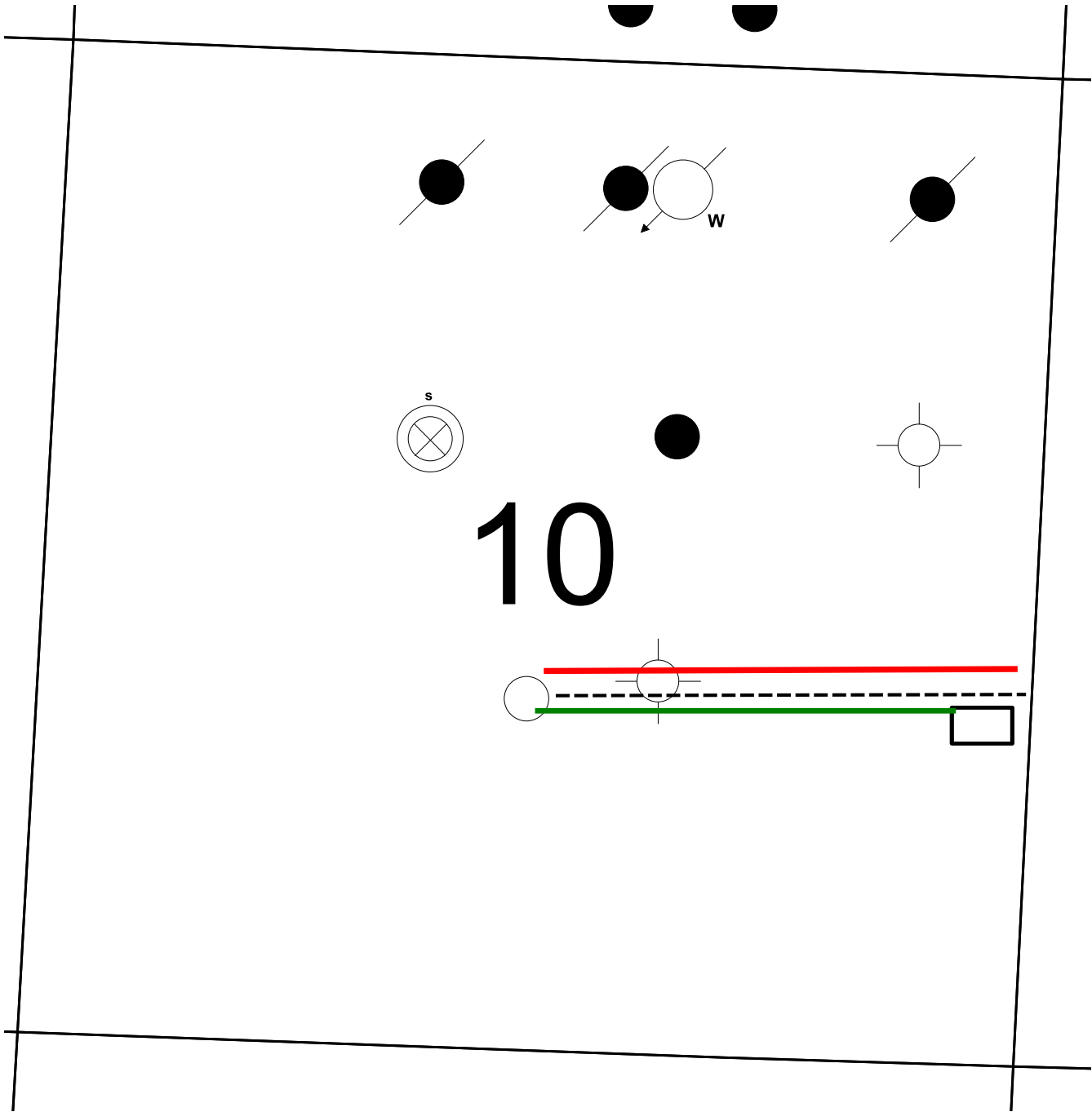

Proposed Location



Estimated Lease Road



Estimated Flow Line



Estimated Electrical Line



Estimated Tank Site

<p>GOETSCH 1-10 1880 FSL & 2660 FEL Sec 10-6S-37W Sherman County, KS</p>		
Landowner Notification Map.		Date: 9 June, 2019

Billie R. Hoyt
Register of Deeds
Billie R. Hoyt



Form 88- (Producer's Special Revised) (PAID-UP-REV)

OIL AND GAS LEASE

AGREEMENT, Made and entered into the 3rd day of December, 2017, by and between _____

LYMAN L. GOETSCH REVOCABLE TRUST, UTD 12/10/96 and S. JOANNE GOETSCH REVOCABLE

TRUST, UTD 12/10/96, herein represented by: Lyman L. Goetsch, as trustee, whose mailing address is 2470 County

Road 5, Brewster, Kansas 67732 hereinafter called Lessor (whether one or more), and BLACK OAK

EXPLORATION, LLC, whose mailing address is 1474 S. St Paul Street, Denver, CO 80210, hereinafter called

Lessee:

Lessor, in consideration of Ten and Other Valuable Considerations _____ Dollars (\$ 10.00) in hand paid, receipt of which is hereby acknowledged and of the royalties herein provided and of the agreements of the Lessee herein contained, hereby grants, leases and lets exclusively unto Lessee, together with ingress and egress, for the purpose of investigating, exploring by geophysical and other means, prospecting, drilling, mining and operating for and producing oil, liquid hydrocarbons, all gases, and their respective constituent products, injecting gas, water, other fluids, and air into subsurface strata, laying pipe lines, storing oil, placing tanks, power stations, telephone lines, and other structures and things thereon to produce, save, take care of, treat, manufacture, process, store and transport said oil, liquid hydrocarbons, gases and their respective constituent products and other products manufactured therefrom, regardless of the source of said products or location of said wells, the following described land, together with any reversionary rights and after-acquired interest, therein situated in County of Sherman State of Kansas described as follows to-wit:

Section 10: S/2

In Section _____ Township 6 South Range 37 West and containing 320.00 acres, more or less, and all accretions thereto.

Subject to the provisions herein contained, this lease shall remain in force for a term of 3 years from this date (called "primary term") and as long thereafter as oil, liquid hydrocarbons, gas or other respective constituent products, or any of them, is produced or is capable of being produced from said land or land pooled therewith or this lease is otherwise maintained in effect pursuant to the provisions hereof.

In consideration of the premises the said Lessee covenants and agrees:

1st. To deliver to the credit of Lessor, free of cost, in the pipe line to which Lessee may connect wells on said land, the equal one-eighth (1/8) part of all oil produced and saved from the leased premises, net of Lessor's proportionate share of the production, severance, or other excise taxes required to be withheld and remitted to the taxing entity, and the cost incurred by Lessee in delivering, treating, processing, or otherwise making any such oil merchantable.

2nd. To pay Lessor for gas, (including casinghead gas) of whatsoever nature or kind produced and sold, or used off the premises, or used in the manufacture of any products therefrom, one-eighth (1/8), at the market price at the well, (but, as to gas sold by Lessee, in no event more than one-eighth (1/8) of the net proceeds received by Lessee from such sales, such net proceeds to be less a proportionate part of the production, severance, or other excise taxes and the cost incurred by Lessee in delivering, treating for the removal of nitrogen, helium or other impurities in the gas, processing, compressing, or otherwise making any such gas merchantable) for the gas sold, used off the premises, or in the manufacture of products therefrom, said payments to be made monthly.

This lease may be maintained during the primary term hereof without further payment or drilling operations. If at the expiration of the primary term of this lease, oil or gas is not being produced on the leased premises or on acreage pooled or unitized therewith but Lessee is then engaged in drilling, reworking operations thereon, then this lease shall continue in force so long as operations are being continuously prosecuted on the leased premises or on acreage pooled or unitized therewith; and operations shall be considered to be continuously prosecuted if not more than one hundred and twenty (120) days shall elapse between the completion or abandonment of one well and the beginning of operations for the drilling of a subsequent well. If after discovery of oil or gas on the leased premises or on acreage pooled or unitized therewith, the production should cease from any cause after the primary term, this lease shall not terminate if Lessee commences additional drilling or reworking operations within one hundred and twenty (120) days from the date of cessation of production or from the date of completion of a dry hole. If oil or gas shall be discovered and produced as a result of such operations, this lease shall continue in full force and effect so long as oil or gas is produced from the leased premises or on acreage pooled or unitized therewith.

If after the primary term one or more wells on the lease premises or lands pooled or unitized therewith are capable of producing oil or gas or other substances covered hereby, but such well or wells are either shut in or production therefrom is not being sold by Lessee, such well or wells shall nevertheless be deemed to be producing for the purpose of maintaining the lease. If for a period of ninety (90) consecutive days such well or wells are shut in or production therefrom is not sold by Lessee, the Lessee shall pay an aggregate shut-in royalty of One Dollar (\$1.00) per acre then covered by this lease, such payment to be made to Lessor on or before the anniversary date of this lease next ensuing after the expiration of the said ninety (90) day period and thereafter on or before each anniversary date of this lease while the well or wells are shut in or production therefrom is not being sold by Lessee; provided that if this lease is in its primary term or otherwise being maintained by operations, or if production is being sold by Lessee from another well on the leased premises or lands pooled or unitized therewith, no shut-in royalty shall be due until the end of the next following anniversary date of this lease that cessation of such operations or production occurs, as the case may be. Lessee's failure to properly pay shut-in royalty shall render Lessee liable for the amount due, but shall not operate to terminate this lease.

If said Lessor owns a less interest in the above described land than the entire and undivided fee simple estate therein, then all bonus, rentals and royalties (including any shut-in royalties) herein provided for shall be paid to the said Lessor only in the proportion which Lessor's interest bears to the whole and undivided fee.

Lessee shall have the right to use, free of cost, gas, oil and water produced on said land for Lessee's operation thereon, or lands pooled therewith, except water from the wells of Lessor.

Lessee agrees herein to bury all pipelines to a depth below ordinary plow depth, at minimum, thirty-six (36) inches.

No well shall be drilled nearer than 200 feet to the house or barn now on said premises without written consent of Lessor.

Lessee shall pay for damages caused by Lessee's operations on said land.

Lessee shall have the right at any time to remove all machinery and fixtures placed on said premises, including the right to draw and remove casing.

If the estate of either party hereto is assigned, and the privilege of assigning in whole or in part is expressly allowed, the covenants hereof shall extend to their heirs, executors, administrators, successors or assigns, but no change in the ownership of the land or assignment of rentals or royalties shall be binding on the Lessee until after the Lessee has been furnished with a written transfer or assignment or a true copy thereof. In case Lessee assigns this lease, in whole or in part, Lessee shall be relieved of all obligations with respect to the assigned portion or portions arising subsequent to the date of assignment.

Lessee may at any time execute and deliver to Lessor or place of record a release or releases covering any portion or portions of the above described premises and thereby surrender this lease as to such portion or portions and be relieved of all obligations as to the acreage surrendered.

All express or implied covenants of this lease shall be subject to all Federal and State Laws, Executive Orders, Rules or Regulations, and this lease shall not be terminated, in whole or in part, nor Lessee held liable in damages, for failure to comply therewith, if compliance is prevented by, or if such failure is the result of, any such Law, Order, Rule or Regulation, including restrictions on the drilling and production of wells, and regulation of the price or transportation of oil, gas or other substance covered hereby. When drilling, reworking, production or other operations or obligations under this lease are prevented or delayed by such laws, rules, regulations or orders, or by inability to obtain necessary permits, equipment, services, material, water, electricity, fuel, access or easements, or by an act of God, strike, lockout, or other industrial disturbance, act of the public enemy, war, blockade, public riot, fire, storm, impaired surface conditions, flood or other act of nature, explosion, governmental action, governmental delay, restraint or inaction, or by inability to obtain a satisfactory market for production, or failure of purchasers or carriers to take or transport such production, or by any other cause, whether of the kind specifically enumerated above or otherwise, which is not reasonably within control of Lessee, this lease shall not terminate because of such prevention or delay, and, at Lessee's option, the period of such prevention or delay shall be added to the term hereof. Lessee shall not be liable for breach of any provision or implied covenants of this lease when drilling, production, or other operations are so prevented or delayed.

Lessor hereby warrants and agrees to defend the title to the lands herein described, and agrees that the Lessee shall have the right at any time to redeem for Lessor, by payment of any mortgages, taxes or other liens on the above described lands, in the event of default of payment by Lessor, and be subrogated to the rights of the holder thereof, and the undersigned Lessors, for themselves and their heirs, successors and assigns, hereby surrender and release all right of dower and homestead in the premises described herein, in so far as said right of dower and homestead may in any way affect the purposes for which this lease is made, as recited herein. In case of payment of any such mortgage, taxes or other liens by Lessee, in addition to the right to subrogation herein granted, Lessee shall also have the right to retain, without further consent or authority from Lessor, any royalties which become due to Lessor hereunder and to reimburse itself therefrom, and the retention of such royalties by Lessee shall have the same effect as if paid to the Lessor on whose behalf payment of any mortgage, taxes or other liens was made.

Lessee, at its option, is hereby given the right and power to pool, unitize or combine the acreage covered by this lease or any portion thereof with other land, lease or leases in the immediate vicinity thereof, when in Lessee's judgment it is necessary or advisable to do so in order to properly develop and operate said lease premises so as to promote the conservation of oil, gas or other minerals in and under and that may be produced from said premises, such pooling or unitization to be of tracts contiguous to one another and to be into a unit or units not exceeding 40 acres each in the event of an oil well, or into a unit or units not exceeding 640 acres each in the event of a horizontal well or a gas well. Lessee shall execute in writing and record in the conveyance records of the county in which the land herein leased is situated an instrument identifying and describing the pooled or unitized acreage. The entire acreage so pooled or unitized into a tract or unit shall be treated, for all purposes except the payment of royalties on production from the pooled unit, as if it were included in this lease. If production is found on the pooled acreage, it shall be treated as if production is had from this lease, whether the well or wells be located on the premises covered by this lease or not. In lieu of the royalties elsewhere herein specified, Lessor shall receive on production from a unit so pooled only such portion of the royalty stipulated herein as the amount of his acreage placed in the unit or his royalty interest therein on an acreage basis bears to the total acreage so pooled or unitized in the particular unit involved.

This lease may be signed in any number or numbers of counterparts and shall be effective as to each Lessor on execution hereof as to his or her interest and shall be binding on those signing, notwithstanding some of the Lessors above named who may not have joined in the execution hereof. The word "Lessor" as used in this lease shall mean the party or parties who execute this lease as Lessor, although not named above.

Lessee shall have the exclusive right to explore the land herein described by geological, geophysical or other methods, whether similar to those herein specified or not and whether now known or not, including the drilling of holes, use of torsion balance, seismograph explosions, magnetometer, or other geophysical or geological instruments, tests or procedures, for the purpose of securing geological and geophysical information. All information obtained by Lessee as a result of such activity shall be the exclusive property of Lessee, and Lessee may disseminate or sell such information without Lessor's consent. Lessor and Lessee herein agree that a portion of the consideration paid herein is for advance payment of usual and customary damages associated with seismograph operations (i.e.: tire tracks in the wheat, pasture or field, road use, compaction etc.). If any extraordinary damages should occur, at Lessee's discretion, Lessor or its tenant (if Lessor has a tenant) will be compensated accordingly, or Lessee may elect to repair the damages in lieu of compensation.

In the event that any provision(s) of this lease are declared invalid or unenforceable by any court or governmental agency having jurisdiction thereof, the remaining terms and provisions that are not effected shall remain in full force and effect. In the event that any provision(s) of this lease are so declared invalid or unenforceable, the court or governmental agency may reform said provision(s) to the extent and only to the extent deemed necessary to make the same valid and enforceable.

See Exhibit "A" for additional terms and provisions.

IN WITNESS WHEREOF, the undersigned execute this instrument as of the day and year first above written.

LYMAN L. GOETSCH REVOCABLE TRUST, UTD 12/10/96



By: Lyman L. Goetsch, trustee

S. JOANNE GOETSCH REVOCABLE TRUST, UTD 12/10/96



By: Lyman L. Goetsch, trustee

EXHIBIT "A"

Attached to and made a part of that certain Oil and Gas Lease dated December 3, 2011, by and between Lyman L. Goetsch Revocable Trust, UTD 12/10/96, et al, as Lessor, and Black Oak Exploration, LLC, as Lessee.

ADDITIONAL TERMS AND PROVISIONS:

1. The provisions of this EXHIBIT "A" shall control and supersede the terms of the attached oil and gas lease when such terms conflict.
2. Lessee shall bury and maintain all pipelines below ordinary plow depth (36").
3. Lessee shall pay all damages, caused by Lessee's operations hereunder to crops, including grass, and restore as nearly as practical, said premises to the same conditions and contour as previously existed, upon termination of this lease.
4. Lessee is hereby granted the option to extend the primary term of this lease for an additional two (2) years from the expiration of the original primary term. This option may be exercised by Lessee in total or in part, by mailing on or before the expiration date of lease to Lessor at the above address, the sum of \$30 per net acre for the amount of acres Lessee elects to extend. Should this option be exercised as herein provided, it shall be considered for all purposes as though this lease originally provided for a term of five (5) years.

ACKNOWLEDGMENT PAGE TO FOLLOW

ACKNOWLEDGMENTS

[STATE OF Kansas] §
[COUNTY OF Thomas] §

This instrument was acknowledged before me this 12 day of December 2017, by LYMAN L.

GOETSCH REVOCABLE TRUST, UTD 12/10/96 and S. JOANNE GOETSCH REVOCABLE TRUST, UTD

12/10/96, herein represented by: Lyman L. Goetsch, as trustee

My commission expires 7-11-21

Sherrie M. Eicher
Notary Public

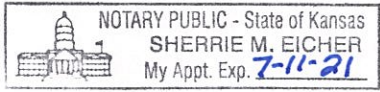

No. _____

OIL AND GAS LEASE

FROM

TO

Date _____

Section _____ Twp. _____ Rge. _____

No. of Acres _____ Term _____

County _____

STATE OF _____

County _____

This instrument was filed for record on the _____

day of _____

at _____ o'clock _____ M., and duly recorded

in Book _____ Page _____ of _____

the records of this office.

By _____ Register of Deeds.

When recorded, return to _____

BLACK OAK EXPLORATION, LLC
1474 S. ST. PAUL STREET, DENVER, CO
80210