

VESS OIL CORPORATION
 BROWN-SCULLY LEASE
 NE. 1/4, SECTION 16, T28S, R4E
 BUTLER COUNTY, KANSAS

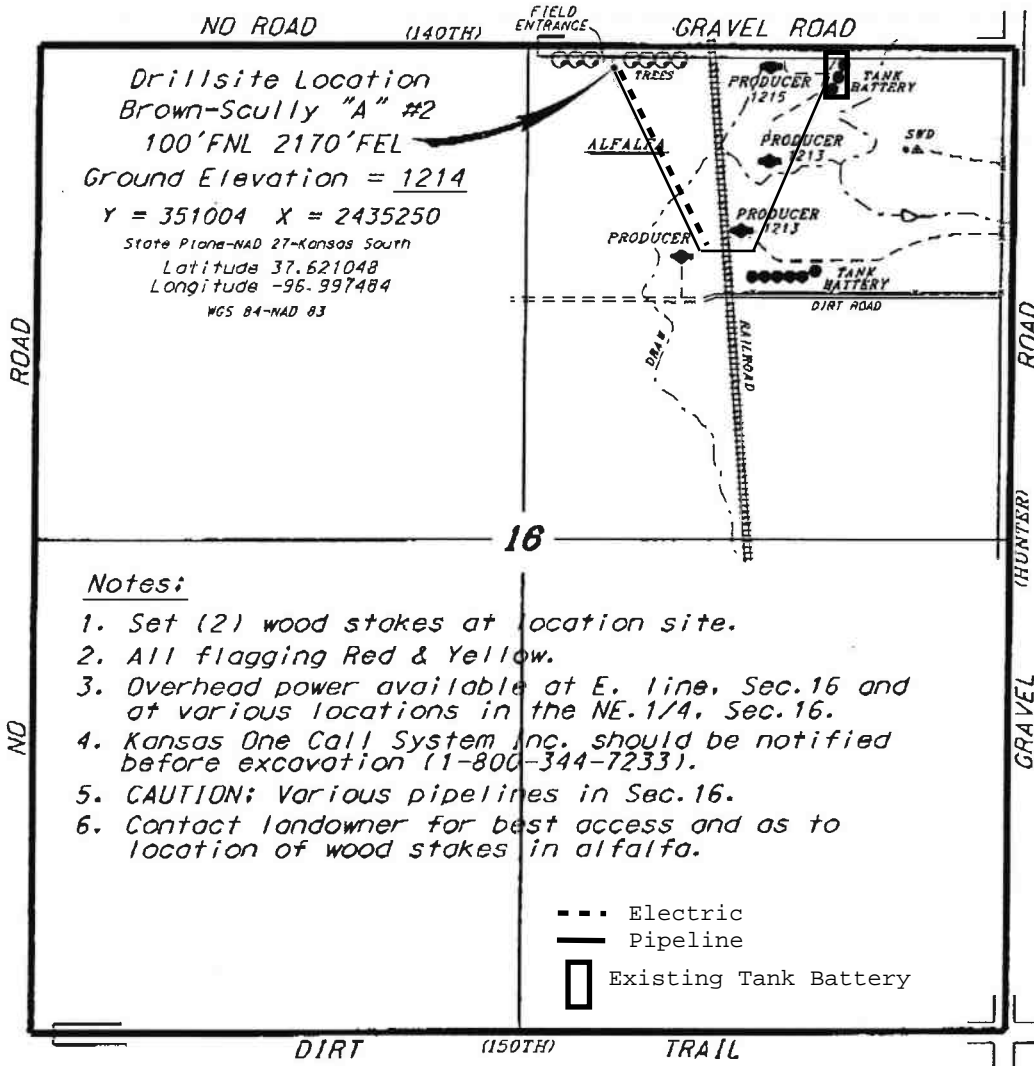

*Ingress and egress to location as shown on this plot is for public use only and may not be legally opened for public use. Contact landowner, tenant and county road department for access.

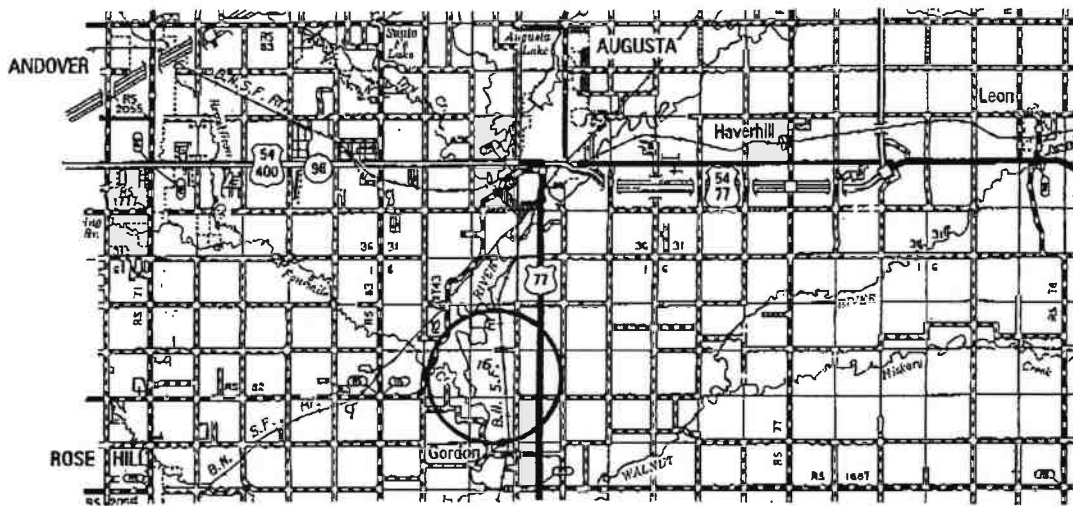

• Controlling data is based upon the best maps and photographs available to us and upon a regular section of land containing 640 acres.
 • Approximate Section lines were determined using the normal standard of care of oilfield surveyors practicing in the state of Kansas. The section corners, which establish the precise section lines, were not necessarily located, and the exact location of the drillsite location in the section is not guaranteed. Therefore, the operator securing this service and accepting this plot and all other parties relying thereon agree to hold Central Kansas Oilfield Services, Inc., its officers and employees harmless from all losses, costs and expenses and said entities released from any liability from incidental or consequential damages.
 • Elevations derived from National Geodetic Vertical Datum.

Date June 5, 2019

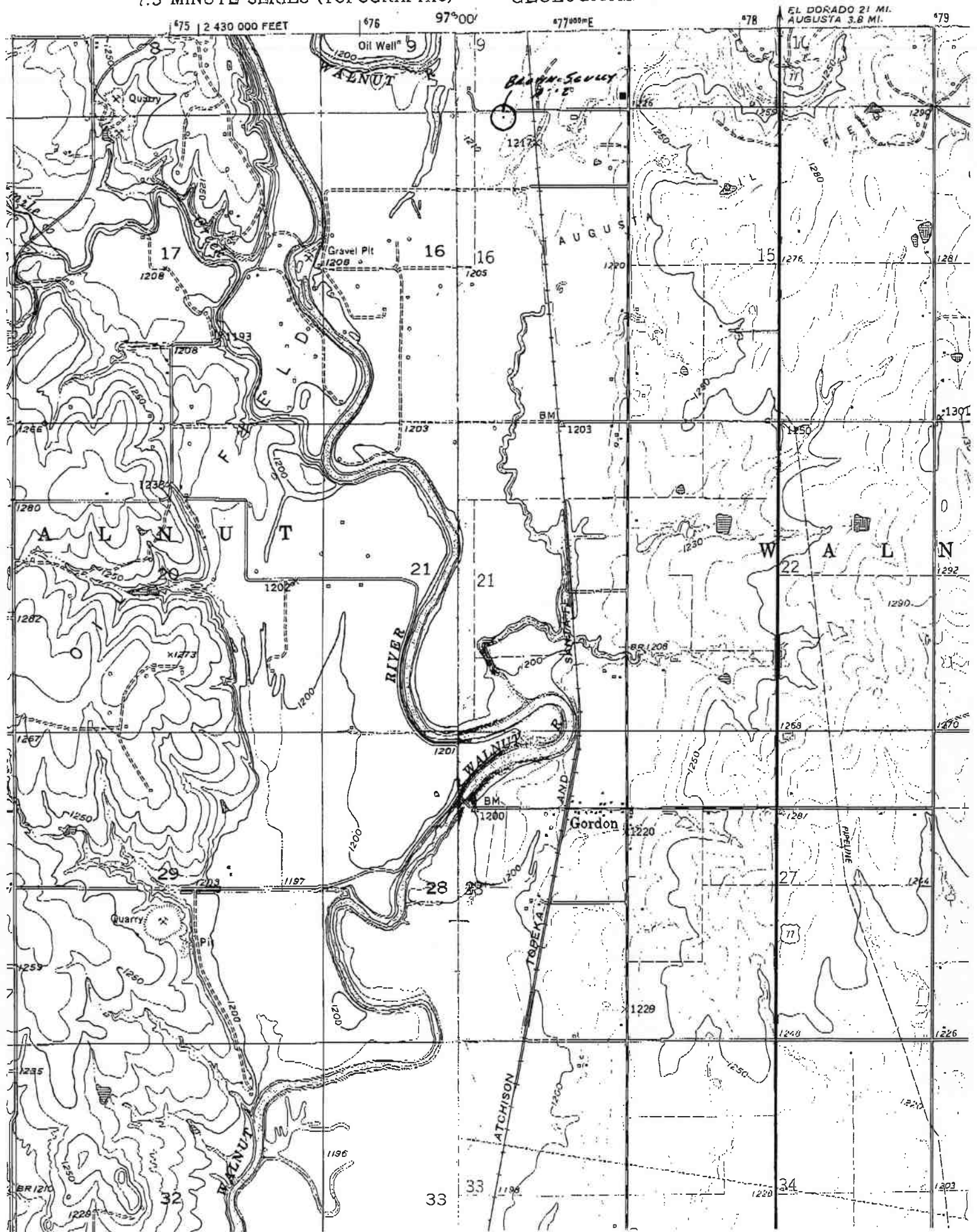

175 2 430 000 FEET 176 97°00' 177 00000E 178 EL DORADO 21 MI. AUGUSTA 3.8 MI. 179

Oil Well
WALNUT
Augustus
Walnut

Gravel Pit

Gordon

RIVER

WALNUT

AUGUSTUS

WALNUT

Quarry

ROCKY MOUNTAIN

BR 1210

