

**PLAT & CERTIFICATION OF ACREAGE ATTRIBUTABLE TO AN OIL WELL**

API Number: 15-007-24358  
 Operator: Hayes Oil + Gas llc  
 Lease: Kotzen - Heydenreich 1-10  
 Well Number: 1-10  
 Field: Rhodes  
 Number of acres attributable to well: \_\_\_\_\_  
 Producing Formation(s): \_\_\_\_\_

Location of well: County Barber  
2310 feet from  South /  North line of section  
1750 feet from  East /  West line of section  
 \_\_\_\_\_ Sec. \_\_\_\_\_ Twp. \_\_\_\_\_ R.  East  West  
 Is section:  Regular  Irregular  
 If section is Irregular, locate well from the nearest corner boundry:  
 Section corner used:  NE  NW  SE  SW

(Show the location of the well and shade attributable acreage for prorated wells.) (Show the footage to the nearest lease or line; and show footage to the nearest common source supply well.)

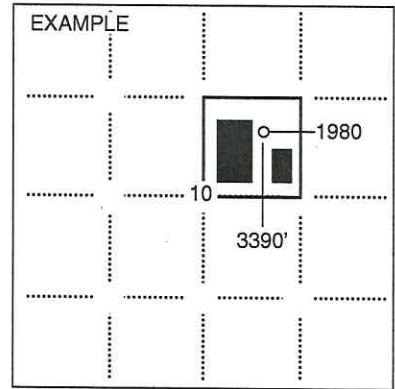
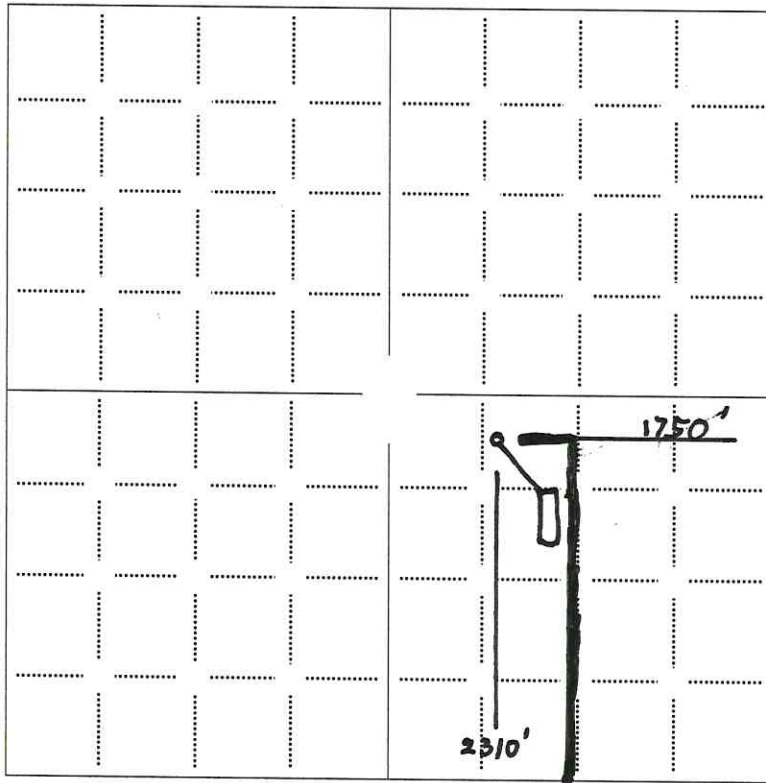

SEWARD CO.

The undersigned hereby certifies as \_\_\_\_\_ (Title) for \_\_\_\_\_ (Co.), a duly authorized agent, that all information shown hereon is true and correct to the best of my knowledge and belief, that all acreage claimed attributable to the oil well named herein will be kept exclusively for oil recovery by the subject oil well.

Signature: \_\_\_\_\_

Subscribed and sworn to before me on this \_\_\_\_\_ day of \_\_\_\_\_, \_\_\_\_\_

\_\_\_\_\_  
Notary Public

My Commission expires: \_\_\_\_\_