

VINCENT OIL CORPORATION
 ROTZ LEASE
 SE.1/4, SECTION 5, T29S, R22W
 FORD COUNTY, KANSAS

GRAVEL (WILBURN ROAD) ROAD

Notes:

1. Set (2) wood stakes at location site.
2. All flagging Red & Yellow.
3. Overhead power available at N. & W. lines, Sec.5.
4. Kansas One Call System Inc. should be notified before excavation (1-800-344-7233).
5. CAUTION; Various pipelines in Sec.5.
6. Section 5 is irregular.
7. Contact landowner for best access.
8. Location fell 33' SE. of a NE-SW pivot system wheel track, no alternate set per representative.

ROAD (125 ROAD)
 PAVED

ROAD (126 ROAD)
 GRAVEL

5

Drillsite Location
 Rotz #1-5
 1963'FSL 1960'FEL
 Ground Elevation = 2499

Y = 322980 X = 1638825

State Plane-NAD 27-Kansas South

Latitude 37.54707

Longitude -99.745805

(NAD 27)

IMEL-ROTZ
 UNIT #2-5

IMEL-ROTZ
 UNIT #1-5

NE-SW PIVOT SYSTEM
 WHEEL TRACK 33'NW.
 OF LOCATION

PLOWED
 GROUND

APPROX. LOCATION
 CENTER PIVOT IRR.
 SYSTEM

GRAVEL (WILDFIRE ROAD) ROAD

FLAGGED ROAD
 OPPOSITE LOC.

*Ingress and egress to location as shown on this plat is per usage only and may not be legally opened for public use. Contact landowner, tenant and county road department for access.

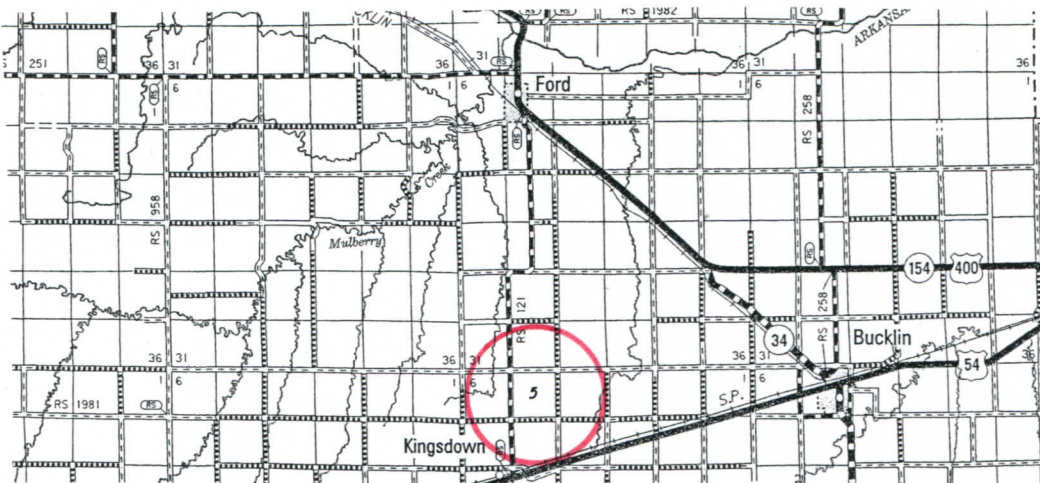
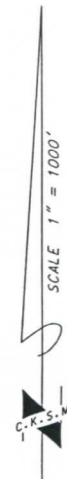

* Controlling data is based upon the best maps and photographs available to us and upon a regular section of land containing 640 acres.
 * Approximate section lines were determined using the normal standard of care of oilfield surveyors practicing in the state of Kansas. The section corners, which establish the precise section lines, were not necessarily located, and the exact location of the drillsite location in the section is not guaranteed. Therefore, the operator securing this service and accepting this plat and all other parties relying thereon agree to hold Central Kansas Oilfield Services, Inc., its officers and employees harmless from all losses, costs and expenses and said entities released from any liability from incidental or consequential damages.
 * Elevations derived from National Geodetic Vertical Datum.

Date October 2, 2019

