

Proposed Plan of Construction
 WENU 103
 Sec 4 T28S-R34W
 Haskell County, KS

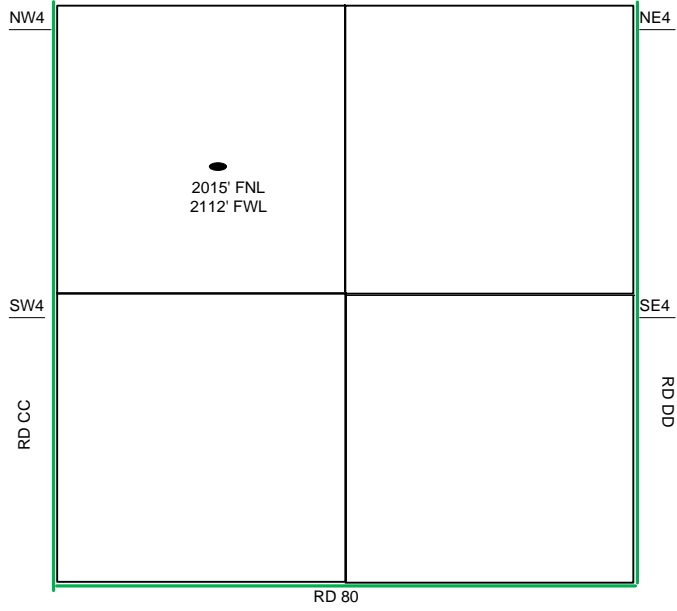

Sec 4 - T28S - R34W

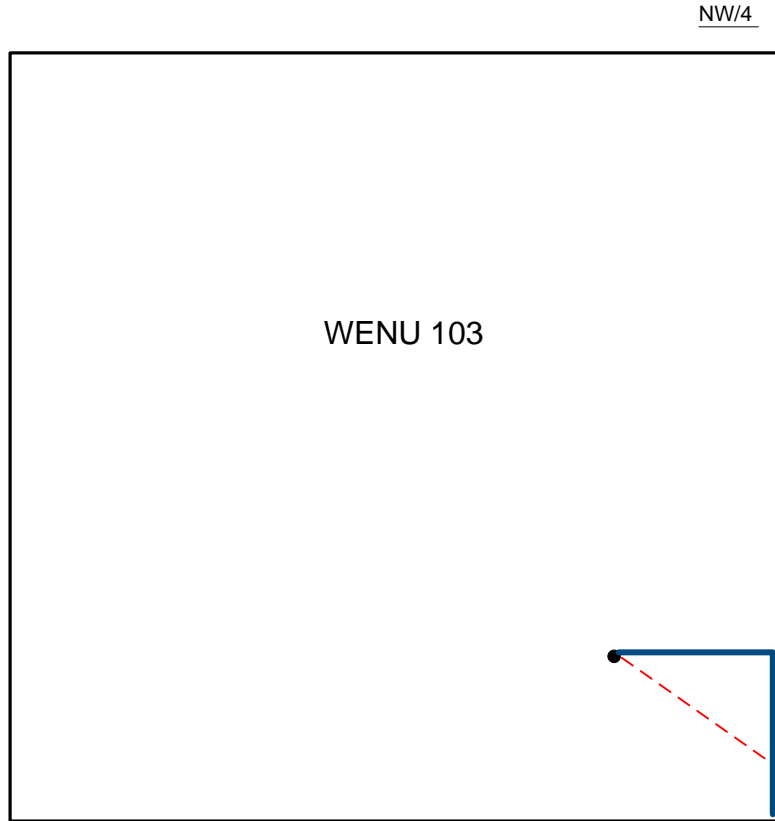

Proposed Details of
 NW/4 Sec 4 - T28S - R34W

The Tank Battery for the WENU 103 is located SE of the well. WENU Facility.

Note-Drawing **Not** to Scale