

Confidentiality Requested:

Yes  No

**KANSAS CORPORATION COMMISSION  
OIL & GAS CONSERVATION DIVISION**

Form ACO-1

January 2018

**Form must be Typed**

**Form must be Signed**

**All blanks must be Filled**

**WELL COMPLETION FORM  
WELL HISTORY - DESCRIPTION OF WELL & LEASE**

OPERATOR: License # \_\_\_\_\_

Name: \_\_\_\_\_

Address 1: \_\_\_\_\_

Address 2: \_\_\_\_\_

City: \_\_\_\_\_ State: \_\_\_\_\_ Zip: \_\_\_\_\_ + \_\_\_\_\_

Contact Person: \_\_\_\_\_

Phone: ( \_\_\_\_\_ ) \_\_\_\_\_

CONTRACTOR: License # \_\_\_\_\_

Name: \_\_\_\_\_

Wellsite Geologist: \_\_\_\_\_

Purchaser: \_\_\_\_\_

Designate Type of Completion:

New Well  Re-Entry  Workover

Oil  WSW  SWD

Gas  DH  EOR

OG  GSW

CM (Coal Bed Methane)

Cathodic  Other (Core, Expl., etc.): \_\_\_\_\_

If Workover/Re-entry: Old Well Info as follows:

Operator: \_\_\_\_\_

Well Name: \_\_\_\_\_

Original Comp. Date: \_\_\_\_\_ Original Total Depth: \_\_\_\_\_

Deepening  Re-perf.  Conv. to EOR  Conv. to SWD  
 Plug Back  Liner  Conv. to GSW  Conv. to Producer

Commingled Permit #: \_\_\_\_\_

Dual Completion Permit #: \_\_\_\_\_

SWD Permit #: \_\_\_\_\_

EOR Permit #: \_\_\_\_\_

GSW Permit #: \_\_\_\_\_

Spud Date or Date Reached TD Completion Date or Recompletion Date

API No.: \_\_\_\_\_

Spot Description: \_\_\_\_\_

\_\_\_\_\_ - \_\_\_\_\_ - \_\_\_\_\_ Sec. \_\_\_\_\_ Twp. \_\_\_\_\_ S. R. \_\_\_\_\_  East  West

\_\_\_\_\_ Feet from  North /  South Line of Section

\_\_\_\_\_ Feet from  East /  West Line of Section

Footages Calculated from Nearest Outside Section Corner:

NE  NW  SE  SW

GPS Location: Lat: \_\_\_\_\_, Long: \_\_\_\_\_  
(e.g. xx.xxxxx) (e.g. -xxx.xxxxx)

Datum:  NAD27  NAD83  WGS84

County: \_\_\_\_\_

Lease Name: \_\_\_\_\_ Well #: \_\_\_\_\_

Field Name: \_\_\_\_\_

Producing Formation: \_\_\_\_\_

Elevation: Ground: \_\_\_\_\_ Kelly Bushing: \_\_\_\_\_

Total Vertical Depth: \_\_\_\_\_ Plug Back Total Depth: \_\_\_\_\_

Amount of Surface Pipe Set and Cemented at: \_\_\_\_\_ Feet

Multiple Stage Cementing Collar Used?  Yes  No

If yes, show depth set: \_\_\_\_\_ Feet

If Alternate II completion, cement circulated from: \_\_\_\_\_

feet depth to: \_\_\_\_\_ w/ \_\_\_\_\_ sx cmt.

**Drilling Fluid Management Plan**

*(Data must be collected from the Reserve Pit)*

Chloride content: \_\_\_\_\_ ppm Fluid volume: \_\_\_\_\_ bbls

Dewatering method used: \_\_\_\_\_

Location of fluid disposal if hauled offsite: \_\_\_\_\_

Operator Name: \_\_\_\_\_

Lease Name: \_\_\_\_\_ License #: \_\_\_\_\_

Quarter \_\_\_\_\_ Sec. \_\_\_\_\_ Twp. \_\_\_\_\_ S. R. \_\_\_\_\_  East  West

County: \_\_\_\_\_ Permit #: \_\_\_\_\_

**AFFIDAVIT**

I am the affiant and I hereby certify that all requirements of the statutes, rules and regulations promulgated to regulate the oil and gas industry have been fully complied with and the statements herein are complete and correct to the best of my knowledge.

Submitted Electronically

**KCC Office Use ONLY**

Confidentiality Requested

Date: \_\_\_\_\_

Confidential Release Date: \_\_\_\_\_

Wireline Log Received  Drill Stem Tests Received

Geologist Report / Mud Logs Received

UIC Distribution

ALT  I  II  III Approved by: \_\_\_\_\_ Date: \_\_\_\_\_

Operator Name: \_\_\_\_\_ Lease Name: \_\_\_\_\_ Well #: \_\_\_\_\_

Sec. \_\_\_\_\_ Twp. \_\_\_\_\_ S. R. \_\_\_\_\_  East  West County: \_\_\_\_\_

**INSTRUCTIONS:** Show important tops of formations penetrated. Detail all cores. Report all final copies of drill stems tests giving interval tested, time tool open and closed, flowing and shut-in pressures, whether shut-in pressure reached static level, hydrostatic pressures, bottom hole temperature, fluid recovery, and flow rates if gas to surface test, along with final chart(s). Attach extra sheet if more space is needed.

Final Radioactivity Log, Final Logs run to obtain Geophysical Data and Final Electric Logs must be emailed to kcc-well-logs@kcc.ks.gov. Digital electronic log files must be submitted in LAS version 2.0 or newer AND an image file (TIFF or PDF).

Drill Stem Tests Taken <input type="checkbox"/> Yes <input type="checkbox"/> No <i>(Attach Additional Sheets)</i>  Samples Sent to Geological Survey <input type="checkbox"/> Yes <input type="checkbox"/> No  Cores Taken <input type="checkbox"/> Yes <input type="checkbox"/> No Electric Log Run <input type="checkbox"/> Yes <input type="checkbox"/> No Geologist Report / Mud Logs <input type="checkbox"/> Yes <input type="checkbox"/> No  List All E. Logs Run:	<input type="checkbox"/> Log Formation (Top), Depth and Datum <input type="checkbox"/> Sample  Name Top Datum
--	---

CASING RECORD <input type="checkbox"/> New <input type="checkbox"/> Used							
Report all strings set-conductor, surface, intermediate, production, etc.							
Purpose of String	Size Hole Drilled	Size Casing Set (In O.D.)	Weight Lbs. / Ft.	Setting Depth	Type of Cement	# Sacks Used	Type and Percent Additives

ADDITIONAL CEMENTING / SQUEEZE RECORD				
Purpose:	Depth Top Bottom	Type of Cement	# Sacks Used	Type and Percent Additives
<input type="checkbox"/> Perforate <input type="checkbox"/> Protect Casing <input type="checkbox"/> Plug Back TD <input type="checkbox"/> Plug Off Zone				

1. Did you perform a hydraulic fracturing treatment on this well?  Yes  No *(If No, skip questions 2 and 3)*
2. Does the volume of the total base fluid of the hydraulic fracturing treatment exceed 350,000 gallons?  Yes  No *(If No, skip question 3)*
3. Was the hydraulic fracturing treatment information submitted to the chemical disclosure registry?  Yes  No *(If No, fill out Page Three of the ACO-1)*

Date of first Production/Injection or Resumed Production/Injection:	Producing Method: <input type="checkbox"/> Flowing <input type="checkbox"/> Pumping <input type="checkbox"/> Gas Lift <input type="checkbox"/> Other <i>(Explain)</i> _____			
Estimated Production Per 24 Hours	Oil Bbls.	Gas Mcf	Water Bbls.	Gas-Oil Ratio Gravity

DISPOSITION OF GAS: <input type="checkbox"/> Vented <input type="checkbox"/> Sold <input type="checkbox"/> Used on Lease <i>(If vented, Submit ACO-18.)</i>	METHOD OF COMPLETION: <input type="checkbox"/> Open Hole <input type="checkbox"/> Perf. <input type="checkbox"/> Dually Comp. <input type="checkbox"/> Commingled <i>(Submit ACO-5) (Submit ACO-4)</i>	PRODUCTION INTERVAL: Top Bottom
---	--	------------------------------------

Shots Per Foot	Perforation Top	Perforation Bottom	Bridge Plug Type	Bridge Plug Set At	Acid, Fracture, Shot, Cementing Squeeze Record <i>(Amount and Kind of Material Used)</i>

TUBING RECORD:	Size:	Set At:	Packer At:	
----------------	-------	---------	------------	--



25	shale	562
1	limy sand	563 hard grey sand
6	shale	569 grey sand, very thin coal laminations, some gas
4	silty shale	573
78	shale	651
7	sand	658 green sand, no show, no odor
45	shale	703
2	lime	705
3	shale	708
3	lime	711
7	shale	718
9	lime	727
12	shale	739
3	lime	742
11	shale	753
9	lime	762
11	shale	773
1	lime	774
5	shale	779
2	lime	781
2	shale	783
7	silty shale	790 CP
1.5	limy sand	791.5 white, hard, no bleed
9.5	oil sand	801 brown soft sand, good bleed, gassy
3	broken sand	804 30% brown sand, 70% shale, good bleed
13	silty shale	817
17	shale	834
1	lime & shells	835
5	shale	840 TD

Drilled a 9 7/8" hole to 47.3'

Drilled a 5 5/8" hole to 840'

Set 47.3' of new 7" casing threaded and coupled, cemented with 15 sacks cement.

Set 821' of new 2 7/8" 8 round upset tubing with 3 centralizers, 1 float shoe, 1 clamp.

Dug 1 pit

Cored 790'-809'



24 S. Gold Paola, KS 66071

Allen's Holdings & Investments  
 Oil & Gas Well Drilling  
 Water Wells  
 Geo-Loop Installation

Phone: 913-557-9083  
 Fax: 913-557-9084

**WELL LOG**

Tauy Oil, Inc.

L Hey #5

API #15-045-22295-00-00

July 16, 2019-July 18, 2019

<u>Thickness of Strata</u>	<u>Formation</u>	<u>Total</u>
5	soil & clay	5
7	sandy shale	12
8	sandstone	20 brown soft, no water
18	sandstone	38 grey, coarse grained, making 7 gpm
2	limy sandstone	40 hard white limy sandstone
107	shale	147
6	lime	153
6	shale	159
7	lime	166
17	shale	183
7	lime	190
5	shale	195
20	lime	215
27	shale	242
25	lime	267
8	shale	275
2	lime	277
60	shale	337
18	lime	355
1	shale	356
3	lime	359
18	shale	377 Redbed
8	lime	385
36	shale	421
8	lime	429
4	shale	433
2	lime	435
11	shale	446
27	lime	473
5	shale	478
24	lime	502
4	shale	506
4	lime	510
3	shale	513
7	lime	520 Base of Kansas City/Hertha
5	shale	525
6	sand	531 green sand, wet, some gas
6	silty shale	537

25	shale	562
1	limy sand	563 hard grey sand
6	shale	569 grey sand, very thin coal laminations, some gas
4	silty shale	573
78	shale	651
7	sand	658 green sand, no show, no odor
45	shale	703
2	lime	705
3	shale	708
3	lime	711
7	shale	718
9	lime	727
12	shale	739
3	lime	742
11	shale	753
9	lime	762
11	shale	773
1	lime	774
5	shale	779
2	lime	781
2	shale	783
7	silty shale	790 CP
1.5	limy sand	791.5 white, hard, no bleed
9.5	oil sand	801 brown soft sand, good bleed, gassy
3	broken sand	804 30% brown sand, 70% shale, good bleed
13	silty shale	817
17	shale	834
1	lime & shells	835
5	shale	840 TD

Drilled a 9 7/8" hole to 47.3'

Drilled a 5 5/8" hole to 840'

Set 47.3' of new 7" casing threaded and coupled, cemented with 15 sacks cement.

Set 821' of new 2 7/8" 8 round upset tubing with 3 centralizers, 1 float shoe, 1 clamp.

Dug 1 pit

Cored 790'-809'

# HEY #5

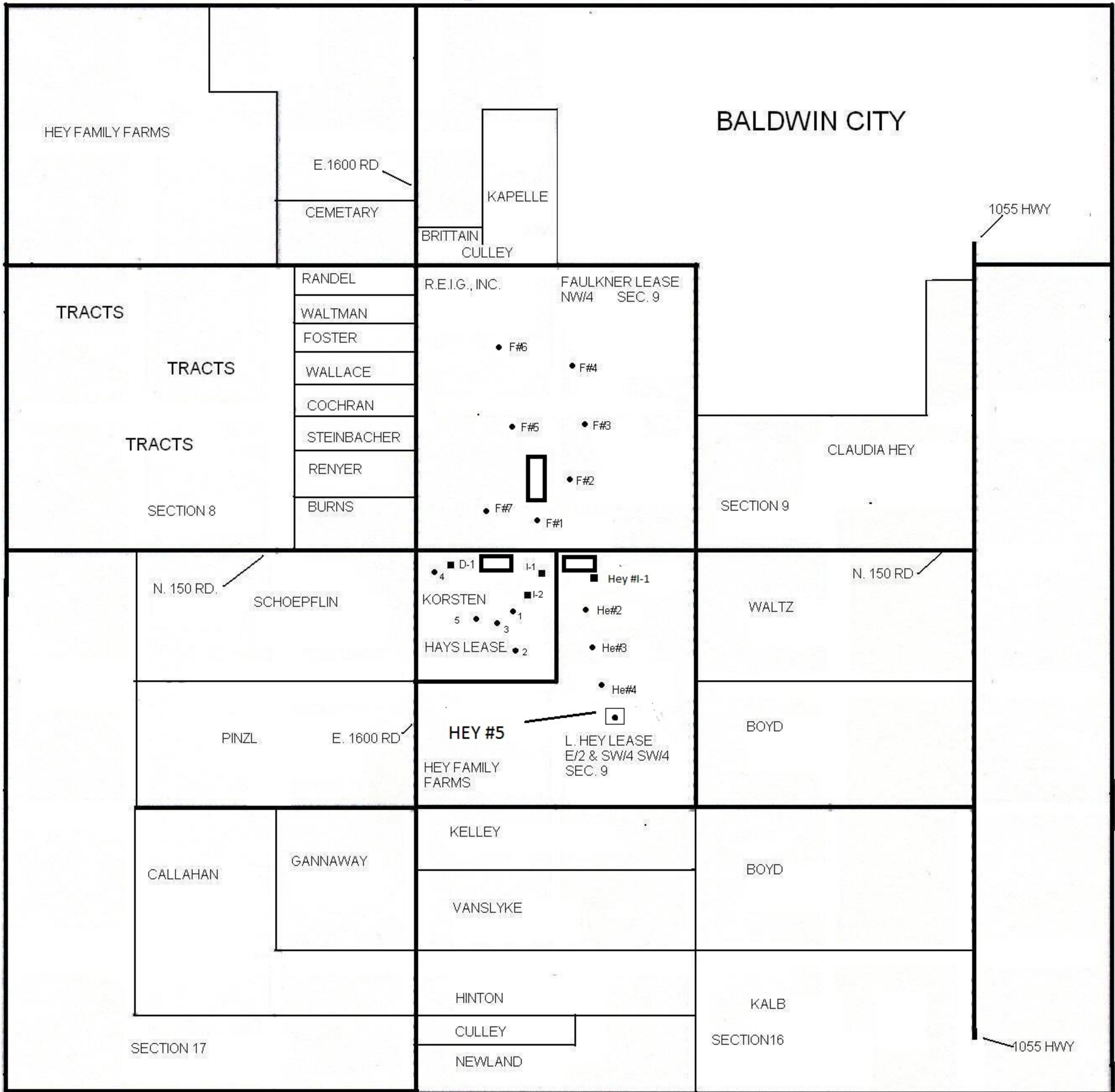

• PRODUCING WELL    ■ INJECTION WELL    □ APPLICANT WELL    ▭ TANKS

JULY 7, 2019

HEY #5

API #15-045-22295-00-00

CEMENTED 47.3' 7" Casing w/15sx Portland

Using drilling rig tools.

Daniel Martin  
Tauy Oil, Inc.





REMIT TO  
QES Pressure Pumping LLC  
Dept:970  
P.O.Box 4346  
Houston, TX 77210-4346

MAIN OFFICE  
P.O.Box884  
Chanute,KS 66720  
620/431-9210,1-800/467-8676  
Fax 620/431-0012

Invoice Invoice# 901124

Invoice Date: 07/22/19 Terms: C.O.D. Page 1

TAUY OIL  
P.O. BOX 973  
BALDWIN CITY KS 66006  
USA

L. HEY #5

Part No	Description	Quantity	Discounted Unit Price	Discounted Total
CE0450	Cement Pump Charge 0 - 1500'	1.000	825.0000	825.00
CE0002	Equipment Mileage Charge - Heavy Equipment	20.000	3.9325	78.65
CE0711	Minimum Cement Delivery Charge	0.500	363.0000	181.50
WE0853	80 BBL Vacuum Truck (Cement Services)	1.000	55.0000	55.00
CC5840	Poz-Blend I A (50:50)	115.000	7.4250	853.88
CC5965	Bentonite	393.000	0.1650	64.85
CC6075	Celloflake	29.000	1.1000	31.90
CP8176	2 7/8" Top Rubber Plug	1.000	24.7500	24.75
SubTotal After Discount				2,115.53

Tax: 75.59  
Total: 2,191.12

Amount Due 3,983.84 If paid after 07/22/19