

KANSAS CORPORATION COMMISSION
OIL & GAS CONSERVATION DIVISION

Form ACO-4
Form must be typed
March 2009

APPLICATION FOR COMMINGLING OF PRODUCTION (K.A.R. 82-3-123) OR FLUIDS (K.A.R. 82-3-123a) *Commingling ID #* _____

OPERATOR: License # _____ API No. 15 - _____
Name: _____ Spot Description: _____
Address 1: _____ - - - - - Sec. _____ Twp. _____ S. R. _____ East West
Address 2: _____ Feet from North / South Line of Section
City: _____ State: _____ Zip: _____ + _____ Feet from East / West Line of Section
Contact Person: _____ County: _____
Phone: (_____) _____ Lease Name: _____ Well #: _____

1. Name and upper and lower limit of each production interval to be commingled:
Formation: _____ (Perfs): _____
Formation: _____ (Perfs): _____
Formation: _____ (Perfs): _____
Formation: _____ (Perfs): _____
Formation: _____ (Perfs): _____

2. Estimated amount of fluid production to be commingled from each interval:
Formation: _____ BOPD: _____ MCFPD: _____ BWPD: _____
Formation: _____ BOPD: _____ MCFPD: _____ BWPD: _____
Formation: _____ BOPD: _____ MCFPD: _____ BWPD: _____
Formation: _____ BOPD: _____ MCFPD: _____ BWPD: _____
Formation: _____ BOPD: _____ MCFPD: _____ BWPD: _____

3. Plat map showing the location of the subject well, all other wells on the subject lease, and all wells on offsetting leases within a 1/2 mile radius of the subject well, and for each well the names and addresses of the lessee of record or operator.

4. Signed certificate showing service of the application and affidavit of publication as required in K.A.R. 82-3-135a.

For Commingling of PRODUCTION ONLY, include the following:

- 5. Wireline log of subject well. Previously Filed with ACO-1: Yes No
- 6. Complete Form ACO-1 (*Well Completion form*) for the subject well.

For Commingling of FLUIDS ONLY, include the following:

- 7. Well construction diagram of subject well.
- 8. Any available water chemistry data demonstrating the compatibility of the fluids to be commingled.

AFFIDAVIT: I am the affiant and hereby certify that to the best of my current information, knowledge and personal belief, this request for commingling is true and proper and I have no information or knowledge, which is inconsistent with the information supplied in this application.

Submitted Electronically

KCC Office Use Only
 Denied Approved
15-Day Periods Ends: _____
Approved By: _____ Date: _____

Protests may be filed by any party having a valid interest in the application. Protests must be in writing and comply with K.A.R. 82-3-135b and must be filed within 15 days of publication of the notice of application.

Bouziden #3-10
Commingle Application

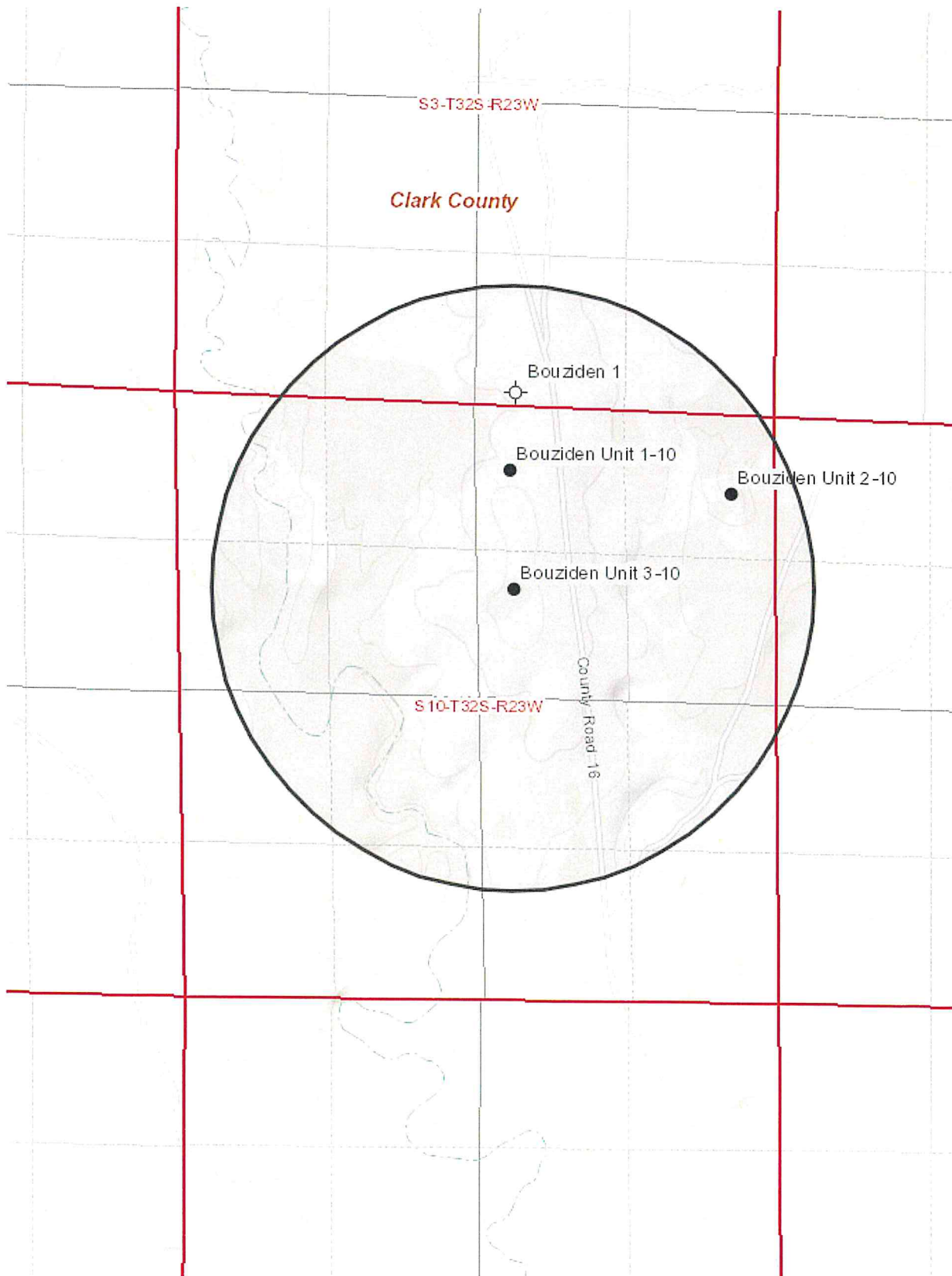

K.C.C. Application Report

Lands:

Township 32 South, Range 23 West

Section 3: S/2S/2

Section 10: All

Section 11: W/2W/2

Clark County, Kansas

Tract	Lessee or Operator	Apparent Mineral Owners
Section 3: S/2S/2 Section 10: All Section 11: W/2W/2	Mull Drilling Company, Inc. 1700 N Waterfront Pkwy, Bldg. 1200 Wichita, KS 67206	

Date: November 15, 2019



LEGAL PROOF OF PUBLICATION

Account #	Ad Number	Identification	PO	Amount	Cols	Lines
453877	0004465097	BEFORE THE STATE CORPORATION COMMIS	Legal notice	\$329.84	1	52

Attention: Risa Carter

MULL DRILLING COMPANY, INC.
1700 N. WATERFRONT PKWY, BUILDING 1200
WICHITA, KS 67206

**BEFORE THE STATE CORPORATION
COMMISSION OF THE STATE OF KANSAS
NOTICE OF FILING APPLICATION**

Re: Mull Drilling Company, Inc. --
Application for order to permit
commingling of production of the
Bouziden Unit #3-10, located in Clark
County, KS; the Cooper #1-12, located in
Rawlins County, KS; the Schippers #1-33,
located in Thomas County, KS.

To: All Oil & Gas Producers, Unleased
Mineral Interest Owners, Landowners, and
all persons whosoever concerned.

You, and each of you, are hereby notified
that Mull Drilling Company, Inc. has filed
an application to commingle production of
the LKC, Cherokee, and Morrow forma-
tions on the Bouziden Unit #3-10,
located SW/4 NE/4 10-32S-23W, Clark
County, KS; the LKC, Marmaton, and
Cherokee formations on the Cooper #1-
12, located NW/4 NW/4 12-5S-33W, Raw-
lins County, KS; the LKC, Pawnee, and
Myrick Station formations on the Schip-
pers #1-33, located SE/4 SW/4 33-10S-
31W, Thomas County, KS.

Any persons who object to or protest this
application shall be required to file their
objections or protests with the Conserva-
tion Division of the State Corporation
Commission of the State of Kansas
within fifteen (15) days from the date of
the publication. These protests shall be
files pursuant to Commission regulations
and must state specific reasons why the
grant of the application may cause
waste, violate correlative rights or pollute
the natural resources of the state of Kan-
sas. If no protests are received, this appli-
cation may be granted through a summa-
ry proceeding. If valid protests are
received, this matter will be set for hear-
ing.

All persons interested or concerned shall
take notice of the foregoing and shall gov-
ern themselves
accordingly.

Mull Drilling Company, Inc.
1700 N. Waterfront Parkway,
Building 1200
Wichita, KS 67206
316-264-6366

In The STATE OF KANSAS
In and for the County of Sedgwick
AFFIDAVIT OF PUBLICATION

1 Insertions

Beginning issue of: 11/20/2019

Ending issue of: 11/20/2019

STATE OF KANSAS)

.SS

County of Sedgwick)

Tony Berg, of lawful age, being first duly
sworn, deposeth and saith: That he is
Record Clerk of The Wichita Eagle, a daily
newspaper published in the City of Wichita,
County of Sedgwick, State of Kansas, and
having a general paid circulation on a daily
basis in said County, which said
newspaper has been continuously and
uninterruptedly published in said County for
more than one year prior to the first
publication of the notice hereinafter
mentioned, and which said newspaper has
been entered as second class mail matter
at the United States Post Office in Wichita,
Kansas, and which said newspaper is not a
trade, religious or fraternal publication and
that a notice of a true copy is hereto
attached was published in the regular and
entire Morning issue of said The Wichita
Eagle from 11/20/2019 to 11/20/2019.

I certify (or declare) under the penalty of
perjury that the foregoing is true and correct.

(Signature of Principal Clerk)

DATED: 11/20/2019

Notary Public Sedgwick County, Kansas

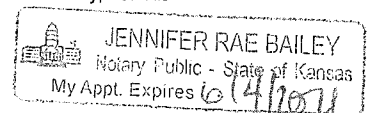

(First published in the Clark County Gazette on Wednesday, November 20, 2019.)

MULL DRILLING COMPANY, INC.
WICHITA, KANSAS

BEFORE THE STATE
CORPORATION COMMISSION OF
THE STATE OF KANSAS
NOTICE OF FILING APPLICATION

Re: Mull Drilling Company, Inc.
– Application for order to permit
commingling of production of the
Bouziden Unit #3-10, located in
Clark County, Kansas.

To: All Oil & Gas Producers,
Unleased Mineral Interest Owners,
Landowners, and all persons
whosoever concerned.

You, and each of you, are hereby notified that Mull Drilling Company, Inc. has filed an application to commingle production of the Lansing-Kansas City, Cherokee, and Morrow formations on the Bouziden Unit #3-10, located SW/4 NE/4 10-32S-23W, Clark County, Kansas.

Any persons who object to or protest this application shall be required to file their objections or protests with the Conservation Division of the State Corporation Commission of the State of Kansas within fifteen (15) days from the date of the publication. These protests shall be files pursuant to Commission regulations and must state specific reasons why the grant of the application may cause waste, violate correlative rights or pollute the natural resources of the state of Kansas. If no protests are received, this application may be granted through a summary proceeding. If valid protests are received, this matter will be set for hearing.

All persons interested or concerned shall take notice of the foregoing

and shall govern themselves accordingly.

Mull Drilling Company, Inc.
1700 N. Waterfront Parkway,
Building 1200
Wichita, KS 67206
316-264-6366

Affidavit of Publication

State of Kansas, County of Clark, ss: Clint D Kuhns, of lawful age, being first duly sworn on oath says that he is the principal clerk – bookkeeper of Clark County Gazette, a weekly newspaper printed and published at Minneola, KS; that said newspaper has the following qualifications: (a) it has been published at least fifty (50) times a year and has so published at least five (5) years prior to the first publication of the attached notice; (b) it is entered at the post office as periodical mail matter; (c) it has a general paid circulation on a weekly basis in said county and it is not a trade, religious or fraternal publication; and (d) it is published in Clark County, Kansas; and that the attached legal notice being a copy of Bouziden #3-10 as per clipping attached, was published in the regular and entire weekly edition of said newspaper and not any supplement thereof for 1 consecutive week(s), the first publication being on the 20th of November, 2019, and the last publication being on the 20th day of November 2019



Subscribed and sworn to before me this 20th day of November, 2019.

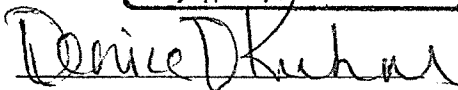

My Appointment Expires: 7/16/23

Publication Fee: 78.00



DRILLING COMPANY, INC. WICHITA, KANSAS

Proposed Wellbore Configuration

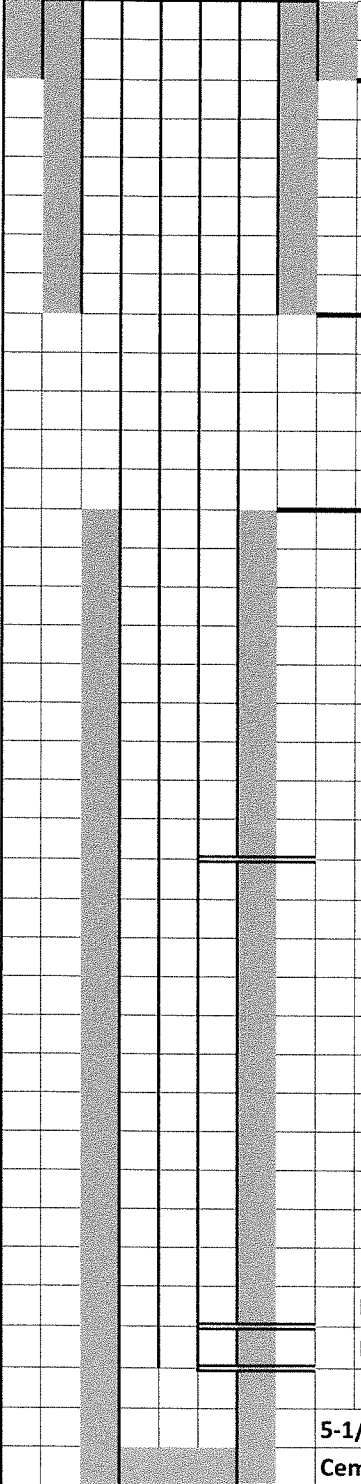
	13-3/8" Conductor Set at 76'	Date:	11/7/2019
	Cmt to surface with 135 sks.	Well Name:	Bouziden Unit #3-10
		Location:	1621' FNL & 2315' FEL
			Section 10-T32S-R23W
		County:	Clark
		State:	Kansas
	8-5/8" Surface set at 619'	API:	15-025-21609
	Cmt to surface w/300 sks.	KB:	2252'
		GL:	2240'
		Spud Date:	7/10/2019

TOC @ 4230 (CBL 8/5/19)

Proposed Lansing-Kansas City Perfs at 4609'-4804'

Proposed Cherokee Perfs at 5340'-5342'
Morrow Perfs at 5372'-78'

5-1/2", 17# casing set at 5423'
Cemented with 235 sks. 50/50 Pozmix



DownHole SAT(tm)
FORMATION WATER CHEMISTRY INPUT

Lansing Water

Mull Drilling
 Bouziden #1
 Wellhead

Pro-Stim Chemicals
 Troy Pelton

Report Date: 03-25-2019 Sampled: 03-10-2019 at 1644
 Sample #: 5644 Sample ID: KCampbell

CATIONS

Calcium (as Ca)	7960
Magnesium (as Mg)	3451
Barium (as Ba)	32.00
Strontium (as Sr)	0.00
Sodium (as Na)	82247
Potassium (as K)	0.00
Lithium (as Li)	0.00
Ammonia (as NH ₃)	0.00
Aluminum (as Al)	0.00
Iron (as Fe)	18.00
Manganese (as Mn)	0.700
Zinc (as Zn)	0.00
Lead (as Pb)	0.00

ANIONS

Chloride (as Cl)	153000
Sulfate (as SO ₄)	250.00
Bromine (as Br)	0.00
Dissolved CO ₂ (as CO ₂)	80.00
Bicarbonate (as HCO ₃)	120.00
Carbonate (as CO ₃)	0.00
Oxalic acid (as C ₂ O ₄)	0.00
Silica (as SiO ₂)	0.00
Phosphate(as PO ₄)	0.00
H ₂ S (as H ₂ S)	0.00
Fluoride (as F)	0.00
Nitrate (as NO ₃)	0.00
Boron (as B)	0.00

PARAMETERS

Calculated T.D.S.	232226
Molar Conductivity	449754
Resistivity	2.22
Sp.Gr.(g/mL)	1.15
Pressure(psia)	14.70
pCO ₂ (psia)	0.00842
pH ₂ S(atm)	0.00
Temperature (°F)	70.00
pH	6.93

CORROSION RATE PREDICTION

CO ₂ - H ₂ S Rate(mpy)	0.00293
--	---------

COMMENTS All anions and cations are in mg/l

FRENCH CREEK SOFTWARE, INC.
1220 VALLEY FORGE ROAD, SUITE 21, VALLEY FORGE, PA 19460



DownHole SAT®
FORMATION WATER CHEMISTRY INPUT

Mull Drilling
Bouziden #3

Pro-Stim Chemicals
Troy Pelton

Morrow Water

Report Date: 08-30-2019
Sample #: 6592

Sampled: 08-23-2019 at 1644
Sample ID: WBaten

CATIONS

Calcium (as Ca)	7760
Magnesium (as Mg)	8165
Barium (as Ba)	93.00
Strontium (as Sr)	0.00
Sodium (as Na)	59646
Potassium (as K)	0.00
Lithium (as Li)	0.00
Ammonia (as NH ₃)	0.00
Aluminum (as Al)	0.00
Iron (as Fe)	310.00
Manganese (as Mn)	2.40
Zinc (as Zn)	0.00
Lead (as Pb)	0.00

ANIONS

Chloride (as Cl)	130900
Sulfate (as SO ₄)	250.00
Bromine (as Br)	0.00
Dissolved CO ₂ (as CO ₂)	425.00
Bicarbonate (as HCO ₃)	220.00
Carbonate (as CO ₃)	0.00
Oxalic acid (as C ₂ O ₄)	0.00
Silica (as SiO ₂)	0.00
Phosphate(as PO ₄)	0.00
H ₂ S (as H ₂ S)	0.00
Fluoride (as F)	0.00
Nitrate (as NO ₃)	0.00
Boron (as B)	0.00

PARAMETERS

Calculated T.D.S.	198733
Molar Conductivity	362113
Resistivity	2.76
Sp.Gr.(g/mL)	1.13
Pressure(psia)	14.70
pCO ₂ (psia)	0.0831
pH ₂ S(atm)	0.00
Temperature (°F)	81.00
pH	5.61

CORROSION RATE PREDICTION

CO ₂ - H ₂ S Rate(mpy)	0.0770
--	--------

COMMENTS All anions and cations are in mg/l

SGB Solutions
5918 S County Road 1273, Midland, TX 79706

Conservation Division
266 N. Main St., Ste. 220
Wichita, KS 67202-1513



Phone: 316-337-6200
Fax: 346-337-6211
<http://kcc.ks.gov/>

Dwight D. Keen, Chair
Shari Feist Albrecht, Commissioner
Susan K. Duffy, Commissioner

Laura Kelly, Governor

December 18, 2019

Mark Shreve
Mull Drilling Co., Inc.
1700 N Waterfront Pkwy, Bldg 1200
Wichita, KS 67206

RE: Approved Commingling CO121909
Bouziden Unit 3-10
API No. 15-025-21609-00-00

Dear Mr. Shreve:

Your Application for Commingling (ACO-4) for the above described well has been reviewed and approved by the Kansas Corporation Commission (KCC) per K.A.R. 82-3-123. Notice was examined and found to be proper per K.A.R. 82-3-135a. No protest had been filed within the 15-day protest period.

Based upon the depth of the Morrow formation perforations, total oil production shall not exceed 200 BOPD and total gas production shall not exceed 50% of the absolute open flow (AOF).

File form ACO-1 upon re-completion of the well to commingle.

Sincerely,

Rick Hestermann
Production Department