

Proposed Plan of Construction

Lester 3
Sec 33 T27S-R34W
Haskell County, KS

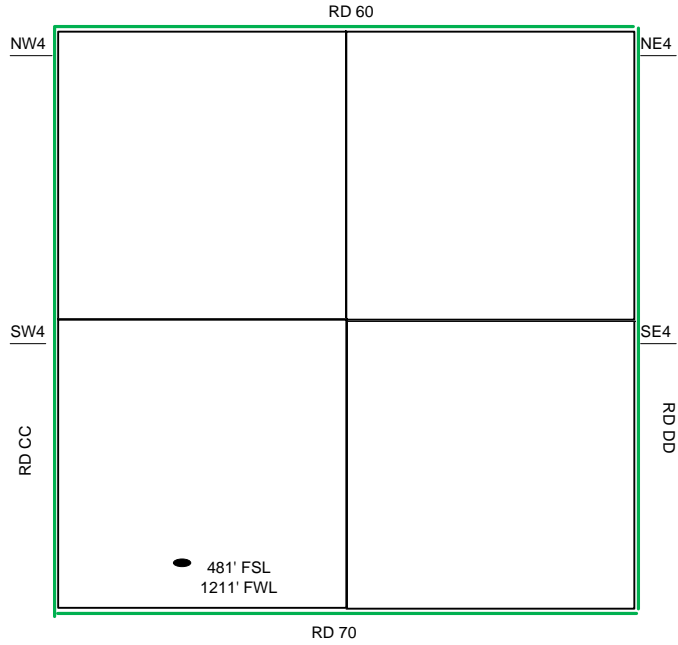

Sec 33 - T27S - R34W

SW/4

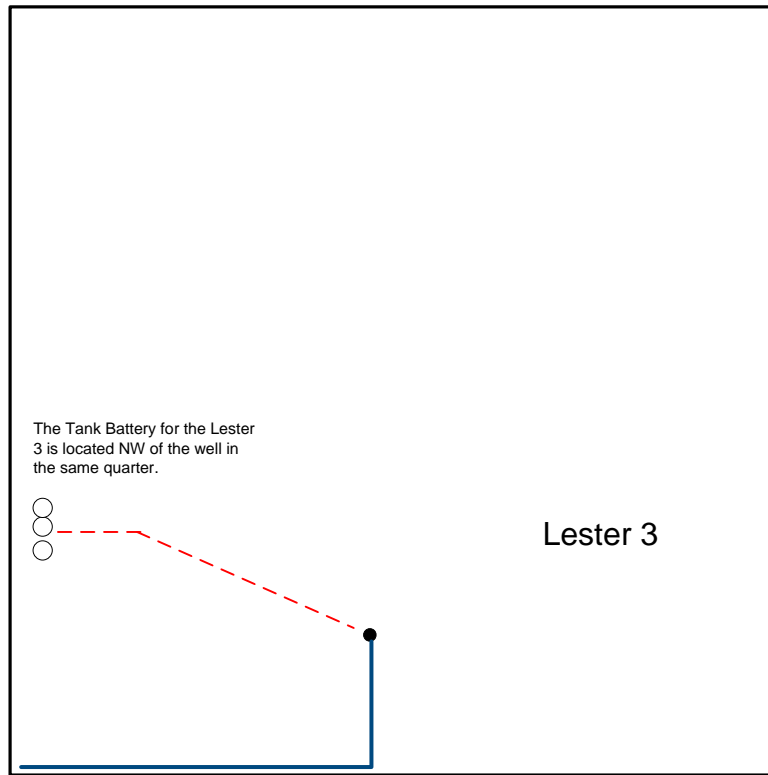

The Tank Battery for the Lester 3 is located NW of the well in the same quarter.

- Well Location
- Proposed Lease Roads
- Proposed Pipeline
- Proposed Tank Battery
- Proposed Power Lines
- Existing Pipeline

Proposed Details of
SW/4 Sec 33 - T27S - R34W

Note-Drawing **Not** to Scale