

**JEL RESOURCES, LLC**  
**LYDA RUTTI LEASE**  
 SW. 1/4, SECTION 9, T22S, R13W  
 STAFFORD COUNTY, KANSAS

**HIGHWAY 19**

**Notes:**

1. Set (2) wood stakes at location site.
2. All flagging Red & Yellow.
3. Overhead power available at N. & W. lines and E. 1/2 of S. line, Sec. 9.
4. Kansas One Call System Inc. should be notified before excavation (1-800-344-7233).
5. CAUTION; Various pipelines in Sec. 9.
6. Contact landowner for best access.

\*Ingress and egress to location as shown on this plot is per usage only and may not be legally opened for public use. Contact landowner, tenant and county road department for access.

SAND (NW. 10TH AVE.) ROAD

281 (N. HWY. 281)

HIGHWAY

**9**

**Drillsite Location**  
**Lyda Rutti #1-9**  
**600'FSL 990'FWL**  
**Ground Elevation = 1895**

**Y = 538923 X = 1924508**

State Plane-NAD 27-Kansas South

Latitude 38.14650

Longitude -98.76288

WGS 84-NAD 83

APPROX LOCATION  
 CENTER PIVOT IRR.  
 SYSTEM

DIRT TRAIL  
 FLAGGED TRAIL

STUBBLE

PIVOT SYSTEM WHEEL  
 TRACK 86'NE. &  
 94'SW. OF LOC.

Set Wood Stake  
 (Proposed)  
 Reserve Pit  
 325'FSL 230'FWL

SAND (NW. 130TH ST.) ROAD

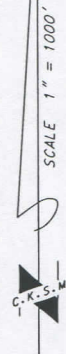
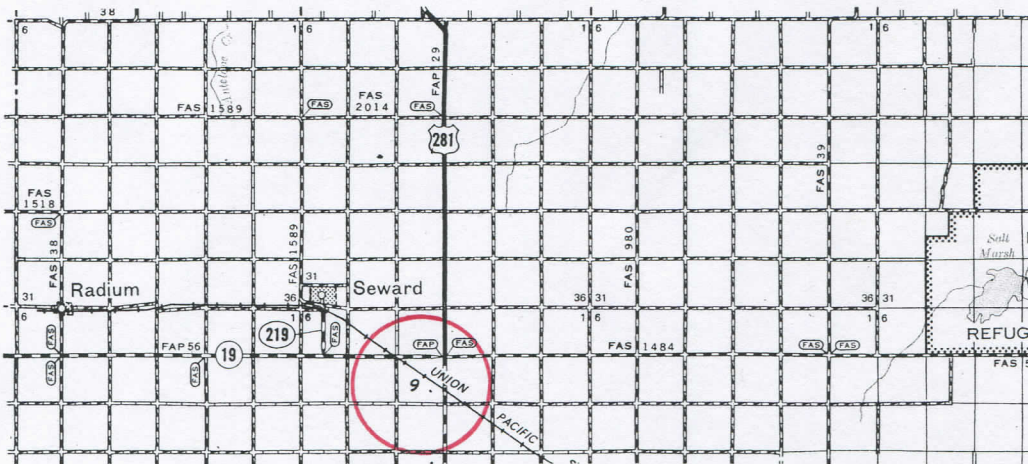

\* Controlling data is based upon the best maps and photographs available to us and upon a regular section of land containing 640 acres.

\* Approximate section lines were determined using the normal standard of care of oilfield surveyors practicing in the state of Kansas. The section corners, which establish the precise section lines, were not necessarily located, and the exact location of the drillsite location in the section is not guaranteed. Therefore, the operator securing this service and accepting this plot and all other parties relying thereon agree to hold Central Kansas Oilfield Services, Inc., its officers and employees harmless from all losses, costs and expenses and said entities released from any liability from incidental or consequential damages.

\* Elevations derived from National Geodetic Vertical Datum.

Date January 21, 2020

**CENTRAL KANSAS OILFIELD SERVICES, INC. (620)792-1977**