

KANSAS CORPORATION COMMISSION
OIL & GAS CONSERVATION DIVISION

Form ACO-4
Form must be typed
March 2009

APPLICATION FOR COMMINGLING OF PRODUCTION (K.A.R. 82-3-123) OR FLUIDS (K.A.R. 82-3-123a) *Commingling ID #* _____

OPERATOR: License # _____ API No. 15 - _____
Name: _____ Spot Description: _____
Address 1: _____ - - - - - Sec. _____ Twp. _____ S. R. _____ East West
Address 2: _____ Feet from North / South Line of Section
City: _____ State: _____ Zip: _____ + _____ Feet from East / West Line of Section
Contact Person: _____ County: _____
Phone: (_____) _____ Lease Name: _____ Well #: _____

1. Name and upper and lower limit of each production interval to be commingled:
Formation: _____ (Perfs): _____
Formation: _____ (Perfs): _____
Formation: _____ (Perfs): _____
Formation: _____ (Perfs): _____
Formation: _____ (Perfs): _____

2. Estimated amount of fluid production to be commingled from each interval:
Formation: _____ BOPD: _____ MCFPD: _____ BWPD: _____
Formation: _____ BOPD: _____ MCFPD: _____ BWPD: _____
Formation: _____ BOPD: _____ MCFPD: _____ BWPD: _____
Formation: _____ BOPD: _____ MCFPD: _____ BWPD: _____
Formation: _____ BOPD: _____ MCFPD: _____ BWPD: _____

3. Plat map showing the location of the subject well, all other wells on the subject lease, and all wells on offsetting leases within a 1/2 mile radius of the subject well, and for each well the names and addresses of the lessee of record or operator.

4. Signed certificate showing service of the application and affidavit of publication as required in K.A.R. 82-3-135a.

For Commingling of PRODUCTION ONLY, include the following:

- 5. Wireline log of subject well. Previously Filed with ACO-1: Yes No
- 6. Complete Form ACO-1 (*Well Completion form*) for the subject well.

For Commingling of FLUIDS ONLY, include the following:

- 7. Well construction diagram of subject well.
- 8. Any available water chemistry data demonstrating the compatibility of the fluids to be commingled.

AFFIDAVIT: I am the affiant and hereby certify that to the best of my current information, knowledge and personal belief, this request for commingling is true and proper and I have no information or knowledge, which is inconsistent with the information supplied in this application.

Submitted Electronically

KCC Office Use Only
 Denied Approved
15-Day Periods Ends: _____
Approved By: _____ Date: _____

Protests may be filed by any party having a valid interest in the application. Protests must be in writing and comply with K.A.R. 82-3-135b and must be filed within 15 days of publication of the notice of application.

*BEFORE THE STATE CORPORATION
COMMISSION OF THE STATE OF KANSAS:
NOTICE OF FILING APPLICATION FOR COMMINGLING OF PRODUCTION*

January 30, 2020

RE: F.G. Holl Company, L.L.C. – Application for order to commingle production from the Lansing-Kansas City and the Arbuckle Formations at the ILS Land “A” #1-1, Barton County, Kansas.

TO: All Oil and Gas Producers, Unleased Mineral Interest Owners, Landowners, and all persons whosoever concerned.

You, and each one of you, are hereby notified that F.G. Holl Company, L.L.C. has filed an application to commingle production from the Lansing-Kansas City and the Arbuckle Formations at its ILS Land “A” #1-1 well, located 30' S. & 130' E. of C SE NW NE/4 Sec. 1-19S-14W, Barton County, Kansas.

Any persons who object or protest against this application shall be required to file their concerns with the Conservation Division of the State Corporation Commission of the State of Kansas within 15 days from the date of the publication. These protests shall be filed pursuant to Commission’s regulations and must state specific reasons why the grant of the application may cause waste, violate correlative rights or pollute the natural resources of the state of Kansas. If no protests are received, this application may be granted through a summary proceeding. If valid protests are received, this matter will be set for hearing.

All persons interested or concerned shall take notice of the foregoing and shall govern themselves accordingly.

F.G. Holl Company, L.L.C
9431 E. Central, Suite 100,
Wichita, KS. 67206
(316) 684-8481

Operator, Lessee or Unleased Mineral Owners
Within a ½ mile radius of F.G. Holl Company, LLC

ILS Land "A" #1-1
30' S. & 130' E. of C SE NW NE/4
Section 1-19S-14W
Barton County, KS.

Notice of Commingling of Production

F.G. Holl Company, LLC is filing with the Kansas Corporation Commission, Oil & Gas Conservation Division Application for Commingling of Production from Lansing-Kansas City & Arbuckle rock Formations. Pursuant to K.A.R. 82-3-135a (b), you are hereby notified of such action.

Names and addresses of leased & un-leased mineral owners & acreage within a ½ mile radius of subject well:

ILS Land, L.L.C. , P.O. Box 1506, Great Bend, KS. 67530: NE/4 & E/2 SE/4 of Sec.1-19S14W, Barton County, KS.

Central Kansas Ag, L.L.C, P.O. Box 894, Great Bend, KS. 67530: NW/4 Sec. 6-19S-13W

Kyle Morrison, Et al., Attention: Glenn Opie Law Office, 10343 S. Highland Cir., Oletha, Kansas 66061 (NW/4 & W/2 SE/4 Sec. 1-19S-14W).

Great Bend Feeding, Inc., 355 NW 30 Avenue, Great Bend, KS. 67530: SW/4 Sec. 1-19S-14W.

J & J Lang Family Trust, 861 NW 40 Avenue, Hoisington, KS. 67544: SE/4 Sec. 36-18S-14W – Land-owner.

Daryl J. Stoss, 264 NW 50 Road, Great Bend, KS.67530: SW/4 Sec. 36-18S-14W – Land-owner.

Pollie A. Unruh, 3511 23 Street, Great Bend, KS. 67530 : W/2 SW/4 of Sec. 31-18S-13W.

RJM, P.O. Box 256, Claflin, KS. 67525: SW/4 Sec. 6-19S-13W.

Certificate of Service for Commingling of Production

Operator, Lessee or Unleased Mineral Owners
Within a ½ mile radius of F.G. Holl Company, LLC

ILS Land "A" #1-1
30' S. & 130' E. of C SE NW NE/4
Section 1-19S-14W
Barton County, KS.

Pursuant to K.A.R. 82-3-135a (b), F.G. Holl Company is hereby providing Certificate of Service for notifications served notifying commingling of production from Lansing-Kansas City & Arbuckle at the ILS Land "A" #1-1 as follows:

Name and address of leased and un-leased mineral owner & corresponding acreage within a ½ mile radius of subject well:

ILS Land, L.L.C. , P.O. Box 1506, Great Bend, KS. 67530: NE/4 & E/2 SE/4 of Sec.1-19S14W, Barton County, KS.

Central Kansas Ag, L.L.C, P.O. Box 894, Great Bend, KS. 67530: NW/4 Sec. 6-19S-13W

Kyle Morrison, Et al., Attention: Glenn Opie Law Office, 10343 S. Highland Cir., Oleta, Kansas 66061 (NW/4 & W/2 SE/4 Sec. 1-19S-14W).

Great Bend Feeding, Inc., 355 NW 30 Avenue, Great Bend, KS. 67530: SW/4 Sec. 1-19S-14W.

J & J Lang Family Trust, 861 NW 40 Avenue, Hoisington, KS. 67544: SE/4 Sec. 36-18S-14W – Land-owner.

Daryl J. Stoss, 264 NW 50 Road, Great Bend, KS.67530: SW/4 Sec. 36-18S-14W – Land-owner.

Pollie A. Unruh, 3511 23 Street, Great Bend, KS. 67530 : W/2 SW/4 of Sec. 31-18S-13W.

RJM, P.O. Box 256, Claflin, KS. 67525: SW/4 Sec. 6-19S-13W.

Signature: 
Applicant or Duly Authorized Agent - Loveness Mpanje

State of Kansas _____)
County of Sedgwick _____)

This instrument was acknowledged before me on this 30th day of January, 2020 by Loveness Mpanje

Notary Public: 
BETTY H. SPOTSWOOD

My Commission Expires: 4/30/2022



Verification

State of Kansas)

) ss:

County of Sedgwick)

Loveness Mpanje, of lawful age being first duly sworn, upon oath states:

That she has the authority on behalf of Operator to file this Commingling of Production application, has read the application, knows the contents, and knows all of the statements and details in the application are true and correct.

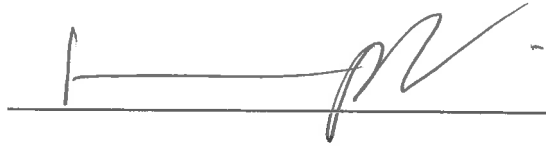

Signature of Submitter

Subscribed and sworn to before me this 30th day of January, 2020.

BETTY H. Spotswood
Notary Public



My appointment expires: 4/30/2022

ILS LAND "A" 1-1

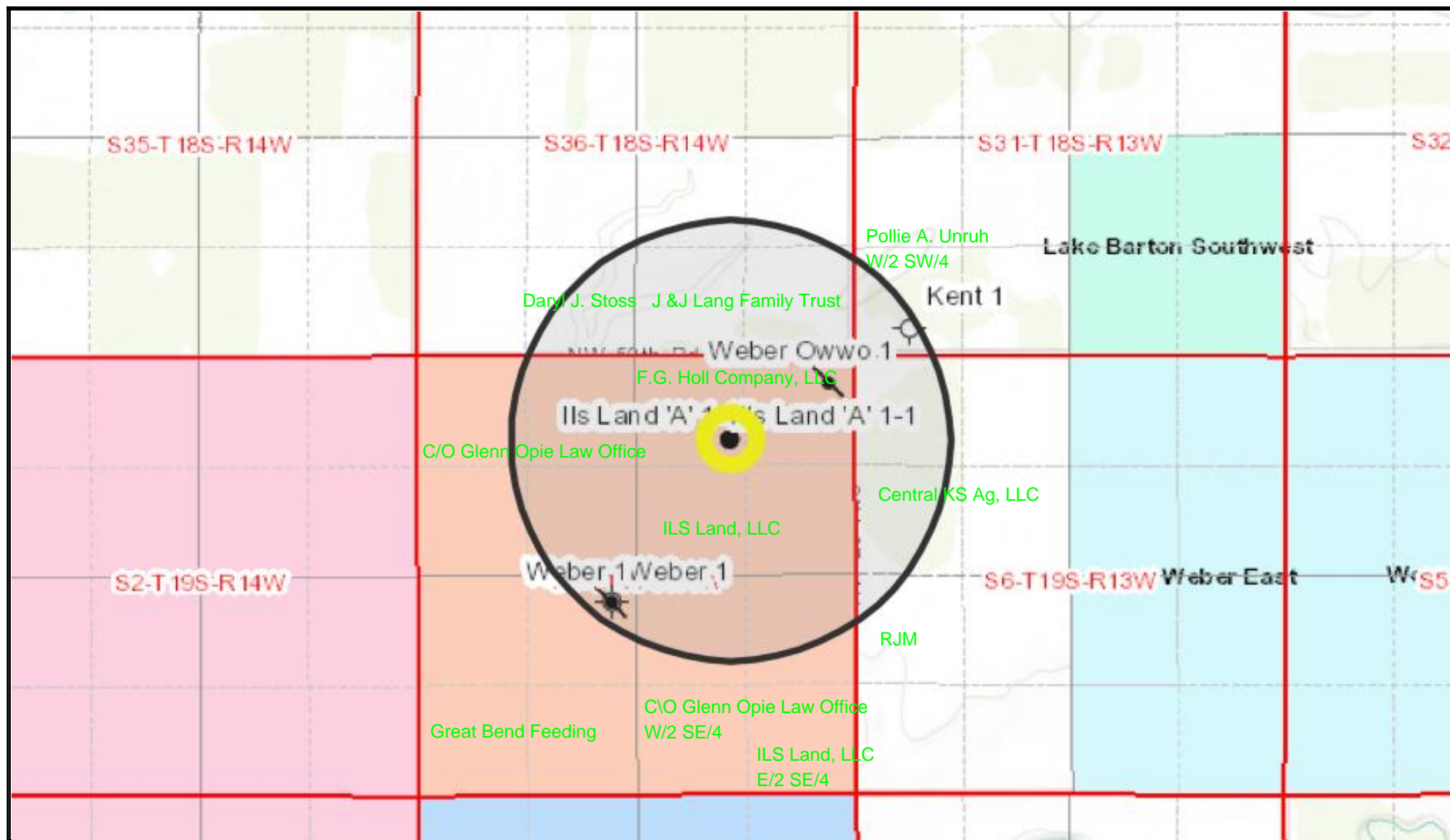

Oil and Gas Wells

- | | | | | |
|---------------------------------------|--|--------------------------------|----------------------------------|--|
| ● Coal Bed Methane | ⊗ Enhanced Oil Recovery, Plugged-Abandoned | ⊗ Injection, Plugged-Abandoned | ⊗ Oil and Gas, Plugged-Abandoned | ⊗ Other, Plugged-Abandoned |
| ● Coal Bed Methane, Plugged-Abandoned | ⊗ Gas | ○ Intent | ● Oil | ⊗ Salt Water Disposal |
| ⊗ Dry and Abandoned | ⊗ Gas, Plugged-Abandoned | ○ Location | ⊗ Oil, Plugged-Abandoned | ⊗ Salt Water Disposal, Plugged-Abandoned |
| ⊗ Enhanced Oil Recovery | ⊗ Injection | ⊗ Oil and Gas | ⊗ Other | |

1/17/2020

<https://maps.kgs.ku.edu/oilgas>

**GREAT BEND TRIBUNE
2012 FOREST AVENUE
Great Bend, KS 67530**

*F.G. Holl Company, L.L.C.
9431 E. Central
Suite 100
WICHITA KS 67206

I, Jana K Hestand, Business Manager, of the

Great Bend Tribune, Great Bend, KS, published in the English language, and having a bona fide list of paid subscribers located in the aforementioned City, and with a general circulation in Great Bend and the area entered as a second class matter under the Postal Laws and Regulation of the United States of America for 52 successive weeks or more prior to the issue of

2/2/2020, certify that the notice of "ILS Land "A" #1-1" attached hereto has been published in said newspaper and online for 2 issues(s) consecutive, commencing with the issue of **2/2/2020**

Jana K Hestand

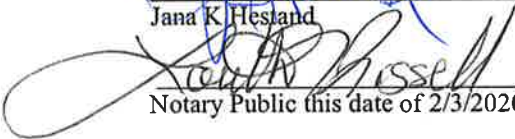
Notary Public this date of 2/3/2020

 **State of Kansas -Notary Public**
Loretta Russell
My Commission Expires 9/8/22

Name	*F.G. Holl Company, L.L.C.
Order Number	44299
Order Date	1/31/2020
Number Issues	2
Pub Count	2
First Issue	2/2/2020
Last Issue	2/2/2020
Order Price	\$39.22
Publications	01 Tribune, 02 Online
Pub Dates	01 Tribune: 2/2/2020 02 Online: 2/2/2020

Proof of Publication

(First published in the Great Bend Tribune on February 2, 2020)1T

BEFORE THE STATE CORPORATION COMMISSION OF THE STATE OF KANSAS: NOTICE OF FILING APPLICATION FOR COMMINGLING OF PRODUCTION

January 30, 2020

RE: F.G. Holl Company, L.L.C. – Application for order to commingle production from the Lansing-Kansas City and the Arbuckle Formations at the ILS Land "A" #1-1, Barton County, Kansas.

TO: All Oil and Gas Producers, Unleased Mineral Interest Owners, Landowners, and all persons whosoever concerned.

You, and each one of you, are hereby notified that F.G. Holl Company, L.L.C. has filed an application to commingle production from the Lansing-Kansas City and the Arbuckle Formations at its ILS Land "A" #1-1well, located 30' S. & 130' E. of C SE NW NE/4 Sec. 1-19S-14W, Barton County, Kansas.

Any persons who object or protest against this application shall be required to file their concerns with the Conservation Division of the State Corporation Commission of the State of Kansas within 15 days from the date of the publication. These protests shall be filed pursuant to Commission's regulations and must state specific reasons why the grant of the application may cause waste, violate correlative rights or pollute the natural resources of the state of Kansas. If no protests are received, this application may be granted through a summary proceeding. If valid protests are received, this matter will be set for hearing.

All persons interested or concerned shall take notice of the foregoing and shall govern themselves accordingly.

F.G. Holl Company, L.L.C
9431 E. Central, Suite 100,
Wichita, KS. 67206
(316) 684-8481

(First published in the Great Bend Tribune on February 2, 2020)1T

BEFORE THE STATE CORPORATION COMMISSION OF THE STATE OF KANSAS: NOTICE OF FILING APPLICATION FOR COMMINGLING OF PRODUCTION

January 30, 2020

RE: F.G. Holl Company, L.L.C. – Application for order to commingle production from the Lansing-Kansas City and the Arbuckle Formations at the ILS Land "A" #1-1, Barton County, Kansas.

TO: All Oil and Gas Producers, Unleased Mineral Interest Owners, Landowners, and all persons whosoever concerned.

You, and each one of you, are hereby notified that F.G. Holl Company, L.L.C. has filed an application to commingle production from the Lansing-Kansas City and the Arbuckle Formations at its ILS Land "A" #1-1well, located 30' S. & 130' E. of C SE NW NE/4 Sec. 1-19S-14W, Barton County, Kansas.

Any persons who object or protest against this application shall be required to file their concerns with the Conservation Division of the State Corporation Commission of the State of Kansas within 15 days from the date of the publication. These protests shall be filed pursuant to Commission's regulations and must state specific reasons why the grant of the application may cause waste, violate correlative rights or pollute the natural resources of the state of Kansas. If no protests are received, this application may be granted through a summary proceeding. If valid protests are received, this matter will be set for hearing.

All persons interested or concerned shall take notice of the foregoing and shall govern themselves accordingly.

F.G. Holl Company, L.L.C
9431 E. Central, Suite 100,
Wichita, KS. 67206
(316) 684-8481



AFFIDAVIT OF PUBLICATION

Account #	Ad Number	Identification	PO	Amount	Cols	Depth
453711	0004550117	BEFORE THE STATE CORPORATION COMMIS	Legal Notice	\$270.15	1	4.50 In

Attention: Loveness Mpanje

F.G. HOLL COMPANY, LLC
9431 E CENTRAL AVE STE 100
WICHITA, KS 67206

In The STATE OF KANSAS
In and for the County of Sedgwick
AFFIDAVIT OF PUBLICATION

1 Insertions

Beginning issue of: 02/02/2020

Ending issue of: 02/02/2020

STATE OF KANSAS)

.SS

County of Sedgwick)

VICTORIA RODELA, of lawful age, being first duly sworn, deposeth and saith: That he is Record Clerk of The Wichita Eagle, a daily newspaper published in the City of Wichita, County of Sedgwick, State of Kansas, and having a general paid circulation on a daily basis in said County, which said newspaper has been continuously and uninterruptedly published in said County for more than one year prior to the first publication of the notice hereinafter mentioned, and which said newspaper has been entered as second class mail matter at the United States Post Office in Wichita, Kansas, and which said newspaper is not a trade, religious or fraternal publication and that a notice of a true copy is hereto attached was published in the regular and entire Morning issue of said The Wichita Eagle from 2/2/2020 to 02/02/2020.

I certify (or declare) under the penalty of perjury that the foregoing is true and correct.

V Rodela

Signature of Principal Clerk

DATED: 2/12/2020

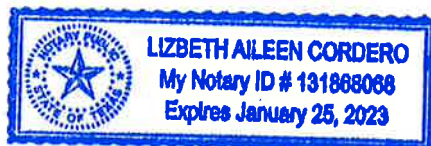

Lizbeth Aileen Cordero

Notary Public Dallas County, Texas

Extra charge for lost or duplicate affidavits.
Legal document please do not destroy!

BEFORE THE STATE CORPORATION
COMMISSION OF THE STATE OF
KANSAS:

NOTICE OF FILING APPLICATION FOR
COMMINGLING OF PRODUCTION

January 30, 2020

**RE: F.G. Holl Company, L.L.C. – Appli-
cation for order to commingle production
from the Lansing-Kansas City and the
Arbuckle Formations at the ILS Land "A"
#1-1, Barton County, Kansas.**

TO: All Oil and Gas Producers, Unleased
Mineral Interest Owners, Landowners, and
all persons whosoever concerned.

You, and each one of you, are hereby noti-
fied that F.G. Holl Company, L.L.C. has
filed an application to commingle produc-
tion from the Lansing-Kansas City and the
Arbuckle Formations at its ILS Land "A"
#1-1 well, located 30' S. & 130' E. of C SE
NW NE/4 Sec. 1-19S-14W, Barton County,
Kansas.

Any persons who object or protest against
this application shall be required to file
their concerns with the Conservation Divi-
sion of the State Corporation Commission
of the State of Kansas within 15 days from
the date of the publication. These protests
shall be filed pursuant to Commission's
regulations and must state specific rea-
sons why the grant of the application may
cause waste, violate correlative rights or
pollute the natural resources of the state
of Kansas. If no protests are received, this
application may be granted through a
summary proceeding. If valid protests are
received, this matter will be set for
hearing.

All persons interested or concerned shall
take notice of the foregoing and shall
govern themselves accordingly.

F.G. Holl Company, L.L.C.
9431 E. Central, Suite 100,
Wichita, KS. 67206
(316) 684-8481



AFFIDAVIT OF PUBLICATION

Account #	Ad Number	Identification	PO	Amount	Cols	Depth
453711	0004550117	BEFORE THE STATE CORPORATION COMMIS	Legal Notice	\$270.15	1	4.50 In

Attention: Loveness Mpanje

F.G. HOLL COMPANY, LLC
9431 E CENTRAL AVE STE 100
WICHITA, KS 67206

In The STATE OF KANSAS
In and for the County of Sedgwick
AFFIDAVIT OF PUBLICATION

1 Insertions

Beginning issue of: 02/02/2020

Ending issue of: 02/02/2020

STATE OF KANSAS)

.SS

County of Sedgwick)

VICTORIA RODELA, of lawful age, being first duly sworn, deposeth and saith: That he is Record Clerk of The Wichita Eagle, a daily newspaper published in the City of Wichita, County of Sedgwick, State of Kansas, and having a general paid circulation on a daily basis in said County, which said newspaper has been continuously and uninterruptedly published in said County for more than one year prior to the first publication of the notice hereinafter mentioned, and which said newspaper has been entered as second class mail matter at the United States Post Office in Wichita, Kansas, and which said newspaper is not a trade, religious or fraternal publication and that a notice of a true copy is hereto attached was published in the regular and entire Morning issue of said The Wichita Eagle from 2/2/2020 to 02/02/2020.

I certify (or declare) under the penalty of perjury that the foregoing is true and correct.

V Rodela

Signature of Principal Clerk

DATED: 2/12/2020

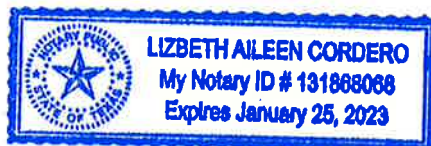

Lizbeth Aileen Cordero

Notary Public Dallas County, Texas

Extra charge for lost or duplicate affidavits.
Legal document please do not destroy!

BEFORE THE STATE CORPORATION
COMMISSION OF THE STATE OF
KANSAS:

NOTICE OF FILING APPLICATION FOR
COMMINGLING OF PRODUCTION

January 30, 2020

**RE: F.G. Holl Company, L.L.C. – Appli-
cation for order to commingle production
from the Lansing-Kansas City and the
Arbuckle Formations at the ILS Land "A"
#1-1, Barton County, Kansas.**

TO: All Oil and Gas Producers, Unleased
Mineral Interest Owners, Landowners, and
all persons whosoever concerned.

You, and each one of you, are hereby noti-
fied that F.G. Holl Company, L.L.C. has
filed an application to commingle produc-
tion from the Lansing-Kansas City and the
Arbuckle Formations at its ILS Land "A"
#1-1 well, located 30' S. & 130' E. of C SE
NW NE/4 Sec. 1-19S-14W, Barton County,
Kansas.

Any persons who object or protest against
this application shall be required to file
their concerns with the Conservation Divi-
sion of the State Corporation Commission
of the State of Kansas within 15 days from
the date of the publication. These protests
shall be filed pursuant to Commission's
regulations and must state specific rea-
sons why the grant of the application may
cause waste, violate correlative rights or
pollute the natural resources of the state
of Kansas. If no protests are received, this
application may be granted through a
summary proceeding. If valid protests are
received, this matter will be set for
hearing.

All persons interested or concerned shall
take notice of the foregoing and shall
govern themselves accordingly.

F.G. Holl Company, L.L.C.
9431 E. Central, Suite 100,
Wichita, KS. 67206
(316) 684-8481

Conservation Division
266 N. Main St., Ste. 220
Wichita, KS 67202-1513



Phone: 316-337-6200
Fax: 316-337-6211
<http://kcc.ks.gov/>

Susan K. Duffy, Chair
Shari Feist Albrecht, Commissioner
Dwight D. Keen, Commissioner

Laura Kelly, Governor

February 17, 2020

Loveness Mpanje
F. G. Holl Company LLC
9431 E Central, Ste 100
Wichita, KS 64206-2563

RE: Approved Commingling CO022001
ILS Land A 1-1
API No. 15-009-26209-00-01

Dear Ms. Mpanje:

Your Application for Commingling (ACO-4) for the above described well has been reviewed and approved by the Kansas Corporation Commission (KCC) per K.A.R. 82-3-123. Notice was examined and found to be proper per K.A.R. 82-3-135a. No protest had been filed within the 15-day protest period.

Based upon the depth of the Arbuckle formation perforations, total oil production shall not exceed 100 BOPD and total gas production shall not exceed 50% of the absolute open flow (AOF).

Sincerely,

Rick Hestermann
Production Department