

KANSAS CORPORATION COMMISSION
OIL & GAS CONSERVATION DIVISION

Form ACO-4
Form must be typed
March 2009

APPLICATION FOR COMMINGLING OF PRODUCTION (K.A.R. 82-3-123) OR FLUIDS (K.A.R. 82-3-123a) *Commingling ID #* _____

OPERATOR: License # _____ API No. 15 - _____
Name: _____ Spot Description: _____
Address 1: _____ - - - - - Sec. _____ Twp. _____ S. R. _____ East West
Address 2: _____ Feet from North / South Line of Section
City: _____ State: _____ Zip: _____ + _____ Feet from East / West Line of Section
Contact Person: _____ County: _____
Phone: (_____) _____ Lease Name: _____ Well #: _____

1. Name and upper and lower limit of each production interval to be commingled:
Formation: _____ (Perfs): _____
Formation: _____ (Perfs): _____
Formation: _____ (Perfs): _____
Formation: _____ (Perfs): _____
Formation: _____ (Perfs): _____

2. Estimated amount of fluid production to be commingled from each interval:
Formation: _____ BOPD: _____ MCFPD: _____ BWPD: _____
Formation: _____ BOPD: _____ MCFPD: _____ BWPD: _____
Formation: _____ BOPD: _____ MCFPD: _____ BWPD: _____
Formation: _____ BOPD: _____ MCFPD: _____ BWPD: _____
Formation: _____ BOPD: _____ MCFPD: _____ BWPD: _____

3. Plat map showing the location of the subject well, all other wells on the subject lease, and all wells on offsetting leases within a 1/2 mile radius of the subject well, and for each well the names and addresses of the lessee of record or operator.

4. Signed certificate showing service of the application and affidavit of publication as required in K.A.R. 82-3-135a.

For Commingling of PRODUCTION ONLY, include the following:

- 5. Wireline log of subject well. Previously Filed with ACO-1: Yes No
- 6. Complete Form ACO-1 (*Well Completion form*) for the subject well.

For Commingling of FLUIDS ONLY, include the following:

- 7. Well construction diagram of subject well.
- 8. Any available water chemistry data demonstrating the compatibility of the fluids to be commingled.

AFFIDAVIT: I am the affiant and hereby certify that to the best of my current information, knowledge and personal belief, this request for commingling is true and proper and I have no information or knowledge, which is inconsistent with the information supplied in this application.

Submitted Electronically

KCC Office Use Only
 Denied Approved
15-Day Periods Ends: _____
Approved By: _____ Date: _____

Protests may be filed by any party having a valid interest in the application. Protests must be in writing and comply with K.A.R. 82-3-135b and must be filed within 15 days of publication of the notice of application.

AFFIDAVIT

STATE OF KANSAS)
 - SS.
County of Sedgwick)

Peter Fiorini, of lawful age, being first duly sworn, deposeth and saith: That he is Geologist/Production Manager of Ritchie Exploration, County of Sedgwick, State of Kansas, and that notice was given to all lessee of record or operator within ½ mile radius of the Wilbur Unit #1 well located in the County of Wichita (see attached plat map). This notice included a letter regarding the Commingle Application. All notices were mailed on May 11, 2020.

made as aforesaid on the 11th of

May A.D. 2020

And affiant further says that he has personal knowledge of the statements above set forth and that they are true.

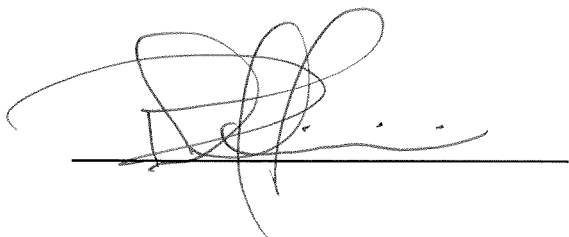

Subscribed and sworn to before me this

11th day of May 2020

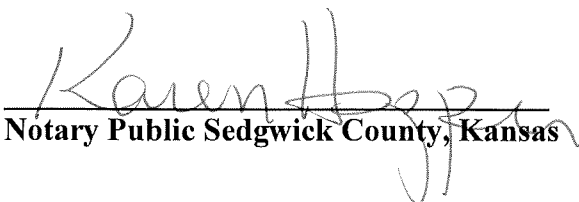

Notary Public Sedgwick County, Kansas





LEGAL PROOF OF PUBLICATION

Account #	Ad Number	Identification	PO	Amount	Cols	Lines
453699	0004645881	LEGAL NOTICE You, and each of you, are hereby	LEGAL NOTICE	\$196.44	1	32

Attention: Karen Hopper
RITCHIE EXPLORATION INC
P O BOX 783188
WICHITA, KS 672783188

LEGAL NOTICE

You, and each of you, are hereby notified that Ritchie Exploration, Inc. has filed an application to commence the commingling of production from the Altamont and Pawnee sources of supply for the #1 Wilbur Unit well located approx. SE NE SW of Section 7-17S-36W, Wichita County, Kansas.

Any persons who object to or protest this application shall be required to file their objections or protests with the Conservation Division of the State Corporation Commission of the State of Kansas within fifteen (15) days from the date of the publication. These protests shall be filed pursuant to Commission regulations and must state specific reasons why the grant of the application may cause waste, violate correlative rights or pollute the natural resources of the state of Kansas. If no protests are received, this application may be granted through a summary proceeding. If valid protests are received, this matter will be set for hearing.

All persons interested or concerned shall take notice of the foregoing and shall govern themselves accordingly.
RITCHIE EXPLORATION, INC.
P.O. Box 783188
Wichita, KS 67278-3188
(316) 691-9500

In The STATE OF KANSAS
In and for the County of Sedgwick
AFFIDAVIT OF PUBLICATION

1 Insertions

Beginning issue of: 05/13/2020

Ending issue of: 05/13/2020

STATE OF KANSAS)
.SS

County of Sedgwick)

Tony Berg, of lawful age, being first duly sworn, deposeth and saith: That he is Record Clerk of The Wichita Eagle, a daily newspaper published in the City of Wichita, County of Sedgwick, State of Kansas, and having a general paid circulation on a daily basis in said County, which said newspaper has been continuously and uninterruptedly published in said County for more than one year prior to the first publication of the notice hereinafter mentioned, and which said newspaper has been entered as second class mail matter at the United States Post Office in Wichita, Kansas, and which said newspaper is not a trade, religious or fraternal publication and that a notice of a true copy is hereto attached was published in the regular and entire Morning issue of said The Wichita Eagle from 5/13/2020 to 05/13/2020.

I certify (or declare) under the penalty of perjury that the foregoing is true and correct.

(Signature of Principal Clerk)

DATED: 5/18/2020

Notary Public Sedgwick County, Kansas

JENNIFER RAE BAILEY
Notary Public - State of Kansas
My Appt. Expires 05/18/2021

Proof of Publication

State of Kansas
County of Wichita, ss:

Rob Taylor, of lawful age, being duly sworn upon oath states that he is the editor of **THE WICHITA COUNTY NATIVE SUN**, formerly known as *The Leoti Standard*.

THAT said newspaper has been published at least weekly 50 times a year and has been so published for at least five years prior to the first publication of the attached notice.

THAT said newspaper was entered as second class matter at the post office of its publication;

THAT said newspaper has a general paid circulation on a daily, weekly, monthly, or yearly basis in WICHITA County, Kansas, and is NOT a trade, religious, or fraternal publication and has been printed and published in WICHITA County, Kansas.

THE ATTACHED was published on the following dates in a regular issue of said newspaper:

1st Publication was made on the 20th day of May, 2020.

Publication Fee	\$46.80
Affidavit, Notary's Fees	\$0.00
Additional Copies (0 @ \$2.00)	\$0.00
Total Publication Fee	\$46.80

(Signed)

Witness my hand this ___ day of _____, 20__.

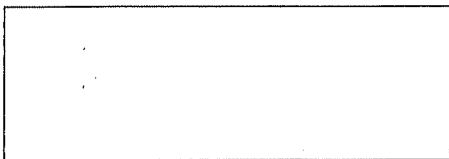

SUBSCRIBED and SWORN to before me this ___ day of _____, 20__.

(Notary Public)

My commission expires _____

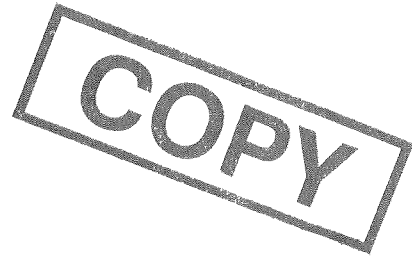

[First published in *The Wichita County Native Sun*, Wednesday, May 20, 2020.]

LEGAL NOTICE

You, and each of you, are hereby notified that Ritchie Exploration, Inc. has filed an application to commence the commingling of production from the Altamont and Pawnee sources of supply for the #1 Wilbur Unit well located approx. SE NE SW of Section 7-17S-36W, Wichita County, Kansas.

Any persons who object to or protest this application shall be required to file their objections or protests with the Conservation Division of the State Corporation Commission of the State of Kansas within fifteen (15) days from the date of the publication. These protests

shall be filed pursuant to Commission regulations and must state specific reasons why the grant of the application may cause waste, violate correlative rights, or pollute the natural resources of the state of Kansas. If no protests are received, this application may be granted through a summary proceeding. If valid protests are received, this matter will be set for hearing.

All persons interested or concerned shall take notice of the foregoing and shall govern themselves accordingly.

RITCHIE EXPLORATION, INC.
P.O. Box 783188
Wichita, KS 67278-3188
(316) 691-9500

20-53-1

APPLICATION FOR COMMINGLING OF PRODUCTION OR FLUIDS

**Operator, Lessee or Unleased Mineral Owner
within a ½ mile radius of Ritchie Exploration, Inc.'s**

**#1 Wilbur Unit
1669' FSL & 2388' FWL
Section 7-17S-36W
Wichita Co., KS**

Township 17 South, Range 36 West

Sec. 7:	NE/4	LoJo Land, LLC Lonnie Lewis, Managing Member 304 S. Genessee Street Leoti, Kansas 67861	Mineral Owner
	NW/4	Denise Gerstberger, a widow 601 S. 9th Street Leoti, Kansas 67861	Mineral Owner
		Gary Wilbur and Beth A. Wilbur 426 W. County Road L Leoti, Kansas 67861	Mineral Owner
	S/2, less a 58.85-acre tract in the SW/4	Ritchie Exploration, Inc. PO Box 783188 Wichita, Kansas 67278-3188	Operator: #1 Wilbur Unit
		Gary Wilbur and Beth A. Wilbur 426 W. County Road L Leoti, Kansas 67861	Surface Owner
	58.85-acre tract in the SW/4	Ritchie Exploration, Inc. PO Box 783188 Wichita, Kansas 67278-3188	Lessee
Sec. 18:	N/2, less a 114.391-acre tract	Ritchie Exploration, Inc. PO Box 783188 Wichita, Kansas 67278-3188	Lessee
	114.391-acre tract in N/2	Ritchie Exploration, Inc. PO Box 783188 Wichita, Kansas 67278-3188	Lessee

R 37 W

R 36 W

T
17
S

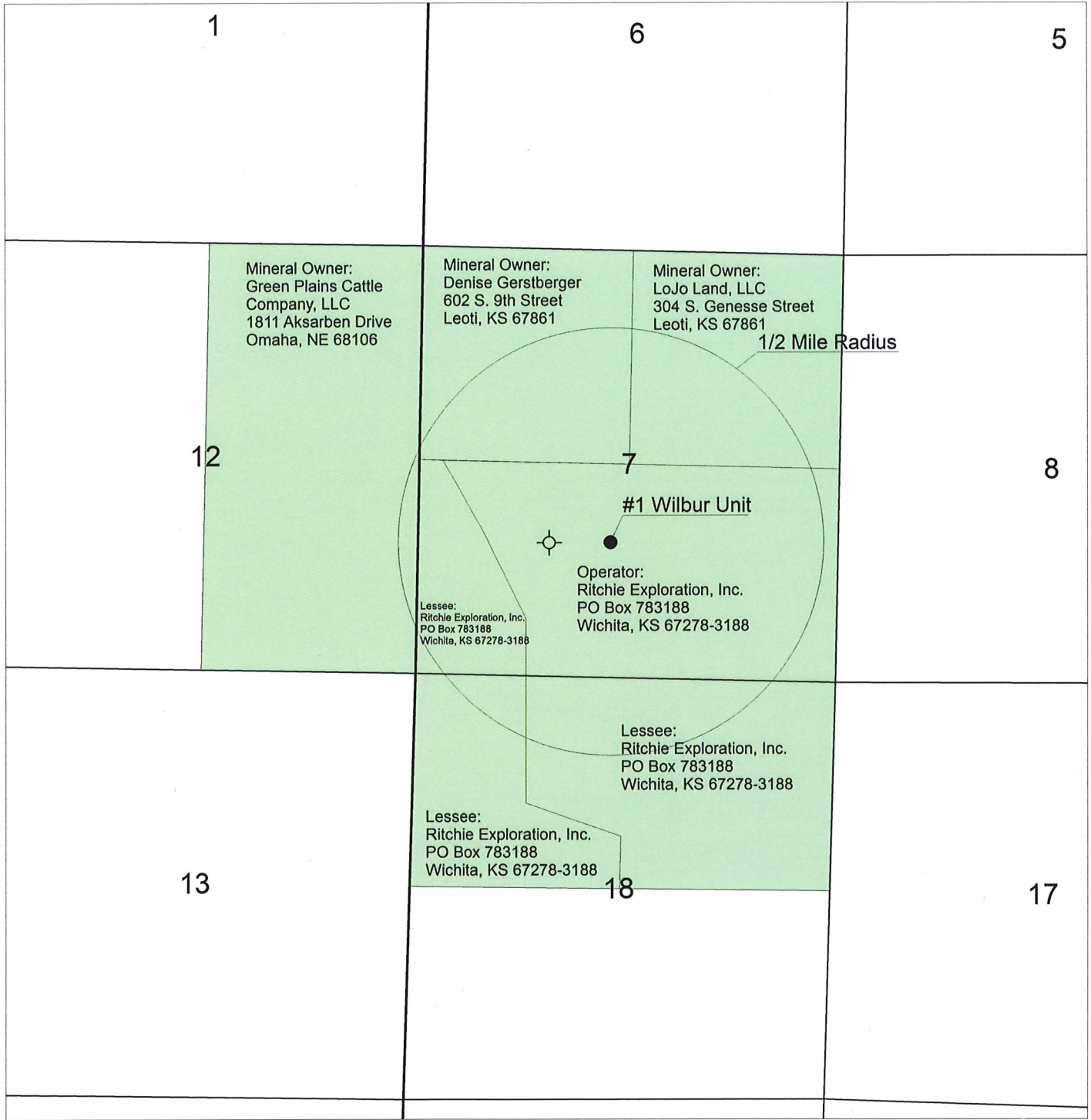

- Legend**
- Oil Well
 - ⊕ Dry and Abandoned Well



RITCHIE
EXPLORATION, INC.
Wichita, Kansas

**Application for
Commingling of
Production or Fluids**

Applicant Well: #1 Wilbur Unit
API: 15-203-20333-0000

All Wells within 1/2 Mile Radius
Name and Address of Operators, Lessee Of Record, or
Mineral Owners

Wichita County, Kansas

Prepared By: Justin Clegg	Scale: 1 : 22,000	Date: March 26, 2020
------------------------------	----------------------	-------------------------

Conservation Division
266 N. Main St., Ste. 220
Wichita, KS 67202-1513



Phone: 316-337-6200
Fax: 316-337-6211
<http://kcc.ks.gov/>

Susan K. Duffy, Chair
Shari Feist Albrecht, Commissioner
Dwight D. Keen, Commissioner

Laura Kelly, Governor

June 9, 2020

Peter Fiorini
Ritchie Exploration, Inc.
P.O. Box 783188
Wichita, KS 67278-3188

RE: Approved Commingling CO062008
Wilbur Unit 2
API No. 15-203-20333-00-00

Dear Mr. Fiorini:

Your Application for Commingling (ACO-4) for the above described well has been reviewed and approved by the Kansas Corporation Commission (KCC) per K.A.R. 82-3-123. Notice was examined and found to be proper per K.A.R. 82-3-135a. No protest had been filed within the 15-day protest period.

Based upon the depth of the Pawnee formation perforations, total oil production shall not exceed 200 BOPD and total gas production shall not exceed 50% of the absolute open flow (AOF).

Sincerely,

Rick Hestermann
Production Department