

KANSAS CORPORATION COMMISSION
OIL & GAS CONSERVATION DIVISION

Form ACO-4
Form must be typed
March 2009

APPLICATION FOR COMMINGLING OF PRODUCTION (K.A.R. 82-3-123) OR FLUIDS (K.A.R. 82-3-123a) *Commingling ID #* _____

OPERATOR: License # _____ API No. 15 - _____
Name: _____ Spot Description: _____
Address 1: _____ - - - - - Sec. _____ Twp. _____ S. R. _____ East West
Address 2: _____ Feet from North / South Line of Section
City: _____ State: _____ Zip: _____ + _____ Feet from East / West Line of Section
Contact Person: _____ County: _____
Phone: (_____) _____ Lease Name: _____ Well #: _____

1. Name and upper and lower limit of each production interval to be commingled:
Formation: _____ (Perfs): _____
Formation: _____ (Perfs): _____
Formation: _____ (Perfs): _____
Formation: _____ (Perfs): _____
Formation: _____ (Perfs): _____

2. Estimated amount of fluid production to be commingled from each interval:
Formation: _____ BOPD: _____ MCFPD: _____ BWPD: _____
Formation: _____ BOPD: _____ MCFPD: _____ BWPD: _____
Formation: _____ BOPD: _____ MCFPD: _____ BWPD: _____
Formation: _____ BOPD: _____ MCFPD: _____ BWPD: _____
Formation: _____ BOPD: _____ MCFPD: _____ BWPD: _____

3. Plat map showing the location of the subject well, all other wells on the subject lease, and all wells on offsetting leases within a 1/2 mile radius of the subject well, and for each well the names and addresses of the lessee of record or operator.

4. Signed certificate showing service of the application and affidavit of publication as required in K.A.R. 82-3-135a.

For Commingling of PRODUCTION ONLY, include the following:

- 5. Wireline log of subject well. Previously Filed with ACO-1: Yes No
- 6. Complete Form ACO-1 (*Well Completion form*) for the subject well.

For Commingling of FLUIDS ONLY, include the following:

- 7. Well construction diagram of subject well.
- 8. Any available water chemistry data demonstrating the compatibility of the fluids to be commingled.

AFFIDAVIT: I am the affiant and hereby certify that to the best of my current information, knowledge and personal belief, this request for commingling is true and proper and I have no information or knowledge, which is inconsistent with the information supplied in this application.

Submitted Electronically

KCC Office Use Only
 Denied Approved
15-Day Periods Ends: _____
Approved By: _____ Date: _____

Protests may be filed by any party having a valid interest in the application. Protests must be in writing and comply with K.A.R. 82-3-135b and must be filed within 15 days of publication of the notice of application.

Confidentiality Requested:

Yes No

KANSAS CORPORATION COMMISSION
OIL & GAS CONSERVATION DIVISION

Form ACO-1
January 2018
Form must be Typed
Form must be Signed
All blanks must be Filled

CONFIDENTIAL

WELL COMPLETION FORM
WELL HISTORY - DESCRIPTION OF WELL & LEASE

OPERATOR: License # 4767
Name: Ritchie Exploration, Inc.
Address 1: 8100 E 22ND ST N # 700
Address 2: BOX 783188
City: WICHITA State: KS Zip: 67278 + 3188
Contact Person: Peter Fiorini
Phone: (316) 691-9500
CONTRACTOR: License # 33575
Name: WW Drilling, LLC
Wellsite Geologist: Max Lovely
Purchaser: CHS

Designate Type of Completion:

New Well Re-Entry Workover

Oil WSW SWD

Gas DH EOR

OG GSW

CM (Coal Bed Methane)

Cathodic Other (Core, Expl., etc.): _____

If Workover/Re-entry: Old Well Info as follows:

Operator: _____

Well Name: _____

Original Comp. Date: _____ Original Total Depth: _____

Deepening Re-perf. Conv. to EOR Conv. to SWD

Plug Back Liner Conv. to GSW Conv. to Producer

Commingled Permit #: _____

Dual Completion Permit #: _____

SWD Permit #: _____

EOR Permit #: _____

GSW Permit #: _____

<u>11/05/2018</u>	<u>11/17/2018</u>	<u>11/17/2018</u>
Spud Date or Recompletion Date	Date Reached TD	Completion Date or Recompletion Date

API No.: 15-101-22616-00-00

Spot Description: 49'S & 149'W of

- N2 - NW-SE Sec. 29 Twp. 19 S. R. 30 East West

2261 Feet from North / South Line of Section

2129 Feet from East / West Line of Section

Footages Calculated from Nearest Outside Section Corner:

NE NW SE SW

GPS Location: Lat: _____, Long: _____
(e.g. xx.xxxxx) (e.g. -xxx.xxxxx)

Datum: NAD27 NAD83 WGS84

County: Lane

Lease Name: SPECE 29D Well #: 1

Field Name: _____

Producing Formation: Fort Scott & Altamont

Elevation: Ground: 2923 Kelly Bushing: 2931

Total Vertical Depth: 4740 Plug Back Total Depth: 4691

Amount of Surface Pipe Set and Cemented at: 220 Feet

Multiple Stage Cementing Collar Used? Yes No

If yes, show depth set: 2238 Feet

If Alternate II completion, cement circulated from: 0

feet depth to: 2238 w/ 400 sx cmt.

Drilling Fluid Management Plan

(Data must be collected from the Reserve Pit)

Chloride content: 27000 ppm Fluid volume: 700 bbls

Dewatering method used: Evaporated

Location of fluid disposal if hauled offsite:

Operator Name: _____

Lease Name: _____ License #: _____

Quarter _____ Sec. _____ Twp. _____ S. R. _____ East West

County: _____ Permit #: _____

AFFIDAVIT

I am the affiant and I hereby certify that all requirements of the statutes, rules and regulations promulgated to regulate the oil and gas industry have been fully complied with and the statements herein are complete and correct to the best of my knowledge.

Submitted Electronically

KCC Office Use ONLY

Confidentiality Requested

Date: 02/26/2019

Confidential Release Date: _____

Wireline Log Received Drill Stem Tests Received

Geologist Report / Mud Logs Received

UIC Distribution

ALT I II III Approved by: Karen Ritter Date: 02/26/2019

Operator Name: Ritchie Exploration, Inc. Lease Name: SPECE 29D Well #: 1
 Sec. 29 Twp. 19 S. R. 30 East West County: Lane

INSTRUCTIONS: Show important tops of formations penetrated. Detail all cores. Report all final copies of drill stems tests giving interval tested, time tool open and closed, flowing and shut-in pressures, whether shut-in pressure reached static level, hydrostatic pressures, bottom hole temperature, fluid recovery, and flow rates if gas to surface test, along with final chart(s). Attach extra sheet if more space is needed.

Final Radioactivity Log, Final Logs run to obtain Geophysical Data and Final Electric Logs must be emailed to kcc-well-logs@kcc.ks.gov. Digital electronic log files must be submitted in LAS version 2.0 or newer AND an image file (TIFF or PDF).

Drill Stem Tests Taken <input checked="" type="checkbox"/> Yes <input type="checkbox"/> No <i>(Attach Additional Sheets)</i> Samples Sent to Geological Survey <input checked="" type="checkbox"/> Yes <input type="checkbox"/> No Cores Taken <input type="checkbox"/> Yes <input checked="" type="checkbox"/> No Electric Log Run <input checked="" type="checkbox"/> Yes <input type="checkbox"/> No Geologist Report / Mud Logs <input checked="" type="checkbox"/> Yes <input type="checkbox"/> No List All E. Logs Run: Triple Combo Log	<input type="checkbox"/> Log Formation (Top), Depth and Datum <input checked="" type="checkbox"/> Sample Name Top Datum See Attached
---	--

CASING RECORD <input checked="" type="checkbox"/> New <input type="checkbox"/> Used							
Report all strings set-conductor, surface, intermediate, production, etc.							
Purpose of String	Size Hole Drilled	Size Casing Set (In O.D.)	Weight Lbs. / Ft.	Setting Depth	Type of Cement	# Sacks Used	Type and Percent Additives
Surface	12.25	8.63	23	220	Common	165	3% cc, 2% gel
Production	7.88	5.5	15.5	4731	Common	175	10% salt, 2% gel, 1/2% HALAD 322 & 5#

ADDITIONAL CEMENTING / SQUEEZE RECORD				
Purpose:	Depth Top Bottom	Type of Cement	# Sacks Used	Type and Percent Additives
<input type="checkbox"/> Perforate <input type="checkbox"/> Protect Casing <input type="checkbox"/> Plug Back TD <input type="checkbox"/> Plug Off Zone	-			
	-			

- Did you perform a hydraulic fracturing treatment on this well? Yes No *(If No, skip questions 2 and 3)*
- Does the volume of the total base fluid of the hydraulic fracturing treatment exceed 350,000 gallons? Yes No *(If No, skip question 3)*
- Was the hydraulic fracturing treatment information submitted to the chemical disclosure registry? Yes No *(If No, fill out Page Three of the ACO-1)*

Date of first Production/Injection or Resumed Production/ Injection: <u>01/07/2019</u>		Producing Method: <input type="checkbox"/> Flowing <input checked="" type="checkbox"/> Pumping <input type="checkbox"/> Gas Lift <input type="checkbox"/> Other <i>(Explain)</i> _____			
Estimated Production Per 24 Hours	Oil Bbls. <u>106.15</u>	Gas Mcf	Water Bbls. <u>48.01</u>	Gas-Oil Ratio	Gravity <u>35</u>

DISPOSITION OF GAS: <input type="checkbox"/> Vented <input type="checkbox"/> Sold <input type="checkbox"/> Used on Lease <i>(If vented, Submit ACO-18.)</i>	METHOD OF COMPLETION: <input type="checkbox"/> Open Hole <input checked="" type="checkbox"/> Perf. <input type="checkbox"/> Dually Comp. <input type="checkbox"/> Commingled <i>(Submit ACO-5) (Submit ACO-4)</i>	PRODUCTION INTERVAL: Top <u>4434</u> Bottom <u>4530</u>
---	---	--

Shots Per Foot	Perforation Top	Perforation Bottom	Bridge Plug Type	Bridge Plug Set At	Acid, Fracture, Shot, Cementing Squeeze Record <i>(Amount and Kind of Material Used)</i>
4	4646	4649			
4	4615	4620	CIBP Cast Iron Bridge Plug	4600	300 gals 15% MCA
4	4526	4530			500 gals 15% MCA
4	4434	4438			500 gals 15% MCA

TUBING RECORD: Size: <u>2.88</u> Set At: <u>4575</u> Packer At: <u> </u>
--

AFFIDAVIT

STATE OF KANSAS)
 - SS.
County of Sedgwick)

Peter Fiorini, of lawful age, being first duly sworn, deposeth and saith: That he is Production Manager of Ritchie Exploration, County of Sedgwick, State of Kansas, and that notice was given to all lessee of record or operator within ½ mile radius of the Spece 29D #1 well located in the County of Lane (see attached plat map). This notice included a letter regarding commingling of production application. All notices were mailed on December 7, 2020.

made as aforesaid on the 7th of

December A.D. 2020

[Handwritten signature in blue ink]

And affiant further says that he has personal knowledge of the statements above set forth and that they are true.

Subscribed and sworn to before me this

7th day of December 2020



[Handwritten signature of Karen Hopper]

Notary Public Sedgwick County, Kansas



AFFIDAVIT OF PUBLICATION

Account #	Ad Number	Identification	PO	Amount	Cols	Depth
453699	0004827756	LEGAL NOTICE You, and each of you, are hereby	#1 Spece 29D well	\$196.44	1	3.20 In

Attention: Karen Hopper
RITCHIE EXPLORATION INC
P O BOX 783188
WICHITA, KS 672783188

LEGAL NOTICE

You, and each of you, are hereby notified that Ritchie Exploration, Inc. has filed an application to commence the commingling of production from the Fort Scott and Altamont B sources of supply for the #1 Spece 29D well located approx. N2 NW SE of Section 29-19S-30W, Lane County, Kansas.

Any persons who object to or protest this application shall be required to file their objections or protests with the Conservation Division of the State Corporation Commission of the State of Kansas within thirty (30) days from the date of the publication. These protests shall be filed pursuant to Commission regulations and must state specific reasons why the grant of the application may cause waste, violate correlative rights or pollute the natural resources of the state of Kansas. If no protests are received, this application may be granted through a summary proceeding. If valid protests are received, this matter will be set for hearing.

All persons interested or concerned shall take notice of the foregoing and shall govern themselves accordingly.

RITCHIE EXPLORATION, INC.
 P.O. Box 783188
 Wichita, KS 67278-3188
 (316) 691-9500

In The STATE OF KANSAS
 In and for the County of Sedgwick
AFFIDAVIT OF PUBLICATION

1 Insertions

Beginning issue of: 12/10/2020

Ending issue of: 12/10/2020

STATE OF KANSAS)
 .SS
 County of Sedgwick)

VICTORIA RODELA, of lawful age, being first duly sworn, deposeseth and saith: That he is Record Clerk of The Wichita Eagle, a daily newspaper published in the City of Wichita, County of Sedgwick, State of Kansas, and having a general paid circulation on a daily basis in said County, which said newspaper has been continuously and uninterruptedly published in said County for more than one year prior to the first publication of the notice hereinafter mentioned, and which said newspaper has been entered as second class mail matter at the United States Post Office in Wichita, Kansas, and which said newspaper is not a trade, religious or fraternal publication and that a notice of a true copy is hereto attached was published in the regular and entire Morning issue of said The Wichita Eagle from 12/10/2020 to 12/10/2020.

I certify (or declare) under the penalty of perjury that the foregoing is true and correct.

V Rodela

Signature of Principal Clerk

DATED: 12/10/2020

Amanda Dawn Grisham

Notary Public Dallas County, Texas

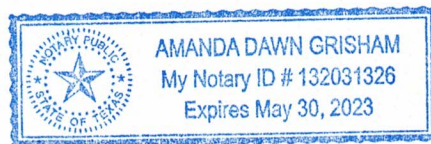

Extra charge for lost or duplicate affidavits.
 Legal document please do not destroy!

Proof of Publication

State of Kansas,
County of Lane, ss:

Emily George

of lawful age, being duly sworn upon oath states that he/she is the editor of **THE DIGHTON HERALD**.

THAT said newspaper has been published at least weekly 50 times a year and has been so published for at least five years prior to the first publication of the attached notice.

THAT said newspaper was entered as second class matter at the post office of its publication;

THAT said newspaper has a general paid circulation on a daily, weekly, monthly, or yearly basis in LANE County, Kansas and is NOT a trade, religious or fraternal publication and has been printed and published in LANE County, Kansas.

THE ATTACHED was published on the following dates in a regular issue of said newspaper:

1st Publication was made on the 16 day of Dec, 20 20

2nd Publication was made on the ___ day of ___, 20 ___

3rd Publication was made on the ___ day of ___, 20 ___

4th Publication was made on the ___ day of ___, 20 ___

5th Publication was made on the ___ day of ___, 20 ___

6th Publication was made on the ___ day of ___, 20 ___

Publication fee \$ 39.60

Affidavit, Notary's Fees \$ _____

Additional Copies _____ @ _____ \$ _____

Total Publication Fee \$ 39.60

Emily George
(Signed)

Witness my hand this 23 day of December, 2020

SUBSCRIBED and SWORN to before me this 23

day of December, 20 20.

Kelli M. James
(Notary Public)

My commission expires 10/21/24



LEGAL

*(First Published in the
Dighton Herald on
December 16, 2020.)*

You, and each of you, are hereby notified that Ritchie Exploration, Inc. has filed an application to commence the commingling of production from the Fort Scott and Altamont "B" sources of supply for the #1 Spece 29D well located approx. N2 NW SE of Section 29-19S-30W, Lane County, Kansas.

Any persons who object to or protest this application shall be required to file their objections or protests with the Conservation Division of the State Corporation Commission of the State of Kansas within thirty (30) days from the date of the publication. These protests shall be filed pursuant to Commission regulations and must state specific reasons why the grant of the application may cause waste, violate correlative rights or pollute the natural resources of the state of Kansas.

If no protests are received, this application may be granted through a summary proceeding. If valid protests are received, this matter will be set for hearing.

All persons interested or concerned shall take notice of the foregoing and shall govern themselves accordingly.

RITCHIE EX-
PLORATION, INC.
P.O. Box 783188
Wichita, KS 67278-3188
(316) 691-9500

APPLICATION FOR COMMINGLING OF PRODUCTION OR FLUIDS

**Operator, Lessee or Unleased Mineral Owner
within a ½ mile radius of Ritchie Exploration, Inc.'s**

**#1 Spece 29D
2,261' FSL & 2,129' FEL
Section 29-19S-30W
Lane Co., KS**

Township 19 South, Range 30 West

Sec. 28:	NW/4	Gerald E. Riley & Donna D. Riley PO Box 397 Dighton, KS 67839	Mineral Owners
		Keith L. Riley & Merrill L. Riley 414 N. 12 th Ave. Hill City, KS 67642	Mineral Owners
	SW/4	M. Gregory Dirks & Debra S. Dirks 1314 Elizabeth Scott City, KS 67871	Mineral Owners
Sec. 29:	NE/4	Celia Ann Wells 103 S. Dodge RD Dighton, KS 67839	Mineral Owner
		Daniel Lee Moomaw & Lisa Moomaw PO Box 396 Dighton, KS 67839	Mineral Owners
		Max Moomaw 103 S. Dodge RD Dighton, KS 67839	Mineral Owner
		Mitch Moomaw & Terry Moomaw PO Box 762 Dighton, KS 67839	Mineral Owners
	NW/4, less a tract	William A. Huseman Trust No. 1, dated 1/1/1980 Joann Riemann, Trustee PO Box 666 Dighton, KS 67839	Mineral Owner

Township 19 South, Range 30 West

Sec. 29:	SW/4, less a tract	Ritchie Exploration, Inc. PO Box 783188 Wichita, KS 67278-3188	Operator: #1 Anderson-Schwartz
	SE/4	Ritchie Exploration, Inc. Samuel M. Spece PO Box 1284 Great Bend, KS 67530 William L. Spece 2001 Van Buren ST Great Bend, KS 67530	Operator: #1 Spece 29D Mineral Owner
Sec. 32:	NW/4	Ritchie Exploration, Inc.	Operator: #1 Anderson-Schwartz, #1 Anderson 32B
	NE/4	Danielle M. Anderson Trust Ronald L. Miller, Trustee PO Box 1203 Great Bend, KS 67530	Mineral Owner

R 30 W

T
19
S

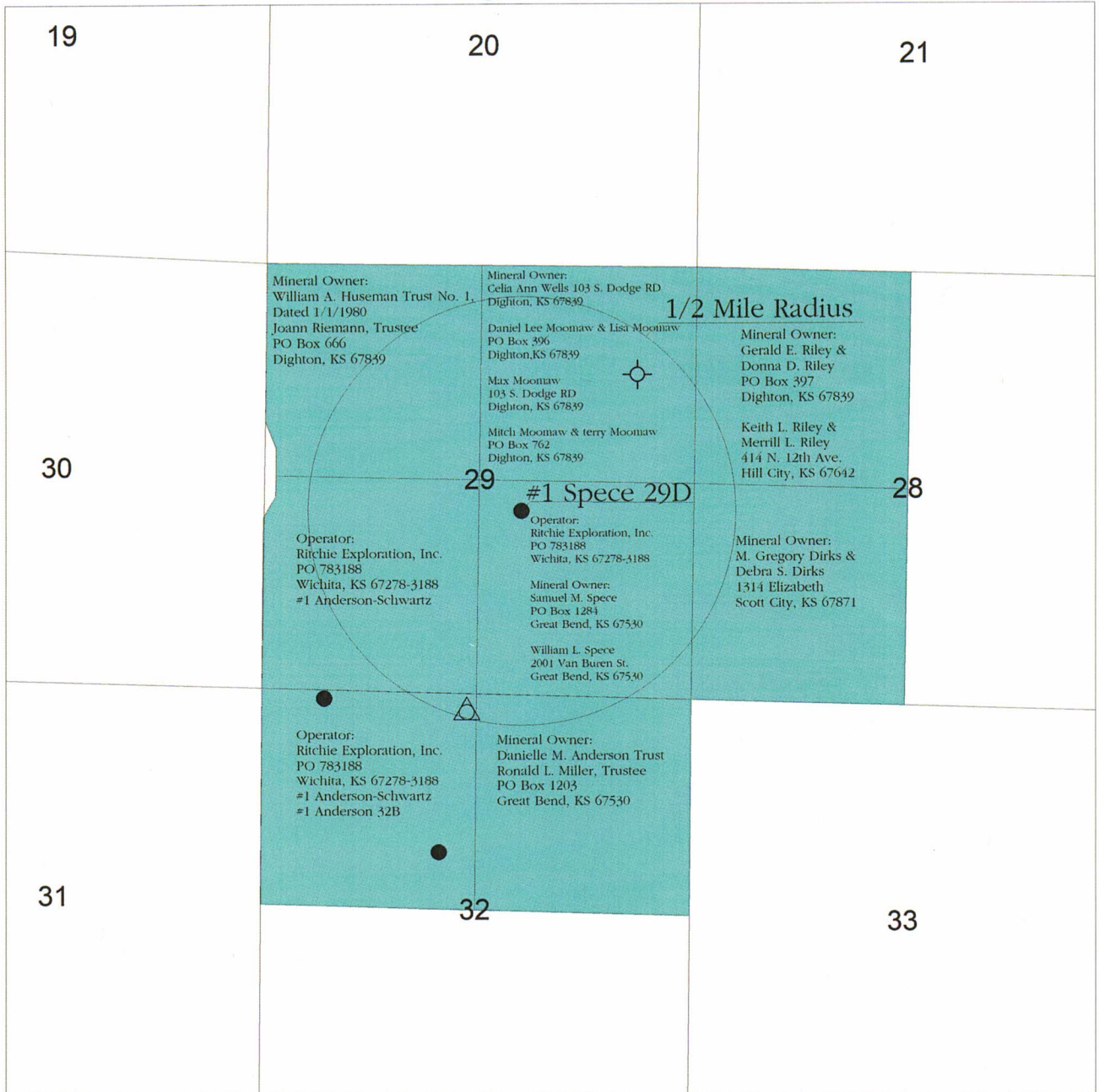

- Legend**
- Oil Well
 - ⊕ Dry and Abandoned Well
 - △ Service Well



RITCHIE
EXPLORATION, INC.
Wichita, Kansas

**Application for
Commingling of
Production or Fluids**

Applicant Well: #1 Spece 29D
API: 15-101-22616-0000
All Wells within 1/2 Mile Radius
Names and Address of Lessee of Record, Operator,
Or Unleased Mineral Owner

Lane County, Kansas

Prepared By: Justin Clegg	Scale: 1 : 24,000	Date: November 18, 2020
------------------------------	----------------------	----------------------------

Conservation Division
266 N. Main St., Ste. 220
Wichita, KS 67202-1513



Phone: 316-337-6200
Fax: 316-337-6211
<http://kcc.ks.gov/>

Susan K. Duffy, Chair
Dwight D. Keen, Commissioner
Andrew J. French, Commissioner

Laura Kelly, Governor

December 31, 2020

Peter Fiorini
Ritchie Exploration, Inc.
P.O. Box 783188
Wichita, KS 67278-3188

RE: Approved Commingling CO122002
Spece 29D 1
API No. 15-101-22616-00-00

Dear Mr. Fiorini:

Your Application for Commingling (ACO-4) for the above described well has been reviewed and approved by the Kansas Corporation Commission (KCC) per K.A.R. 82-3-123. Notice was examined and found to be proper per K.A.R. 82-3-135a. No protest had been filed within the 15-day protest period.

Based upon the depth of the Fort Scott formation perforations, total oil production shall not exceed 200 BOPD and total gas production shall not exceed 50% of the absolute open flow (AOF).

Sincerely,

Rick Hestermann
Production Department