

KANSAS CORPORATION COMMISSION
OIL & GAS CONSERVATION DIVISION

Form CP-1
March 2010

This Form must be Typed
Form must be Signed
All blanks must be Filled

WELL PLUGGING APPLICATION

Form KSONA-1, Certification of Compliance with the Kansas Surface Owner Notification Act,
MUST be submitted with this form.

OPERATOR: License #: _____
Name: _____
Address 1: _____
Address 2: _____
City: _____ State: _____ Zip: _____ + _____
Contact Person: _____
Phone: (_____) _____

API No. 15 - _____
If pre 1967, supply original completion date: _____
Spot Description: _____
____ - ____ - ____ Sec. ____ Twp. ____ S. R. ____ East West
_____ Feet from North / South Line of Section
_____ Feet from East / West Line of Section
Footages Calculated from Nearest Outside Section Corner:
 NE NW SE SW
County: _____
Lease Name: _____ Well #: _____

Check One: Oil Well Gas Well OG D&A Cathodic Water Supply Well Other: _____
 SWD Permit #: _____ ENHR Permit #: _____ Gas Storage Permit #: _____

Conductor Casing Size: _____ Set at: _____ Cemented with: _____ Sacks
Surface Casing Size: _____ Set at: _____ Cemented with: _____ Sacks
Production Casing Size: _____ Set at: _____ Cemented with: _____ Sacks

List (ALL) Perforations and Bridge Plug Sets:

Elevation: _____ (G.L. / K.B.) T.D.: _____ PBTD: _____ Anhydrite Depth: _____
(Stone Corral Formation)

Condition of Well: Good Poor Junk in Hole Casing Leak at: _____
(Interval)

Proposed Method of Plugging (attach a separate page if additional space is needed):

Is Well Log attached to this application? Yes No Is ACO-1 filed? Yes No

If ACO-1 not filed, explain why:

Plugging of this Well will be done in accordance with K.S.A. 55-101 et. seq. and the Rules and Regulations of the State Corporation Commission

Company Representative authorized to supervise plugging operations: _____
Address: _____ City: _____ State: _____ Zip: _____ + _____
Phone: (_____) _____
Plugging Contractor License #: _____ Name: _____
Address 1: _____ Address 2: _____
City: _____ State: _____ Zip: _____ + _____
Phone: (_____) _____

Proposed Date of Plugging (if known): _____

Payment of the Plugging Fee (K.A.R. 82-3-118) will be guaranteed by Operator or Agent

Submitted Electronically

KANSAS CORPORATION COMMISSION
OIL & GAS CONSERVATION DIVISION

Form KSONA-1
January 2014
Form Must Be Typed
Form must be Signed
All blanks must be Filled

**CERTIFICATION OF COMPLIANCE WITH THE
KANSAS SURFACE OWNER NOTIFICATION ACT**

This form must be submitted with all Forms C-1 (Notice of Intent to Drill); CB-1 (Cathodic Protection Borehole Intent); T-1 (Request for Change of Operator Transfer of Injection or Surface Pit Permit); and CP-1 (Well Plugging Application). Any such form submitted without an accompanying Form KSONA-1 will be returned.

Select the corresponding form being filed: C-1 (Intent) CB-1 (Cathodic Protection Borehole Intent) T-1 (Transfer) CP-1 (Plugging Application)

OPERATOR: License # _____
Name: _____
Address 1: _____
Address 2: _____
City: _____ State: _____ Zip: _____ + _____
Contact Person: _____
Phone: (_____) _____ Fax: (_____) _____
Email Address: _____

Well Location:
____ - ____ - ____ - ____ Sec. ____ Twp. ____ S. R. ____ East West
County: _____
Lease Name: _____ Well #: _____
If filing a Form T-1 for multiple wells on a lease, enter the legal description of the lease below:

Surface Owner Information:

Name: _____
Address 1: _____
Address 2: _____
City: _____ State: _____ Zip: _____ + _____

When filing a Form T-1 involving multiple surface owners, attach an additional sheet listing all of the information to the left for each surface owner. Surface owner information can be found in the records of the register of deeds for the county, and in the real estate property tax records of the county treasurer.

If this form is being submitted with a Form C-1 (Intent) or CB-1 (Cathodic Protection Borehole Intent), you must supply the surface owners and the KCC with a plat showing the predicted locations of lease roads, tank batteries, pipelines, and electrical lines. The locations shown on the plat are preliminary non-binding estimates. The locations may be entered on the Form C-1 plat, Form CB-1 plat, or a separate plat may be submitted.

Select one of the following:

- I certify that, pursuant to the Kansas Surface Owner Notice Act (House Bill 2032), I have provided the following to the surface owner(s) of the land upon which the subject well is or will be located: 1) a copy of the Form C-1, Form CB-1, Form T-1, or Form CP-1 that I am filing in connection with this form; 2) if the form being filed is a Form C-1 or Form CB-1, the plat(s) required by this form; and 3) my operator name, address, phone number, fax, and email address.
- I have not provided this information to the surface owner(s). I acknowledge that, because I have not provided this information, the KCC will be required to send this information to the surface owner(s). To mitigate the additional cost of the KCC performing this task, I acknowledge that I must provide the name and address of the surface owner by filling out the top section of this form and that I am being charged a \$30.00 handling fee, payable to the KCC, which is enclosed with this form.

If choosing the second option, submit payment of the \$30.00 handling fee with this form. If the fee is not received with this form, the KSONA-1 form and the associated Form C-1, Form CB-1, Form T-1, or Form CP-1 will be returned.

I Submitted Electronically

I

Form	CP1 - Well Plugging Application
Operator	Woolsey Operating Company, LLC
Well Name	MANKE 1
Doc ID	1542307

Perforations And Bridge Plug Sets

Perforation Top	Perforation Base	Formation	Bridge Plug Depth
5056	5094	MISSISSIPPIAN	

KANSAS DRILLERS LOG

State Geological Survey
WICHITA, BRANCH

S. 6 T. 29S R. 20 ^W
Loc. 2310' FSL & 2310' FEL
County Kiowa

API No. 15 — 097 — 20,359
County Number

Operator
Texas Oil & Gas Corp.

Address
200 West Douglas, Suite 300, Wichita, Kansas 67202

Well No. 1 Lease Name Manke

Footage Location
2310 feet from (N) (S) line 2310 feet from (E) (W) line

Principal Contractor Xplor Drilling Company Geologist High Plains Consulting Ltd.

Spud Date 11-18-76 Total Depth 5180' P.B.T.D. N/A

Date Completed 1-24-77 Oil Purchaser N/A

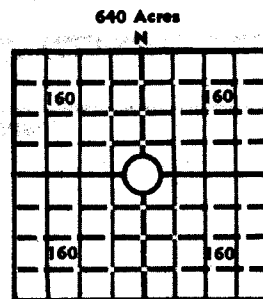

Elev.: Gr. 2387'
DF 2392' KB 2395'

CASING RECORD

Report of all strings set — surface, intermediate, production, etc.

Purpose of string	Size hole drilled	Size casing set (in O.D.)	Weight lbs/ft.	Setting depth	Type cement	Socks	Type and percent additives
Surface	12 1/4"	8 5/8"	24#	571'	Common	500	2% Gel, 3% CaCl
Production	7 7/8"	4 1/2"	10.5#	5179'	50/50 Pozmix	200	18% NaCl, 1.2# CFR2 5# gilsonite/sx

LINER RECORD

PERFORATION RECORD

Top, ft.	Bottom, ft.	Socks cement	Shots per ft.	Size & type	Depth interval
N/A	N/A	N/A			
TUBING RECORD			4 JSPF	Deep Penet.	5076-86'
Size	Setting depth	Packer set at			
2 3/8"	5095'	N/A			

ACID, FRACTURE, SHOT, CEMENT SQUEEZE RECORD

Amount and kind of material used	Depth interval treated
Acidized w/2500 gallons acid.	5076-86'

INITIAL PRODUCTION

Date of first production N/A Producing method (flowing, pumping, gas lift, etc.) Flowing

RATE OF PRODUCTION PER 24 HOURS	Oil <u>N/A</u> bbls.	Gas <u>1205</u> MCF	Water <u>N/A</u> bbls.	Gas-oil ratio <u>N/A</u> CFPB
---------------------------------	----------------------	---------------------	------------------------	-------------------------------

Disposition of gas (vented, used on lease or sold) Shut-in Producing interval(s) 5076-86'

INSTRUCTIONS: As provided in KCC Rule 82-2-125, within 90 days after completion of a well, one completed copy of this Drillers Log shall be transmitted to the State Geological Survey of Kansas, 4150 Monroe Street, Wichita, Kansas 67209. Copies of this form are available from the Conservation Division, State Corporation Commission, 3830 So. Meridian (P.O. Box 17027), Wichita, Kansas 66217. Phone AC 316-522-2206. If confidential custody is desired, please note Rule 82-2-125. Drillers Logs will be on open file in the Oil and Gas Division, State Geological Survey of Kansas, Lawrence, Kansas 66044.

Operator
Texas Oil & Gas Corp.

DESIGNATE TYPE OF COMP.: OIL, GAS, DRY HOLE, SWDOW, ETC.:

Well No. 1 Lease Name Manke Gas Well

S 6 T 29S R 20 E W

WELL LOG

Show all important zones of porosity and contents thereof; corod intervals, and all drill-stem tests, including depth interval tested, cushion used, time tool open, flowing and shut-in pressures, and recoveries.

SHOW GEOLOGICAL MARKERS, LOGS RUN, OR OTHER DESCRIPTIVE INFORMATION.

FORMATION DESCRIPTION, CONTENTS, ETC.	TOP	BOTTOM	NAME	DEPTH
Herrington	2658	-263		
Cottonwood	3180	-785		
Wabaunsee	3478	-1083		
Heebner	4247	-1852		
Lansing	4418	-2023		
B/Kansas City	4843	-2448		
Marmaton	4880	-2485		
Cherokee	4980	-2585		
Mississippi	5060	-2665		
TD	5180	-2785		
<u>Core #1, 5048-66', (Cherokee-Mississippi) w/results as follows:</u> Rec 5½' lime & shale, 6½' shale & 1' lime.				
<u>Core #2, 5066-91', (Mississippi) w/results as follows:</u> Rec 3' lime, 16' porous dolomite & 5' shaley dolomite.				
<u>DST #1, 5060-92', (Mississippi) w/results as follows:</u> IFP/30": 260-458#, 1612 MCFD w/spray of muddy water ISIP/60": 1558# FFP/45": 405-500#, 1413 MCFD w/spray of muddy water. FSIP/90": 1558# Rec 72' GCMW.				
<u>DST #2, 5094-5140', (Mississippi) w/results as follows:</u> IFP/30": 135-208#, GTS in 5", 336 MCFD ISIP/60": 1559# FFP/45": 229-343#, 319 MCFD & stable @ 526 MCFD w/spray of water FSIP/90": 1569# Rec 771' HOGCMW.				

USE ADDITIONAL SHEETS, IF NECESSARY, TO COMPLETE WELL RECORD.

Date Received

Harold A. Brown
Harold A. Brown Signature

District Geologist

Title

2-25-77

Date

CERTIFICATION OF COMPLIANCE WITH THE KANSAS SURFACE OWNER NOTIFICATION ACT

SUPPLEMENTAL PAGE ATTACHED TO CP-1 WELL PLUGGING APPLICATION

<u>OPERATOR:</u>	<u>LEASE NAME:</u>	<u>WELL #:</u>
Woolsey Operating Company, LLC	Manke	1

Surface Owner Information (additional owners):

KURT A. MANKE
176 N ST.
BUCKLIN, KS 67834

MANKE REVOCABLE TRUST
8303 WEST THURMAN ST
WICHITA, KS 67212

VICTOR MANKE
8303 WEST THURMAN ST
WICHITA, KS 67212

February 11, 2021

DEAN PATTISSON
Woolsey Operating Company, LLC
125 N MARKET STE 1000
WICHITA, KS 67202-1729

Re: Plugging Application
API 15-097-20359-00-00
MANKE 1
SE/4 Sec.06-29S-20W
Kiowa County, Kansas

Dear DEAN PATTISSON:

The Conservation Division has received your Well Plugging Application (CP-1).

Under K.A.R. 82-3-113(b)(2), you must notify DISTRICT 1 of your proposed plugging plan at least 5 days before plugging the well. DISTRICT 1's phone number is (620) 682-7933. Failure to notify DISTRICT 1, or failure to file a Well Plugging Record (CP-4) after the well is plugged will result in a penalty recommendation.

Under K.A.R. 82-3-600, you must file an Application for Surface Pit (CDP-1) if you wish to use a workover pit while plugging the well. Failure to timely file a CDP-1, failure to timely remove fluids, or failure to timely file Closure of Surface Pit (CDP-4) or Waste Transfer (CDP-5) forms will result in a penalty recommendation.

This receipt does NOT constitute authorization to plug this well if you do not otherwise have the legal right to do so.

This receipt is VOID after August 10, 2021. If the well is not plugged by then, you will have to submit a new CP-1 if you wish to plug the well.

The August 10, 2021 deadline does NOT override any compliance deadline given to you by Legal, District, or other Commission Staff. Failure to comply with any given deadline will still result in the Commission assessing penalties, or taking other legal action.

Sincerely,
Production Department Supervisor

cc: DISTRICT 1