

For KCC Use:

Effective Date: \_\_\_\_\_

District # \_\_\_\_\_

SGA?  Yes  No

KANSAS CORPORATION COMMISSION  
OIL & GAS CONSERVATION DIVISION

Form C-1

March 2010

Form must be Typed  
Form must be Signed  
All blanks must be Filled

NOTICE OF INTENT TO DRILL

Must be approved by KCC five (5) days prior to commencing well

Form KSONA-1, Certification of Compliance with the Kansas Surface Owner Notification Act, MUST be submitted with this form.

Expected Spud Date: \_\_\_\_\_  
month day year

OPERATOR: License# \_\_\_\_\_

Name: \_\_\_\_\_

Address 1: \_\_\_\_\_

Address 2: \_\_\_\_\_

City: \_\_\_\_\_ State: \_\_\_\_\_ Zip: \_\_\_\_\_ + \_\_\_\_\_

Contact Person: \_\_\_\_\_

Phone: \_\_\_\_\_

CONTRACTOR: License# \_\_\_\_\_

Name: \_\_\_\_\_

Well Drilled For:

Well Class:

Type Equipment:

- |                              |                                   |                                    |                                     |
|------------------------------|-----------------------------------|------------------------------------|-------------------------------------|
| <input type="checkbox"/> Oil | <input type="checkbox"/> Enh Rec  | <input type="checkbox"/> Infield   | <input type="checkbox"/> Mud Rotary |
| <input type="checkbox"/> Gas | <input type="checkbox"/> Storage  | <input type="checkbox"/> Pool Ext. | <input type="checkbox"/> Air Rotary |
|                              | <input type="checkbox"/> Disposal | <input type="checkbox"/> Wildcat   | <input type="checkbox"/> Cable      |

Seismic ; \_\_\_\_\_ # of Holes  Other

Other: \_\_\_\_\_

If OWWO: old well information as follows:

Operator: \_\_\_\_\_

Well Name: \_\_\_\_\_

Original Completion Date: \_\_\_\_\_ Original Total Depth: \_\_\_\_\_

Directional, Deviated or Horizontal wellbore?  Yes  No

If Yes, true vertical depth: \_\_\_\_\_

Bottom Hole Location: \_\_\_\_\_

KCC DKT #: \_\_\_\_\_

Spot Description: \_\_\_\_\_

\_\_\_\_\_ - \_\_\_\_\_ - \_\_\_\_\_ Sec. \_\_\_\_\_ Twp. \_\_\_\_\_ S. R. \_\_\_\_\_  E  W  
(Q/Q/Q/Q)

\_\_\_\_\_ feet from  N /  S Line of Section

\_\_\_\_\_ feet from  E /  W Line of Section

Is SECTION:  Regular  Irregular?

(Note: Locate well on the Section Plat on reverse side)

County: \_\_\_\_\_

Lease Name: \_\_\_\_\_ Well #: \_\_\_\_\_

Field Name: \_\_\_\_\_

Is this a Prorated / Spaced Field?  Yes  No

Target Formation(s): \_\_\_\_\_

Nearest Lease or unit boundary line (in footage): \_\_\_\_\_

Ground Surface Elevation: \_\_\_\_\_ feet MSL

Water well within one-quarter mile:  Yes  No

Public water supply well within one mile:  Yes  No

Depth to bottom of fresh water: \_\_\_\_\_

Depth to bottom of usable water: \_\_\_\_\_

Surface Pipe by Alternate:  I  II

Length of Surface Pipe Planned to be set: \_\_\_\_\_

Length of Conductor Pipe (if any): \_\_\_\_\_

Projected Total Depth: \_\_\_\_\_

Formation at Total Depth: \_\_\_\_\_

Water Source for Drilling Operations:

Well  Farm Pond  Other: \_\_\_\_\_

DWR Permit #: \_\_\_\_\_

(Note: Apply for Permit with DWR  )

Will Cores be taken?  Yes  No

If Yes, proposed zone: \_\_\_\_\_

AFFIDAVIT

The undersigned hereby affirms that the drilling, completion and eventual plugging of this well will comply with K.S.A. 55 et. seq.

It is agreed that the following minimum requirements will be met:

1. Notify the appropriate district office **prior** to spudding of well;
2. A copy of the approved notice of intent to drill **shall be** posted on each drilling rig;
3. The minimum amount of surface pipe as specified below **shall be set** by circulating cement to the top; in all cases surface pipe **shall be set** through all unconsolidated materials plus a minimum of 20 feet into the underlying formation.
4. If the well is dry hole, an agreement between the operator and the district office on plug length and placement is necessary **prior to plugging**;
5. The appropriate district office will be notified before well is either plugged or production casing is cemented in;
6. If an ALTERNATE II COMPLETION, production pipe shall be cemented from below any usable water to surface within **120 DAYS** of spud date. Or pursuant to Appendix "B" - Eastern Kansas surface casing order #133,891-C, which applies to the KCC District 3 area, alternate II cementing must be completed within 30 days of the spud date or the well shall be plugged. **In all cases, NOTIFY district office** prior to any cementing.

Submitted Electronically

**For KCC Use ONLY**

API # 15 - \_\_\_\_\_

Conductor pipe required \_\_\_\_\_ feet

Minimum surface pipe required \_\_\_\_\_ feet per ALT.  I  II

Approved by: \_\_\_\_\_

**This authorization expires:** \_\_\_\_\_  
(This authorization void if drilling not started within 12 months of approval date.)

Spud date: \_\_\_\_\_ Agent: \_\_\_\_\_

Remember to:

- File Certification of Compliance with the Kansas Surface Owner Notification Act (KSONA-1) with Intent to Drill;
- File Drill Pit Application (form CDP-1) with Intent to Drill;
- File Completion Form ACO-1 within 120 days of spud date;
- File acreage attribution plat according to field proration orders;
- Notify appropriate district office 48 hours prior to workover or re-entry;
- Submit plugging report (CP-4) after plugging is completed (within 60 days);
- Obtain written approval before disposing or injecting salt water.
- If well will not be drilled or permit has expired (See: authorized expiration date) please check the box below and return to the address below.

Well will not be drilled or Permit Expired Date: \_\_\_\_\_

Signature of Operator or Agent: \_\_\_\_\_

E  
 W

For KCC Use ONLY

API # 15 - \_\_\_\_\_

**IN ALL CASES PLOT THE INTENDED WELL ON THE PLAT BELOW**

In all cases, please fully complete this side of the form. Include items 1 through 5 at the bottom of this page.

Operator: \_\_\_\_\_

Lease: \_\_\_\_\_

Well Number: \_\_\_\_\_

Field: \_\_\_\_\_

Number of Acres attributable to well: \_\_\_\_\_

QTR/QTR/QTR/QTR of acreage: \_\_\_\_\_ - \_\_\_\_\_ - \_\_\_\_\_ - \_\_\_\_\_

Location of Well: County: \_\_\_\_\_

\_\_\_\_\_ feet from  N /  S Line of Section

\_\_\_\_\_ feet from  E /  W Line of Section

Sec. \_\_\_\_\_ Twp. \_\_\_\_\_ S. R. \_\_\_\_\_  E  W

Is Section:  Regular or  Irregular

**If Section is Irregular, locate well from nearest corner boundary.**

Section corner used:  NE  NW  SE  SW

**PLAT**

Show location of the well. Show footage to the nearest lease or unit boundary line. Show the predicted locations of lease roads, tank batteries, pipelines and electrical lines, as required by the Kansas Surface Owner Notice Act (House Bill 2032). You may attach a separate plat if desired.

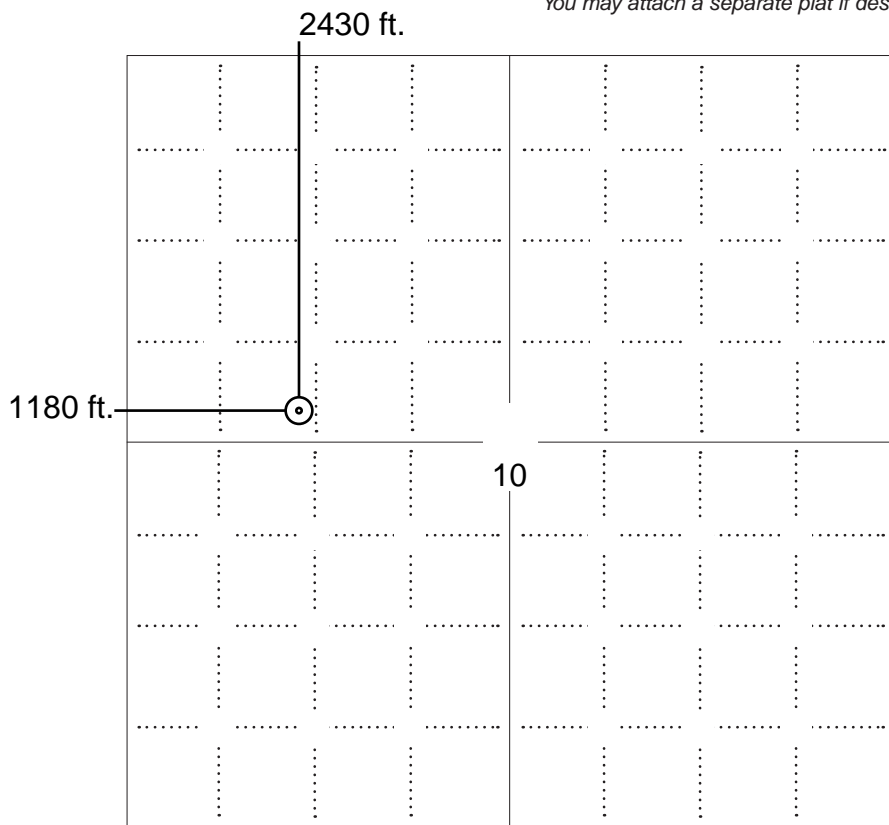

**LEGEND**

- Well Location
- Tank Battery Location
- Pipeline Location
- - - - Electric Line Location
- Lease Road Location



**NOTE: In all cases locate the spot of the proposed drilling locaton.**

**In plotting the proposed location of the well, you must show:**

1. The manner in which you are using the depicted plat by identifying section lines, i.e. 1 section, 1 section with 8 surrounding sections, 4 sections, etc.
2. The distance of the proposed drilling location from the south / north and east / west outside section lines.
3. The distance to the nearest lease or unit boundary line (in footage).
4. If proposed location is located within a prorated or spaced field a certificate of acreage attribution plat must be attached: (C0-7 for oil wells; CG-8 for gas wells).
5. The predicted locations of lease roads, tank batteries, pipelines, and electrical lines.

KANSAS CORPORATION COMMISSION  
OIL & GAS CONSERVATION DIVISIONForm CDP-1  
May 2010  
Form must be Typed

## APPLICATION FOR SURFACE PIT

Submit in Duplicate

Operator Name:		License Number:	
Operator Address:			
Contact Person:		Phone Number:	
Lease Name & Well No.:		Pit Location (QQQQ): ____ - ____ - ____ - ____ Sec. ____ Twp. ____ R. ____ <input type="checkbox"/> East <input type="checkbox"/> West ____ Feet from <input type="checkbox"/> North / <input type="checkbox"/> South Line of Section ____ Feet from <input type="checkbox"/> East / <input type="checkbox"/> West Line of Section ____ County	
Type of Pit: <input type="checkbox"/> Emergency Pit <input type="checkbox"/> Burn Pit <input type="checkbox"/> Settling Pit <input type="checkbox"/> Drilling Pit <input type="checkbox"/> Workover Pit <input type="checkbox"/> Haul-Off Pit <i>(If WP Supply API No. or Year Drilled)</i>	Pit is: <input type="checkbox"/> Proposed <input type="checkbox"/> Existing If Existing, date constructed: _____ Pit capacity: _____ (bbls)		
Is the pit located in a Sensitive Ground Water Area? <input type="checkbox"/> Yes <input type="checkbox"/> No		Chloride concentration: _____ mg/l <i>(For Emergency Pits and Settling Pits only)</i>	
Is the bottom below ground level? <input type="checkbox"/> Yes <input type="checkbox"/> No	Artificial Liner? <input type="checkbox"/> Yes <input type="checkbox"/> No	How is the pit lined if a plastic liner is not used?	
Pit dimensions (all but working pits): _____ Length (feet) _____ Width (feet) <input type="checkbox"/> N/A: Steel Pits Depth from ground level to deepest point: _____ (feet) <input type="checkbox"/> No Pit			
If the pit is lined give a brief description of the liner material, thickness and installation procedure.		Describe procedures for periodic maintenance and determining liner integrity, including any special monitoring.	
Distance to nearest water well within one-mile of pit: _____ feet    Depth of water well _____ feet		Depth to shallowest fresh water _____ feet. Source of information: <input type="checkbox"/> measured <input type="checkbox"/> well owner <input type="checkbox"/> electric log <input type="checkbox"/> KDWR	
<b>Emergency, Settling and Burn Pits ONLY:</b> Producing Formation: _____ Number of producing wells on lease: _____ Barrels of fluid produced daily: _____ Does the slope from the tank battery allow all spilled fluids to flow into the pit? <input type="checkbox"/> Yes <input type="checkbox"/> No		<b>Drilling, Workover and Haul-Off Pits ONLY:</b> Type of material utilized in drilling/workover: _____ Number of working pits to be utilized: _____ Abandonment procedure: _____ _____ Drill pits must be closed within 365 days of spud date.	
Submitted Electronically			

## KCC OFFICE USE ONLY

 Liner     Steel Pit     RFAC     RFASDate Received: \_\_\_\_\_ Permit Number: \_\_\_\_\_ Permit Date: \_\_\_\_\_ Lease Inspection:  Yes  No

KANSAS CORPORATION COMMISSION
OIL & GAS CONSERVATION DIVISION

Form KSONA-1
January 2014
Form Must Be Typed
Form must be Signed
All blanks must be Filled

CERTIFICATION OF COMPLIANCE WITH THE
KANSAS SURFACE OWNER NOTIFICATION ACT

This form must be submitted with all Forms C-1 (Notice of Intent to Drill); CB-1 (Cathodic Protection Borehole Intent);
T-1 (Request for Change of Operator Transfer of Injection or Surface Pit Permit); and CP-1 (Well Plugging Application).
Any such form submitted without an accompanying Form KSONA-1 will be returned.

Select the corresponding form being filed: [ ] C-1 (Intent) [ ] CB-1 (Cathodic Protection Borehole Intent) [ ] T-1 (Transfer) [ ] CP-1 (Plugging Application)

OPERATOR: License # \_\_\_\_\_
Name: \_\_\_\_\_
Address 1: \_\_\_\_\_
Address 2: \_\_\_\_\_
City: \_\_\_\_\_ State: \_\_\_\_\_ Zip: \_\_\_\_\_ + \_\_\_\_\_
Contact Person: \_\_\_\_\_
Phone: ( \_\_\_\_\_ ) \_\_\_\_\_ Fax: ( \_\_\_\_\_ ) \_\_\_\_\_
Email Address: \_\_\_\_\_

Well Location:
\_\_\_\_ - \_\_\_\_ - \_\_\_\_ - \_\_\_\_ Sec. \_\_\_\_ Twp. \_\_\_\_ S. R. \_\_\_\_ [ ] East [ ] West
County: \_\_\_\_\_
Lease Name: \_\_\_\_\_ Well #: \_\_\_\_\_

If filing a Form T-1 for multiple wells on a lease, enter the legal description of the lease below:

Surface Owner Information:

Name: \_\_\_\_\_
Address 1: \_\_\_\_\_
Address 2: \_\_\_\_\_
City: \_\_\_\_\_ State: \_\_\_\_\_ Zip: \_\_\_\_\_ + \_\_\_\_\_

When filing a Form T-1 involving multiple surface owners, attach an additional sheet listing all of the information to the left for each surface owner. Surface owner information can be found in the records of the register of deeds for the county, and in the real estate property tax records of the county treasurer.

If this form is being submitted with a Form C-1 (Intent) or CB-1 (Cathodic Protection Borehole Intent), you must supply the surface owners and the KCC with a plat showing the predicted locations of lease roads, tank batteries, pipelines, and electrical lines. The locations shown on the plat are preliminary non-binding estimates. The locations may be entered on the Form C-1 plat, Form CB-1 plat, or a separate plat may be submitted.

Select one of the following:

- [ ] I certify that, pursuant to the Kansas Surface Owner Notice Act (House Bill 2032), I have provided the following to the surface owner(s) of the land upon which the subject well is or will be located: 1) a copy of the Form C-1, Form CB-1, Form T-1, or Form CP-1 that I am filing in connection with this form; 2) if the form being filed is a Form C-1 or Form CB-1, the plat(s) required by this form; and 3) my operator name, address, phone number, fax, and email address.
[ ] I have not provided this information to the surface owner(s). I acknowledge that, because I have not provided this information, the KCC will be required to send this information to the surface owner(s). To mitigate the additional cost of the KCC performing this task, I acknowledge that I must provide the name and address of the surface owner by filling out the top section of this form and that I am being charged a \$30.00 handling fee, payable to the KCC, which is enclosed with this form.

If choosing the second option, submit payment of the \$30.00 handling fee with this form. If the fee is not received with this form, the KSONA-1 form and the associated Form C-1, Form CB-1, Form T-1, or Form CP-1 will be returned.

I Submitted Electronically

John O. Farmer, Inc.  
Bowlby-Maupin #2 Location Map  
2/25/2021

Bowlby-Maupin #2

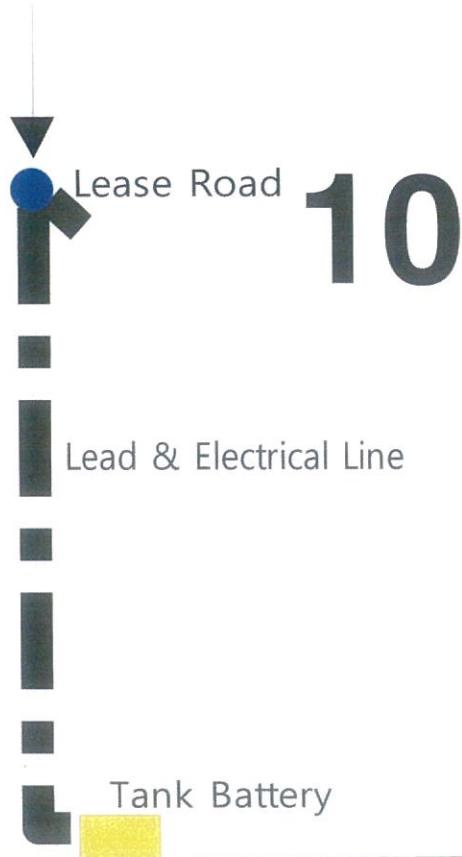

original  
document in  
base well  
file

**DECLARATION OF UNITIZATION**

KNOW ALL MEN BY THESE PRESENTS:

THAT WHEREAS, John O. Farmer, Inc., is the owner of the following described oil and gas leases, to-wit:

- (a) An oil and gas lease dated May 23, 2007, from Farmers National Company, Agent for UMB Bank, N.A., Trustee of the Ralph & Ella Bowlby Charitable Trust and Trustee of the Angelica A. Bowlby Revocable Trust dated 4/14/97, lessor, to John O. Farmer, Inc., lessee, and recorded in Book 208 at page 196 in the office of the register of deeds of Russell County, Kansas;
- (b) An oil and gas lease dated May 9, 2007, from The Hadley Foundation, Inc., lessor, to John O. Farmer, Inc., lessee, and recorded in Book 208 at page 173 in the office of the register of deeds of Russell County, Kansas;

covering, in both cases, the following described lands, to-wit:

The West Half of the Southwest Quarter (W/2 SW/4) and the South Half of the Northwest Quarter (S/2 NW/4) of Section Ten (10), Township Eleven (11) South, Range Fifteen (15) West of the 6<sup>th</sup> P.M, Russell County, Kansas;

- (c) An oil and gas lease dated July 30, 2007, from First Presbyterian Church, lessor, to John O. Farmer, Inc., lessee, and recorded in Book 208 at page 888 in the office of the register of deeds of Russell County, Kansas;
- (d) An oil and gas lease dated July 30, 2007, from The Salvation Army, lessor, to John O. Farmer, Inc., lessee, and recorded in Book 208 at page 534 in the office of the register of deeds of Russell County, Kansas;
- (e) An oil and gas lease dated July 30, 2007, from Young Women's Christian Association, lessor, to John O. Farmer, Inc., lessee, and recorded in Book 208 at page 517 in the office of the register of deeds of Russell County, Kansas;
- (f) An oil and gas lease dated July 22, 2007, from Sara S. Broer, Trustee of the Sara S. Broer Trust dated 6/28/94, lessor, to John O. Farmer, Inc., lessee, and recorded in Book 208 at page 434 in the office of the register of deeds of Russell County, Kansas;



State of Kansas, Russell County, ss  
 This instrument filed for record  
 December 3, 2007  
 8:15 A M. Recorded in  
 Book 208 Page 993-996  
 Register of Deeds  
 \$20.00  
*Dee Ann MacPherson*

Computer    
 Numerical 5   
 Misc. \_\_\_\_\_

all of said leases described at (c) through (f) above covering the following described lands, to-wit:

The South Half of the Northwest Quarter (S/2 NW/4) of Section Ten (10), Township Eleven (11) South, Range Fifteen (15) West of the 6<sup>th</sup> P.M., Russell County, Kansas;

- (g) An oil and gas lease dated April 25, 2006, from U.S. AgBank, FCB, lessor, to John O. Farmer, Inc., lessee, and recorded in Book 207 at page 769 in the office of the register of deeds of Russell County, Kansas;
- (h) An oil and gas lease dated April 17, 2006, from Marshall Samuel Maupin, et ux., lessors, to John O. Farmer, Inc., lessee, and recorded in Book 206 at page 277 in the office of the register of deeds of Russell County, Kansas;

said leases described at (g) and (h) above covering the following described lands, to-wit:

The North Half of the Northwest Quarter (N/2 NW/4) and the East Half of the Southwest Quarter (E/2 SW/4) of Section Ten (10), Township Eleven (11) South, Range Fifteen (15) West of the 6<sup>th</sup> P.M., Russell County, Kansas;

AND WHEREAS, the leases described at (b), (c), (d), (e), (f) and (h) contain the following described language, to-wit:

"Lessee, at its option, is hereby given the right and power to pool or combine the acreage covered by this lease or any portion thereof with other land, lease or leases in the immediate vicinity thereof, when in lessee's judgment it is necessary or advisable to do so in order to properly develop and operate said lease premises so as to promote the conservation of oil, gas or other minerals in and under and that may be produced from said premises, such pooling to be of tracts contiguous to one another and to be into a unit or units not exceeding 40 acres each in the event of an oil well, or into a unit or units not exceeding 640 acres each in the event of a gas well. Lessee shall execute in writing and record in the conveyance records of the county in which the land herein leased is situated an instrument identifying and describing the pooled acreage. The entire acreage so pooled into a tract or unit shall be treated for all purposes except the payment of royalties on production from the pooled unit, as if it were included in this lease. If production is found on the pooled acreage, it shall be treated as if production is had from this lease, whether the well or wells be located on the premises

covered by this lease or not. In lieu of the royalties elsewhere herein specified, lessor shall receive on production from a unit so pooled only such portion of the royalty stipulated herein as the amount of his acreage placed in the unit or his royalty interest therein on an acreage basis bears to the total acreage so pooled in the particular unit involved."

And the lease described at (a) above contains the following described language,

to-wit:

Lessee is hereby granted the right at any time and from time to time to unitize the leased premises or any portion of portions thereof, as to all strata or any stratum or strata, with any other lands as to all strata or any stratum or strata, for the production primarily of oil or primarily of gas with or without distillate. However, no unit for the production primarily of oil shall embrace more than 40 acres, or for the production primarily of gas with or without distillate more than 640 acres; provided that if any governmental regulation shall prescribe a spacing pattern for the development of the field or allocate a producing allowable based on acreage per well, then any such unit may embrace as much additional acreage as may be so prescribed or as may be used in such allocation of allowable. Lessee shall file written unit designations in the county in which the lease premises are located. Operations upon and production from the unit shall be treated as if such operations were upon or such production were from the leased premises whether or not the well or wells are located thereon. The entire acreage within a unit shall be treated for all purposes as if it were covered by and included in this lease except that the royalty on production from the unit shall be as below provided, and except that in calculating the amount of any shut in gas royalties, only the part of the acreage originally leased and then actually embraced by this lease shall be counted. In respect to production from the unit, Lessee shall pay Lessor, in lieu of other royalties thereon, only such proportion of the royalties stipulated therein as the amount of his acreage placed in the unit, or his royalty interest therein on an acreage basis bears to the total acreage in the unit.

And the lease described at (g) above contains the following described language,

to-wit:

As to the oil and gas leasehold estate hereby granted, Lessee is expressly granted the right and privilege to consolidate said oil and gas leasehold with any other adjacent or contiguous oil and gas leasehold estates to form a consolidated oil and gas leasehold estate which shall not exceed a total area of approximately 640 acres for gas and 80 acres for oil; and in the event Lessee exercises the right and privilege of consolidation, as



herein granted, the consolidated oil and gas leasehold estate shall be deemed, treated and operated in the same manner as though the entire consolidated leasehold estate were originally covered by and included in this lease, and all royalties which shall accrue on oil or gas, produced and marketed from the consolidated estate, including all royalties payable hereunder, shall be prorated and paid to the Lessors of the various tracts included in the consolidated estate in the same proportion that the acreage of each said Lessor bears to the total acreage of the consolidated estate, and a producing oil or gas well on any portion of the consolidated estate shall operate to continue the oil and gas leasehold estate hereby granted so long as oil or gas is produced therefrom.

NOW THEREFORE, the undersigned hereby declares that the following described real estate is hereby unitized for production of oil and gas, to-wit:

A 40 acre unit beginning 2100 feet South and 740 feet East of the Northwest Corner (NW/C) of Section Ten (10), Township Eleven (11) South, Range Fifteen (15) West of the 6<sup>th</sup> P.M., Russell County, Kansas; thence East 1900 feet; thence South 917 feet; thence West 1900 feet; thence North 917 feet to the point of origin.

This unitization shall be effective the 28<sup>th</sup> day of November, 2007.

JOHN O. FARMER, INC.

By John O. Farmer III  
(Title) President

**ACKNOWLEDGMENT**

**STATE OF KANSAS, COUNTY OF RUSSELL, ss:**

Before me, the undersigned, a Notary Public, within and for the County and State, on this 28 day of November, 2007, personally appeared John O. Farmer III, (title) President of John O. Farmer, Inc., a Kansas corporation, who executed the within and foregoing Declaration Of Unitization and acknowledged to me that he executed the same for and on behalf of, and as the act and deed of said corporation for the uses and purposes therein set forth.

IN WITNESS WHEREOF, I have hereunto set my hand and official seal the day and year last above written.

My appointment expires: 01/20/10

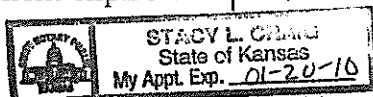

Stacy L. Craig  
Notary Public

Stacy L. Craig

DECLARATION OF UNITIZATION, Page 4 of 4 pages.

BOOK 208 PAGE 0996

## Summary of Changes

Lease Name and Number: Bowlby-Maupin 2

API/Permit #: 15-167-24104-00-00

Doc ID: 1561982

Correction Number: 1

Approved By: Rick Hestermann 03/02/2021

Field Name	Previous Value	New Value
Fresh Water Information Source: KDWR	Yes	No
KCC Only - Approved By	Rick Hestermann 02/25/2021	Rick Hestermann 03/02/2021
KCC Only - Approved Date	02/25/2021	03/02/2021
KCC Only - Date Received	02/25/2021	03/01/2021
Save Link	../../../../kcc/detail/operatorEditDetail.cfm?docID=1559540	../../../../kcc/detail/operatorEditDetail.cfm?docID=1561982

## Summary of Attachments

Lease Name and Number: Bowlby-Maupin 2

API: 15-167-24104-00-00

Doc ID: 1561982

Correction Number: 1

Approved By: Rick Hestermann 03/02/2021

Attachment Name