

**KANSAS CORPORATION COMMISSION
OIL & GAS CONSERVATION DIVISION**

Form ACO-4
Form must be typed
March 2009

APPLICATION FOR COMMINGLING OF PRODUCTION (K.A.R. 82-3-123) OR FLUIDS (K.A.R. 82-3-123a) *Commingling ID #* _____

OPERATOR: License # _____ API No. 15 - _____
 Name: _____ Spot Description: _____
 Address 1: _____ - - - - - Sec. _____ Twp. _____ S. R. _____ ☐ East ☐ West
 Address 2: _____ Feet from ☐ North / ☐ South Line of Section
 City: _____ State: _____ Zip: _____ + _____ Feet from ☐ East / ☐ West Line of Section
 Contact Person: _____ County: _____
 Phone: (_____) _____ Lease Name: _____ Well #: _____

☐ 1. Name and upper and lower limit of each production interval to be commingled:

Formation: _____	(Perfs): _____
Formation: _____	(Perfs): _____
Formation: _____	(Perfs): _____
Formation: _____	(Perfs): _____
Formation: _____	(Perfs): _____

☐ 2. Estimated amount of fluid production to be commingled from each interval:

Formation: _____	BOPD: _____	MCFPD: _____	BWPD: _____
Formation: _____	BOPD: _____	MCFPD: _____	BWPD: _____
Formation: _____	BOPD: _____	MCFPD: _____	BWPD: _____
Formation: _____	BOPD: _____	MCFPD: _____	BWPD: _____
Formation: _____	BOPD: _____	MCFPD: _____	BWPD: _____

☐ 3. Plat map showing the location of the subject well, all other wells on the subject lease, and all wells on offsetting leases within a 1/2 mile radius of the subject well, and for each well the names and addresses of the lessee of record or operator.

☐ 4. Signed certificate showing service of the application and affidavit of publication as required in K.A.R. 82-3-135a.

For Commingling of PRODUCTION ONLY, include the following:

- ☐ 5. Wireline log of subject well. Previously Filed with ACO-1: ☐ Yes ☐ No
- ☐ 6. Complete Form ACO-1 (*Well Completion form*) for the subject well.

For Commingling of FLUIDS ONLY, include the following:

- ☐ 7. Well construction diagram of subject well.
- ☐ 8. Any available water chemistry data demonstrating the compatibility of the fluids to be commingled.

AFFIDAVIT: I am the affiant and hereby certify that to the best of my current information, knowledge and personal belief, this request for commingling is true and proper and I have no information or knowledge, which is inconsistent with the information supplied in this application.

Submitted Electronically

KCC Office Use Only

☐ Denied ☐ Approved

15-Day Periods Ends: _____

Approved By: _____ Date: _____

Protests may be filed by any party having a valid interest in the application. Protests must be in writing and comply with K.A.R. 82-3-135b and must be filed within 15 days of publication of the notice of application.

AFFIDAVIT

STATE OF KANSAS)
 - SS.
County of Sedgwick)

Peter Fiorini, of lawful age, being first duly sworn, deposeth and saith: That he is Production Manager of Ritchie Exploration, County of Sedgwick, State of Kansas, and that notice was given to all lessee of record or operator within ½ mile radius of the Collins 32C #1 well located in the County of Logan (see attached plat map). This notice included a letter regarding commingling of production application. All notices were mailed on May 25, 2021.

made as aforesaid on the 25th of

May A.D. 2021

And affiant further says that he has personal knowledge of the statements above set forth and that they are true.

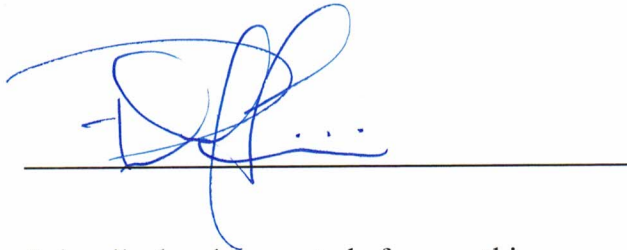

Subscribed and sworn to before me this

25th day of May 2021

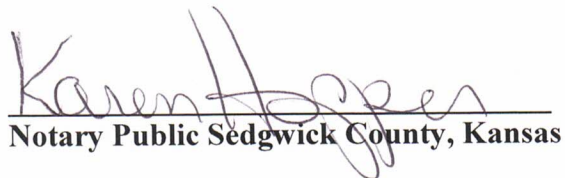

Notary Public Sedgwick County, Kansas

Confidentiality Requested:

☒ Yes ☐ NoKANSAS CORPORATION COMMISSION
OIL & GAS CONSERVATION DIVISION

Form ACO-1

January 2018

Form must be Typed

Form must be Signed

All blanks must be Filled

CONFIDENTIAL**WELL COMPLETION FORM**
WELL HISTORY - DESCRIPTION OF WELL & LEASEOPERATOR: License # 4767Name: Ritchie Exploration, Inc.Address 1: 8100 E 22ND ST N # 700Address 2: BOX 783188City: WICHITA State: KS Zip: 67278 + 3188Contact Person: Peter FioriniPhone: (316) 691-9500CONTRACTOR: License # 33575Name: WW Drilling, LLCWellsite Geologist: Kent MatsonPurchaser: CHS

Designate Type of Completion:

☒ New Well ☐ Re-Entry ☐ Workover☒ Oil ☐ WSW ☐ SWD☐ Gas ☐ DH ☐ EOR☐ OG ☐ GSW☐ CM (Coal Bed Methane)☐ Cathodic ☐ Other (Core, Expl., etc.): _____

If Workover/Re-entry: Old Well Info as follows:

Operator: _____

Well Name: _____

Original Comp. Date: _____ Original Total Depth: _____

☐ Deepening ☐ Re-perf. ☐ Conv. to EOR ☐ Conv. to SWD
☐ Plug Back ☐ Liner ☐ Conv. to GSW ☐ Conv. to Producer☐ Commingled Permit #: _____☐ Dual Completion Permit #: _____☐ SWD Permit #: _____☐ EOR Permit #: _____☐ GSW Permit #: _____01/20/2019 02/04/2019 02/04/2019Spud Date or
Recompletion Date Date Reached TD Completion Date or
Recompletion DateAPI No.: 15-109-21583-00-00Spot Description: 152'S & 57'E of- S2 - NW-SW Sec. 32 Twp. 12 S. R. 36 ☐ East ☒ West1498 Feet from ☐ North / ☒ South Line of Section717 Feet from ☐ East / ☒ West Line of Section

Footages Calculated from Nearest Outside Section Corner:

☐ NE ☐ NW ☐ SE ☒ SWGPS Location: Lat: _____, Long: _____
(e.g. xx.xxxxx) (e.g. -xxx.xxxxx)Datum: ☐ NAD27 ☐ NAD83 ☐ WGS84County: LoganLease Name: COLLINS 32C Well #: 1

Field Name: _____

Producing Formation: Pleasanton & AltamontElevation: Ground: 3165 Kelly Bushing: 3173Total Vertical Depth: 4840 Plug Back Total Depth: 4794Amount of Surface Pipe Set and Cemented at: 221 FeetMultiple Stage Cementing Collar Used? ☒ Yes ☐ NoIf yes, show depth set: 2532 FeetIf Alternate II completion, cement circulated from: 0feet depth to: 2532 w/ 500 sx cmt.**Drilling Fluid Management Plan**

(Data must be collected from the Reserve Pit)

Chloride content: 16000 ppm Fluid volume: 800 bblsDewatering method used: Evaporated

Location of fluid disposal if hauled offsite:

Operator Name: _____

Lease Name: _____ License #: _____

Quarter _____ Sec. _____ Twp. _____ S. R. _____ ☐ East ☐ West

County: _____ Permit #: _____

AFFIDAVIT

I am the affiant and I hereby certify that all requirements of the statutes, rules and regulations promulgated to regulate the oil and gas industry have been fully complied with and the statements herein are complete and correct to the best of my knowledge.

Submitted Electronically

KCC Office Use ONLY☒ Confidentiality RequestedDate: 04/29/2019☐ Confidential Release Date: 04/28/2021☒ Wireline Log Received ☒ Drill Stem Tests Received☒ Geologist Report / Mud Logs Received☐ UIC DistributionALT ☐ I ☒ II ☐ III Approved by: Karen Ritter Date: 04/29/2019

Operator Name: Ritchie Exploration, Inc. Lease Name: COLLINS 32C Well #: 1
 Sec. 32 Twp. 12 S. R. 36 ☐ East ☒ West County: Logan

INSTRUCTIONS: Show important tops of formations penetrated. Detail all cores. Report all final copies of drill stems tests giving interval tested, time tool open and closed, flowing and shut-in pressures, whether shut-in pressure reached static level, hydrostatic pressures, bottom hole temperature, fluid recovery, and flow rates if gas to surface test, along with final chart(s). Attach extra sheet if more space is needed.

Final Radioactivity Log, Final Logs run to obtain Geophysical Data and Final Electric Logs must be emailed to kcc-well-logs@kcc.ks.gov. Digital electronic log files must be submitted in LAS version 2.0 or newer AND an image file (TIFF or PDF).

Drill Stem Tests Taken <input checked="" type="checkbox"/> Yes <input type="checkbox"/> No <i>(Attach Additional Sheets)</i> Samples Sent to Geological Survey <input checked="" type="checkbox"/> Yes <input type="checkbox"/> No Cores Taken <input type="checkbox"/> Yes <input checked="" type="checkbox"/> No Electric Log Run <input checked="" type="checkbox"/> Yes <input type="checkbox"/> No Geologist Report / Mud Logs <input checked="" type="checkbox"/> Yes <input type="checkbox"/> No List All E. Logs Run: Triple Combo Log	<input type="checkbox"/> Log Formation (Top), Depth and Datum <input checked="" type="checkbox"/> Sample Name Top Datum See Attached
---	--

CASING RECORD <input checked="" type="checkbox"/> New <input type="checkbox"/> Used							
Report all strings set-conductor, surface, intermediate, production, etc.							
Purpose of String	Size Hole Drilled	Size Casing Set (In O.D.)	Weight Lbs. / Ft.	Setting Depth	Type of Cement	# Sacks Used	Type and Percent Additives
Surface	12.25	8.83	23	221	Common	175	3% CC, 2% Gel
Production	7.88	4.5	10.5	4831	Common	220	10% salt, 2% gel, 5# per sack Kol-Seal &

ADDITIONAL CEMENTING / SQUEEZE RECORD				
Purpose:	Depth Top Bottom	Type of Cement	# Sacks Used	Type and Percent Additives
<input type="checkbox"/> Perforate <input type="checkbox"/> Protect Casing <input type="checkbox"/> Plug Back TD <input type="checkbox"/> Plug Off Zone	-			
	-			

1. Did you perform a hydraulic fracturing treatment on this well? ☐ Yes ☒ No *(If No, skip questions 2 and 3)*
 2. Does the volume of the total base fluid of the hydraulic fracturing treatment exceed 350,000 gallons? ☐ Yes ☐ No *(If No, skip question 3)*
 3. Was the hydraulic fracturing treatment information submitted to the chemical disclosure registry? ☐ Yes ☐ No *(If No, fill out Page Three of the ACO-1)*

Date of first Production/Injection or Resumed Production/ Injection: <u>04/23/2019</u>		Producing Method: <input type="checkbox"/> Flowing <input checked="" type="checkbox"/> Pumping <input type="checkbox"/> Gas Lift <input type="checkbox"/> Other <i>(Explain)</i> _____			
Estimated Production Per 24 Hours	Oil Bbls. 16	Gas Mcf	Water Bbls. 20	Gas-Oil Ratio	Gravity 22

DISPOSITION OF GAS: <input type="checkbox"/> Vented <input type="checkbox"/> Sold <input type="checkbox"/> Used on Lease <i>(If vented, Submit ACO-18.)</i>	METHOD OF COMPLETION: <input type="checkbox"/> Open Hole <input checked="" type="checkbox"/> Perf. <input type="checkbox"/> Dually Comp. <input type="checkbox"/> Commingled <i>(Submit ACO-5) (Submit ACO-4)</i>	PRODUCTION INTERVAL: Top Bottom <u>4229</u> <u>4357</u>
---	---	---

Shots Per Foot	Perforation Top	Perforation Bottom	Bridge Plug Type	Bridge Plug Set At	Acid, Fracture, Shot, Cementing Squeeze Record <i>(Amount and Kind of Material Used)</i>
4	4354	4357			500 gals 15% MCA
4	4276	4279			500 gals 15% MCA & 1000 gals 28% NE
TUBING RECORD: Size: <u>2.375</u> Set At: <u>4414</u> Packer At: <u> </u>					

Form	ACO1 - Well Completion
Operator	Ritchie Exploration, Inc.
Well Name	COLLINS 32C 1
Doc ID	1458536

Casing

Purpose Of String	Size Hole Drilled	Size Casing Set	Weight	Setting Depth	Type Of Cement	Number of Sacks Used	Type and Percent Additives
Surface	12.25	8.83	23	221	Common	175	3% CC, 2% Gel
Production	7.88	4.5	10.5	4831	Common	220	10% salt, 2% gel, 5# per sack Kol-Seal & 14% CD1-26

APPLICATION FOR COMMINGLING OF PRODUCTION OR FLUIDS

**Operator, Lessee or Unleased Mineral Owner
within a ½ mile radius of Ritchie Exploration, Inc.'s**

**#1 Collins 32C
1,498' FSL & 717' FWL
Section 32-12S-36W
Logan Co., KS**

Township 12 South, Range 36 West

Sec. 31:	NE/4	Kvasnicka Family Trust, U/T/A dated May 28, 1999 William G. Kvasnicka & Constance E. Kvasnicka, Trustees 17510 W 119 TH Street, Apt. 119 Olathe, KS 66061	Mineral Owner
	SE/4	Wilbur C. Mountford Trust No. 1, dated March 1, 1982 Wilbur C. Mountford & Betty L. Mountford, Trustees 23147 W. 71 ST Terrace Shawnee, KS 66227	Mineral Owner
		Betty L. Mountford Trust No. 1, dated March 1, 1982 Betty L. Mountford & Wilbur C. Mountford, Trustees 23147 W. 71 ST Terrace Shawnee, KS 66227	Mineral Owner
Sec. 32:	NW/4	Ritchie Exploration, Inc. P.O. Box 783188 Wichita, KS 67278-3188	Lessee
	SW/4	Ritchie Exploration, Inc. P.O. Box 783188 Wichita, KS 67278-3188	Operator: #1 Collins 32C
		Phillip L. Collins Intervivos Trust PO Box 196 Winona, KS 67764	Mineral Owner
		Phillip L. Collins PO Box 196 Winona, KS 67764	Mineral Owner
	E/2	Fossil Resources, LLC 111 W. 36 TH ST Hays, KS 67601	Operator: Smith 1

Township 13 South, Range 36 West

Sec. 5:	NE/4	CMX, Inc. 1700 N Waterfront Pkwy, Bldg 300, Ste B Wichita, KS 67206	Operator: Gaskill Range 1-5
	NW/4	Gaskill Range, L.P., a Kansas limited partnership Guy C. Gaskill, General Partner PO Box 235 Winona, KS 67764	Mineral Owner
Sec. 6:	NE/4	Chester L. Collins Trust No. 1 (Nancy J. Wilford Trust B Share), dated May 1, 1982 Nancy J. Wilford & Bryan Latham, Trustees 900 S. Honeybrook Lane Derby, KS 67037	Mineral Owner

R 36 W

T
12
S

T
13
S

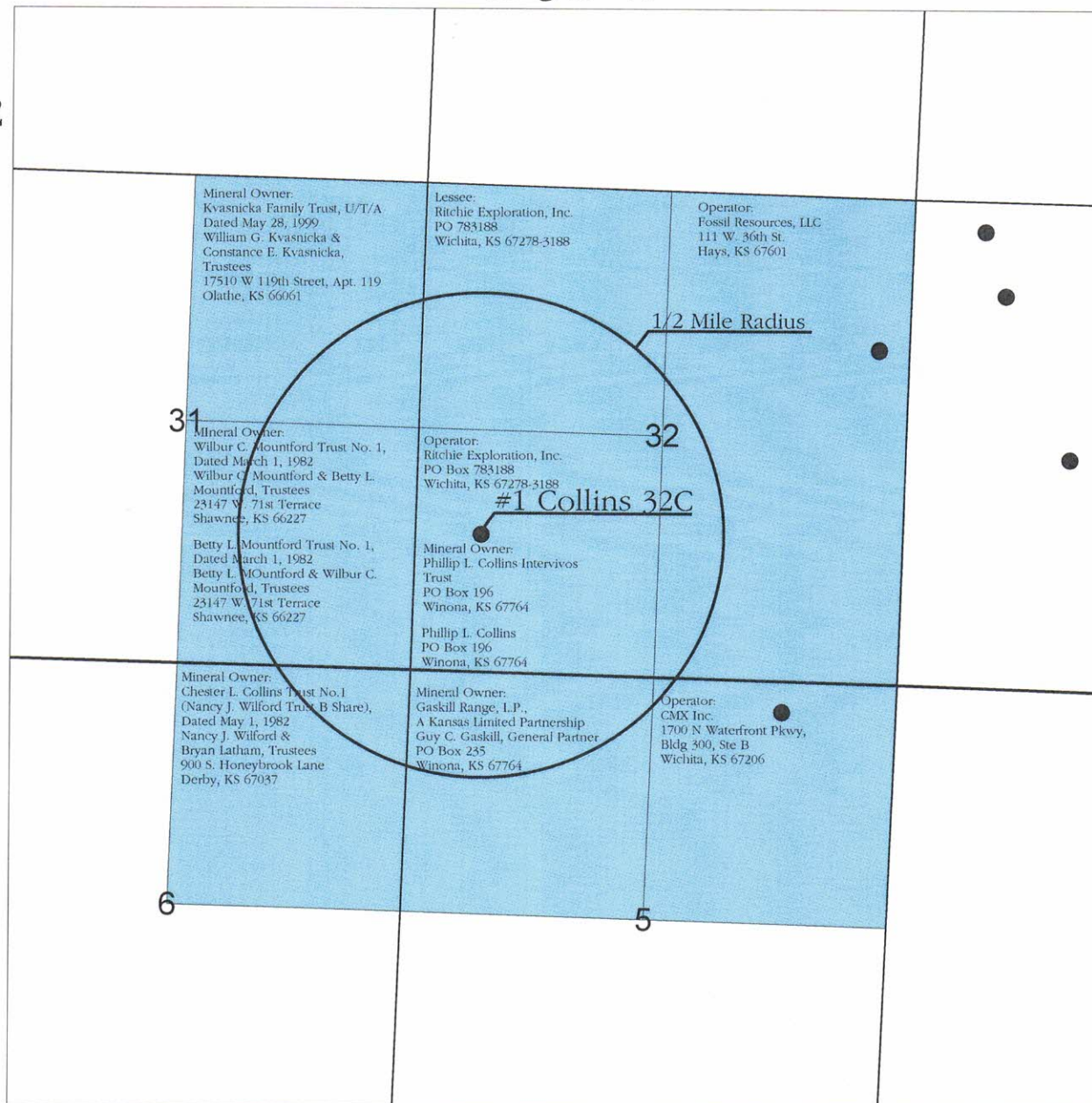

 RITCHIE EXPLORATION, INC. Wichita, Kansas		Application for Commingling of Production or Fluids	
		Applicant Well: #1 Collins 32C API: 15-109-21583 All Wells on Offsetting Leases within a 1/2 Mile Radius Name and Address of Lessee of Record, Operator, or Unleased Mineral Owner	
Logan County, Kansas			
Prepared By: Justin Clegg	Scale: 1 : 22,000	Date: May 19, 2021	

Proof of Publication

State of Kansas,
County of Logan, ss:

of lawful age, being duly sworn upon oath states that he/she is the editor of **THE OAKLEY GRAPHIC**.

THAT said newspaper has been published at least weekly 50 times a year and has been so published for at least five years prior to the first publication of the attached notice.

THAT said newspaper was entered as second class matter at the post office of its publication;

THAT said newspaper has a general paid circulation on a daily, weekly, monthly, or yearly basis in LOGAN County, Kansas and is NOT a trade, religious or fraternal publication and has been printed and published in LOGAN County, Kansas.

THE ATTACHED was published on the following dates in a regular issue of said newspaper:

1st Publication was made on the 2nd day of June, 20 21

2nd Publication was made on the _____ day of _____, 20 _____

3rd Publication was made on the _____ day of _____, 20 _____

4th Publication was made on the _____ day of _____, 20 _____

5th Publication was made on the _____ day of _____, 20 _____

6th Publication was made on the _____ day of _____, 20 _____

Publication fee \$ 47.70

Affidavit, Notary's Fees \$ _____

Additional Copies _____ @ _____ \$ _____

Total Publication Fee \$ 47.70

Keri Traynor
(Signed)

Witness my hand this 3rd day of June, 20 21

SUBSCRIBED and SWORN to before me this 3rd

day of June, 20 21

Anita Gabel
(Notary Public)

My commission expires January 16, 2024

ANITA GABEL
Notary Public - State of Kansas
My Appointment Expires 01-16-24

(First published in The Oakley Graphic on June 2, 2021.)

LEGAL NOTICE

You, and each of you, are hereby notified that Ritchie Exploration, Inc. has filed an application to commence the commingling of production from the Pleasanton and Altamont B sources of supply for the #1 Collin 32C well located approx. S/2 NW SW, of Section Sec. 32-12S-36W, Logan County, Kansas.

Any persons who object to or protest this application shall be required to file their objections or protests with the Conservation Division of the State Corporation Commission of the State of Kansas within fifteen (15) days from the date of the publication. These protests shall be filed pursuant to Commission regulations and must state specific reasons why the grant of the application may cause waste, violate correlative rights or pollute the natural resources of the state of Kansas.

If no protests are received, this application may be granted through a summary proceeding. If valid protests are received, this matter will be set for hearing.

All persons interested or concerned shall take notice of the foregoing and shall govern themselves accordingly.

RITCHIE EXPLORATION,
INC.
P.O. Box 783188
Wichita, KS 67278-3188
(316) 691-9500



Beaufort Gazette
Belleville News-Democrat
Bellingham Herald
Bradenton Herald
Centre Daily Times
Charlotte Observer
Columbus Ledger-Enquirer
Fresno Bee

The Herald - Rock Hill
Herald Sun - Durham
Idaho Statesman
Island Packet
Kansas City Star
Lexington Herald-Leader
Merced Sun-Star
Miami Herald

el Nuevo Herald - Miami
Modesto Bee
Raleigh News & Observer
The Olympian
Sacramento Bee
Fort Worth Star-Telegram
The State - Columbia
Sun Herald - Biloxi

Sun News - Myrtle Beach
The News Tribune Tacoma
The Telegraph - Macon
San Luis Obispo Tribune
Tri-City Herald
Wichita Eagle

AFFIDAVIT OF PUBLICATION

Account #	Order Number	Identification	Order PO	Amount	Cols	Depth
24452	72595	Print Legal Ad - IPL0025739		\$225.46	1	3.79

Attention: Peter Fiorini
RITCHIE EXPLORATION INC
P O BOX 783188
WICHITA, KS 672783188

LEGAL PUBLICATION

LEGAL NOTICE

You, and each of you, are hereby notified that Ritchie Exploration, Inc. has filed an application to commence the commingling of production from the Pleasanton and Altamont B sources of supply for the #1 Collins 32C well located approx. S/2 NW SE of Section 32-12S-36W, Logan County, Kansas.

Any persons who object to or protest this application shall be required to file their objections or protests with the Conservation Division of the State Corporation Commission of the State of Kansas within fifteen (15) days from the date of the publication. These protests shall be filed pursuant to Commission regulations and must state specific reasons why the grant of the application may cause waste, violate correlative rights or pollute the natural resources of the state of Kansas.

If no protests are received, this application may be granted through a summary proceeding. If valid protests are received, this matter will be set for hearing.

All persons interested or concerned shall take notice of the foregoing and shall govern themselves accordingly.

RITCHIE EXPLORATION, INC.
P.O. Box 783188
Wichita, KS 67278-3188
(316) 691-9500
IPL0025739
May 27 2021

In The STATE OF KANSAS
In and for the County of Sedgwick

No. of Insertions: 1
Beginning Issue of: 05/27/2021
Ending Issue of: 05/27/2021

STATE OF KANSAS)

SS

County of Sedgwick)

Hayley Martin, of lawful age, being first duly sworn, depose and saith: That he is Record Clerk of The Wichita Eagle, a daily newspaper published in the City of Wichita, County of Sedgwick, State of Kansas, and having a general paid circulation on a daily basis in said County, which said newspaper has been continuously and uninterruptedly published in said County for more than one year prior to the first publication of the notice hereinafter mentioned, and which said newspaper has been entered as second class mail matter at the United States Post Office in Wichita, Kansas, and which said newspaper is not a trade, religious or fraternal publication and that a notice of a true copy is hereto attached was published in the regular and entire Morning issue of said The Wichita Eagle from 05/27/2021 to 05/27/2021.

I certify (or declare) under penalty of perjury that the foregoing is true and correct.

DATED: 06/28/2021

Notary Public in and for the state of Texas, residing in Dallas County

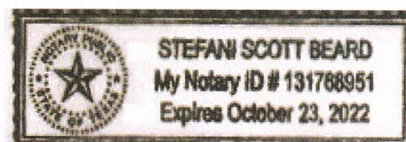

Extra charge for lost or duplicate affidavits.
Legal document please do not destroy!

Conservation Division
266 N. Main St., Ste. 220
Wichita, KS 67202-1513



Phone: 316-337-6200
Fax: 316-337-6211
<http://kcc.ks.gov/>

Andrew J. French, Chairperson
Dwight D. Keen, Commissioner
Susan K. Duffy, Commissioner

Laura Kelly, Governor

June 29, 2021

Peter Fiorini
Ritchie Exploration, Inc.
P.O. Box 783188
Wichita, KS 67278-3188

RE: Approved Commingling CO062103
Collins 32C #1
API No. 15-109-21583-00-00

Dear Mr. Fiorini:

Your Application for Commingling (ACO-4) for the above described well has been reviewed and approved by the Kansas Corporation Commission (KCC) per K.A.R. 82-3-123. Notice was examined and found to be proper per K.A.R. 82-3-135a. No protest had been filed within the 15-day protest period.

Based upon the depth of the Altamont B formation perforations, total oil production shall not exceed 200 BOPD and total gas production shall not exceed 50% of the absolute open flow (AOF).

Sincerely,

Rick Hestermann
Production Department