

KANSAS CORPORATION COMMISSION
OIL & GAS CONSERVATION DIVISION

Form CP-1
March 2010

This Form must be Typed
Form must be Signed
All blanks must be Filled

WELL PLUGGING APPLICATION

Form KSONA-1, Certification of Compliance with the Kansas Surface Owner Notification Act,
MUST be submitted with this form.

OPERATOR: License #: _____
Name: _____
Address 1: _____
Address 2: _____
City: _____ State: _____ Zip: _____ + _____
Contact Person: _____
Phone: (_____) _____

API No. 15 - _____
If pre 1967, supply original completion date: _____
Spot Description: _____
____ - ____ - ____ Sec. ____ Twp. ____ S. R. ____ East West
____ Feet from North / South Line of Section
____ Feet from East / West Line of Section
Footages Calculated from Nearest Outside Section Corner:
 NE NW SE SW
County: _____
Lease Name: _____ Well #: _____

Check One: Oil Well Gas Well OG D&A Cathodic Water Supply Well Other: _____
 SWD Permit #: _____ ENHR Permit #: _____ Gas Storage Permit #: _____

Conductor Casing Size: _____ Set at: _____ Cemented with: _____ Sacks
Surface Casing Size: _____ Set at: _____ Cemented with: _____ Sacks
Production Casing Size: _____ Set at: _____ Cemented with: _____ Sacks

List (ALL) Perforations and Bridge Plug Sets:

Elevation: _____ (G.L. / K.B.) T.D.: _____ PBTD: _____ Anhydrite Depth: _____
(Stone Corral Formation)

Condition of Well: Good Poor Junk in Hole Casing Leak at: _____
(Interval)

Proposed Method of Plugging (attach a separate page if additional space is needed):

Is Well Log attached to this application? Yes No Is ACO-1 filed? Yes No

If ACO-1 not filed, explain why:

Plugging of this Well will be done in accordance with K.S.A. 55-101 et. seq. and the Rules and Regulations of the State Corporation Commission

Company Representative authorized to supervise plugging operations: _____

Address: _____ City: _____ State: _____ Zip: _____ + _____

Phone: (_____) _____

Plugging Contractor License #: _____ Name: _____

Address 1: _____ Address 2: _____

City: _____ State: _____ Zip: _____ + _____

Phone: (_____) _____

Proposed Date of Plugging (if known): _____

Payment of the Plugging Fee (K.A.R. 82-3-118) will be guaranteed by Operator or Agent

Submitted Electronically

KANSAS CORPORATION COMMISSION
OIL & GAS CONSERVATION DIVISION

Form KSONA-1

July 2021

Form Must Be Typed

Form must be Signed

All blanks must be Filled

**CERTIFICATION OF COMPLIANCE WITH THE
KANSAS SURFACE OWNER NOTIFICATION ACT**

This form must be submitted with all Forms C-1 (Notice of Intent to Drill); CB-1 (Cathodic Protection Borehole Intent); T-1 (Request for Change of Operator Transfer of Injection or Surface Pit Permit); and CP-1 (Well Plugging Application). Any such form submitted without an accompanying Form KSONA-1 will be returned.

Select the corresponding form being filed: C-1 (Intent) CB-1 (Cathodic Protection Borehole Intent) T-1 (Transfer) CP-1 (Plugging Application)

OPERATOR: License # _____

Name: _____

Address 1: _____

Address 2: _____

City: _____ State: _____ Zip: _____ + _____

Contact Person: _____

Phone: (_____) _____ Fax: (_____) _____

Email Address: _____

Well Location:

____ - ____ - ____ - ____ Sec. ____ Twp. ____ S. R. ____ East West

County: _____

Lease Name: _____ Well #: _____

If filing a Form T-1 for multiple wells on a lease, enter the legal description of the lease below:

Surface Owner Information:

Name: _____

Address 1: _____

Address 2: _____

City: _____ State: _____ Zip: _____ + _____

When filing a Form T-1 involving multiple surface owners, attach an additional sheet listing all of the information to the left for each surface owner. Surface owner information can be found in the records of the register of deeds for the county, and in the real estate property tax records of the county treasurer.

If this form is being submitted with a Form C-1 (Intent) or CB-1 (Cathodic Protection Borehole Intent), you must supply the surface owners and the KCC with a plat showing the predicted locations of lease roads, tank batteries, pipelines, and electrical lines. The locations shown on the plat are preliminary non-binding estimates. The locations may be entered on the Form C-1 plat, Form CB-1 plat, or a separate plat may be submitted.

Select one of the following:

- I certify that, pursuant to the Kansas Surface Owner Notice Act (see Chapter 55 of the Kansas Statutes Annotated), I have provided the following to the surface owner(s) of the land upon which the subject well is or will be located: 1) a copy of the Form C-1, Form CB-1, Form T-1, or Form CP-1 that I am filing in connection with this form; 2) if the form being filed is a Form C-1 or Form CB-1, the plat(s) required by this form; and 3) my operator name, address, phone number, fax, and email address.
- I have not provided this information to the surface owner(s). I acknowledge that, because I have not provided this information, the KCC will be required to send this information to the surface owner(s). To mitigate the additional cost of the KCC performing this task, I acknowledge that I must provide the name and address of the surface owner by filling out the top section of this form and that I am being charged a \$30.00 handling fee, payable to the KCC, which is enclosed with this form.

If choosing the second option, submit payment of the \$30.00 handling fee with this form. If the fee is not received with this form, the KSONA-1 form and the associated Form C-1, Form CB-1, Form T-1, or Form CP-1 will be returned.

I Submitted Electronically

I

Form	CP1 - Well Plugging Application
Operator	Vincent Oil Corporation
Well Name	BEESELEY 1
Doc ID	1640326

Perforations And Bridge Plug Sets

Perforation Top	Perforation Base	Formation	Bridge Plug Depth
4155	4158	Pawnee	3950
4155	4158	Pawnee	3910
3855	3862	Lansing -Kansas City	
3836	3850	Lansing -Kansas City	
3784	3792	Lansing -Kansas City	
3740	3748	Lansing -Kansas City	

Wellbore Diagram:

Company: VINCENT OIL Corp.
 Well: BERSLY #1
 Location: NE-SW-SW
 Sec-Twp-Rge: 19-14-28 W
 Elevation: KB 2620
 Type: OIL WELL

* CONV. TO WSW 4/30/2012

API # 15-063-20411

8 5/8" @ 332' w/ 225 SK.

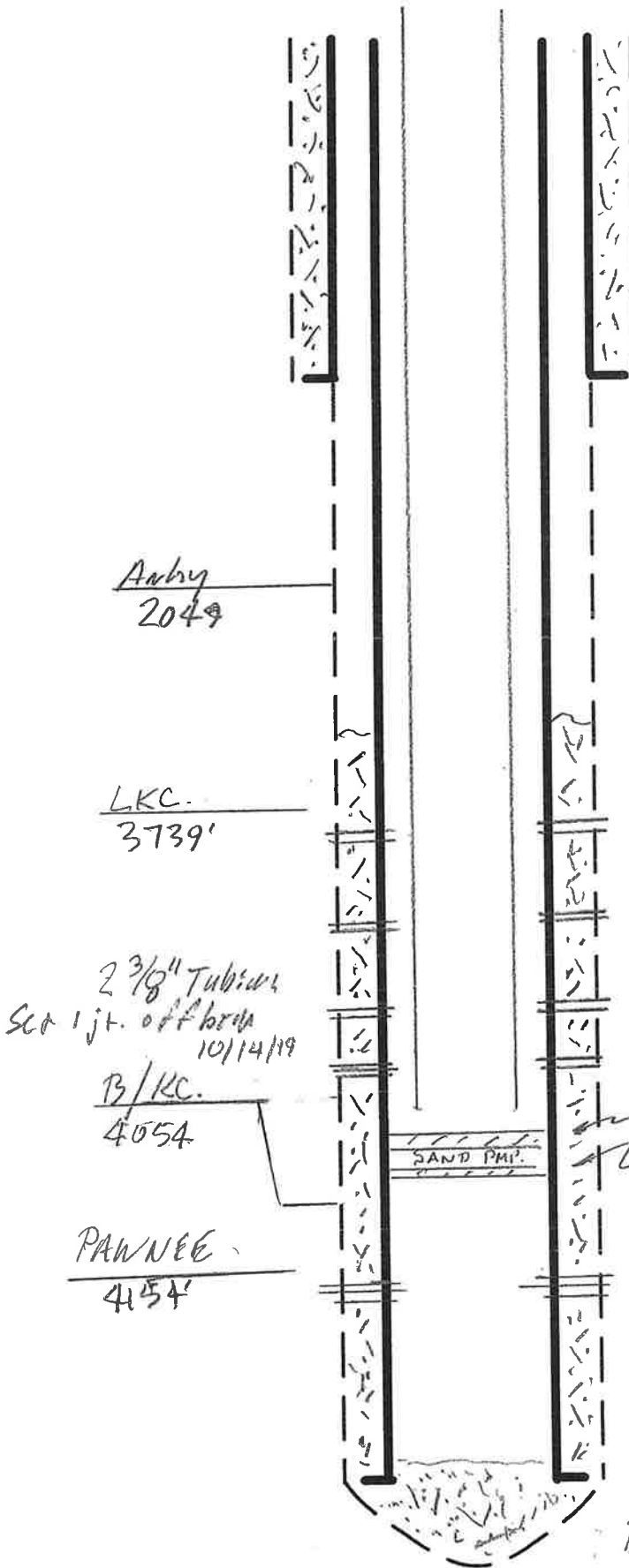

Top Cont By Bond Log @ 3690'

3740-3748

3784-3792 WTR Supply Perfs
4/25/2012

3836-3850

3855-3862

CIRP @ 3910 (10/14/2019)

CIRP @ 3950 (4/30/2012)

Perf 4155-4158 (Orig. Comp. 6/15/79)

4 1/2" @ 4422' w/ 175 SK 60/40 Poz

RTD 4424

DRILLERS LOG

OPERATOR: VINCENT OIL CORPORATION
230 O. W. Garvey Building
Wichita, Kansas 67202

LEASE: Beesley No. 1
NE SW SW Sec. 19-14S-28W
Gove County, Kansas

CONTRACTOR: Slawson Drilling Company, Inc.
200 Douglas Building
Wichita, Kansas 67202

COMMENCED: 4/16/79

COMPLETED: 4/26/79

RTD: 4424'

SURFACE CASING: 8-5/8" set at 332' with 235 sx cement

PROD. CASING: 4-1/2" set at 4422' with 175 sx cement

0' to 120' Surface Hole
120' to 338' Shells (338' 12 1/2" Surface Hole)
338' to 700' Shale
700' to 2507' Shale & Shells
2507' to 2998' Lime & Shale
2998' to 3310' Shale & Lime
3310' to 3468' Lime & Shale
3468' to 3643' Shale & Lime
3643' to 3796' Lime & Shale
3796' to 3827' Shale & Lime
3827' to 3980' Lime & Shale
3980' to 4005' Shale & Lime
4005' to 4180' Lime & Shale
4180' to 4225' Shale & Lime
4225' to 4325' Lm & Shale
4325' to 4325' Lime
4325' to 4424' Shale & Lime
RTD 4424'

STATE OF KANSAS

COUNTY OF SEDGWICK

I, James C. Remsberg, of the Slawson Drilling Company, Inc. hereby state the above is an accurate copy of the Beesley No. 1 log for Vincent Oil Corporation.

James C. Remsberg

Subscribed and sworn to me this 1st day of May, 1979

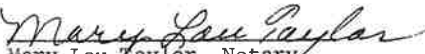
Mary Lou Taylor, Notary

My commission expires January 17, 1981





Cement Bond Log

VDL

FILE NO.

COMPANY VINCENT OIL

WELL BEESELEY #1

FIELD _____

COUNTY GOVE STATE KS.

LOCATION: NE-SW-SW
 SEC 19 TWP 14S RGE 28W

Other Services
PEAF.

Permanent Datum GROUND LEVEL Elev. 2615
 Log Measured from K.B., 5 Ft. Above Permanent Datum
 Drilling Measured from K.B.

Elevations:
 KB 2620
 DF _____
 GL 2615

Date	CSG. RECORD	Surface	Protection	Production	Liner	
5-9-79	ONE	8 5/8		4 1/2		
Run No.	Size					
4370	WT./Ft.			10.5		
Depth-Driller	Grade					
4366	Type Joint					
Depth-Logger	Top	SURF		SURF		
4361	Bottom	332		4422		
Bottom Logged Int.	PRIMARY CEMENTING DATA					
Top Logged Int.	Type Cement			100-40 PDS MIX		
3550	Vol. of Cement			175 SX		
Ft. Measured	Additive					
811	% Additive					
Type Fluid in Csg.	Retarder					
WTR.	% Retarder					
Density of Fluid	Slurry Wt.					
FULL	Water Loss					
Fluid Level	Drig. Mud Type					
Max. Temp. Deg. F.	Drig. Mud Wt.					
-	PRIMARY CEMENTING PROCEDURE					
Tool Series No.	Started Pumping	HR.	DATE	Preceding Fluid		
1408 M	Plug on Bottom			Vol.	Bbls.	
Tool Diam.	Pres. Released			Returns: Full	Partial	None
3 1/2	Started Bond Log	1030	5-9	Pipe Rot. During Pumping:	Yes	No
Standoff Size	Finished Bond Log	1230	5-9	Pipe Rot. After Plugdown:	Yes	No
-						
Logging Speed						
30						
R/A Log Type						
GIR						
T.C.						
2						
Sens. Setting						
331						
API Units/Div.						
8						
Truck or Unit No.						
LP-3031						
Location						
GT. BEND						
Opr. Rig Time						
2 HR.						
Recorded by						
FISHER						
Witnessed by						

FIELD PRINT
THANK YOU

FOLD HERE

REMARKS: CBL GAIN -- 63
 GATE -- -- 540
 SENS -- -- 265
 2-GAIN -- -- 16
 SET UP @ 3600
 RUN IN STEP -- 7

Scratch Depth
Centralizer Depths

SQUEEZE JOB DETAIL

Squeeze No.	Date	Depth Interval	Type Cement	Vol. of Cement	Additive	% Additive	Retarder	% Retarder	Slurry Wt.	Preceding Fluid	Vol. Preceding Fluid	Breakdown Pressure	Max. Pres. — Stage 1	" " 2	" " 3	Final Max. Pressure	Time Brkdn. (hr.-date)	Pumping Stopped	Pres. Released	Started Bond Log	Finished Bond Log	
1																						
2																						
3																						
4																						

Pressure read at: Surface _____ Bottom Hole _____

SEQUENCE OF CEMENT BOND LOGS

Log run following: CBL Run _____ CBL Run _____

Surface Casing Cement _____ Squeeze No. 1 _____

AVERAGE WELL DRIFT _____ from _____ to _____

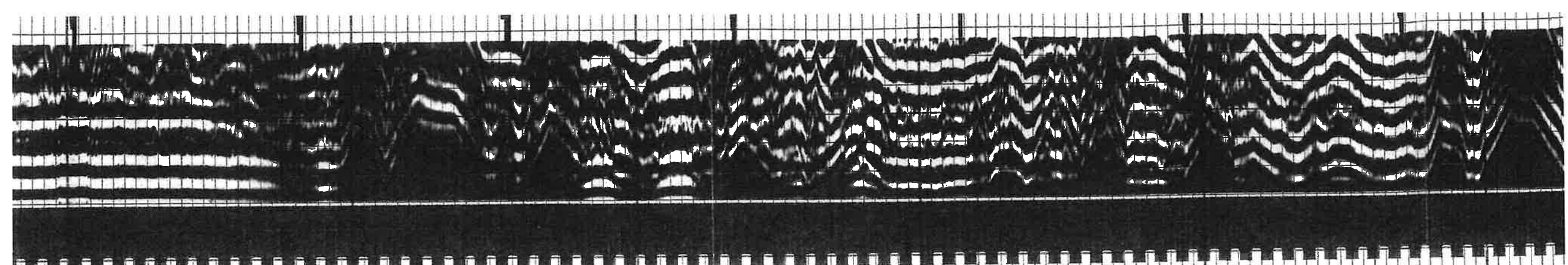

KODAK SAFETY FILM

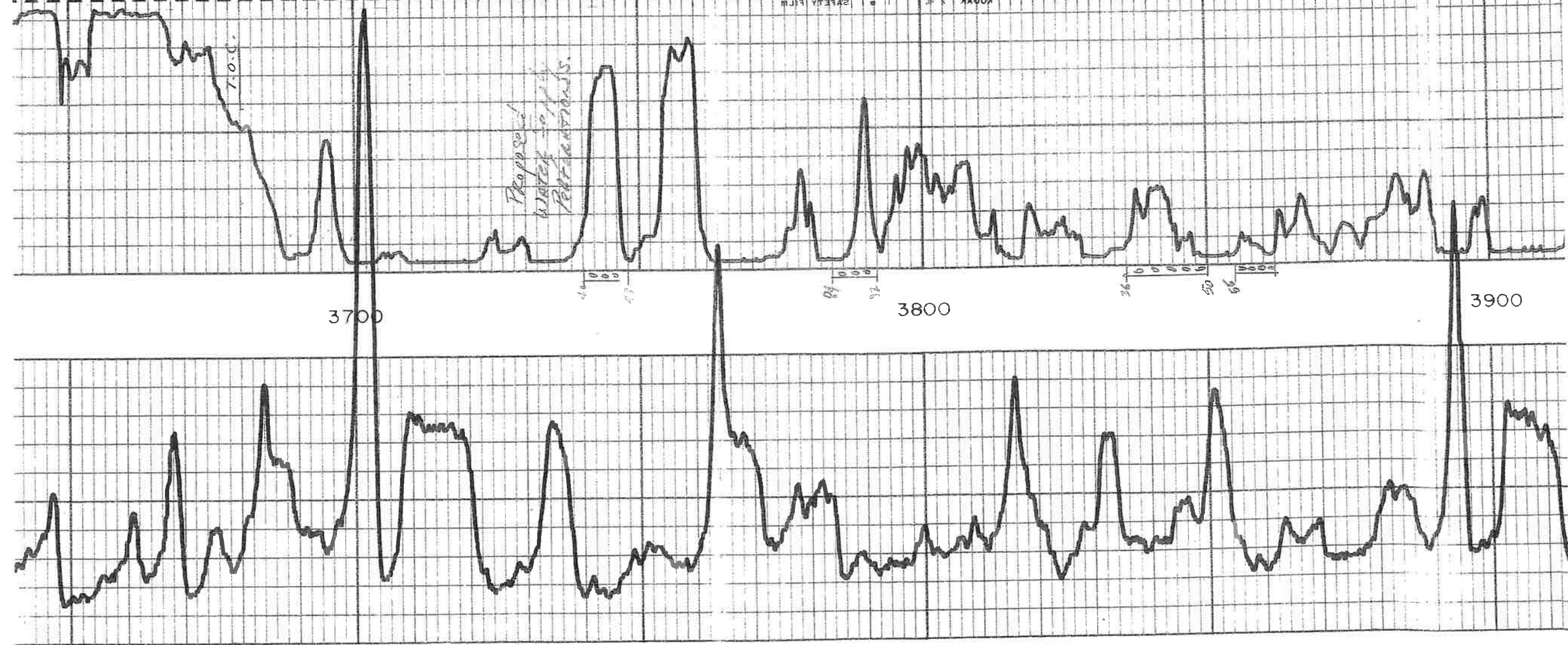

April 22, 2022

M.L. Korphage
Vincent Oil Corporation
200 W DOUGLAS AVE #725
WICHITA, KS 67202-3023

Re: Plugging Application
API 15-063-20411-00-00
BEESLEY 1
SW/4 Sec.19-14S-28W
Gove County, Kansas

Dear M.L. Korphage:

The Conservation Division has received your Well Plugging Application (CP-1).

Under K.A.R. 82-3-113(b)(2), you must notify DISTRICT 4 of your proposed plugging plan at least 5 days before plugging the well. DISTRICT 4's phone number is (785) 261-6250. Failure to notify DISTRICT 4, or failure to file a Well Plugging Record (CP-4) after the well is plugged will result in a penalty recommendation.

Under K.A.R. 82-3-600, you must file an Application for Surface Pit (CDP-1) if you wish to use a workover pit while plugging the well. Failure to timely file a CDP-1, failure to timely remove fluids, or failure to timely file Closure of Surface Pit (CDP-4) or Waste Transfer (CDP-5) forms will result in a penalty recommendation.

This receipt does NOT constitute authorization to plug this well if you do not otherwise have the legal right to do so.

This receipt is VOID after October 19, 2022. If the well is not plugged by then, you will have to submit a new CP-1 if you wish to plug the well.

The October 19, 2022 deadline does NOT override any compliance deadline given to you by Legal, District, or other Commission Staff. Failure to comply with any given deadline will still result in the Commission assessing penalties, or taking other legal action.

Sincerely,
Production Department Supervisor

cc: DISTRICT 4