

WATER WELL RECORD (WWC-5)

KOLAR DOC ID _____ WELL ID _____
 Original Record Correction Change in Well Use

LOCATION OF WATER WELL

| | | | | | | | | | | | | | | |
|----------|--|-----------|--|---------|--|----------|--|-------|--|--------|----------|---|---|---|
| Latitude | | Longitude | | Section | | Township | | Range | | E W | Fraction | ¼ | ¼ | ¼ |
| Datum | | Elevation | | County | | | | | | | | | | |

WATER WELL OWNER

| | |
|---|--|
| Name | |
| Business | |
| Address | |
| Well location at owner's address | |

WELL WATER USE

| |
|--|
| |
|--|

COMPLETION

| |
|---|
| Depth of completed well: _____ ft. |
| Depth(s) groundwater encountered: (1) _____ ft.; (2) _____ ft.; (3) _____ ft.; (4) dry well |
| Static water level in well: _____ ft. measured below land surface on (mm/dd/yy): _____ measured above land surface on (mm/dd/yy): _____ |
| Estimated yield: _____ gpm |
| Water level was: _____ ft. after _____ hours pumping _____ gpm |
| Pump installed? Yes No |
| Water well disinfected? Yes No |
| Date disinfected (mm/dd/yy): _____ |
| Aquifer, if known: |

NEAREST SOURCE OF POTENTIAL CONTAMINATION

| |
|---|
| Source: _____ |
| Distance from well: _____ Direction from well: _____ |
| Source description: _____ |
| Source: _____ |
| Distance from well: _____ Direction from well: _____ |
| Source description: _____ |
| No potential source of contamination within 100 feet. |

CONSTRUCTION

| | |
|--|---------------------------------|
| Borehole interval: from _____ to _____ ft. | Borehole diameter: _____ in. |
| from _____ to _____ ft. | _____ in. |
| Casing height above land surface: _____ in. | |
| If casing height is less than 12 in. has a variance been approved?* Yes No | |
| *variance not required for monitoring or environmental remediation wells | |
| Casing type: _____ | |
| Blank casing interval: _____ ft. to _____ ft. | |
| Blank casing diameter: _____ in. | |
| Casing joints: _____ | |
| Weight: _____ lbs/ft. | |
| Wall thickness or gauge no.: _____ | |
| Blank casing interval: _____ ft. to _____ ft. | |
| Blank casing diameter: _____ in. | |
| Casing joints: _____ | |
| Weight: _____ lbs/ft. | |
| Wall thickness or gauge no.: _____ | |
| Grout interval: _____ ft. to _____ ft. | |
| Grout material: _____ | |
| Grout interval: _____ ft. to _____ ft. | |
| Grout material: _____ | |
| Screen / perforation material: _____ | |
| Screen / perforation openings: _____ | |
| Screen / perforation intervals: From _____ ft. to _____ ft. | |
| Slot size _____ unit _____ | |
| From _____ ft. to _____ ft. | |
| Slot size _____ unit _____ | |
| Gravel pack intervals: Gravel pack not used: Gravel size _____ in | |
| From _____ ft. to _____ ft. | |
| Gravel pack not used: Gravel size _____ in | |
| From _____ ft. to _____ ft. | |

PERMIT & ID NUMBERS (AS REQUIRED)

| |
|---|
| DWR Application No.: _____ |
| KDHE / EPA Project Code: _____ |
| Site Name: _____ |
| KDHE UIC Class V Form Completed: Yes No |
| County Permit: Yes No Permit ID: _____ |
| Lease Name & Well #: _____ |
| # of boreholes: _____ # of dewatering wells: _____ |

LITHOLOGIC LOG

| FROM | TO | LITHOLOGY INTERVALS |
|------|----|---------------------|
| | | |
| | | |
| | | |
| | | |
| | | |
| | | |
| | | |
| | | |
| | | |
| | | |

COMMENTS

| |
|--|
| |
|--|

CONTRACTOR'S OR LANDOWNERS CERTIFICATION

| |
|---|
| This water well was constructed reconstructed pursuant to the stated water well contractor's license and was completed on _____. I certify that this record is true to the best of my knowledge and belief. This water well record was completed on _____ under the business name of _____, Kansas Water Well Contractor's License No. _____ under the authority of the designated person as defined in K.A.R. 28-30-2(j) and signed and certified by the electronic signature of the designated person at its submittal: _____. |
|---|

Send one copy to WATER WELL OWNER and retain one for your records. Fee of \$5.00 for each constructed well.

| | |
|------------|----------------------------|
| Form | WWC5.2 - Water Well Record |
| Doc ID | 1647448 |
| Well Owner | Iuka Coop |
| Contractor | Coranco Great Plains, Inc. |

Lithology

| From | To | Lithology Intervals |
|------|----|----------------------------------|
| 0 | 9 | clay-lean,brownish,brown |
| 9 | 14 | sand,fine,clayey,reddish,brown |
| 14 | 34 | silt,caliche stringers,brown |
| 34 | 41 | clay-lean,silty,brown |
| 41 | 46 | sand,fine,silty,tan |
| 46 | 53 | silt,clayey,light,brown |
| 53 | 67 | clay,silty,light,brown,saturated |

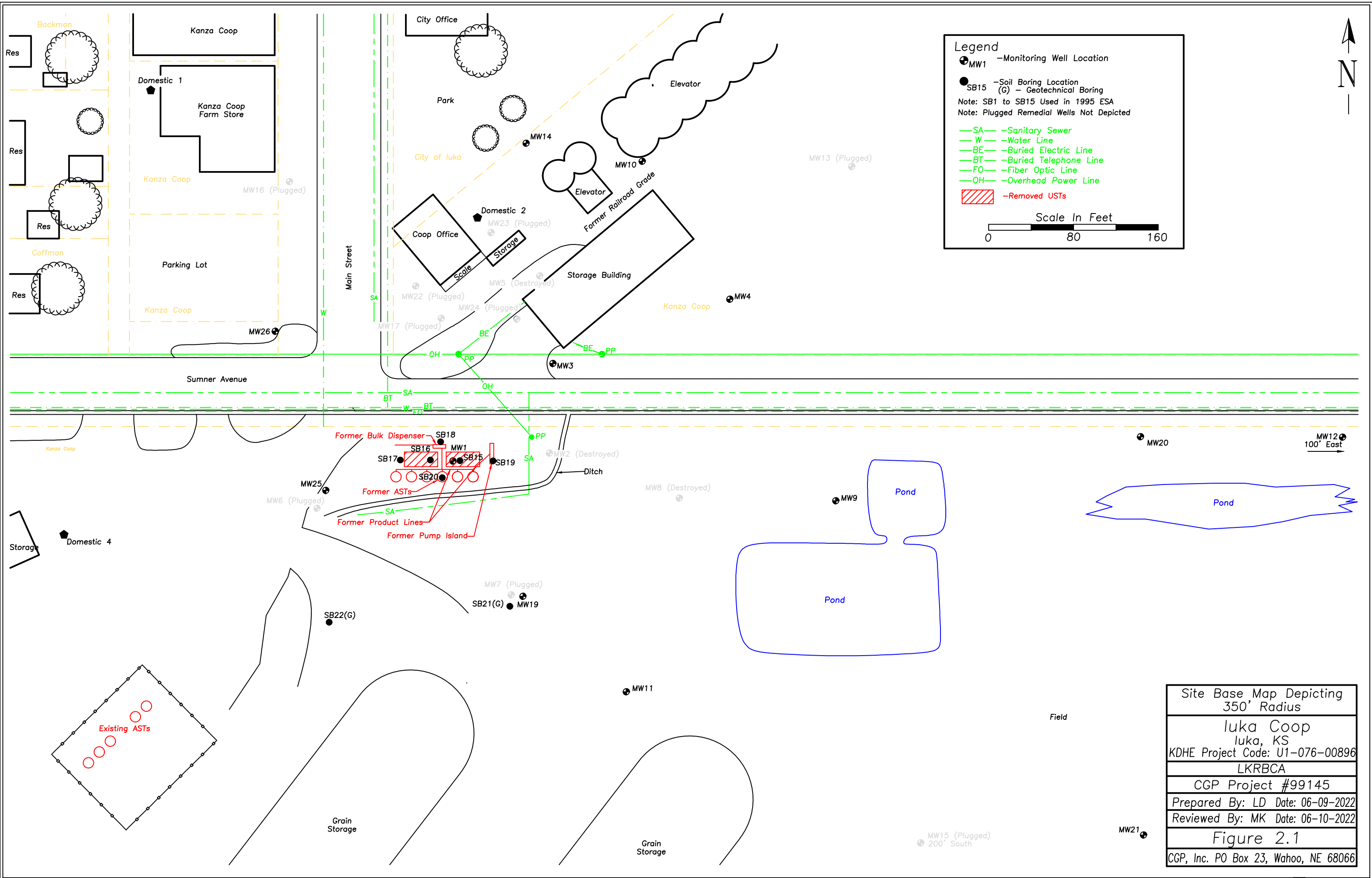

Legend

- MW1 - Monitoring Well Location
- SB15 (G) - Soil Boring Location (G) - Geotechnical Boring
- Note: SB1 to SB15 Used in 1995 ESA
- Note: Plugged Remedial Wells Not Depicted
- SA — Sanitary Sewer
- W — Water Line
- BE — Buried Electric Line
- BT — Buried Telephone Line
- FO — Fiber Optic Line
- OH — Overhead Power Line
- ▨ - Removed USTs

Scale In Feet

0 80 160

| |
|--|
| Site Base Map Depicting 350' Radius |
| Iuka Coop Iuka, KS KDHE Project Code: U1-076-00896 |
| LKRBCA |
| CGP Project #99145 |
| Prepared By: LD Date: 06-09-2022 |
| Reviewed By: MK Date: 06-10-2022 |
| Figure 2.1 |
| CGP, Inc. PO Box 23, Wahoo, NE 68066 |

99145



APR 25 2022

April 15, 2022

Coranco Great Plains, Inc.
Matt Kralik
141 W. 10th, PO Box 23
Wahoo, NE 68066
Email: mkralik@corancogreatplains.com

RE: Project No. 2204-0125

Matt.

The following is the information requested on a Monitoring Well Site, Iuka Coop, Iuka, Pratt County, Kansas.

| Point | North Coord. | East Coord. | Distance SE Cor. North | From S.3 West | Elev. Top Of Rim or PK Nail | Elev. Top of PVC Pipe | Latitude North | Longitude West |
|---------------------------|-----------------|----------------|------------------------------|---------------------|-----------------------------------|-----------------------------|-------------------|-------------------|
| SE Corner S3-T27S-R13W | 10000 | 10000 | | | | | | |
| MW25 | 13106.56 | 6600.00 | 3106.56 | 3400.00 | 1943.56 | 1942.97 | 37.72765 | 98.73234 |
| MW26 | 13257.49 | 6487.19 | 3257.49 | 3512.81 | 1947.82 | 1947.26 | 37.72806 | 98.73274 |
| Site BM | 13159.78 | 6745.08 | 3159.78 | 3254.92 | | SBM Elevation = 1943.83 | | |

Description: "□" Square cut 6' North of lift station, 300 feet ± East of intersection of Sumner and Main Streets.

MW25 and MW26 are in the: NE¼ SW¼ SE¼ NW¼ S.3-T27S-R13W

If you have any questions, please do not hesitate in giving us a call.

Sincerely,



Tim Sloan, L.S.
SMH CONSULTANTS