

**WATER WELL RECORD (WWC-5)**

KOLAR DOC ID \_\_\_\_\_ WELL ID \_\_\_\_\_  
 Original Record      Correction      Change in Well Use

**LOCATION OF WATER WELL**

Latitude		Longitude		Section		Township		Range		E W	Fraction		¼		¼		¼
Datum		Elevation		County													

**WATER WELL OWNER**

Name	
Business	
Address	
Well location  at owner's address	

**WELL WATER USE**

--

**COMPLETION**

Depth of completed well: _____ ft.
Depth(s) groundwater encountered: (1) _____ ft.; (2) _____ ft.; (3) _____ ft.; (4) dry well
Static water level in well: _____ ft. measured below land surface on (mm/dd/yy): _____ measured above land surface on (mm/dd/yy): _____
Estimated yield: _____ gpm
Water level was: _____ ft. after _____ hours pumping _____ gpm
Pump installed?    Yes    No
Water well disinfected?    Yes    No
Date disinfected (mm/dd/yy): _____
Aquifer, if known:

**NEAREST SOURCE OF POTENTIAL CONTAMINATION**

Source: _____
Distance from well: _____      Direction from well: _____
Source description: _____
Source: _____
Distance from well: _____      Direction from well: _____
Source description: _____
No potential source of contamination within 100 feet.

**CONSTRUCTION**

Borehole interval: from _____ to _____ ft.	Borehole diameter: _____ in.
from _____ to _____ ft.	_____ in.
Casing height above land surface: _____ in.	
If casing height is less than 12 in. has a variance been approved?*    Yes    No	
*variance not required for monitoring or environmental remediation wells	
Casing type: _____	
Blank casing interval: _____ ft. to _____ ft.	
Blank casing diameter: _____ in.	
Casing joints: _____	
Weight: _____ lbs/ft.	
Wall thickness or gauge no.: _____	
Blank casing interval: _____ ft. to _____ ft.	
Blank casing diameter: _____ in.	
Casing joints: _____	
Weight: _____ lbs/ft.	
Wall thickness or gauge no.: _____	
Grout interval: _____ ft. to _____ ft.	
Grout material: _____	
Grout interval: _____ ft. to _____ ft.	
Grout material: _____	
Screen / perforation material: _____	
Screen / perforation openings: _____	
Screen / perforation intervals: From _____ ft. to _____ ft.	
Slot size _____ unit _____	
From _____ ft. to _____ ft.	
Slot size _____ unit _____	
Gravel pack intervals: Gravel pack not used:    Gravel size _____ in	
From _____ ft. to _____ ft.	
Gravel pack not used:    Gravel size _____ in	
From _____ ft. to _____ ft.	

**PERMIT & ID NUMBERS (AS REQUIRED)**

DWR Application No.: _____
KDHE / EPA Project Code: _____
Site Name: _____
KDHE UIC Class V Form Completed:    Yes    No
County Permit:    Yes    No    Permit ID: _____
Lease Name & Well #: _____
# of boreholes: _____    # of dewatering wells: _____

**LITHOLOGIC LOG**

FROM	TO	LITHOLOGY INTERVALS

**COMMENTS**

--

**CONTRACTOR'S OR LANDOWNERS CERTIFICATION**

This water well was    constructed    reconstructed    pursuant to the stated water well contractor's license and was completed on _____. I certify that this record is true to the best of my knowledge and belief. This water well record was completed on _____ under the business name of _____, Kansas Water Well Contractor's License No. _____ under the authority of the designated person as defined in K.A.R. 28-30-2(j) and signed and certified by the electronic signature of the designated person at its submittal: _____.
---

Send one copy to WATER WELL OWNER and retain one for your records. Fee of \$5.00 for each constructed well.

Division of Environment  
Curtis State Office Building  
1000 SW Jackson St., Suite 400  
Topeka, KS 66612-1367



Phone: 785-296-1535  
Fax: 785-559-4264  
[www.kdheks.gov](http://www.kdheks.gov)

Janet Stanek, Secretary

Laura Kelly, Governor

November 29, 2022

VIA ELECTRONIC COMMUNICATIONS

Logan McNett (Lic. #897)  
Peterson McNett Drilling, Inc.  
P.O. Box 207  
Lindsborg, KS 67456  
[mcnettdrilling@yahoo.com](mailto:mcnettdrilling@yahoo.com)

SUBJECT: Approval of Variance Request for L&G Well Less Than 50 feet from Non-Watertight Sewer Line  
Craig Blomberg, 422 S. Chestnut St., Lindsborg, McPherson County, KS.  
NE, SW, SW, Section 17, Township 17 South, Range 3 West.

Dear Mr. McNett,

Today, the Kansas Department of Health & Environment (KDHE) received electronically your request for variance to install a domestic lawn and garden well at the above referenced property. Variance request materials were attached. KDHE also spoke with the Director of Public Works for the City of Lindsborg about the proposed well location.

The request is to construct the well south of the garage and approximately 25 feet east of the N-S municipal sewer line that is clay tile and not watertight. The request included a proposal to place bentonite grout in the annular seal of the well to a depth of 40 feet below ground surface. It is noted that several nearby water well records show at least 42 feet of clay overlying the sand and gravel aquifer that would supply water to the well.

This letter provides notice of approval to construct the proposed L&G well at least 25 feet east of the clay tile sewer line inside the City of Lindsborg at 422 S. Chestnut St., contingent upon grouting at least the top 40 feet of the well's annular space. Please indicate KDHE approval on the water well record submitted within 30 days of well completion.

Please contact me at 785-296-3565 (o), 785-224-5259 (c), or [Pam.Chaffee@ks.gov](mailto:Pam.Chaffee@ks.gov) if you have questions.

Sincerely,

A handwritten signature in cursive script that reads "Pamela Chaffee".

Pamela Chaffee, P.G., Manager  
Water Well Program  
Geology & Well Technology Unit/Bureau of Water

Copy via email: KDHE/BOW/GWTU – McPherson County file  
Chris Lindholm, Director, Lindsborg Public Works [chrisl@lindsborgcity.org](mailto:chrisl@lindsborgcity.org)

It has been asked of me by Craig Blomberg, owner of residence at 422 S Chestnut, Lindsborg Ks, McPherson County, to apply for a variance for these reasons. To facilitate our equipment and minimize damage to lawn for proposed lawn and garden well to be 25' east of city sewer line (clay tile). The sewer line is in the middle of the alley and the location is in city limits. I have also put a detailed drawing of how I would construct well to further minimize cross contamination by putting an additional grout seal to a depth of 40', if that were ever to be an issue. The proposed well location is up hill of the alley and has good run off.

Owner  
Craig Blomberg,

*Craig Blomberg*

Director of Public works Lindsborg Ks  
Chris Lindholm

*Chris Lindholm*

Thank you for taking the time to look over this  
sincerely, Logan McNett license number 897

*Logan McNett*

Water tight  
sandstone seal

12"

Ground level

40'  
Densitone

15'  
Chlorinated  
gravel

55' 5"  
PVC CASING

10' 5" PVC  
screen .020

65'

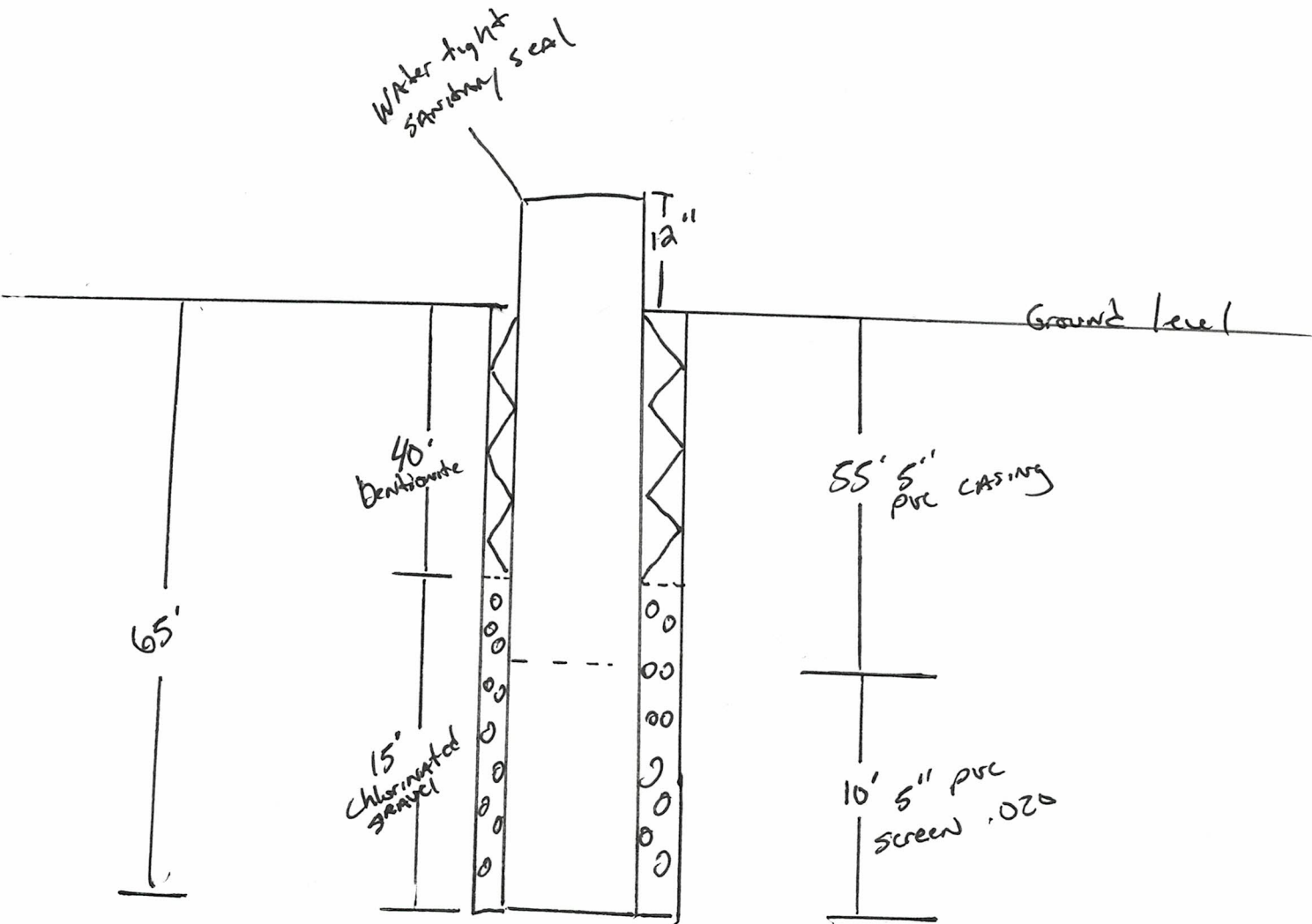

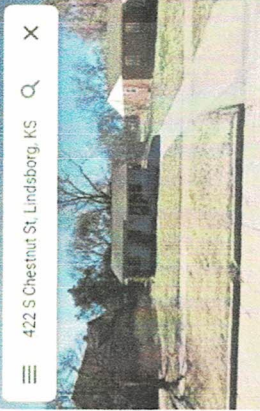
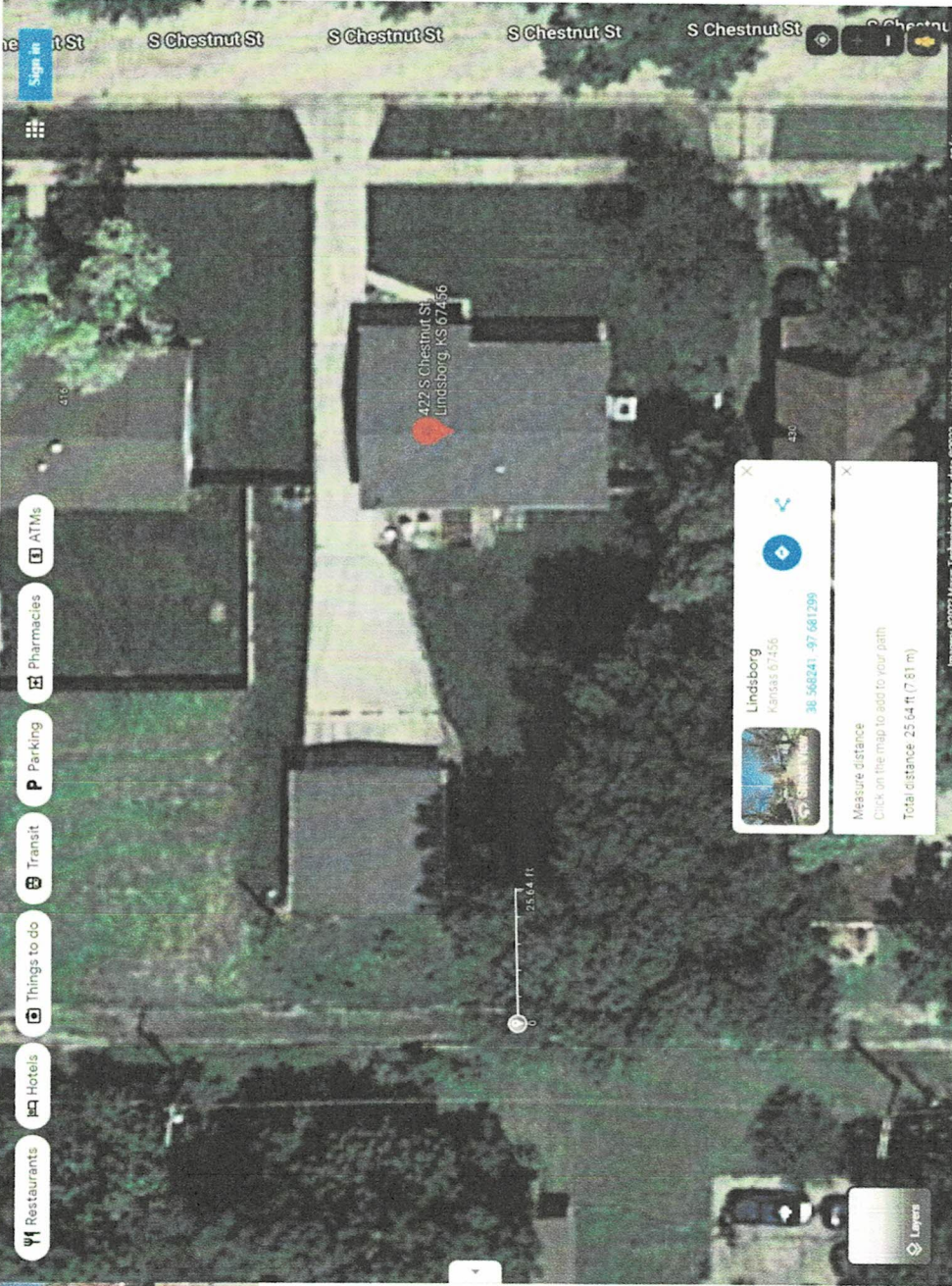

### 422 S Chestnut St

Building

- Directions
- Save
- Nearby
- Send to phone
- 422 S Chestnut St, Lindsborg, KS 67456
- Suggest an edit on 422 S Chestnut St
- Add a missing place
- Add your business

### Photos



**Lindsborg**  
Kansas 67456  
38 468241 - 97 681299

Measure distance  
Click on the map to add to your path  
Total distance: 25.64 ft (7.81 m)