

**WATER WELL RECORD (WWC-5)**

KOLAR DOC ID \_\_\_\_\_ WELL ID \_\_\_\_\_

**LOCATION OF WATER WELL**

Latitude		Longitude		Section		Township		Range		E W	Fraction	¼	¼	¼
Datum		Elevation		County										

**WATER WELL OWNER**

Name	
Business	
Address	
Well location at owner's address	

**WELL WATER USE**

--

**WELL INFORMATION**

Depth of well: _____ ft.
Dry well
Static water level in well: _____ ft. measured below land surface on (mm/dd/yy): _____
measured above land surface on (mm/dd/yy): _____

**PERMIT & ID NUMBERS (AS REQUIRED)**

DWR Application No.: _____
KDHE / EPA Project Code: _____
Site Name: _____
KDHE UIC Class V Form Completed: Yes No
County Permit: Yes No Permit ID: _____
Lease Name & Well #: _____
# of boreholes: _____ # of dewatering wells: _____

**CASING**

Type of blank casing used: _____
Casing type details: _____
Blank casing diameter: _____ inches
Was casing removed? Yes No
Top of casing is currently _____ feet _____ ground
Reason required if top of casing is now less than 5 feet below ground surface for a hand dug well or less than 3 feet below ground surface for all other types of wells.

**GROUT & PLUGGING MATERIALS**

Grout or Plugging interval (ft.)		Material	Description
From	To		

**COMMENTS**

--

**CONTRACTOR'S OR LANDOWNERS CERTIFICATION**

<p>This water well was plugged pursuant to the stated water well contractor's license and was completed on _____. I certify that this record is true to the best of my knowledge and belief. This water well record was completed on _____ under the business name of _____, Kansas Water Well Contractor's License No. _____ under the authority of the designated person as defined in K.A.R. 28-30-2(j) and signed and certified by the electronic signature of the designated person at its submittal _____.</p>
--

Send one copy to WATER WELL OWNER and retain one for your records.

July 21, 2021 4:44:58 pm (Pop)  
 C:\Users\popad\AECOM\Directory\GDS\GIS Services - GIS CAD PROJECTS\DCS-AMERICAS\SHELL\Kansas\Waverly Release, 600 ft N of 2652 Yearling Rd., Williamsburg, KS\Workspace\07212021\Seminar\Annual\_2021.dwg

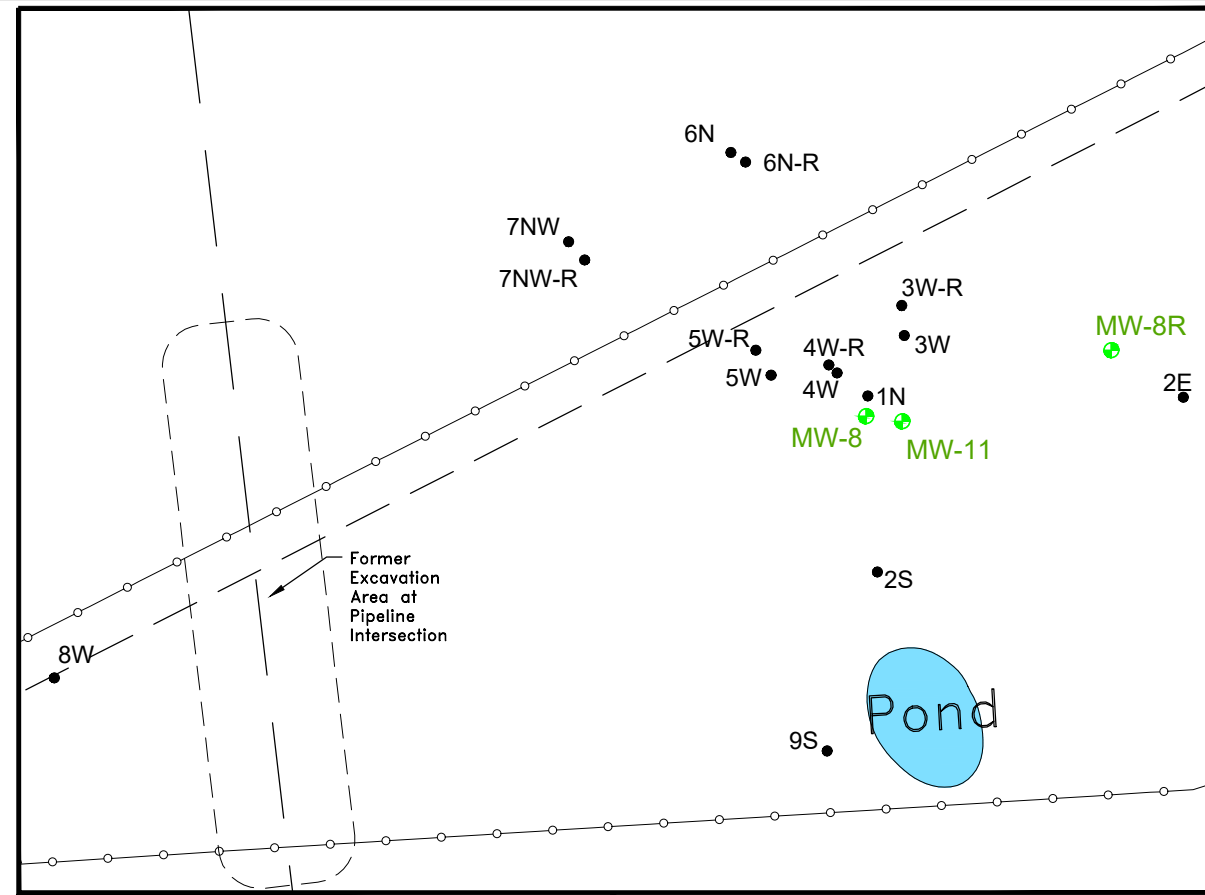

INSET  
SCALE: 1"=50'

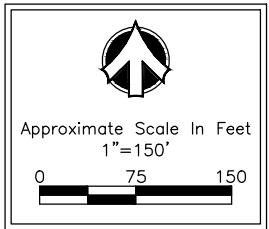
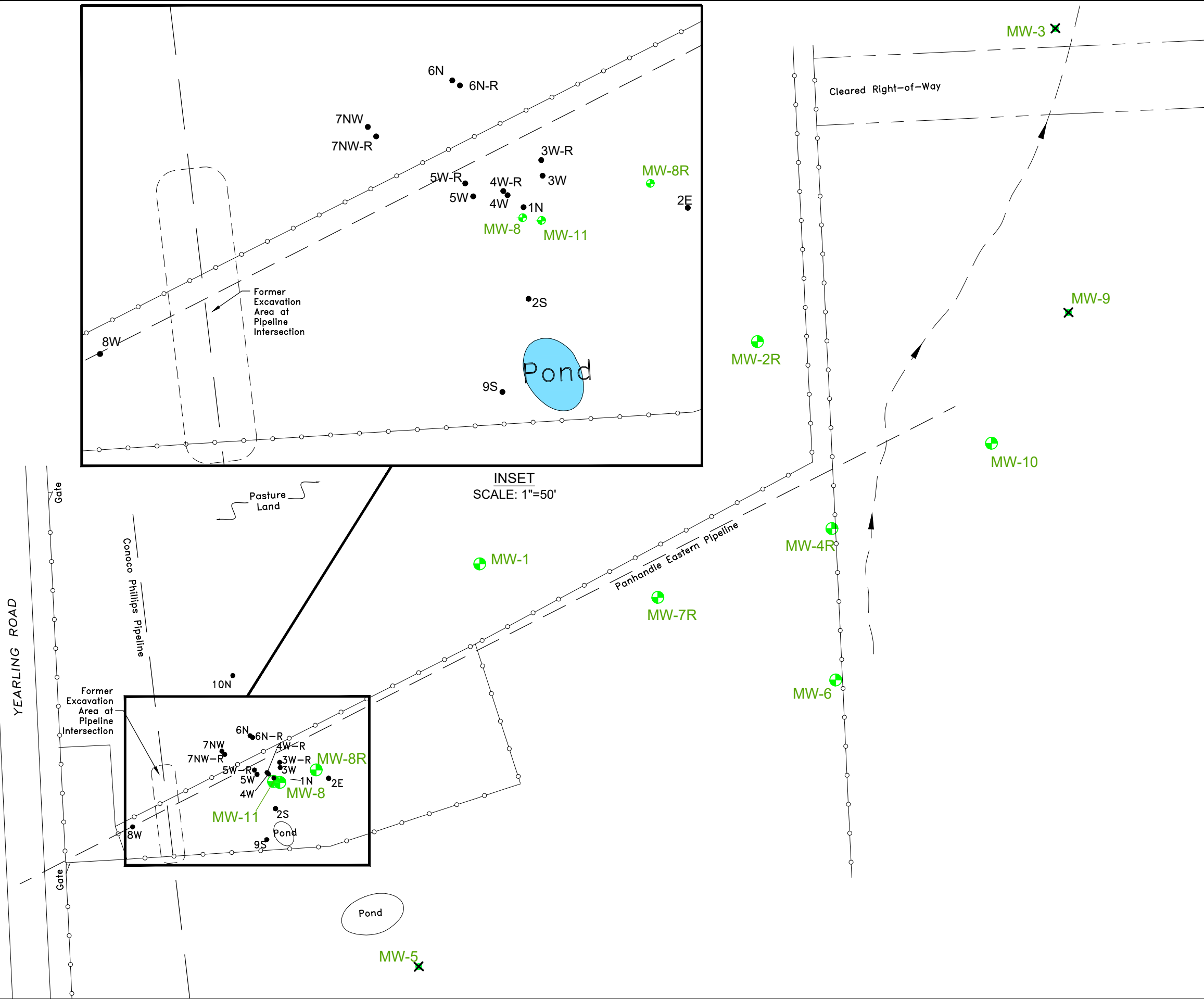

LEGEND	
	Groundwater Monitoring Well Location
	Soil Boring Location
	Former Groundwater Monitoring Well Location
	Limits of Former Excavation
	Fence Line
	Pipeline
	Intermittent Creek

<b>AECOM</b> 2380 McGee Street, Suite 200 Kansas City, Missouri 64108		
CLIENT: SHELL OIL PRODUCTS US		
LOCATION: NEAR WAVERLY, KANSAS		
TITLE: MONITORING WELL LOCATION MAP SHELL PIPELINE COMPANY LP EQUILON KC PIPELINE SITE		
DRAWN BY TMS	CHECKED BY KGS	APPROVED BY SAL
PROJECT NO. 60643615	DATE JULY 2021	FIGURE NO. 3