

WATER WELL RECORD (WWC-5)

KOLAR DOC ID _____ WELL ID _____
 Original Record Correction Change in Well Use

LOCATION OF WATER WELL

Latitude		Longitude		Section		Township		Range		E W	Fraction	¼	¼	¼
Datum		Elevation		County										

WATER WELL OWNER

Name	
Business	
Address	
Well location at owner's address	

WELL WATER USE

--

COMPLETION

Depth of completed well: _____ ft.
Depth(s) groundwater encountered: (1) _____ ft.; (2) _____ ft.; (3) _____ ft.; (4) dry well
Static water level in well: _____ ft. measured below land surface on (mm/dd/yy): _____ measured above land surface on (mm/dd/yy): _____
Estimated yield: _____ gpm
Water level was: _____ ft. after _____ hours pumping _____ gpm
Pump installed? Yes No
Water well disinfected? Yes No
Date disinfected (mm/dd/yy): _____
Aquifer, if known:

NEAREST SOURCE OF POTENTIAL CONTAMINATION

Source: _____
Distance from well: _____ Direction from well: _____
Source description: _____
Source: _____
Distance from well: _____ Direction from well: _____
Source description: _____
No potential source of contamination within 100 feet.

CONSTRUCTION

Borehole interval: from _____ to _____ ft.	Borehole diameter: _____ in.
from _____ to _____ ft.	_____ in.
Casing height above land surface: _____ in.	
If casing height is less than 12 in. has a variance been approved?* Yes No	
*variance not required for monitoring or environmental remediation wells	
Casing type: _____	
Blank casing interval: _____ ft. to _____ ft.	
Blank casing diameter: _____ in.	
Casing joints: _____	
Weight: _____ lbs/ft.	
Wall thickness or gauge no.: _____	
Blank casing interval: _____ ft. to _____ ft.	
Blank casing diameter: _____ in.	
Casing joints: _____	
Weight: _____ lbs/ft.	
Wall thickness or gauge no.: _____	
Grout interval: _____ ft. to _____ ft.	
Grout material: _____	
Grout interval: _____ ft. to _____ ft.	
Grout material: _____	
Screen / perforation material: _____	
Screen / perforation openings: _____	
Screen / perforation intervals: From _____ ft. to _____ ft.	
Slot size _____ unit _____	
From _____ ft. to _____ ft.	
Slot size _____ unit _____	
Gravel pack intervals: Gravel pack not used: Gravel size _____ in	
From _____ ft. to _____ ft.	
Gravel pack not used: Gravel size _____ in	
From _____ ft. to _____ ft.	

PERMIT & ID NUMBERS (AS REQUIRED)

DWR Application No.: _____
KDHE / EPA Project Code: _____
Site Name: _____
KDHE UIC Class V Form Completed: Yes No
County Permit: Yes No Permit ID: _____
Lease Name & Well #: _____
of boreholes: _____ # of dewatering wells: _____

LITHOLOGIC LOG

FROM	TO	LITHOLOGY INTERVALS

COMMENTS

--

CONTRACTOR'S OR LANDOWNERS CERTIFICATION

This water well was constructed reconstructed pursuant to the stated water well contractor's license and was completed on _____. I certify that this record is true to the best of my knowledge and belief. This water well record was completed on _____ under the business name of _____, Kansas Water Well Contractor's License No. _____ under the authority of the designated person as defined in K.A.R. 28-30-2(j) and signed and certified by the electronic signature of the designated person at its submittal: _____.

Send one copy to WATER WELL OWNER and retain one for your records. Fee of \$5.00 for each constructed well.

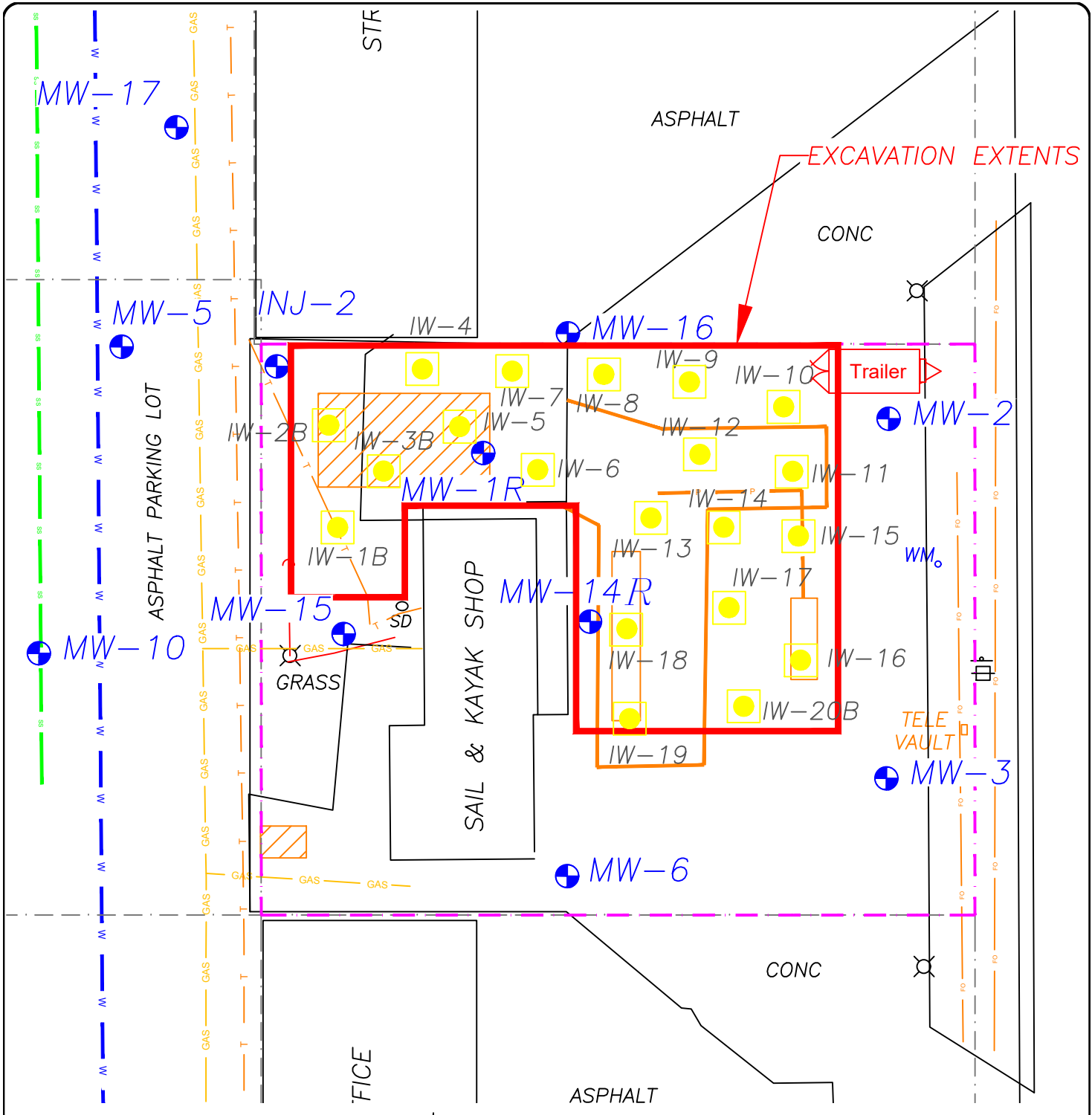

- LEGEND:**
- ⊕ MW-4 MONITORING WELL
 - ⊙ IW-7 OXYGEN INJECTION WELL
 - PROPERTY LINES
 - APPROXIMATE SITE BOUNDARY
 - ▨ FORMER UST BASIN/PUMP ISLANDS/PRODUCT LINES
 - OVERHEAD ELECTRIC/TELEPHONE LINE
 - SANITARY SEWER LINE (APPROX. DEPTH 2-6')
 - GAS LINE (APPROX. 2 TO 6')
 - PHONE/FIBER OPTIC LINE (APPROX. 1.5 TO 3')
 - WATER LINE (APPROX. 2-6')

NOTES:

1. LOCATION OF UTILITIES ARE APPROXIMATE, BASED ON PRIOR SITE MAPS PROVIDED BY KDHE.
2. AERIAL SOURCE: GOOGLE EARTH (2021).



SCS ENGINEERS
ENVIRONMENTAL CONSULTANTS AND CONTRACTORS

8575 West 110th Street
 Overland Park, Kansas 66210

FIGURE 1.3
 SITE BASE MAP
 Former Coastal Mart #1161
 425 South Parker, Olathe, Kansas

Project Mgr.	SLM	Date	2/7/2023	KDHE Code:	U4-046-01525	Proj No.	27218273.01
Scale:				File Name	Coastal Mart #1161 SRP.dwg		