

**WATER WELL RECORD (WWC-5)**

KOLAR DOC ID \_\_\_\_\_ WELL ID \_\_\_\_\_  
 Original Record      Correction      Change in Well Use

**LOCATION OF WATER WELL**

Latitude		Longitude		Section		Township		Range		E W	Fraction		¼		¼		¼
Datum		Elevation		County													

**WATER WELL OWNER**

Name	
Business	
Address	
Well location  at owner's address	

**WELL WATER USE**

--

**COMPLETION**

Depth of completed well: _____ ft.
Depth(s) groundwater encountered: (1) _____ ft.; (2) _____ ft.; (3) _____ ft.; (4) dry well
Static water level in well: _____ ft. measured below land surface on (mm/dd/yy): _____ measured above land surface on (mm/dd/yy): _____
Estimated yield: _____ gpm
Water level was: _____ ft. after _____ hours pumping _____ gpm
Pump installed?    Yes    No
Water well disinfected?    Yes    No
Date disinfected (mm/dd/yy): _____
Aquifer, if known:

**NEAREST SOURCE OF POTENTIAL CONTAMINATION**

Source: _____
Distance from well: _____      Direction from well: _____
Source description: _____
Source: _____
Distance from well: _____      Direction from well: _____
Source description: _____
No potential source of contamination within 100 feet.

**CONSTRUCTION**

Borehole interval: from _____ to _____ ft.	Borehole diameter: _____ in.
from _____ to _____ ft.	_____ in.
Casing height above land surface: _____ in.	
If casing height is less than 12 in. has a variance been approved?*    Yes    No	
*variance not required for monitoring or environmental remediation wells	
Casing type: _____	
Blank casing interval: _____ ft. to _____ ft.	
Blank casing diameter: _____ in.	
Casing joints: _____	
Weight: _____ lbs/ft.	
Wall thickness or gauge no.: _____	
Blank casing interval: _____ ft. to _____ ft.	
Blank casing diameter: _____ in.	
Casing joints: _____	
Weight: _____ lbs/ft.	
Wall thickness or gauge no.: _____	
Grout interval: _____ ft. to _____ ft.	
Grout material: _____	
Grout interval: _____ ft. to _____ ft.	
Grout material: _____	
Screen / perforation material: _____	
Screen / perforation openings: _____	
Screen / perforation intervals: From _____ ft. to _____ ft.	
Slot size _____ unit _____	
From _____ ft. to _____ ft.	
Slot size _____ unit _____	
Gravel pack intervals: Gravel pack not used:    Gravel size _____ in	
From _____ ft. to _____ ft.	
Gravel pack not used:    Gravel size _____ in	
From _____ ft. to _____ ft.	

**PERMIT & ID NUMBERS (AS REQUIRED)**

DWR Application No.: _____
KDHE / EPA Project Code: _____
Site Name: _____
KDHE UIC Class V Form Completed:    Yes    No
County Permit:    Yes    No    Permit ID: _____
Lease Name & Well #: _____
# of boreholes: _____    # of dewatering wells: _____

**LITHOLOGIC LOG**

FROM	TO	LITHOLOGY INTERVALS

**COMMENTS**

--

**CONTRACTOR'S OR LANDOWNERS CERTIFICATION**



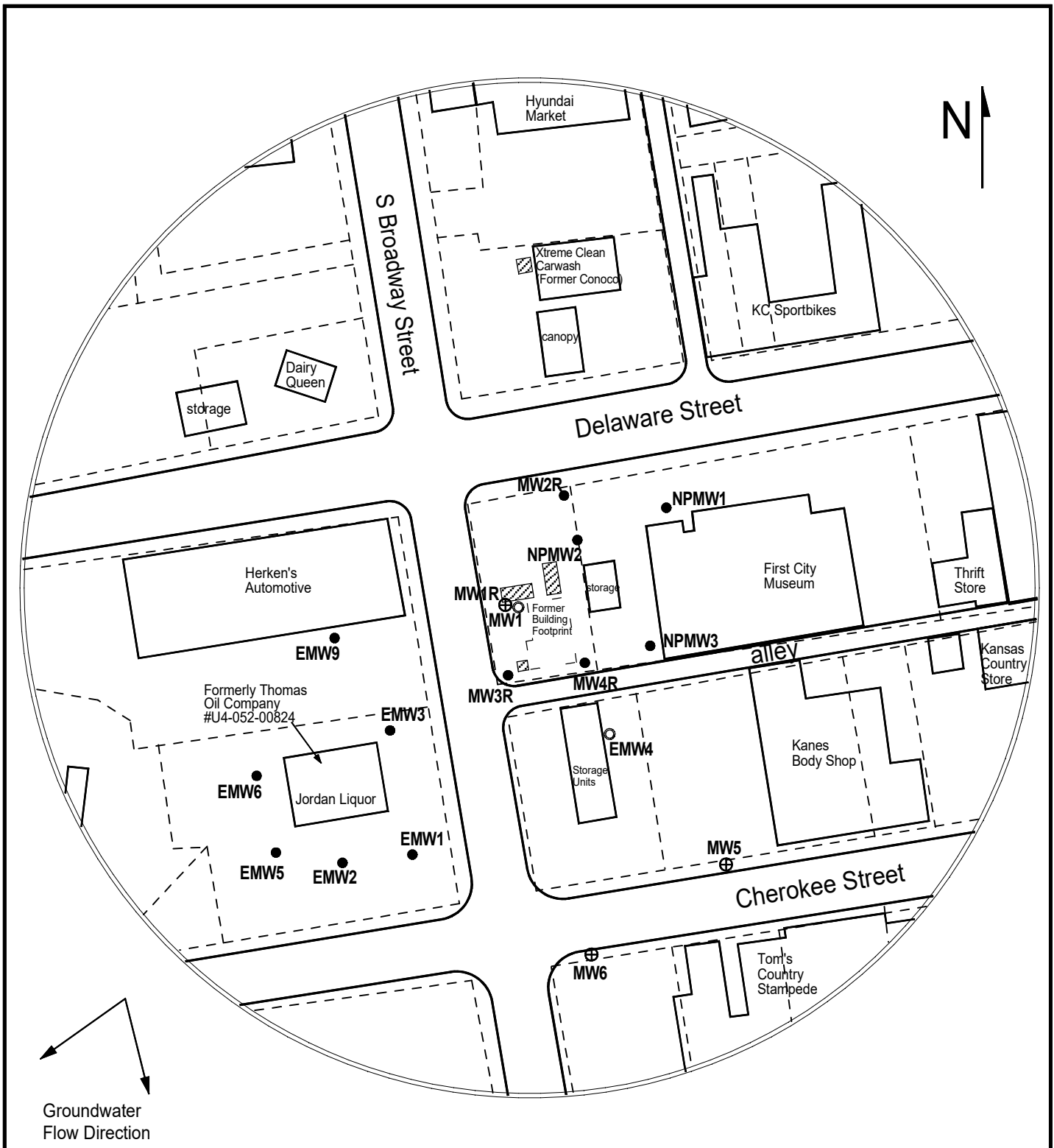

This water well was    constructed    reconstructed    pursuant to the stated water well contractor's license and was completed on _____. I certify that this record is true to the best of my knowledge and belief. This water well record was completed on _____ under the business name of _____, Kansas Water Well Contractor's License No. _____ under the authority of the designated person as defined in K.A.R. 28-30-2(j) and signed and certified by the electronic signature of the designated person at its submittal: _____.
---

Send one copy to WATER WELL OWNER and retain one for your records. Fee of \$5.00 for each constructed well.



**FIGURE 1 - SITE BASE MAP**

**LEGEND:**

-  Approximate Location of Former UST Basins
-  Approximate Location of Property Line
-  Monitoring Well
-  Plugged Monitoring Well
-  Newly Installed Monitoring Well



**PROJECT:**

Pellman Oil Co. (Former)  
201 S. Broadway  
Leavenworth, KS  
KDHE ID: U4-052-11765  
Date: 2/23/23 & 3/9/23



1311 E 25th St., Suite B (785) 841-8707 office  
Lawrence, KS 66046 (785) 865-4282 fax

# DENNIS L HANDKE

1820 NW 59th Terrace  
TOPEKA, KANSAS 66618  
785-286-4047 Home

Jess Chapman  
Larsen & Assoc.  
1311 E. 25<sup>th</sup> St., Suite B  
Topeka, Kansas 66046

March 27, 2023

RE: Monitor Well Elevation Survey  
201 S. Broadway, Leavenworth Kansas

Proj. 23-00J  
Pellman Oil Co. (Former)  
KDHE ID U4-052-11765

Bench Mark: Chisled Sq. on SE corner of concrete sign base at Northeast corner of property.  
Elev.: 783.80      North 5097      West 785      (from SE Cor. Sec. 35-8-22E)

MW-1R	rim	781.57	North 5024	NE1/4,NW1/4,NE1/4,NE1/4
	top pipe	781.02	West 811	Lat = 39.31697    Long = 94.92096
MW-2R	rim	783.01	North 5091	NE1/4,NW1/4,NE1/4,NE1/4
	top pipe	782.69	West 788	Lat = 39.31715    Long = 94.92088
MW-3R	rim	781.61	North 4982	NE1/4,NW1/4,NE1/4,NE1/4
	top pipe	781.29	West 814	Lat = 39.31685    Long = 94.92097
MW-4R	rim	780.62	North 4978	NE1/4,NW1/4,NE1/4,NE1/4
	top pipe	780.34	West 765	Lat = 39.31684    Long = 94.92080
MW-5	rim	779.51	North 4842	SE1/4,NW1/4,NE1/4,NE1/4
	top pipe	779.26	West 693	Lat = 39.31646    Long = 94.92054
MW-6	rim	780.04	North 4780	SE1/4,NW1/4,NE1/4,NE1/4
	top pipe	779.80	West 758	Lat = 39.31630    Long = 94.92078
NPMW-1	rim	784.44	North 5105	NE1/4,NW1/4,NE1/4,NE1/4
	top pipe	784.04	West 784	Lat = 39.31719    Long = 94.92058
NPMW-2	rim	782.92	North 5061	NE1/4,NW1/4,NE1/4,NE1/4
	top pipe	782.54	West 769	Lat = 39.31707    Long = 94.92081
NPMW-3	rim	780.50	North 5003	NE1/4,NW1/4,NE1/4,NE1/4
	top pipe	780.21	West 729	Lat = 39.31691    Long = 94.92067

Lat & Long derived from Leavenworth 7.5' quad map. WGS84.

Elevation derived from existing project. NAVD 88.

If you have any questions, please feel free to call me. Thank you for the opportunity to be of service to you.

