

WATER WELL RECORD (WWC-5)

KOLAR DOC ID _____ WELL ID _____

Original Record Correction Change in Well Use

LOCATION OF WATER WELL

Latitude		Longitude		Section		Township		Range		E W	Fraction	¼	¼	¼
Datum		Elevation		County										

WATER WELL OWNER

Name	
Business	
Address	
Well location at owner's address	

WELL WATER USE

--

COMPLETION

Depth of completed well: _____ ft.
Depth(s) groundwater encountered:
(1) _____ ft.; (2) _____ ft.;
(3) _____ ft.; (4) dry well
Static water level in well: _____ ft.
measured below land surface
on (mm/dd/yy): _____
measured above land surface
on (mm/dd/yy): _____
Estimated yield: _____ gpm
Water level was: _____ ft. after _____ hours
pumping _____ gpm
Pump installed? Yes No
Water well disinfected? Yes No
Date disinfected (mm/dd/yy): _____
Aquifer, if known:

NEAREST SOURCE OF POTENTIAL CONTAMINATION

Source: _____
Distance from well: _____ Direction from well: _____
Source description: _____
Source: _____
Distance from well: _____ Direction from well: _____
Source description: _____
No potential source of contamination within 100 feet.

CONSTRUCTION

Borehole interval:	Borehole diameter:
from _____ to _____ ft.	_____ in.
from _____ to _____ ft.	_____ in.
Casing height above land surface: _____ in.	
If casing height is less than 12 in. has a variance been approved?*	Yes No
*variance not required for monitoring or environmental remediation wells	
Casing type: _____	
Blank casing interval: _____ ft. to _____ ft.	
Blank casing diameter: _____ in.	
Casing joints: _____	
Weight: _____ lbs/ft.	
Wall thickness or gauge no.: _____	
Blank casing interval: _____ ft. to _____ ft.	
Blank casing diameter: _____ in.	
Casing joints: _____	
Weight: _____ lbs/ft.	
Wall thickness or gauge no.: _____	
Grout interval: _____ ft. to _____ ft.	
Grout material: _____	
Grout interval: _____ ft. to _____ ft.	
Grout material: _____	
Screen / perforation material: _____	
Screen / perforation openings: _____	
Screen / perforation intervals:	
From _____ ft. to _____ ft.	
Slot size _____ unit _____	
From _____ ft. to _____ ft.	
Slot size _____ unit _____	
Gravel pack intervals:	
Gravel pack not used: Gravel size _____ in	
From _____ ft. to _____ ft.	
Gravel pack not used: Gravel size _____ in	
From _____ ft. to _____ ft.	

PERMIT & ID NUMBERS (AS REQUIRED)

DWR Application No.: _____
KDHE / EPA Project Code: _____
Site Name: _____
KDHE UIC Class V Form Completed: Yes No
County Permit: Yes No Permit ID: _____
Lease Name & Well #: _____
of boreholes: _____ # of dewatering wells: _____

LITHOLOGIC LOG

FROM	TO	LITHOLOGY INTERVALS

COMMENTS

--

CONTRACTOR'S OR LANDOWNERS CERTIFICATION

This water well was constructed reconstructed pursuant to the stated water well contractor's license and was completed on _____. I certify that this record is true to the best of my knowledge and belief. This water well record was completed on _____ under the business name of _____, Kansas Water Well Contractor's License No. _____ under the authority of the designated person as defined in K.A.R. 28-30-2(j) and signed and certified by the electronic signature of the designated person at its submittal: _____.

Send one copy to WATER WELL OWNER and retain one for your records. Fee of \$5.00 for each constructed well.

DENNIS L HANDKE

1820 NW 59th Terrace
TOPEKA, KANSAS 66618
785-286-4047 Home

Jessica Chapman
Larsen & Associates
1311 E. 25th Street, Suite B
Lawrence, Kansas, 66046

August 9, 2023

RE: Monitor Well Elevation Survey
1121 Main St., Winfield, Kansas

Proj. 23-00A
Wiebe Tire
U2-018-01326

Bench Mark: Chisled X on top SE bolt of East leg on concrete sign base at Southeast corner of property.
Elev: 1127.58 North 2677.70 West 2973.90 (from SE Cor. Sec. 28-32-4E)

MW-1R	rim	1127.73	North	2728.16	SE1/4,SE1/4,SE1/4,NW1/4
	top pipe	1127.33	West	2983.11	Lat= 37.23745 Long = 96.99741
MW-2R	rim	1127.83	North	2694.11	SW1/4,SE1/4,SE1/4,NW1/4
	top pipe	1127.61	West	3041.66	Lat= 37.23735 Long = 96.99761
MW-11	rim	1127.97	North	2680.61	SW1/4,SE1/4,SE1/4,NW1/4
	top pipe	1127.55	West	3193.43	Lat= 37.23731 Long = 96.99813
MW-12	rim	1127.98	North	2244.10	SE1/4,NW1/4,NE1/4,SW1/4
	top pipe	1127.48	West	3513.78	Lat= 37.23601 Long = 96.99921
MW-13	rim	1126.73	North	2139.10	SE1/4,NW1/4,NE1/4,SW1/4
	top pipe	1126.36	West	3330.01	Lat= 37.23582 Long = 96.99857
MW-14	rim	1127.37	North	2310.62	SW1/4,NE1/4,NE1/4,SW1/4
	top pipe	1126.79	West	3221.81	Lat= 37.23629 Long = 96.99821
MW-16R	rim	1127.33	North	2673.58	SW1/4,SE1/4,SE1/4,NW1/4
	top pipe	1126.96	West	3087.49	Lat= 37.23730 Long = 96.99776
MW-17R	rim	1127.93	North	2686.87	SW1/4,SE1/4,SE1/4,NW1/4
	top pipe	1126.97	West	2982.01	Lat= 37.23734 Long = 96.99740

Lat & Long derived from Winfield 7.5' quad map. WGS 84.

Elevation established from existing project.

If you have any questions, please feel free to call me. Thank you for the opportunity to be of service to you.



NOTE: Figures exhibited within this report are only to be used within the context of this report. Placement of property lines, wells, structures, and roads is based on the available information from county appraiser maps, surveys, site visits, and/or previous vendor reports and should be considered approximate. Estimated concentration lines represent estimated contaminant concentrations based on data collected during the sampling event. Actual extent or concentration of contamination beyond the sample point is unknown.

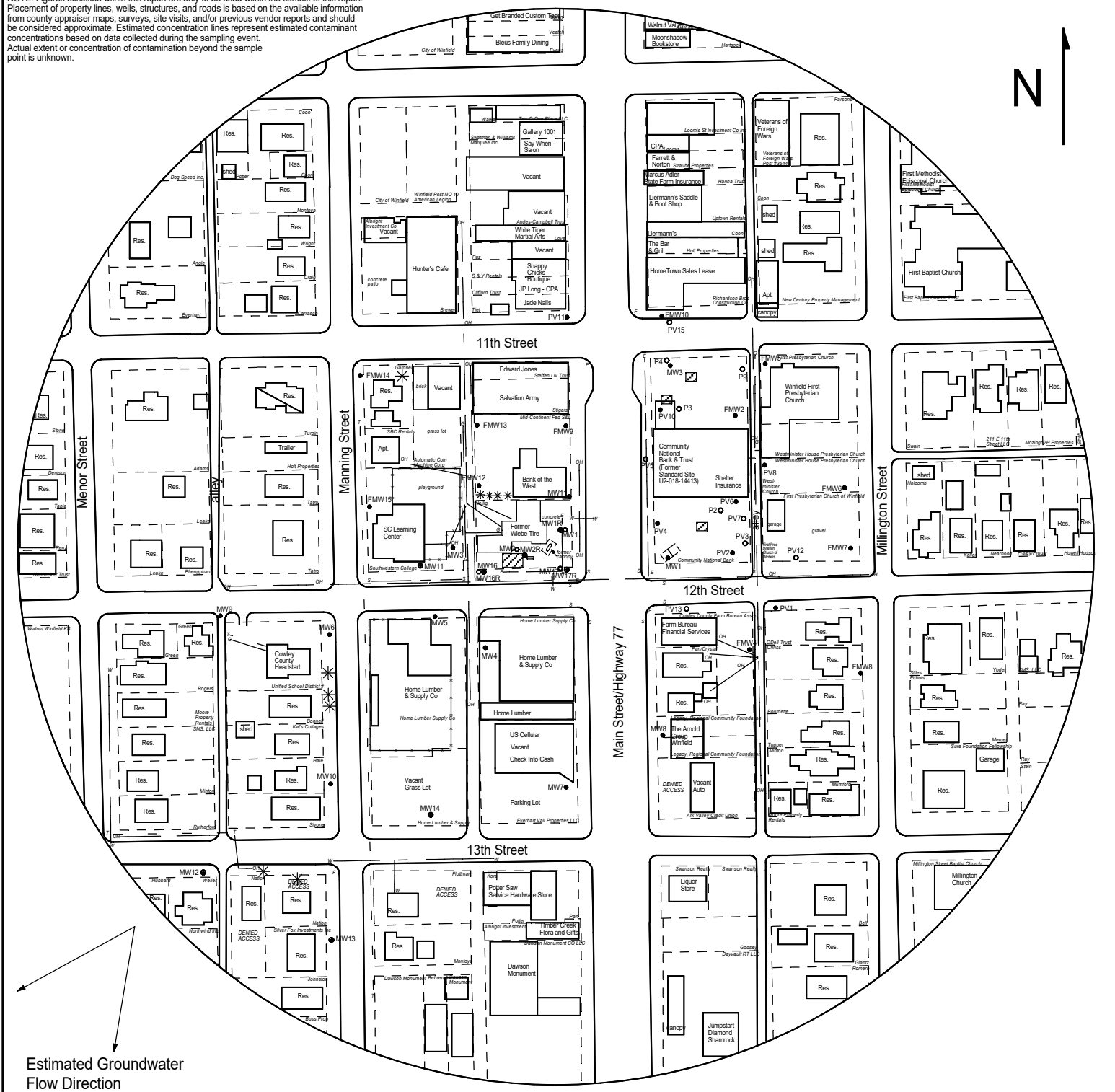

FIGURE 2.2 - 800 FT RADIUS AREA BASE MAP



1311 E 25th St., Suite B 785-841-8707 office
Lawrence, KS 66046 785-865-4282 fax

PROJECT:

Wiebe Tire
1121 Main
Winfield, KS
KDHE ID: U2-018-01326
Date: 7/27-28/23

0 120 ft

LEGEND

- Approximate Location of Former UST Basins & Pump Islands
- Building with Basement
- Approximate Location of Property Line
- Monitoring Well
- Plugged Well
- New Monitoring Well (Installed 7/25-27/23)
- Soil Boring (Drilled 2/5-6/20; 2/10/20; 2/28/20)
- Fire Hydrant
- Sewer Inlet
- Electric Lines (2 - 6 ft bgs)
- Gas Lines (1.5 - 3 ft bgs)
- Overhead Lines (25'-40' high)
- Telephone Lines (2 - 6 ft bgs)
- Water Lines (2 - 6 ft bgs)

NOTE: Utility depths, heights and locations are approximate.