

WATER WELL RECORD (WWC-5)

KOLAR DOC ID _____ WELL ID _____
 Original Record Correction Change in Well Use

LOCATION OF WATER WELL

Latitude		Longitude		Section		Township		Range		E W	Fraction	¼	¼	¼
Datum		Elevation		County										

WATER WELL OWNER

Name	
Business	
Address	
Well location	
at owner's address	

WELL WATER USE

--

COMPLETION

Depth of completed well: _____ ft.
Depth(s) groundwater encountered:
(1) _____ ft.; (2) _____ ft.;
(3) _____ ft.; (4) dry well
Static water level in well: _____ ft.
measured below land surface
on (mm/dd/yy): _____
measured above land surface
on (mm/dd/yy): _____
Estimated yield: _____ gpm
Water level was: _____ ft. after _____ hours
pumping _____ gpm
Pump installed? Yes No
Water well disinfected? Yes No
Date disinfected (mm/dd/yy): _____
Aquifer, if known:

NEAREST SOURCE OF POTENTIAL CONTAMINATION

Source: _____
Distance from well: _____ Direction from well: _____
Source description: _____
Source: _____
Distance from well: _____ Direction from well: _____
Source description: _____
No potential source of contamination within 100 feet.

CONSTRUCTION

Borehole interval:	Borehole diameter:
from _____ to _____ ft.	_____ in.
from _____ to _____ ft.	_____ in.
Casing height above land surface: _____ in.	
If casing height is less than 12 in. has a variance been approved?*	
Yes No	
*variance not required for monitoring or environmental remediation wells	
Casing type: _____	
Blank casing interval: _____ ft. to _____ ft.	
Blank casing diameter: _____ in.	
Casing joints: _____	
Weight: _____ lbs/ft.	
Wall thickness or gauge no.: _____	
Blank casing interval: _____ ft. to _____ ft.	
Blank casing diameter: _____ in.	
Casing joints: _____	
Weight: _____ lbs/ft.	
Wall thickness or gauge no.: _____	
Grout interval: _____ ft. to _____ ft.	
Grout material: _____	
Grout interval: _____ ft. to _____ ft.	
Grout material: _____	
Screen / perforation material: _____	
Screen / perforation openings: _____	
Screen / perforation intervals:	
From _____ ft. to _____ ft.	
Slot size _____ unit _____	
From _____ ft. to _____ ft.	
Slot size _____ unit _____	
Gravel pack intervals:	
Gravel pack not used: Gravel size _____ in	
From _____ ft. to _____ ft.	
Gravel pack not used: Gravel size _____ in	
From _____ ft. to _____ ft.	

PERMIT & ID NUMBERS (AS REQUIRED)

DWR Application No.: _____
KDHE / EPA Project Code: _____
Site Name: _____
KDHE UIC Class V Form Completed: Yes No
County Permit: Yes No Permit ID: _____
Lease Name & Well #: _____
of boreholes: _____ # of dewatering wells: _____

LITHOLOGIC LOG

FROM	TO	LITHOLOGY INTERVALS

COMMENTS

--

CONTRACTOR'S OR LANDOWNERS CERTIFICATION

This water well was constructed reconstructed pursuant to the stated water well contractor's license and was completed on _____. I certify that this record is true to the best of my knowledge and belief. This water well record was completed on _____ under the business name of _____, Kansas Water Well Contractor's License No. _____ under the authority of the designated person as defined in K.A.R. 28-30-2(j) and signed and certified by the electronic signature of the designated person at its submittal: _____.

Send one copy to WATER WELL OWNER and retain one for your records. Fee of \$5.00 for each constructed well.

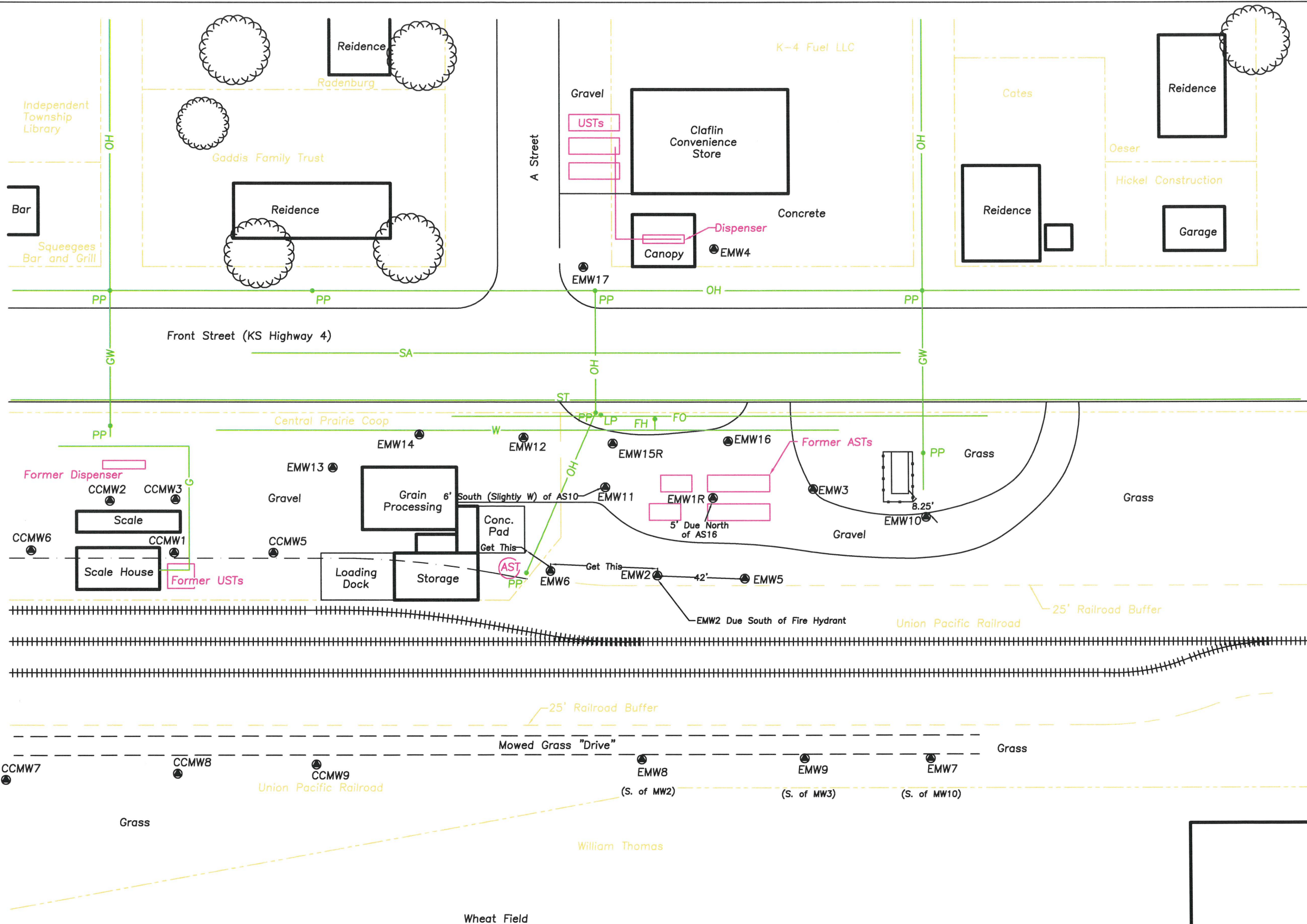

Legend

- EMW1 - Essmiller Monitoring Well
- CCMW1 - Claflin Coop Monitoring Well (Existing)
- - - - - Property Line
- Union Pacific Railroad - Property Owner Name
- OH — Overhead Power Line
- SA — Sanitary Sewer Line (~4' deep)
- FO — Fiber Optic (~3' Deep)
- W — Water Line (~4' deep)
- G — Gas Line (~3' deep)
- BT — Buried Telephone (~3' deep)
- ST — Storm Sewer (~2' deep)
- GW — Guy Wire
- PP • Power Pole
- LP • Light Pole
- MH • Manhole
- Ped • Phone Pedestal
- WM • Water Meter
- FH • Fire Hydrant
- CO • Clean Out
- - Tree

Scale In Feet
0 50 100

Area Base Map	
Essmiller Oil Co. Claflin, Kansas	
KDHE Project Code: A6-005-40491	
Final Remedial Report	
CGP Project #21916K	
Prepared By: TM	Date: 09-13-2023
Reviewed By: MK	Date: 09-14-2023
Figure 3.1.1	
CGP, Inc. PO Box 23, Wahoo, NE 68066	

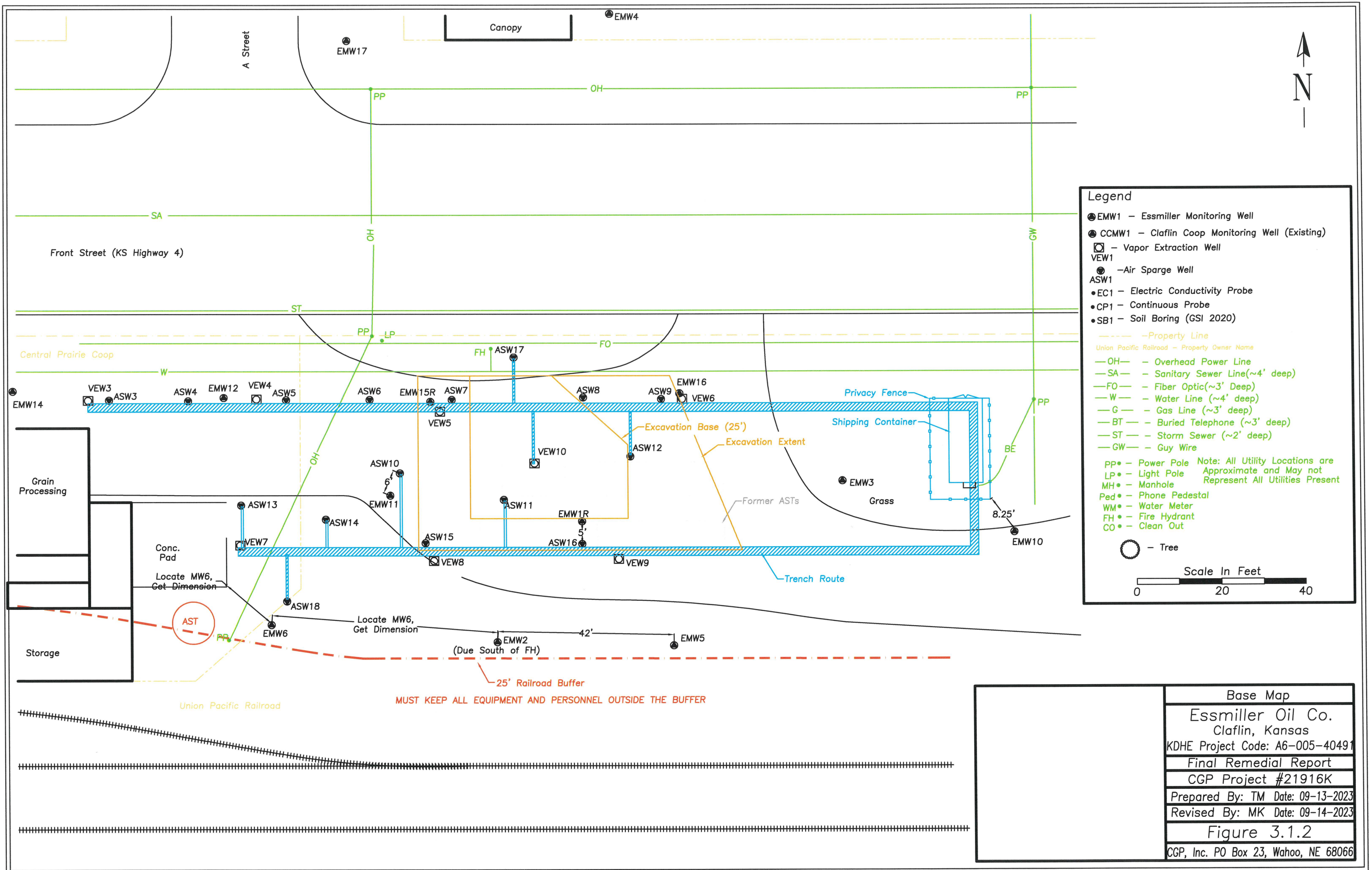

MUST KEEP ALL EQUIPMENT AND PERSONNEL OUTSIDE THE BUFFER

25' Railroad Buffer
(Due South of FH)

Union Pacific Railroad

Conc. Pad
Locate MW6,
Get Dimension



Locate MW6,
Get Dimension

42'

8.25'

Trench Route

Former ASTs

Excavation Base (25')
Excavation Extent

Privacy Fence

Shipping Container

Grass

Canopy

A Street

Front Street (KS Highway 4)

Grain Processing

Storage

EMW14

EMW17

EMW4

VEW3

ASW3

ASW4

EMW12

VEW4

ASW5

ASW6

EMW15R

ASW7

ASW8

ASW9

EMW16

VEW6

ASW12

VEW10

ASW17

ASW11

EMW1R

ASW16

EMW3

EMW10

ASW13

EMW11

ASW14

ASW15

VEW8

ASW18

EMW6

EMW2

EMW5

Locate MW6,
Get Dimension

Locate MW6,
Get Dimension

(Due South of FH)

BE

Locate MW6,
Get Dimension

Locate MW6,
Get Dimension

(Due South of FH)

BE