

WATER WELL RECORD (WWC-5)

KOLAR DOC ID _____ WELL ID _____
 Original Record Correction Change in Well Use

LOCATION OF WATER WELL

Latitude		Longitude		Section		Township		Range		E W	Fraction	¼	¼	¼
Datum		Elevation		County										

WATER WELL OWNER

Name	
Business	
Address	
Well location at owner's address	

WELL WATER USE

--

COMPLETION

Depth of completed well: _____ ft.
Depth(s) groundwater encountered: (1) _____ ft.; (2) _____ ft.; (3) _____ ft.; (4) dry well
Static water level in well: _____ ft. measured below land surface on (mm/dd/yy): _____ measured above land surface on (mm/dd/yy): _____
Estimated yield: _____ gpm
Water level was: _____ ft. after _____ hours pumping _____ gpm
Pump installed? Yes No
Water well disinfected? Yes No
Date disinfected (mm/dd/yy): _____
Aquifer, if known:

NEAREST SOURCE OF POTENTIAL CONTAMINATION

Source: _____
Distance from well: _____ Direction from well: _____
Source description: _____
Source: _____
Distance from well: _____ Direction from well: _____
Source description: _____
No potential source of contamination within 100 feet.

CONSTRUCTION

Borehole interval: from _____ to _____ ft.	Borehole diameter: _____ in.
from _____ to _____ ft.	_____ in.
Casing height above land surface: _____ in.	
If casing height is less than 12 in. has a variance been approved? * Yes No	
*variance not required for monitoring or environmental remediation wells	
Casing type: _____	
Blank casing interval: _____ ft. to _____ ft.	
Blank casing diameter: _____ in.	
Casing joints: _____	
Weight: _____ lbs/ft.	
Wall thickness or gauge no.: _____	
Blank casing interval: _____ ft. to _____ ft.	
Blank casing diameter: _____ in.	
Casing joints: _____	
Weight: _____ lbs/ft.	
Wall thickness or gauge no.: _____	
Grout interval: _____ ft. to _____ ft.	
Grout material: _____	
Grout interval: _____ ft. to _____ ft.	
Grout material: _____	
Screen / perforation material: _____	
Screen / perforation openings: _____	
Screen / perforation intervals: From _____ ft. to _____ ft.	
Slot size _____ unit _____	
From _____ ft. to _____ ft.	
Slot size _____ unit _____	
Gravel pack intervals: Gravel pack not used: Gravel size _____ in	
From _____ ft. to _____ ft.	
Gravel pack not used: Gravel size _____ in	
From _____ ft. to _____ ft.	

PERMIT & ID NUMBERS (AS REQUIRED)

DWR Application No.: _____
KDHE / EPA Project Code: _____
Site Name: _____
KDHE UIC Class V Form Completed: Yes No
County Permit: Yes No Permit ID: _____
Lease Name & Well #: _____
of boreholes: _____ # of dewatering wells: _____

LITHOLOGIC LOG

FROM	TO	LITHOLOGY INTERVALS

COMMENTS

--

CONTRACTOR'S OR LANDOWNERS CERTIFICATION

This water well was constructed reconstructed pursuant to the stated water well contractor's license and was completed on _____. I certify that this record is true to the best of my knowledge and belief. This water well record was completed on _____ under the business name of _____, Kansas Water Well Contractor's License No. _____ under the authority of the designated person as defined in K.A.R. 28-30-2(j) and signed and certified by the electronic signature of the designated person at its submittal: _____.

Send one copy to WATER WELL OWNER and retain one for your records. Fee of \$5.00 for each constructed well.

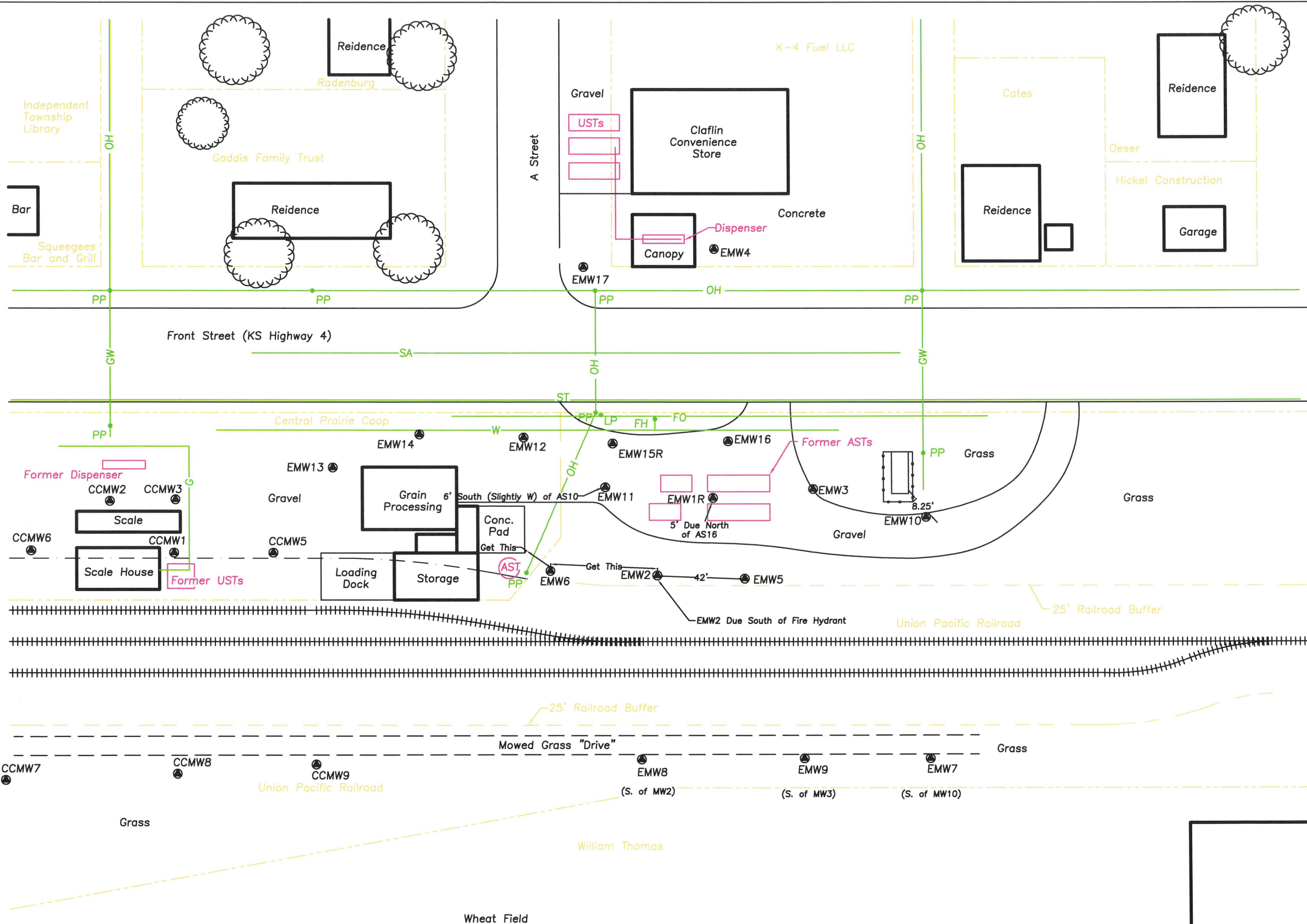

Legend

- EMW1 - Essmiller Monitoring Well
- CCMW1 - Claflin Coop Monitoring Well (Existing)
- - - - - Property Line
- Union Pacific Railroad - Property Owner Name
- OH — Overhead Power Line
- SA — Sanitary Sewer Line (~4' deep)
- FO — Fiber Optic (~3' Deep)
- W — Water Line (~4' deep)
- G — Gas Line (~3' deep)
- BT — Buried Telephone (~3' deep)
- ST — Storm Sewer (~2' deep)
- GW — Guy Wire
- PP • Power Pole
- LP • Light Pole
- MH • Manhole
- Ped • Phone Pedestal
- WM • Water Meter
- FH • Fire Hydrant
- CO • Clean Out
- Tree

Scale In Feet

0 50 100

Area Base Map
Essmiller Oil Co. Claflin, Kansas
KDHE Project Code: A6-005-40491
Final Remedial Report
CGP Project #21916K
Prepared By: TM Date: 09-13-2023
Reviewed By: MK Date: 09-14-2023
Figure 3.1.1
CGP, Inc. PO Box 23, Wahoo, NE 68066

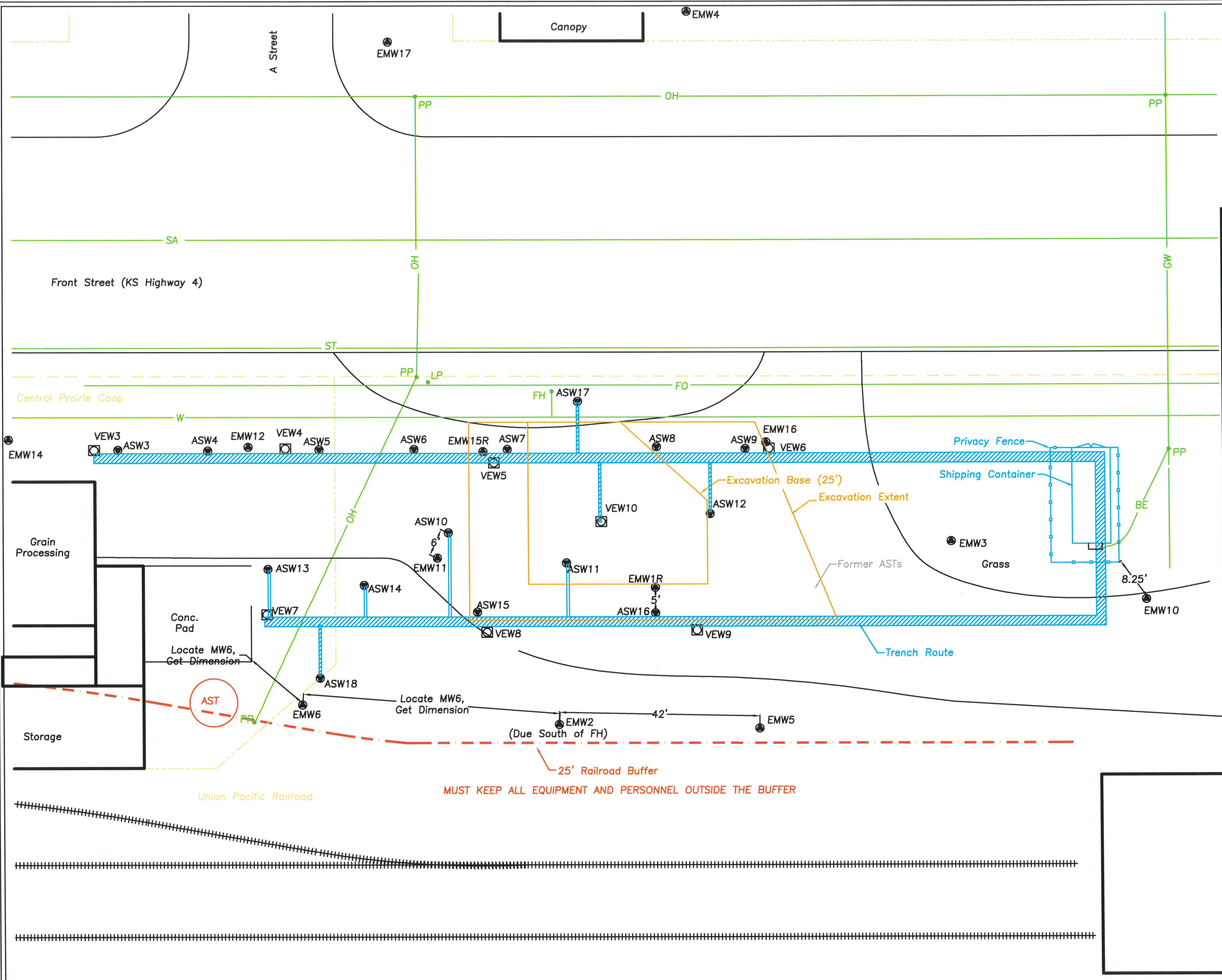
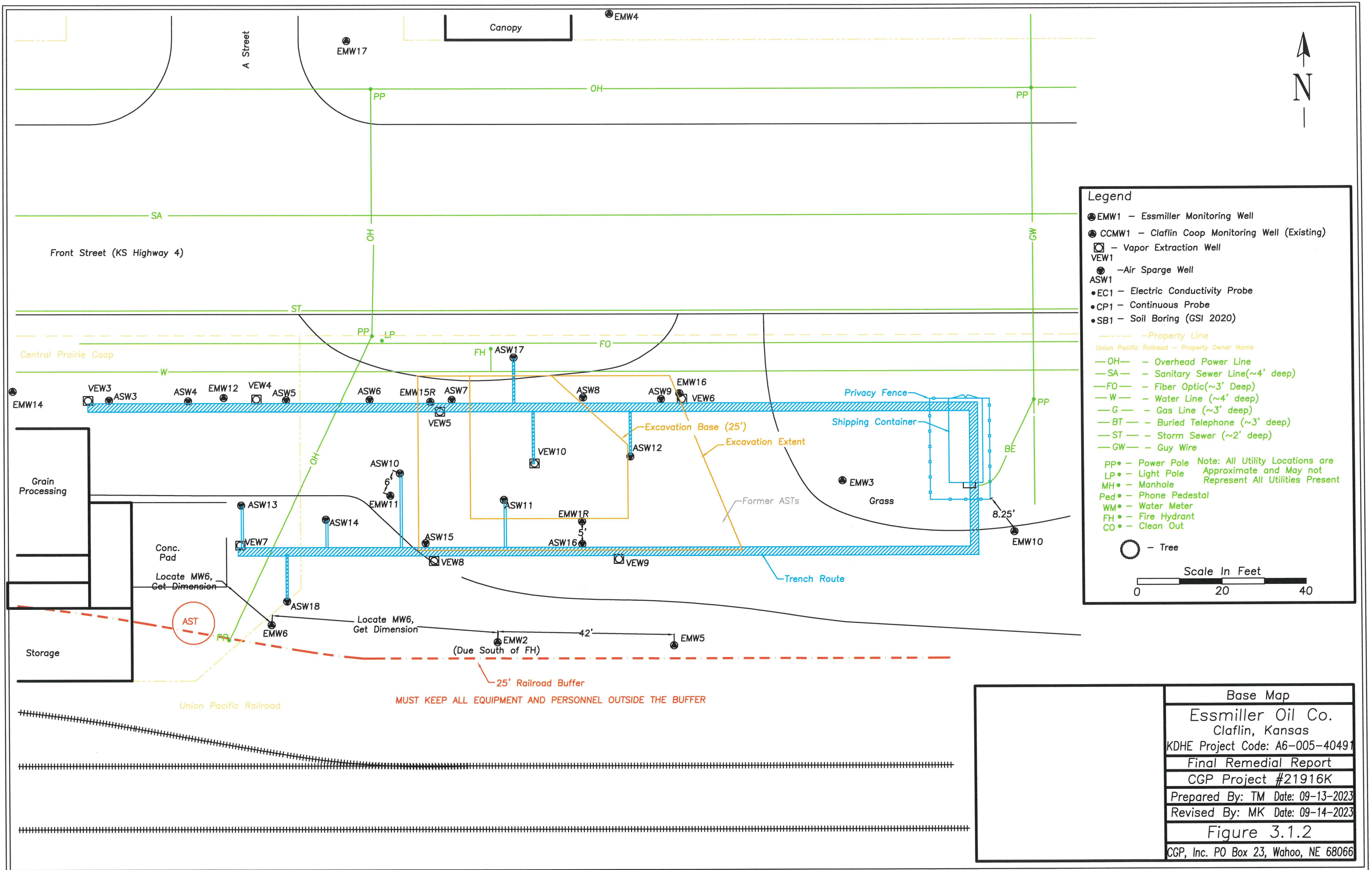

Legend

- EMW1 - Essmiller Monitoring Well
- CCMW1 - Claflin Coop Monitoring Well (Existing)
- - Vapor Extraction Well
- VEW1
- - Air Sparge Well
- ASW1
- EC1 - Electric Conductivity Probe
- CP1 - Continuous Probe
- SB1 - Soil Boring (GSI 2020)
- - - - - Property Line
- Union Pacific Railroad - Property Owner Name
- OH - Overhead Power Line
- SA - Sanitary Sewer Line (~4' deep)
- FO - Fiber Optic (~3' Deep)
- W - Water Line (~4' deep)
- G - Gas Line (~3' deep)
- BT - Buried Telephone (~3' deep)
- ST - Storm Sewer (~2' deep)
- GW - Guy Wire
- PP● - Power Pole
- LP● - Light Pole
- MH● - Manhole
- Ped● - Phone Pedestal
- WM● - Water Meter
- FH● - Fire Hydrant
- CO● - Clean Out
- - Tree

Note: All Utility Locations are Approximate and May not Represent All Utilities Present

Scale In Feet: 0, 20, 40

Base Map	
Essmiller Oil Co. Claflin, Kansas	
KDHE Project Code: A6-005-40491	
Final Remedial Report	
CGP Project #21916K	
Prepared By: TM	Date: 09-13-2023
Revised By: MK	Date: 09-14-2023
Figure 3.1.2	
CGP, Inc. PO Box 23, Wahoo, NE 68066	