

WATER WELL RECORD (WWC-5)

KOLAR DOC ID _____ WELL ID _____
 Original Record Correction Change in Well Use

LOCATION OF WATER WELL

Latitude		Longitude		Section		Township		Range		E W	Fraction	¼	¼	¼
Datum		Elevation		County										

WATER WELL OWNER

Name	
Business	
Address	
Well location at owner's address	

WELL WATER USE

COMPLETION

Depth of completed well: _____ ft.
 Depth(s) groundwater encountered:
 (1) _____ ft.; (2) _____ ft.;
 (3) _____ ft.; (4) dry well

Static water level in well: _____ ft.
 measured below land surface on (mm/dd/yy): _____
 measured above land surface on (mm/dd/yy): _____

Estimated yield: _____ gpm
 Water level was: _____ ft. after _____ hours
 pumping _____ gpm
 Pump installed? Yes No

Water well disinfected? Yes No
 Date disinfected (mm/dd/yy): _____

Aquifer, if known: _____

NEAREST SOURCE OF POTENTIAL CONTAMINATION

Source: _____
 Distance from well: _____ Direction from well: _____
 Source description: _____

Source: _____
 Distance from well: _____ Direction from well: _____
 Source description: _____

No potential source of contamination within 100 feet.

CONSTRUCTION

Borehole interval: from _____ to _____ ft.	Borehole diameter: _____ in.
from _____ to _____ ft.	_____ in.
Casing height above land surface: _____ in. If casing height is less than 12 in. has a variance been approved? * Yes No *variance not required for monitoring or environmental remediation wells	
Casing type: _____	
Blank casing interval: _____ ft. to _____ ft.	
Blank casing diameter: _____ in.	
Casing joints: _____	
Weight: _____ lbs/ft.	
Wall thickness or gauge no.: _____	
Blank casing interval: _____ ft. to _____ ft.	
Blank casing diameter: _____ in.	
Casing joints: _____	
Weight: _____ lbs/ft.	
Wall thickness or gauge no.: _____	
Grout interval: _____ ft. to _____ ft.	
Grout material: _____	
Grout interval: _____ ft. to _____ ft.	
Grout material: _____	
Screen / perforation material: _____	
Screen / perforation openings: _____	
Screen / perforation intervals: From _____ ft. to _____ ft. Slot size _____ unit _____	
From _____ ft. to _____ ft. Slot size _____ unit _____	
Gravel pack intervals: Gravel pack not used: Gravel size _____ in. From _____ ft. to _____ ft.	
Gravel pack not used: Gravel size _____ in. From _____ ft. to _____ ft.	

PERMIT & ID NUMBERS (AS REQUIRED)

DWR Application No.: _____
 KDHE / EPA Project Code: _____
 Site Name: _____
 KDHE UIC Class V Form Completed: Yes No
 County Permit: Yes No Permit ID: _____
 Lease Name & Well #: _____
 # of boreholes: _____ # of dewatering wells: _____

LITHOLOGIC LOG

FROM	TO	LITHOLOGY INTERVALS

COMMENTS

CONTRACTOR'S OR LANDOWNERS CERTIFICATION

This water well was constructed reconstructed pursuant to the stated water well contractor's license and was completed on _____. I certify that this record is true to the best of my knowledge and belief. This water well record was completed on _____ under the business name of _____, Kansas Water Well Contractor's License No. _____ under the authority of the designated person as defined in K.A.R. 28-30-2(j) and signed and certified by the electronic signature of the designated person at its submittal: _____.

Send one copy to WATER WELL OWNER and retain one for your records. Fee of \$5.00 for each constructed well.

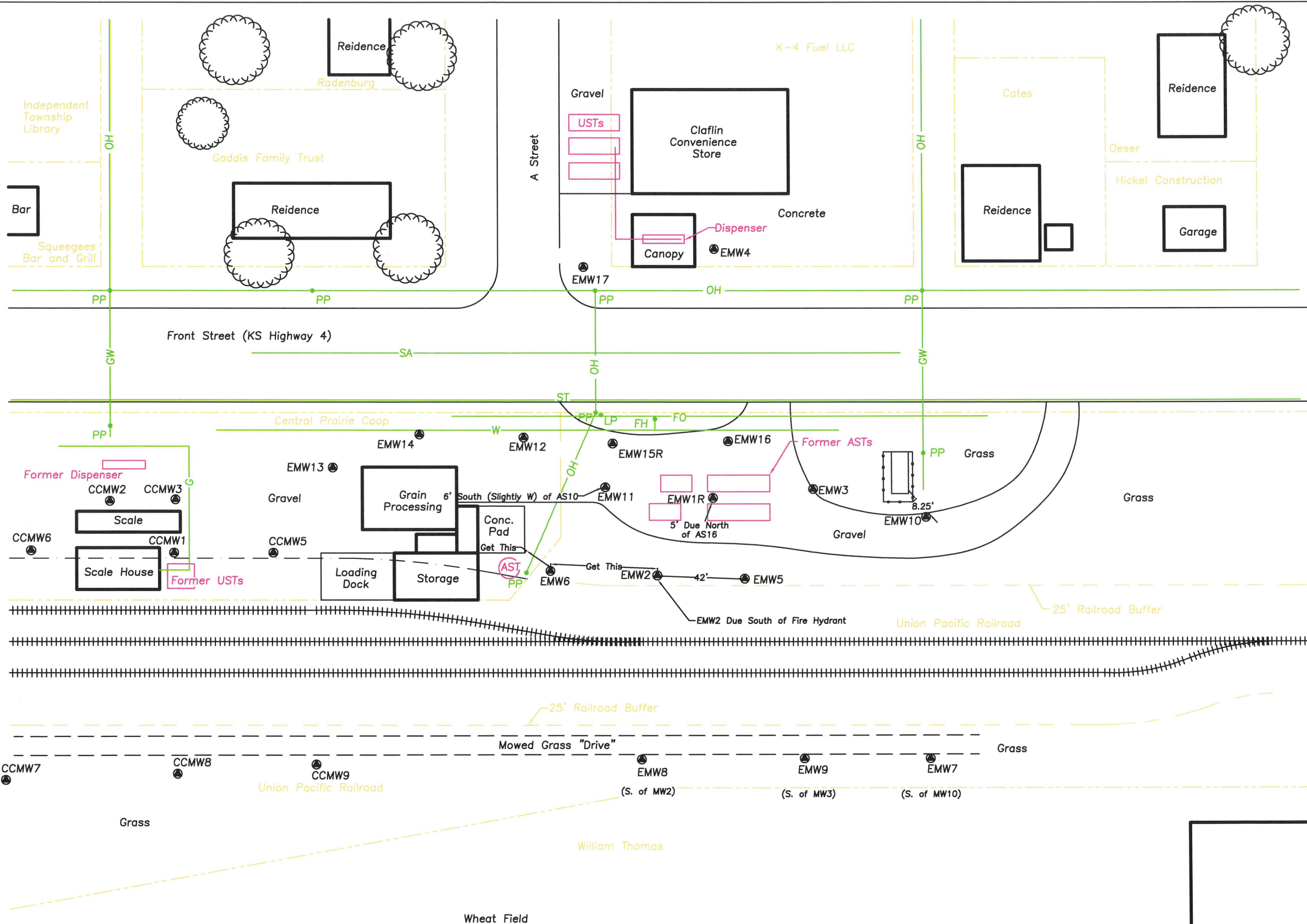

Legend

- EMW1 - Essmiller Monitoring Well
- CCMW1 - Claflin Coop Monitoring Well (Existing)
- - - - - Property Line
- Union Pacific Railroad - Property Owner Name
- OH — Overhead Power Line
- SA — Sanitary Sewer Line (~4' deep)
- FO — Fiber Optic (~3' Deep)
- W — Water Line (~4' deep)
- G — Gas Line (~3' deep)
- BT — Buried Telephone (~3' deep)
- ST — Storm Sewer (~2' deep)
- GW — Guy Wire
- PP • Power Pole
- LP • Light Pole
- MH • Manhole
- Ped • Phone Pedestal
- WM • Water Meter
- FH • Fire Hydrant
- CO • Clean Out
- Tree

Scale In Feet
0 50 100

Area Base Map	
Essmiller Oil Co. Claflin, Kansas	
KDHE Project Code: A6-005-40491	
Final Remedial Report	
CGP Project #21916K	
Prepared By: TM	Date: 09-13-2023
Reviewed By: MK	Date: 09-14-2023
Figure 3.1.1	
CGP, Inc. PO Box 23, Wahoo, NE 68066	

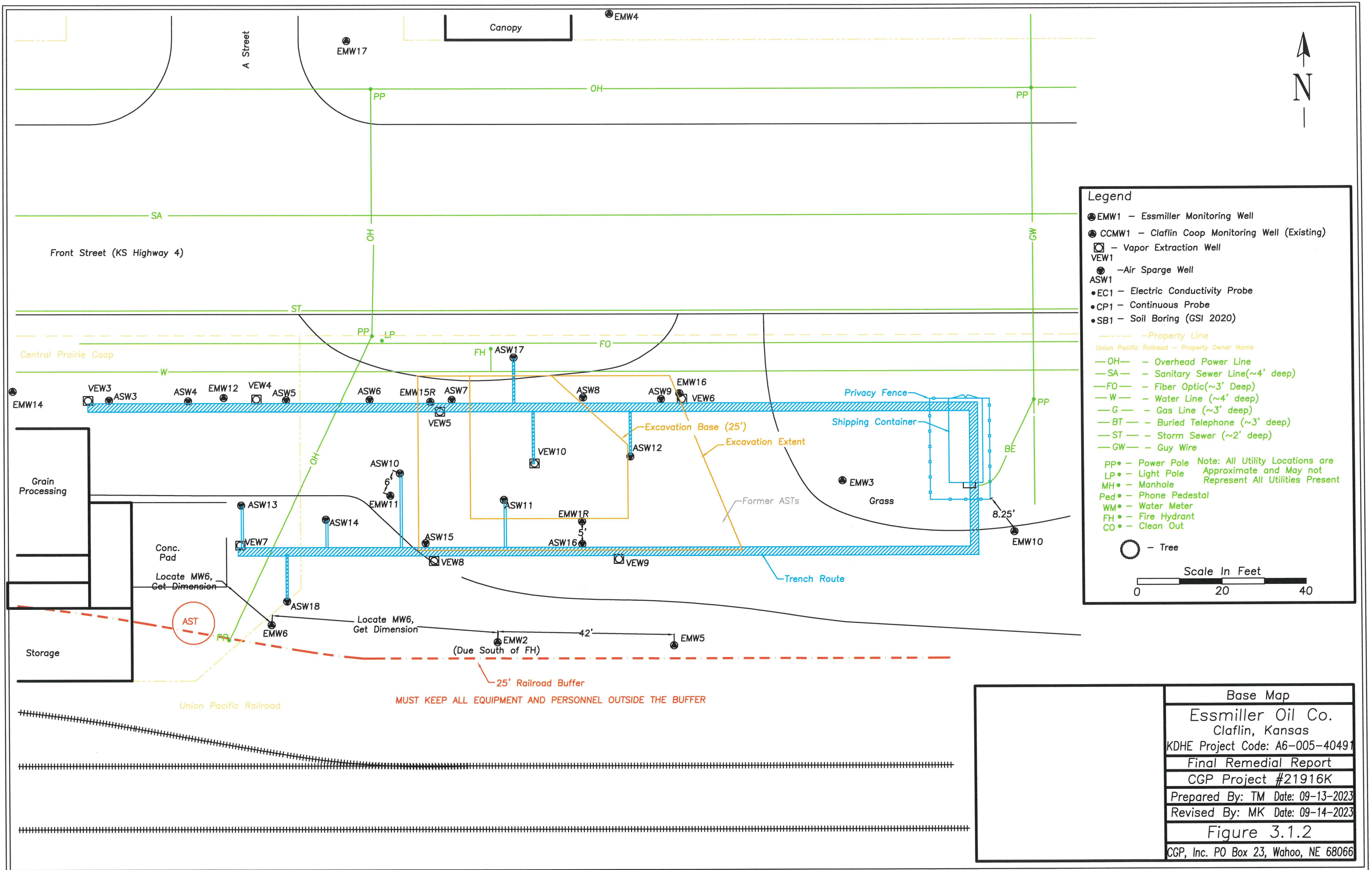

Legend

- EMW1 - Essmiller Monitoring Well
- CCMW1 - Claflin Coop Monitoring Well (Existing)
- - Vapor Extraction Well
- VEW1
- - Air Sparge Well
- ASW1
- EC1 - Electric Conductivity Probe
- CP1 - Continuous Probe
- SB1 - Soil Boring (GSI 2020)
- - Property Line
- Union Pacific Railroad - Property Owner Name
- OH- - Overhead Power Line
- SA- - Sanitary Sewer Line (~4' deep)
- FO- - Fiber Optic (~3' Deep)
- W- - Water Line (~4' deep)
- G- - Gas Line (~3' deep)
- BT- - Buried Telephone (~3' deep)
- ST- - Storm Sewer (~2' deep)
- GW- - Guy Wire
- PP• - Power Pole Note: All Utility Locations are Approximate and May not Represent All Utilities Present
- LP• - Light Pole
- MH• - Manhole
- Ped• - Phone Pedestal
- WM• - Water Meter
- FH• - Fire Hydrant
- CO• - Clean Out
- - Tree

Scale In Feet
0 20 40

Base Map	
Essmiller Oil Co. Claflin, Kansas	
KDHE Project Code: A6-005-40491	
Final Remedial Report	
CGP Project #21916K	
Prepared By: TM	Date: 09-13-2023
Revised By: MK	Date: 09-14-2023
Figure 3.1.2	
CGP, Inc. PO Box 23, Wahoo, NE 68066	

MUST KEEP ALL EQUIPMENT AND PERSONNEL OUTSIDE THE BUFFER

25' Railroad Buffer

Union Pacific Railroad

Conc. Pad
Locate MW6,
Get Dimension

AST

Locate MW6,
Get Dimension

(Due South of FH)

42'

8.25'

Front Street (KS Highway 4)

A Street

Canopy



Grain Processing

Storage

Privacy Fence

Shipping Container

Grass

Former ASTs

Trench Route

Excavation Base (25')

Excavation Extent

EMW17

EMW4

PP

OH

PP

SA

OH

GW

ST

PP

LP

FO

W

FH

EMW14

VEW3

ASW3

ASW4

EMW12

VEW4

ASW5

ASW6

EMW15R

ASW7

ASW8

ASW9

EMW16

VEW6

ASW10

EMW11

ASW11

EMW1R

ASW12

ASW15

ASW16

VEW5

ASW13

ASW14

VEW7

ASW18

VEW8

VEW9

VEW10

ASW17

EMW2

EMW5

PP

BE

EMW10

EMW3