

**WATER WELL RECORD (WWC-5)**

KOLAR DOC ID \_\_\_\_\_ WELL ID \_\_\_\_\_  
 Original Record      Correction      Change in Well Use

**LOCATION OF WATER WELL**

Latitude		Longitude		Section		Township		Range		E W	Fraction	¼	¼	¼
Datum		Elevation		County										

**WATER WELL OWNER**

Name	
Business	
Address	
Well location at owner's address	

**WELL WATER USE**

\_\_\_\_\_

**COMPLETION**

Depth of completed well: \_\_\_\_\_ ft.  
 Depth(s) groundwater encountered:  
 (1) \_\_\_\_\_ ft.; (2) \_\_\_\_\_ ft.;  
 (3) \_\_\_\_\_ ft.; (4) dry well

Static water level in well: \_\_\_\_\_ ft.  
 measured below land surface on (mm/dd/yy): \_\_\_\_\_  
 measured above land surface on (mm/dd/yy): \_\_\_\_\_

Estimated yield: \_\_\_\_\_ gpm  
 Water level was: \_\_\_\_\_ ft. after \_\_\_\_\_ hours  
 pumping \_\_\_\_\_ gpm

Pump installed?    Yes    No

Water well disinfected?    Yes    No  
 Date disinfected (mm/dd/yy): \_\_\_\_\_

Aquifer, if known: \_\_\_\_\_

**NEAREST SOURCE OF POTENTIAL CONTAMINATION**

Source: \_\_\_\_\_  
 Distance from well: \_\_\_\_\_      Direction from well: \_\_\_\_\_  
 Source description: \_\_\_\_\_

Source: \_\_\_\_\_  
 Distance from well: \_\_\_\_\_      Direction from well: \_\_\_\_\_  
 Source description: \_\_\_\_\_

No potential source of contamination within 100 feet.

**CONSTRUCTION**

Borehole interval: from _____ to _____ ft.	Borehole diameter: _____ in.
from _____ to _____ ft.	_____ in.
Casing height above land surface: _____ in. If casing height is less than 12 in. has a variance been approved? * Yes    No *variance not required for monitoring or environmental remediation wells	
Casing type: _____	
Blank casing interval: _____ ft. to _____ ft.	
Blank casing diameter: _____ in.	
Casing joints: _____	
Weight: _____ lbs/ft.	
Wall thickness or gauge no.: _____	
Blank casing interval: _____ ft. to _____ ft.	
Blank casing diameter: _____ in.	
Casing joints: _____	
Weight: _____ lbs/ft.	
Wall thickness or gauge no.: _____	
Grout interval: _____ ft. to _____ ft.	
Grout material: _____	
Grout interval: _____ ft. to _____ ft.	
Grout material: _____	
Screen / perforation material: _____	
Screen / perforation openings: _____	
Screen / perforation intervals: From _____ ft. to _____ ft. Slot size _____ unit _____	
From _____ ft. to _____ ft. Slot size _____ unit _____	
Gravel pack intervals: Gravel pack not used:    Gravel size _____ in. From _____ ft. to _____ ft.	
Gravel pack not used:    Gravel size _____ in. From _____ ft. to _____ ft.	

**PERMIT & ID NUMBERS (AS REQUIRED)**

DWR Application No.: \_\_\_\_\_  
 KDHE / EPA Project Code: \_\_\_\_\_  
 Site Name: \_\_\_\_\_  
 KDHE UIC Class V Form Completed:    Yes    No  
 County Permit:    Yes    No    Permit ID: \_\_\_\_\_  
 Lease Name & Well #: \_\_\_\_\_  
 # of boreholes: \_\_\_\_\_    # of dewatering wells: \_\_\_\_\_

**LITHOLOGIC LOG**

FROM	TO	LITHOLOGY INTERVALS

**COMMENTS**

\_\_\_\_\_

**CONTRACTOR'S OR LANDOWNERS CERTIFICATION**

This water well was    constructed    reconstructed    pursuant to the stated water well contractor's license and was completed on \_\_\_\_\_. I certify that this record is true to the best of my knowledge and belief. This water well record was completed on \_\_\_\_\_ under the business name of \_\_\_\_\_, Kansas Water Well Contractor's License No. \_\_\_\_\_ under the authority of the designated person as defined in K.A.R. 28-30-2(j) and signed and certified by the electronic signature of the designated person at its submittal: \_\_\_\_\_.

Send one copy to WATER WELL OWNER and retain one for your records. Fee of \$5.00 for each constructed well.

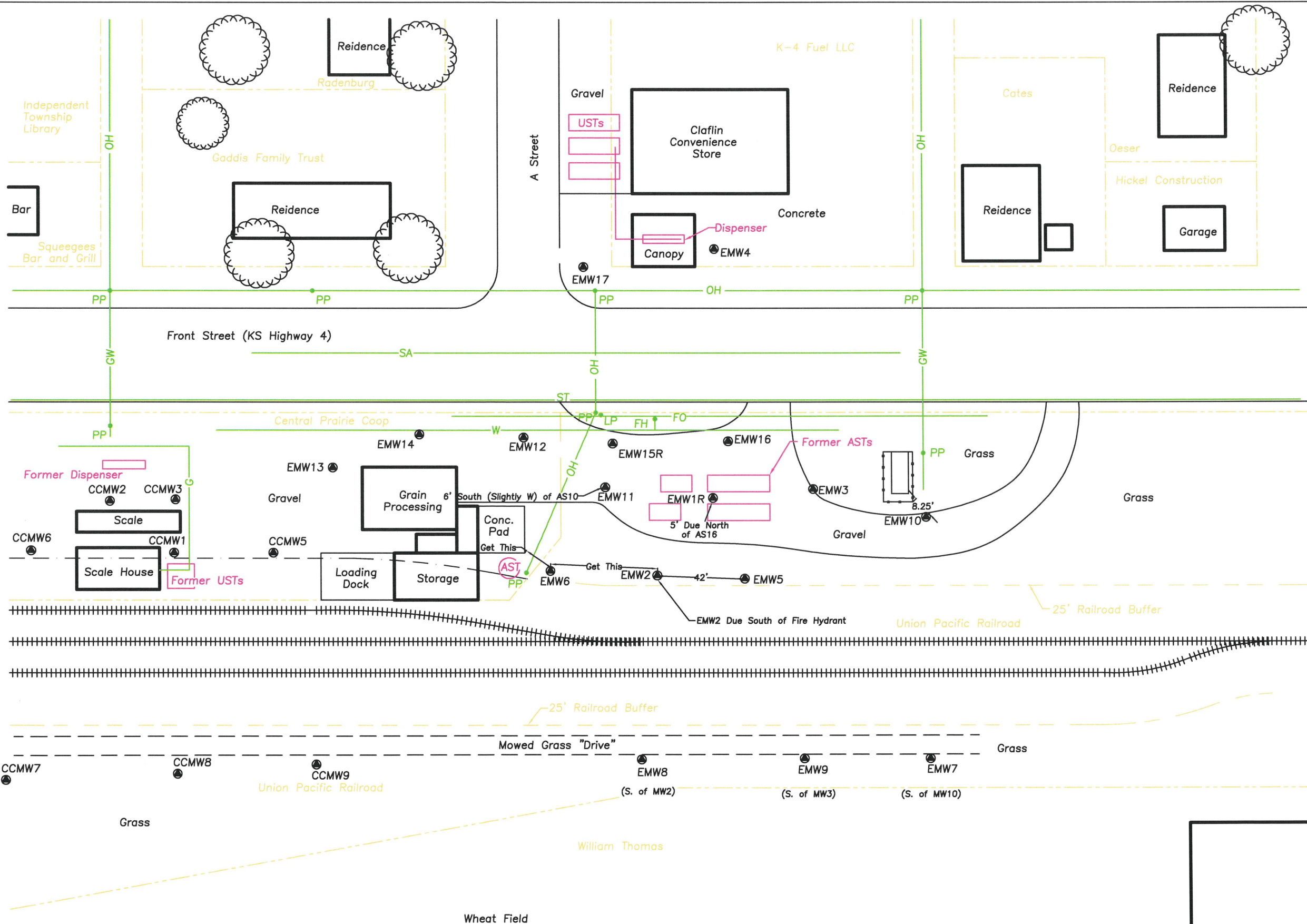

**Legend**

- EMW1 - Essmiller Monitoring Well
- CCMW1 - Claflin Coop Monitoring Well (Existing)
- - - - - Property Line
- Union Pacific Railroad - Property Owner Name
- OH — Overhead Power Line
- SA — Sanitary Sewer Line (~4' deep)
- FO — Fiber Optic (~3' Deep)
- W — Water Line (~4' deep)
- G — Gas Line (~3' deep)
- BT — Buried Telephone (~3' deep)
- ST — Storm Sewer (~2' deep)
- GW — Guy Wire
- PP • Power Pole
- LP • Light Pole
- MH • Manhole
- Ped • Phone Pedestal
- WM • Water Meter
- FH • Fire Hydrant
- CO • Clean Out
- Tree

Scale In Feet  
0 50 100

Area Base Map	
Essmiller Oil Co. Claflin, Kansas	
KDHE Project Code: A6-005-40491	
Final Remedial Report	
CGP Project #21916K	
Prepared By: TM	Date: 09-13-2023
Reviewed By: MK	Date: 09-14-2023
Figure 3.1.1	
CGP, Inc. PO Box 23, Wahoo, NE 68066	



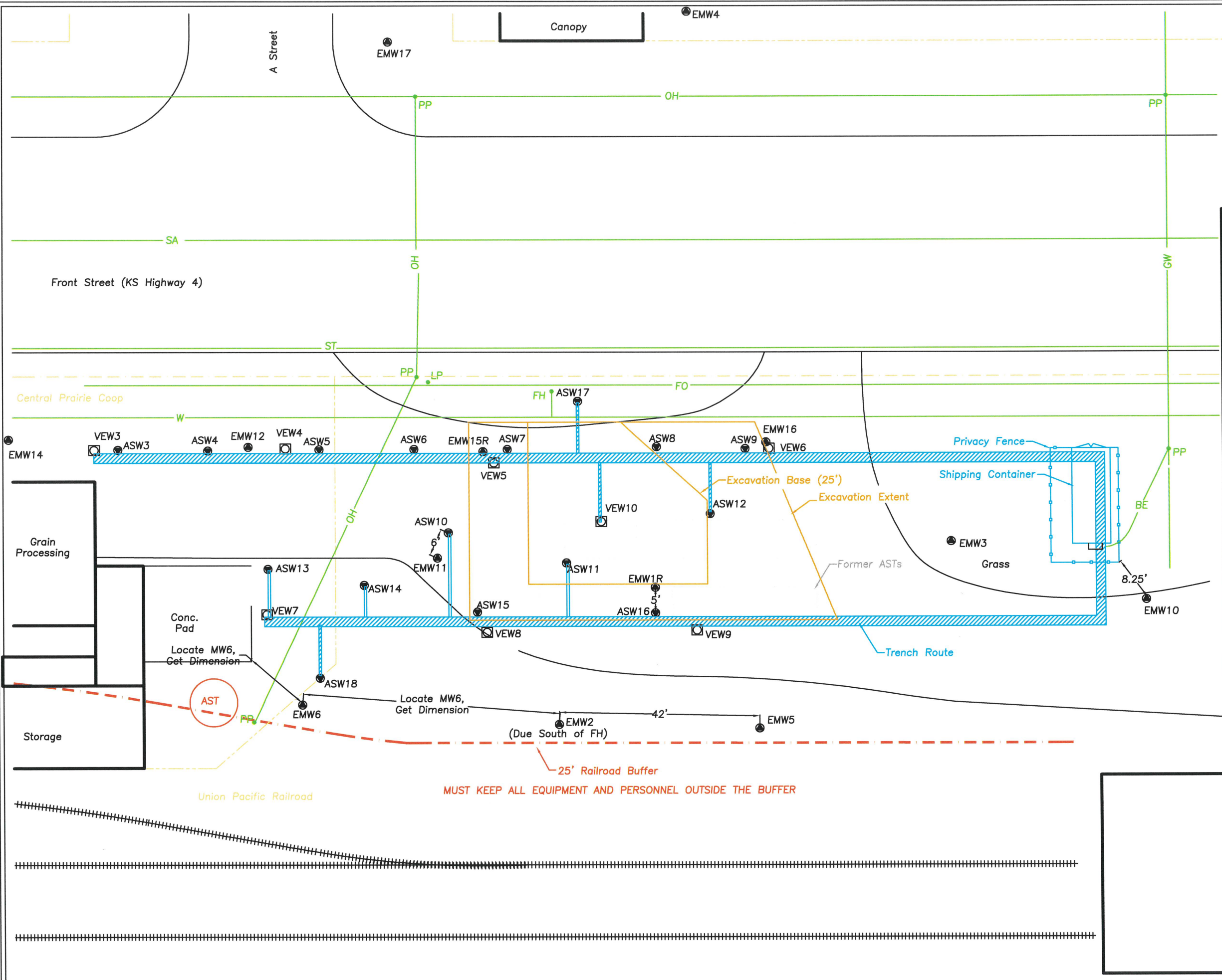
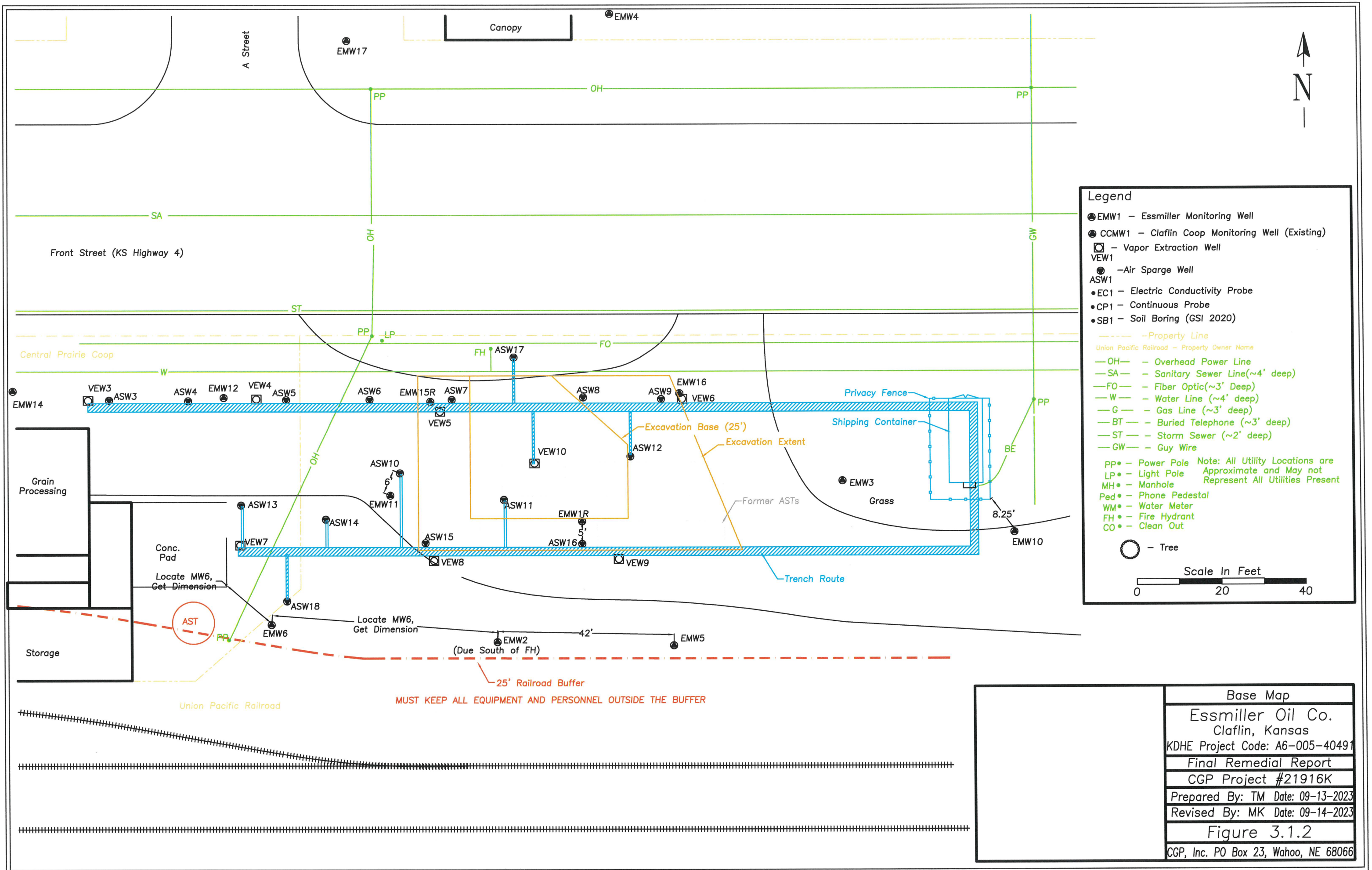

**Legend**

- EMW1 - Essmiller Monitoring Well
- CCMW1 - Claflin Coop Monitoring Well (Existing)
- - Vapor Extraction Well VEW1
- - Air Sparge Well ASW1
- EC1 - Electric Conductivity Probe
- CP1 - Continuous Probe
- SB1 - Soil Boring (GSI 2020)
- - - - - Property Line
- Union Pacific Railroad - Property Owner Name
- OH - Overhead Power Line
- SA - Sanitary Sewer Line (~4' deep)
- FO - Fiber Optic (~3' Deep)
- W - Water Line (~4' deep)
- G - Gas Line (~3' deep)
- BT - Buried Telephone (~3' deep)
- ST - Storm Sewer (~2' deep)
- GW - Guy Wire
- PP● - Power Pole Note: All Utility Locations are Approximate and May not Represent All Utilities Present
- LP● - Light Pole
- MH● - Manhole
- Ped● - Phone Pedestal
- WM● - Water Meter
- FH● - Fire Hydrant
- CO● - Clean Out
- - Tree

**Scale In Feet**  
0 20 40

**Base Map**  
Essmiller Oil Co.  
Claflin, Kansas  
KDHE Project Code: A6-005-40491  
Final Remedial Report  
CGP Project #21916K  
Prepared By: TM Date: 09-13-2023  
Revised By: MK Date: 09-14-2023  
Figure 3.1.2  
CGP, Inc. PO Box 23, Wahoo, NE 68066