

WATER WELL RECORD (WWC-5)

KOLAR DOC ID _____ WELL ID _____
 Original Record Correction Change in Well Use

LOCATION OF WATER WELL

| | | | | | | | | | | | | | | |
|----------|--|-----------|--|---------|--|----------|--|-------|--|--------|----------|---|---|---|
| Latitude | | Longitude | | Section | | Township | | Range | | E W | Fraction | ¼ | ¼ | ¼ |
| Datum | | Elevation | | County | | | | | | | | | | |

WATER WELL OWNER

| | |
|---|--|
| Name | |
| Business | |
| Address | |
| Well location at owner's address | |

WELL WATER USE

| |
|--|
| |
|--|

COMPLETION

| |
|---|
| Depth of completed well: _____ ft. |
| Depth(s) groundwater encountered: (1) _____ ft.; (2) _____ ft.; (3) _____ ft.; (4) dry well |
| Static water level in well: _____ ft. measured below land surface on (mm/dd/yy): _____ measured above land surface on (mm/dd/yy): _____ |
| Estimated yield: _____ gpm |
| Water level was: _____ ft. after _____ hours pumping _____ gpm |
| Pump installed? Yes No |
| Water well disinfected? Yes No |
| Date disinfected (mm/dd/yy): _____ |
| Aquifer, if known: |

NEAREST SOURCE OF POTENTIAL CONTAMINATION

| |
|---|
| Source: _____ |
| Distance from well: _____ Direction from well: _____ |
| Source description: _____ |
| Source: _____ |
| Distance from well: _____ Direction from well: _____ |
| Source description: _____ |
| No potential source of contamination within 100 feet. |

CONSTRUCTION

| | |
|--|---------------------------------|
| Borehole interval: from _____ to _____ ft. | Borehole diameter: _____ in. |
| from _____ to _____ ft. | _____ in. |
| Casing height above land surface: _____ in. | |
| If casing height is less than 12 in. has a variance been approved?* Yes No | |
| *variance not required for monitoring or environmental remediation wells | |
| Casing type: _____ | |
| Blank casing interval: _____ ft. to _____ ft. | |
| Blank casing diameter: _____ in. | |
| Casing joints: _____ | |
| Weight: _____ lbs/ft. | |
| Wall thickness or gauge no.: _____ | |
| Blank casing interval: _____ ft. to _____ ft. | |
| Blank casing diameter: _____ in. | |
| Casing joints: _____ | |
| Weight: _____ lbs/ft. | |
| Wall thickness or gauge no.: _____ | |
| Grout interval: _____ ft. to _____ ft. | |
| Grout material: _____ | |
| Grout interval: _____ ft. to _____ ft. | |
| Grout material: _____ | |
| Screen / perforation material: _____ | |
| Screen / perforation openings: _____ | |
| Screen / perforation intervals: From _____ ft. to _____ ft. | |
| Slot size _____ unit _____ | |
| From _____ ft. to _____ ft. | |
| Slot size _____ unit _____ | |
| Gravel pack intervals: Gravel pack not used: Gravel size _____ in | |
| From _____ ft. to _____ ft. | |
| Gravel pack not used: Gravel size _____ in | |
| From _____ ft. to _____ ft. | |

PERMIT & ID NUMBERS (AS REQUIRED)

| |
|---|
| DWR Application No.: _____ |
| KDHE / EPA Project Code: _____ |
| Site Name: _____ |
| KDHE UIC Class V Form Completed: Yes No |
| County Permit: Yes No Permit ID: _____ |
| Lease Name & Well #: _____ |
| # of boreholes: _____ # of dewatering wells: _____ |

LITHOLOGIC LOG

| FROM | TO | LITHOLOGY INTERVALS |
|------|----|---------------------|
| | | |
| | | |
| | | |
| | | |
| | | |
| | | |
| | | |
| | | |
| | | |
| | | |

COMMENTS

| |
|--|
| |
|--|

CONTRACTOR'S OR LANDOWNERS CERTIFICATION

| |
|---|
| This water well was constructed reconstructed pursuant to the stated water well contractor's license and was completed on _____. I certify that this record is true to the best of my knowledge and belief. This water well record was completed on _____ under the business name of _____, Kansas Water Well Contractor's License No. _____ under the authority of the designated person as defined in K.A.R. 28-30-2(j) and signed and certified by the electronic signature of the designated person at its submittal: _____. |
|---|

Send one copy to WATER WELL OWNER and retain one for your records. Fee of \$5.00 for each constructed well.

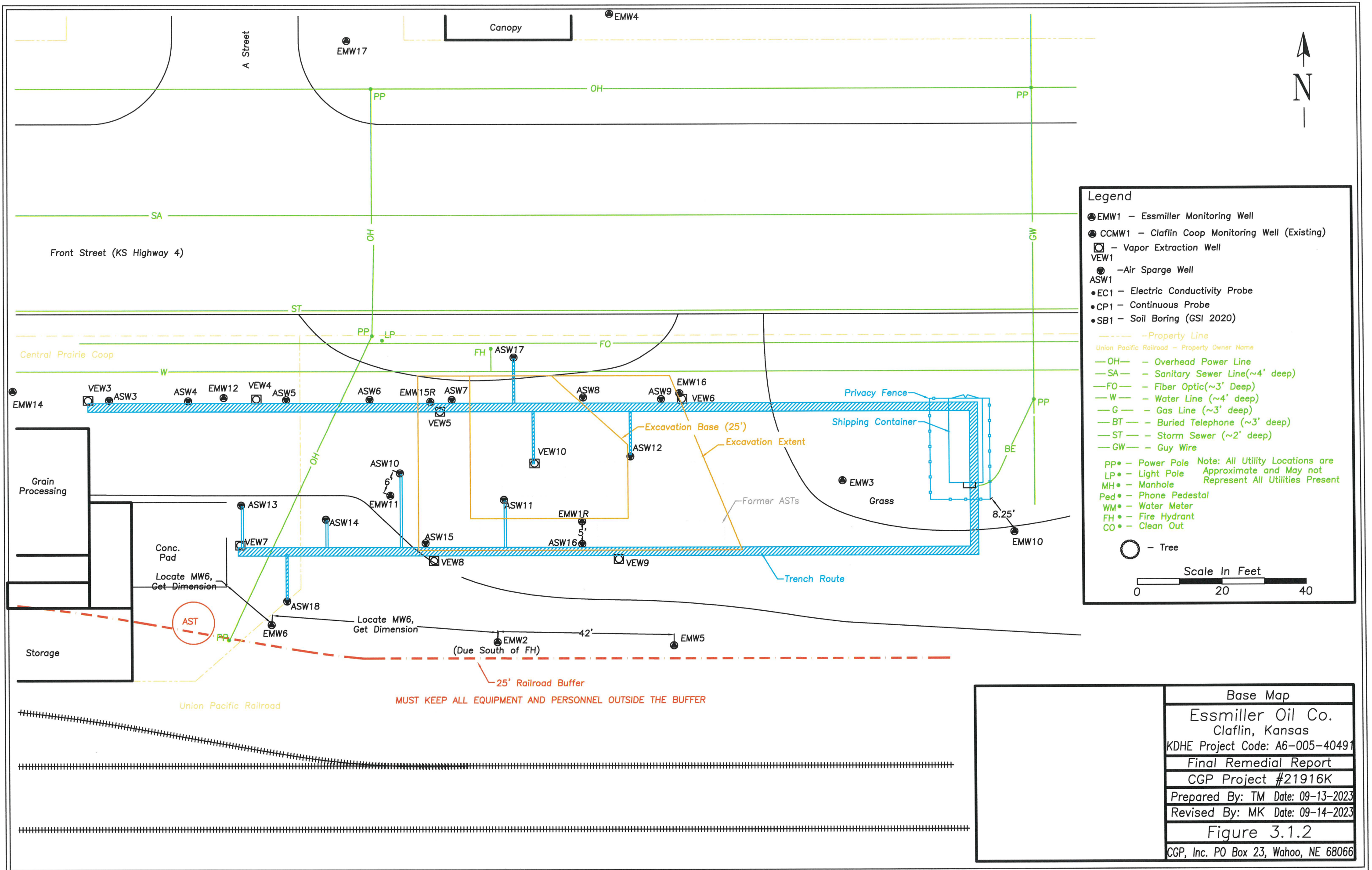

Legend

- EMW1 - Essmiller Monitoring Well
- CCMW1 - Claflin Coop Monitoring Well (Existing)
- - Vapor Extraction Well
- VEW1
- - Air Sparge Well
- ASW1
- EC1 - Electric Conductivity Probe
- CP1 - Continuous Probe
- SB1 - Soil Boring (GSI 2020)
- - Property Line
- Union Pacific Railroad - Property Owner Name
- OH- - Overhead Power Line
- SA- - Sanitary Sewer Line (~4' deep)
- FO- - Fiber Optic (~3' Deep)
- W- - Water Line (~4' deep)
- G- - Gas Line (~3' deep)
- BT- - Buried Telephone (~3' deep)
- ST- - Storm Sewer (~2' deep)
- GW- - Guy Wire
- PP● - Power Pole Note: All Utility Locations are Approximate and May not Represent All Utilities Present
- LP● - Light Pole
- MH● - Manhole
- Ped● - Phone Pedestal
- WM● - Water Meter
- FH● - Fire Hydrant
- CO● - Clean Out
- - Tree

Scale In Feet
0 20 40

| | |
|--------------------------------------|------------------|
| Base Map | |
| Essmiller Oil Co. Claflin, Kansas | |
| KDHE Project Code: A6-005-40491 | |
| Final Remedial Report | |
| CGP Project #21916K | |
| Prepared By: TM | Date: 09-13-2023 |
| Revised By: MK | Date: 09-14-2023 |
| Figure 3.1.2 | |
| CGP, Inc. PO Box 23, Wahoo, NE 68066 | |

MUST KEEP ALL EQUIPMENT AND PERSONNEL OUTSIDE THE BUFFER

25' Railroad Buffer

Union Pacific Railroad

Conc. Pad
Locate MW6,
Get Dimension

AST

Locate MW6,
Get Dimension

(Due South of FH)

42'

8.25'

Front Street (KS Highway 4)

A Street

Canopy



Grain Processing

Storage

Privacy Fence

Shipping Container

Grass

Former ASTs

Trench Route

Excavation Base (25')

Excavation Extent

EMW17

EMW4

PP

OH

PP

SA

OH

GW

ST

PP

LP

FO

W

FH

EMW14

VEW3

ASW3

ASW4

EMW12

VEW4

ASW5

ASW6

EMW15R

ASW7

ASW8

ASW9

EMW16

VEW6

ASW10

EMW11

ASW11

EMW1R

ASW12

VEW10

ASW14

ASW13

VEW7

ASW15

VEW8

ASW16

EMW1R

ASW16

VEW9

ASW18

EMW6

EMW2

EMW5

PP

BE

EMW10

PP

42'

8.25'