

WATER WELL RECORD (WWC-5)

KOLAR DOC ID _____ WELL ID _____
 Original Record Correction Change in Well Use

LOCATION OF WATER WELL

| | | | | | | | | | | | | | | | | | |
|----------|--|-----------|--|---------|--|----------|--|-------|--|--------|----------|--|---|--|---|--|---|
| Latitude | | Longitude | | Section | | Township | | Range | | E W | Fraction | | ¼ | | ¼ | | ¼ |
| Datum | | Elevation | | County | | | | | | | | | | | | | |

WATER WELL OWNER

| | |
|--------------------|--|
| Name | |
| Business | |
| Address | |
| Well location | |
| at owner's address | |

WELL WATER USE

| |
|--|
| |
|--|

COMPLETION

Depth of completed well: _____ ft.
 Depth(s) groundwater encountered:
 (1) _____ ft.; (2) _____ ft.;
 (3) _____ ft.; (4) dry well

Static water level in well: _____ ft.
 measured below land surface on (mm/dd/yy): _____
 measured above land surface on (mm/dd/yy): _____

Estimated yield: _____ gpm
 Water level was: _____ ft. after _____ hours
 pumping _____ gpm

Pump installed? Yes No

Water well disinfected? Yes No
 Date disinfected (mm/dd/yy): _____

Aquifer, if known: _____

NEAREST SOURCE OF POTENTIAL CONTAMINATION

Source: _____
 Distance from well: _____ Direction from well: _____
 Source description: _____

Source: _____
 Distance from well: _____ Direction from well: _____
 Source description: _____

No potential source of contamination within 100 feet.

CONSTRUCTION

| | |
|--|---------------------------------|
| Borehole interval: from _____ to _____ ft. | Borehole diameter: _____ in. |
| from _____ to _____ ft. | _____ in. |
| Casing height above land surface: _____ in. If casing height is less than 12 in. has a variance been approved? * Yes No *variance not required for monitoring or environmental remediation wells | |
| Casing type: _____ | |
| Blank casing interval: _____ ft. to _____ ft. | |
| Blank casing diameter: _____ in. | |
| Casing joints: _____ | |
| Weight: _____ lbs/ft. | |
| Wall thickness or gauge no.: _____ | |
| Blank casing interval: _____ ft. to _____ ft. | |
| Blank casing diameter: _____ in. | |
| Casing joints: _____ | |
| Weight: _____ lbs/ft. | |
| Wall thickness or gauge no.: _____ | |
| Grout interval: _____ ft. to _____ ft. | |
| Grout material: _____ | |
| Grout interval: _____ ft. to _____ ft. | |
| Grout material: _____ | |
| Screen / perforation material: _____ | |
| Screen / perforation openings: _____ | |
| Screen / perforation intervals: From _____ ft. to _____ ft. | |
| Slot size _____ unit _____ | |
| From _____ ft. to _____ ft. | |
| Slot size _____ unit _____ | |
| Gravel pack intervals: Gravel pack not used: Gravel size _____ in | |
| From _____ ft. to _____ ft. | |
| Gravel pack not used: Gravel size _____ in | |
| From _____ ft. to _____ ft. | |

PERMIT & ID NUMBERS (AS REQUIRED)

DWR Application No.: _____
 KDHE / EPA Project Code: _____
 Site Name: _____
 KDHE UIC Class V Form Completed: Yes No
 County Permit: Yes No Permit ID: _____
 Lease Name & Well #: _____
 # of boreholes: _____ # of dewatering wells: _____

LITHOLOGIC LOG

| FROM | TO | LITHOLOGY INTERVALS |
|------|----|---------------------|
| | | |
| | | |
| | | |
| | | |
| | | |
| | | |
| | | |
| | | |
| | | |
| | | |

COMMENTS

| |
|--|
| |
|--|

CONTRACTOR'S OR LANDOWNERS CERTIFICATION

This water well was constructed reconstructed pursuant to the stated water well contractor's license and was completed on _____. I certify that this record is true to the best of my knowledge and belief. This water well record was completed on _____ under the business name of _____, Kansas Water Well Contractor's License No. _____ under the authority of the designated person as defined in K.A.R. 28-30-2(j) and signed and certified by the electronic signature of the designated person at its submittal: _____.

Send one copy to WATER WELL OWNER and retain one for your records. Fee of \$5.00 for each constructed well.

FULL SITE SURVEY

QUICK TRIP #314
DERBY, KANSAS

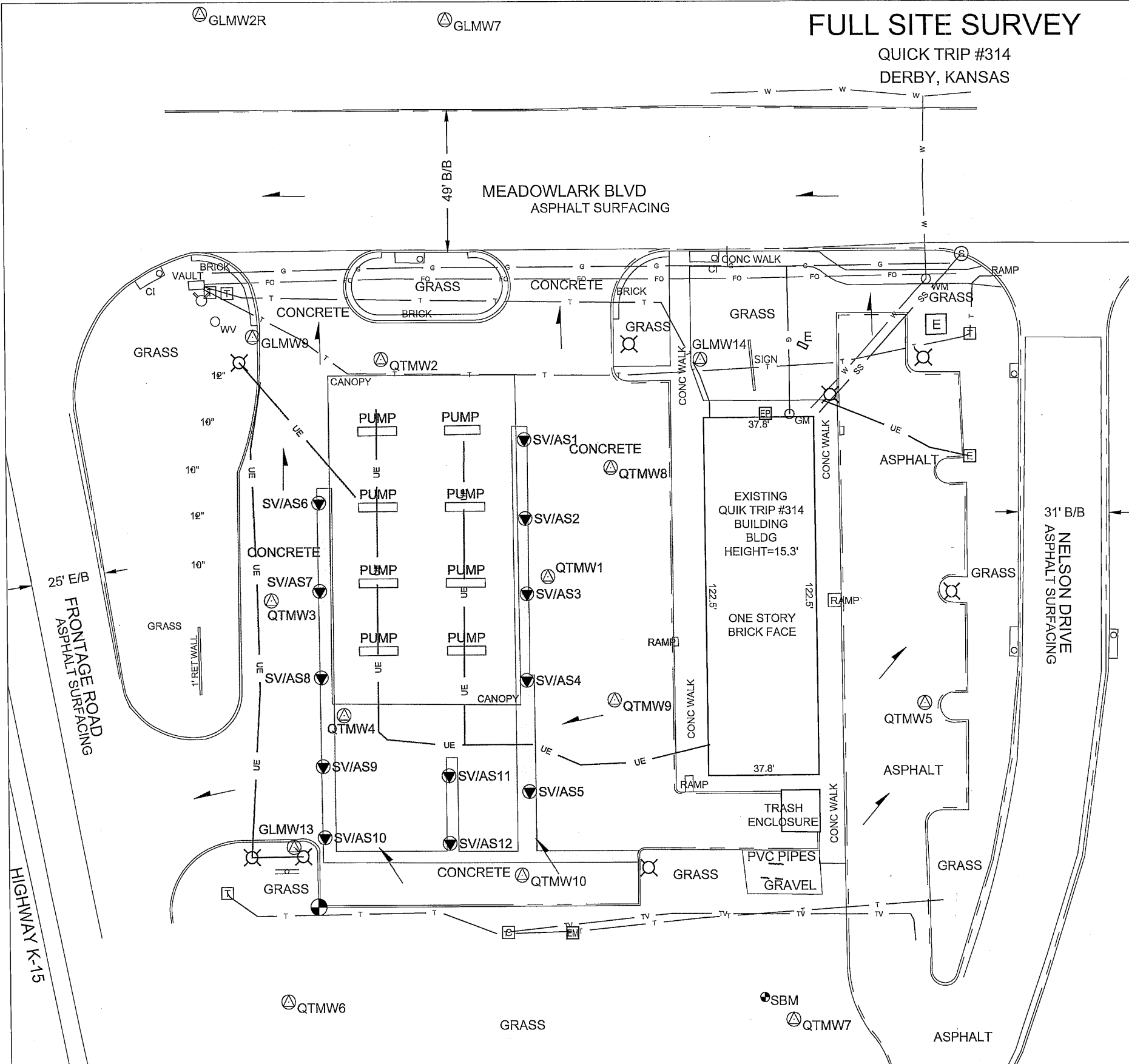

| Point | North Coordinate | East Coordinate | Distance from SE Cor. North | Distance from SE Cor. West | *Elev. Top of Rim or PK Nail | Elev. Top of PVC Pipe | Latitude North | Longitude West |
|---------------|------------------|-----------------|-----------------------------|----------------------------|------------------------------|-----------------------|----------------|----------------|
| SE Cor. | 10000 | 10000 | | | | | | |
| S01-T29S-R01E | | | | | | | | |
| QTMW1 | 15172.98 | 6211.54 | 5172.98 | 3788.46 | 1304.68 | 1304.45 | 37.56209 | 97.27521 |
| QTMW2 | 15247.43 | 6155.14 | 5247.43 | 3844.89 | 1303.76 | 1303.19 | 37.56229 | 97.27541 |
| QTMW3 | 15165.01 | 6116.68 | 5165.01 | 3883.32 | 1303.01 | 1302.53 | 37.53506 | 97.27554 |
| QTMW4 | 15125.64 | 6141.18 | 5125.64 | 3853.82 | 1303.40 | 1303.15 | 37.56196 | 97.27545 |
| QTMW5 | 15129.57 | 6340.79 | 5129.57 | 3659.21 | 1306.47 | 1306.11 | 37.56197 | 97.27477 |
| QTMW6 | 15028.05 | 6121.24 | 5028.05 | 3878.76 | 1303.50 | 1303.30 | 37.56169 | 97.27552 |
| QTMW7 | 15021.61 | 6294.58 | 5021.61 | 3705.42 | 1308.08 | 1307.88 | 37.56167 | 97.27493 |
| QTMW8 | 15209.85 | 6232.99 | 5209.85 | 3767.01 | 1305.17 | 1304.83 | 37.56219 | 97.27514 |
| QTMW9 | 15130.35 | 6233.63 | 5130.35 | 3766.37 | 1305.19 | 1304.80 | 37.51697 | 97.27513 |
| QTMW10 | 15070.69 | 6201.23 | 5070.69 | 3798.77 | 1304.54 | 1304.15 | 37.56181 | 97.27525 |
| GLMW2R | 15365.63 | 6094.23 | 5365.63 | 3905.77 | | | 37.56261 | 97.27562 |
| GLMW7 | 16363.43 | 6178.20 | 5363.43 | 3821.80 | | | 37.56261 | 97.27533 |
| GLMW9 | 15255.27 | 6111.05 | 5255.27 | 3888.95 | | | 37.56231 | 97.27556 |
| GLMW13 | 15080.74 | 6123.62 | 5080.74 | 3876.38 | | | 37.56183 | 97.27551 |
| GLMW14 | 15247.24 | 6264.68 | 5247.24 | 3735.32 | | | 37.56229 | 97.27503 |
| SV/AS1 | 15219.94 | 6203.79 | 5219.94 | 3796.21 | 1304.68 | 1303.68 | 37.56221 | 97.27524 |
| AS PIPE | | | | | | 1304.15 | | |
| SV/AS2 | 15192.91 | 6203.60 | 5192.91 | 3796.04 | 1304.67 | 1303.83 | 37.56214 | 97.27524 |
| AS PIPE | | | | | | 1303.83 | | |
| SV/AS3 | 15167.08 | 6204.25 | 5167.08 | 3795.75 | 1304.66 | 1304.24 | 37.56207 | 97.27524 |
| AS PIPE | | | | | | 1304.21 | | |
| SV/AS4 | 15137.47 | 6203.98 | 5137.47 | 3796.02 | 1304.59 | 1304.09 | 37.56199 | 97.27524 |
| AS PIPE | | | | | | 1304.05 | | |
| SV/AS5 | 15099.47 | 6204.52 | 5099.47 | 3795.48 | 1304.36 | 1303.81 | 37.56188 | 97.27524 |
| AS PIPE | | | | | | 1303.68 | | |
| SV/AS6 | 15198.36 | 6133.23 | 5198.36 | 3866.77 | 1303.39 | 1302.69 | 37.56215 | 97.27548 |
| AS PIPE | | | | | | 1302.75 | | |
| SV/AS7 | 15168.20 | 6133.23 | 5168.20 | 3866.77 | 1303.40 | 1302.81 | 37.56207 | 97.27548 |
| AS PIPE | | | | | | 1302.79 | | |
| SV/AS8 | 15138.56 | 6133.55 | 5138.56 | 3866.45 | 1303.38 | 1302.87 | 37.56199 | 97.27548 |
| AS PIPE | | | | | | 1302.77 | | |
| SV/AS9 | 15108.23 | 6133.87 | 5108.23 | 3866.13 | 1303.30 | 1302.87 | 37.56191 | 97.27548 |
| AS PIPE | | | | | | 1302.81 | | |
| SV/AS10 | 15083.94 | 6134.23 | 5083.94 | 3865.77 | 1303.31 | 1302.85 | 37.56184 | 97.27548 |
| AS PIPE | | | | | | 1302.80 | | |
| SV/AS11 | 15104.95 | 6177.14 | 5104.95 | 3822.86 | 1304.05 | 1303.57 | 37.56190 | 97.27533 |
| AS PIPE | | | | | | 1303.43 | | |
| SV/AS12 | 15081.89 | 6177.26 | 5081.89 | 3822.74 | 1303.94 | 1303.38 | 37.56134 | 97.27533 |
| AS PIPE | | | | | | 1303.02 | | |
| Site B.M. | 15029.23 | 6284.78 | 5029.23 | 3715.22 | B.M. Elev. = 1304.06 | | | |

Description: " □ " Square cut on top of curb at southwest corner of parking lot

SYMBOL LEGEND

- BENCHMARK
- ⊙ MW1 MONITOR WELL
- ⊙ SV/AS# SOIL VAPOR EXTRACTION/AIR SPARGER
- ⊙ CABLE/TV PEDESTAL
- ⊙ GM GAS METER
- ⊙ POWER POLE
- ⊙ LIGHT POLE
- ⊙ ELECTRIC PEDESTAL
- ⊙ ELECTRIC PANEL
- ⊙ TELEPHONE PEDESTAL
- ⊙ SANITARY SEWER MANHOLE
- ⊙ WM WATER METER
- ⊙ WV WATER VALVE
- ⊙ FV FIRE HYDRANT
- ⊙ BUSHES
- ⊙ TREES

LINETYPE LEGEND

- UE — UNDERGROUND ELECTRIC
- TV — CABLE/TV LINE
- T — TELEPHONE LINE
- FO — FIBER OPTIC LINE
- EXIST SS — SANITARY SEWER LINE
- EXIST W — WATER LINE

SMH Consultants
By: Tim Sloan

Tim Sloan
Tim Sloan, P.S.
Vice-President

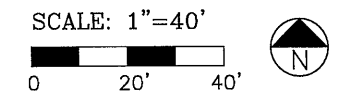
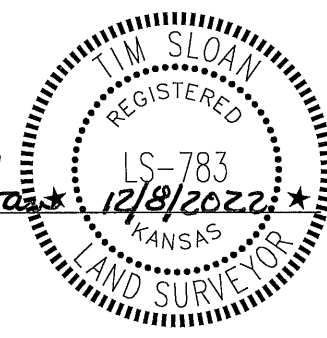

Civil Engineering • Land Surveying • Landscape Architecture
www.smhconsultants.com

Manhattan, KS - HQ P: (785) 776-0541 • Dodge City, KS P: (620) 255-1952
Kansas City, KS P: (913) 444-9615 • Colorado Springs, CO P: (719) 465-2145

Drawn By: ASJ Project #2209-0365 TDS #91