

WATER WELL RECORD (WWC-5)

KOLAR DOC ID _____ WELL ID _____
 Original Record Correction Change in Well Use

LOCATION OF WATER WELL

Latitude		Longitude		Section		Township		Range		E W	Fraction		¼		¼		¼
Datum		Elevation		County													

WATER WELL OWNER

Name	
Business	
Address	
Well location at owner's address	

WELL WATER USE

--

COMPLETION

Depth of completed well: _____ ft.
Depth(s) groundwater encountered: (1) _____ ft.; (2) _____ ft.; (3) _____ ft.; (4) dry well
Static water level in well: _____ ft. measured below land surface on (mm/dd/yy): _____ measured above land surface on (mm/dd/yy): _____
Estimated yield: _____ gpm
Water level was: _____ ft. after _____ hours pumping _____ gpm
Pump installed? Yes No
Water well disinfected? Yes No
Date disinfected (mm/dd/yy): _____
Aquifer, if known:

NEAREST SOURCE OF POTENTIAL CONTAMINATION

Source: _____
Distance from well: _____ Direction from well: _____
Source description: _____
Source: _____
Distance from well: _____ Direction from well: _____
Source description: _____
No potential source of contamination within 100 feet.

CONSTRUCTION

Borehole interval: from _____ to _____ ft.	Borehole diameter: _____ in.
from _____ to _____ ft.	_____ in.
Casing height above land surface: _____ in.	
If casing height is less than 12 in. has a variance been approved?* Yes No	
*variance not required for monitoring or environmental remediation wells	
Casing type: _____	
Blank casing interval: _____ ft. to _____ ft.	
Blank casing diameter: _____ in.	
Casing joints: _____	
Weight: _____ lbs/ft.	
Wall thickness or gauge no.: _____	
Blank casing interval: _____ ft. to _____ ft.	
Blank casing diameter: _____ in.	
Casing joints: _____	
Weight: _____ lbs/ft.	
Wall thickness or gauge no.: _____	
Grout interval: _____ ft. to _____ ft.	
Grout material: _____	
Grout interval: _____ ft. to _____ ft.	
Grout material: _____	
Screen / perforation material: _____	
Screen / perforation openings: _____	
Screen / perforation intervals: From _____ ft. to _____ ft.	
Slot size _____ unit _____	
From _____ ft. to _____ ft.	
Slot size _____ unit _____	
Gravel pack intervals: Gravel pack not used: Gravel size _____ in	
From _____ ft. to _____ ft.	
Gravel pack not used: Gravel size _____ in	
From _____ ft. to _____ ft.	

PERMIT & ID NUMBERS (AS REQUIRED)

DWR Application No.: _____
KDHE / EPA Project Code: _____
Site Name: _____
KDHE UIC Class V Form Completed: Yes No
County Permit: Yes No Permit ID: _____
Lease Name & Well #: _____
of boreholes: _____ # of dewatering wells: _____

LITHOLOGIC LOG

FROM	TO	LITHOLOGY INTERVALS

COMMENTS

--

CONTRACTOR'S OR LANDOWNERS CERTIFICATION

This water well was constructed reconstructed pursuant to the stated water well contractor's license and was completed on _____. I certify that this record is true to the best of my knowledge and belief. This water well record was completed on _____ under the business name of _____, Kansas Water Well Contractor's License No. _____ under the authority of the designated person as defined in K.A.R. 28-30-2(j) and signed and certified by the electronic signature of the designated person at its submittal: _____.

Send one copy to WATER WELL OWNER and retain one for your records. Fee of \$5.00 for each constructed well.

REMEDIAL SURVEY

EPPS SERVICE

CITY OF ELBING, BUTLER COUNTY, KANSAS

Point	North Coordinate	East Coordinate	Distance from SE Cor. North	Distance from Sec. 17 West	*Elev. Top of Rim or PK Nail	Elev. Top of PVC Pipe	Latitude North	Longitude West
SE Cor.								
Sec.17-T23S-R03W	40000	40000						
MW-2R	43435.19	37115.12	3435.19	2884.88	1440.97	1440.71	38.05296	97.12631
MW-4	43400.00	37018.07	3400.00	2981.93	1441.91	1441.63	38.05285	97.12664
MW-6	43429.67	37203.41	3429.67	2796.59	1439.49	1439.29	38.05295	97.12600
MW-16	43539.22	37145.21	3539.22	2854.79	1440.45	1439.94	38.05324	97.12621
MW-17	43563.85	37106.68	3563.85	2893.32	1440.59	1440.20	38.05331	97.12635
MW-18	43453.49	37136.36	3453.49	2863.64	1440.54	1440.09	38.05301	97.12624
MW-19	43377.34	37095.48	3377.34	2904.52	1441.48	1441.01	38.05280	97.12637
MW-20	43223.18	36792.00	3223.18	3208.00	1443.46	1443.10	38.05235	97.12741
MW-21	43458.83	36886.95	3458.83	3113.05	1441.21	1440.84	38.05301	97.12710
MW-22	43414.15	36856.70	3414.15	3143.30	1441.47	1441.05	38.05288	97.12720
AS-1	43422.14	37143.80	3422.14	2856.20	1440.06	1439.80	38.05292	97.12621
AS-2	43412.33	37153.82	3412.33	2846.18	1440.57	1440.24	38.05289	97.12617
SVE-1	43453.41	37136.41	3453.41	2863.59	1439.89	1439.59	38.05301	97.12624
SVE-2	43420.63	37136.30	3420.63	2863.70	1440.04	1439.65	38.05292	97.12623
SVE-3	43730.71	37161.49	3730.71	2838.51	1439.73	1439.39	38.05295	97.12615
SVE-4	43457.90	37149.05	3457.90	2850.95	1440.73	1440.31	38.05302	97.12619

Site B.M. 3610.00 2903.32 B.M. Elev. = 1440.66

Description: "□" Square cut on south end of pump island

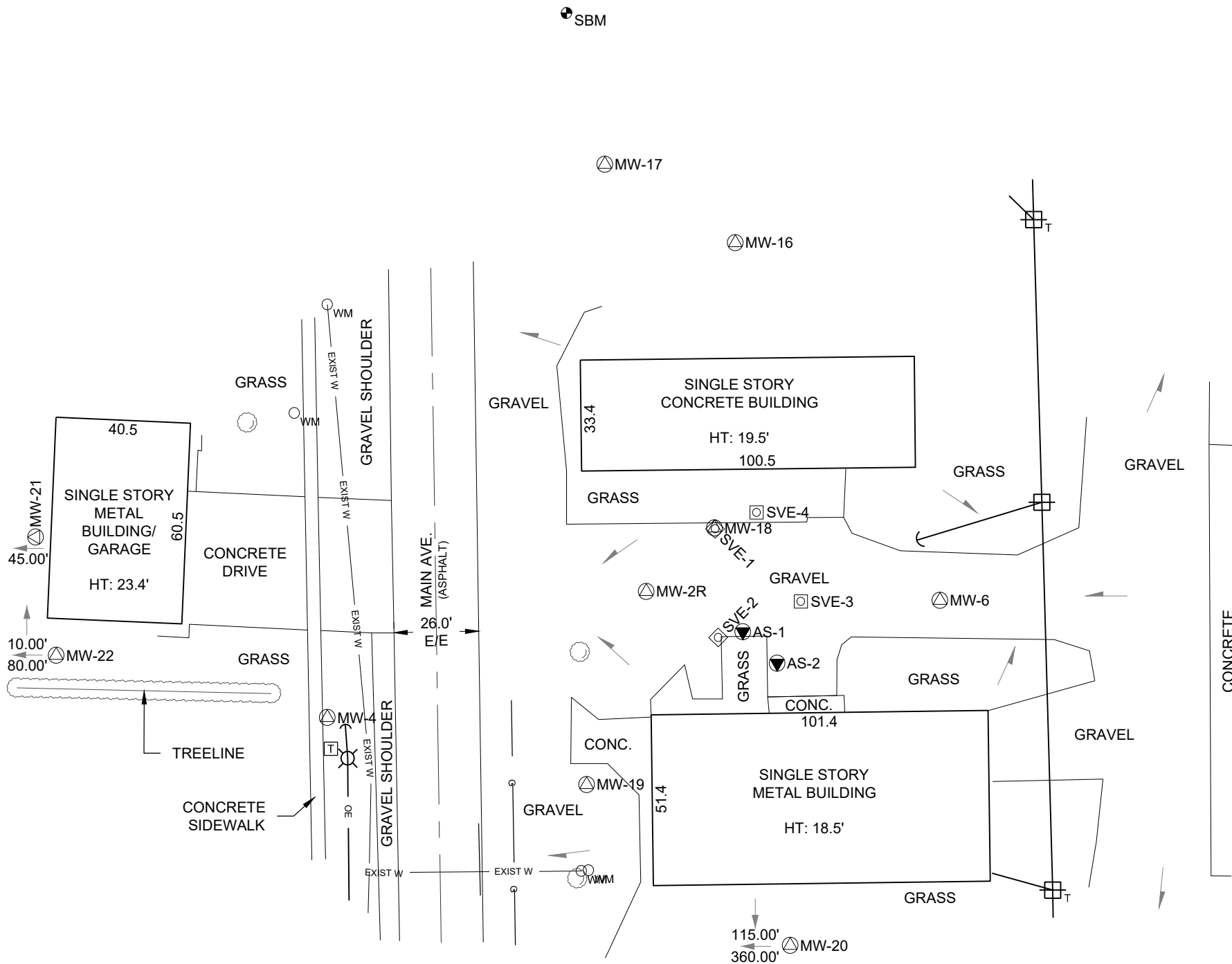

LEGEND

- ⊙ MW-1 MONITORING WELL LOCATION
- ⊙ AS-1 AIR SPARGE WELL
- ⊙ SVE-1 SOIL VAPOR EXTRACTION WELL
- EXIST W — EXIST W — WATER LINE
- OE — OE — OVERHEAD ELECTRIC
- EXIST SS — EXIST SS — SANITARY SEWER LINE
- G — G — GAS LINE
- ⊙ SITE BENCHMARK
- ➔ DRAINAGE DIRECTION
- E/E EDGE OF ROAD TO EDGE OF ROAD
- ⊞ TELEPHONE PEDESTAL
- ⊞ POWER POLE
- ⊞ POWER POL W/TRANSFORMER
- ⊙ WM WATER METER

SMH Consultants
By: Tim Sloan

Tim Sloan, P.S.
Vice-President

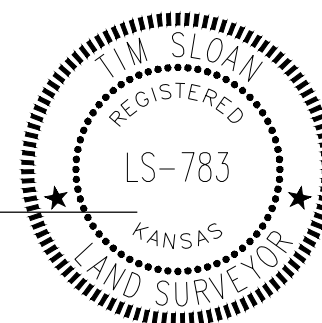

SCALE: 1"=40'

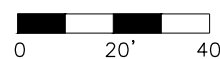

SMH CONSULTANTS

Civil Engineering • Land Surveying • Landscape Architecture
www.smhconsultants.com

Manhattan, KS - HQ P: (785) 776-0541 • Dodge City, KS P: (620) 255-1952
Kansas City P: (913) 444-9615 • Colorado Springs, CO P: (719) 428-8677

Drawn By:RJC Project # 2309-0324 TDS #94