

**WATER WELL RECORD (WWC-5)**

KOLAR DOC ID \_\_\_\_\_ WELL ID \_\_\_\_\_  
 Original Record      Correction      Change in Well Use

**LOCATION OF WATER WELL**

|          |  |           |  |         |  |          |  |       |  |        |          |   |   |   |
|----------|--|-----------|--|---------|--|----------|--|-------|--|--------|----------|---|---|---|
| Latitude |  | Longitude |  | Section |  | Township |  | Range |  | E<br>W | Fraction | ¼ | ¼ | ¼ |
| Datum    |  | Elevation |  | County  |  |          |  |       |  |        |          |   |   |   |

**WATER WELL OWNER**

|   |  |
|---|--|
| Name                                    |  |
| Business                                |  |
| Address                                 |  |
| Well location<br><br>at owner's address |  |

**WELL WATER USE**

|  |
|--|
|  |
|--|

**COMPLETION**

|   |
|---|
| Depth of completed well: _____ ft.  |
| Depth(s) groundwater encountered:<br>(1) _____ ft.; (2) _____ ft.;<br>(3) _____ ft.; (4) dry well   |
| Static water level in well: _____ ft.<br>measured below land surface<br>on (mm/dd/yy): _____<br>measured above land surface<br>on (mm/dd/yy): _____ |
| Estimated yield: _____ gpm  |
| Water level was: _____ ft. after _____ hours<br>pumping _____ gpm   |
| Pump installed?    Yes    No  |
| Water well disinfected?    Yes    No  |
| Date disinfected (mm/dd/yy): _____  |
| Aquifer, if known:  |

**NEAREST SOURCE OF POTENTIAL CONTAMINATION**

|   |
|---|
| Source: _____   |
| Distance from well: _____      Direction from well: _____ |
| Source description: _____                                 |
| Source: _____   |
| Distance from well: _____      Direction from well: _____ |
| Source description: _____                                 |
| No potential source of contamination within 100 feet.     |

**CONSTRUCTION**

|  |                                 |
|--|---------------------------------|
| Borehole interval:<br>from _____ to _____ ft.                                    | Borehole diameter:<br>_____ in. |
| from _____ to _____ ft.  | _____ in.                       |
| Casing height above land surface: _____ in.                                      |                                 |
| If casing height is less than 12 in. has a variance been approved?*    Yes    No |                                 |
| *variance not required for monitoring or environmental remediation wells         |                                 |
| Casing type: _____   |                                 |
| Blank casing interval: _____ ft. to _____ ft.                                    |                                 |
| Blank casing diameter: _____ in.   |                                 |
| Casing joints: _____   |                                 |
| Weight: _____ lbs/ft.  |                                 |
| Wall thickness or gauge no.: _____   |                                 |
| Blank casing interval: _____ ft. to _____ ft.                                    |                                 |
| Blank casing diameter: _____ in.   |                                 |
| Casing joints: _____   |                                 |
| Weight: _____ lbs/ft.  |                                 |
| Wall thickness or gauge no.: _____   |                                 |
| Grout interval: _____ ft. to _____ ft.   |                                 |
| Grout material: _____  |                                 |
| Grout interval: _____ ft. to _____ ft.   |                                 |
| Grout material: _____  |                                 |
| Screen / perforation material: _____   |                                 |
| Screen / perforation openings: _____   |                                 |
| Screen / perforation intervals:<br>From _____ ft. to _____ ft.                   |                                 |
| Slot size _____ unit _____   |                                 |
| From _____ ft. to _____ ft.  |                                 |
| Slot size _____ unit _____   |                                 |
| Gravel pack intervals:<br>Gravel pack not used:    Gravel size _____ in          |                                 |
| From _____ ft. to _____ ft.  |                                 |
| Gravel pack not used:    Gravel size _____ in                                    |                                 |
| From _____ ft. to _____ ft.  |                                 |

**PERMIT & ID NUMBERS (AS REQUIRED)**

|   |
|---|
| DWR Application No.: _____                            |
| KDHE / EPA Project Code: _____                        |
| Site Name: _____                                      |
| KDHE UIC Class V Form Completed:    Yes    No         |
| County Permit:    Yes    No    Permit ID: _____       |
| Lease Name & Well #: _____                            |
| # of boreholes: _____    # of dewatering wells: _____ |

**LITHOLOGIC LOG**

| FROM | TO | LITHOLOGY INTERVALS |
|------|----|---------------------|
|      |    |                     |
|      |    |                     |
|      |    |                     |
|      |    |                     |
|      |    |                     |
|      |    |                     |
|      |    |                     |
|      |    |                     |
|      |    |                     |
|      |    |                     |

**COMMENTS**

|  |
|--|
|  |
|--|

**CONTRACTOR'S OR LANDOWNERS CERTIFICATION**

|   |
|---|
| This water well was    constructed    reconstructed    pursuant to the stated water well contractor's license and was completed on _____. I certify that this record is true to the best of my knowledge and belief. This water well record was completed on _____ under the business name of _____, Kansas Water Well Contractor's License No. _____ under the authority of the designated person as defined in K.A.R. 28-30-2(j) and signed and certified by the electronic signature of the designated person at its submittal: _____. |
|---|

Send one copy to WATER WELL OWNER and retain one for your records. Fee of \$5.00 for each constructed well.

# REMEDIAL SITE SURVEY

FORMER COLORADO OIL & GAS  
COFFEYVILLE, KANSAS

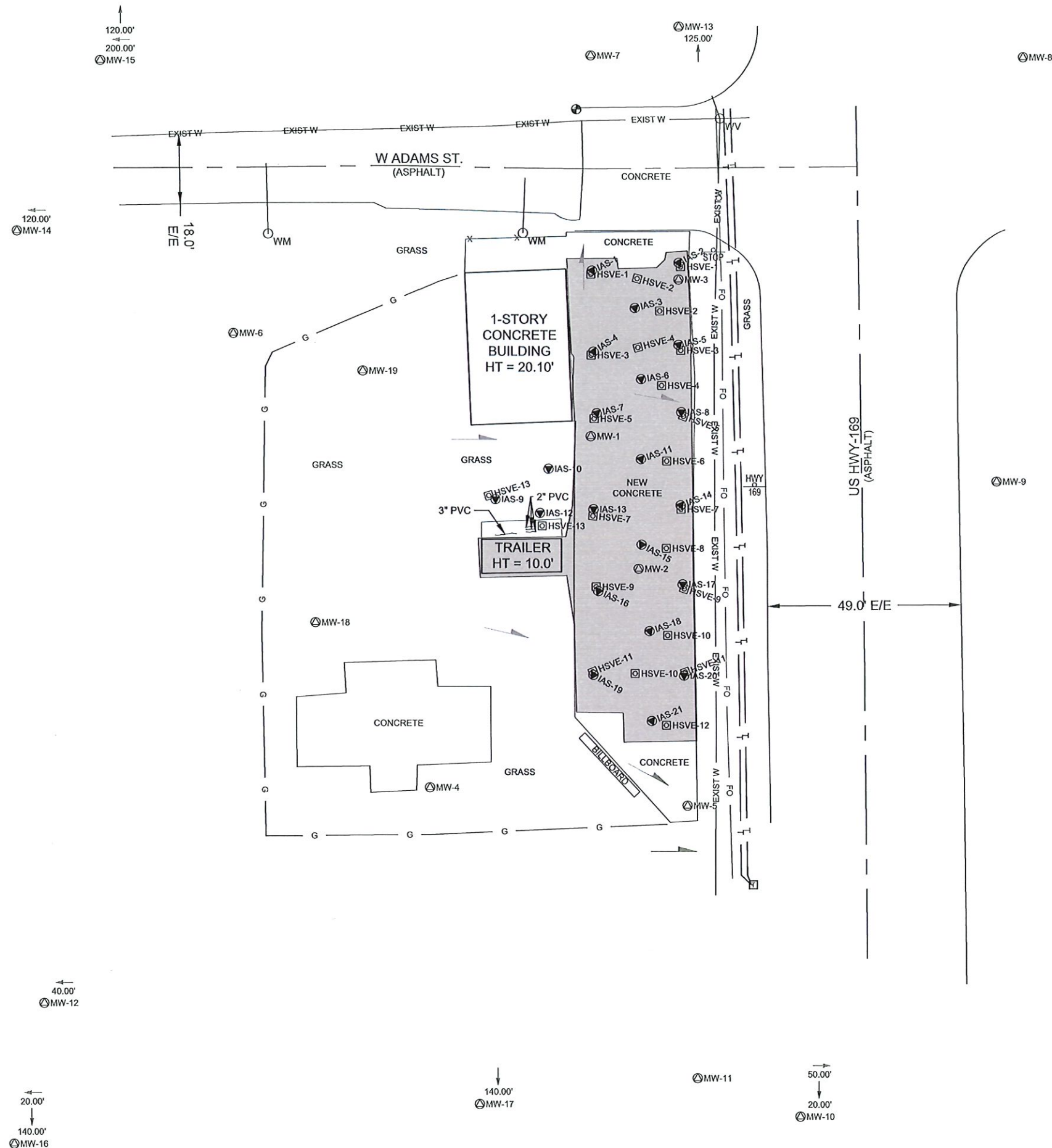

## LEGEND

- |         |                  |          |                                  |
|---------|------------------|----------|----------------------------------|
| FO      | FIBER OPTIC      | ⊕        | SITE BENCHMARK                   |
| T       | TELEPHONE LINE   | ↗        | DRAINAGE DIRECTION               |
| EXIST W | WATERLINE        | ⊙ MW-1   | MONITORING WELL                  |
| G       | GAS LINE         | ⊙ IAS-1  | INJECTION AIR SPARGE             |
| X-X     | CHAIN LINK FENCE | ⊙ HSVE-1 | HORIZONTAL SOIL VAPOR EXTRACTION |
| T       | TELEPHONE VAULT  | ⊙ WM     | WATER METER                      |
| ⊖       | STREET SIGN      | ⊙ WW     | WATER GATE VALVE                 |

SMH Consultants  
By: Tim Sloan

*Tim Sloan*  
Tim Sloan, P.S.  
Vice-President

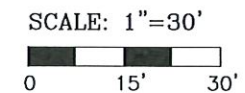
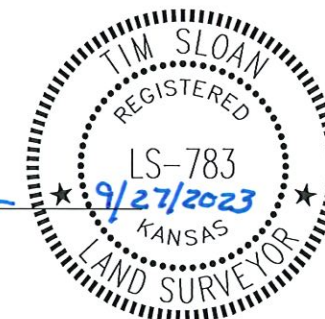

# SMH CONSULTANTS

Civil Engineering • Land Surveying • Landscape Architecture  
www.smhconsultants.com

Manhattan, KS - HQ P: (785) 776-0541 • Dodge City, KS P: (620) 255-1952  
Kansas City P: (913) 444-9615 • Colorado Springs, CO P: (719) 428-8677

Drawn By:RJC Project #2308-0287 TDS #94