

**WATER WELL RECORD (WWC-5)**

KOLAR DOC ID \_\_\_\_\_ WELL ID \_\_\_\_\_  
 Original Record      Correction      Change in Well Use

**LOCATION OF WATER WELL**

Latitude		Longitude		Section		Township		Range		E W	Fraction	¼	¼	¼
Datum		Elevation		County										

**WATER WELL OWNER**

Name	
Business	
Address	
Well location at owner's address	

**WELL WATER USE**

\_\_\_\_\_

**COMPLETION**

Depth of completed well: \_\_\_\_\_ ft.  
 Depth(s) groundwater encountered:  
 (1) \_\_\_\_\_ ft.; (2) \_\_\_\_\_ ft.;  
 (3) \_\_\_\_\_ ft.; (4) dry well

Static water level in well: \_\_\_\_\_ ft.  
 measured below land surface on (mm/dd/yy): \_\_\_\_\_  
 measured above land surface on (mm/dd/yy): \_\_\_\_\_

Estimated yield: \_\_\_\_\_ gpm  
 Water level was: \_\_\_\_\_ ft. after \_\_\_\_\_ hours  
 pumping \_\_\_\_\_ gpm  
 Pump installed?    Yes    No

Water well disinfected?    Yes    No  
 Date disinfected (mm/dd/yy): \_\_\_\_\_

Aquifer, if known: \_\_\_\_\_

**NEAREST SOURCE OF POTENTIAL CONTAMINATION**

Source: \_\_\_\_\_  
 Distance from well: \_\_\_\_\_      Direction from well: \_\_\_\_\_  
 Source description: \_\_\_\_\_

Source: \_\_\_\_\_  
 Distance from well: \_\_\_\_\_      Direction from well: \_\_\_\_\_  
 Source description: \_\_\_\_\_

No potential source of contamination within 100 feet.

**CONSTRUCTION**

Borehole interval: from _____ to _____ ft.	Borehole diameter: _____ in.
from _____ to _____ ft.	_____ in.
Casing height above land surface: _____ in. If casing height is less than 12 in. has a variance been approved?*    Yes    No *variance not required for monitoring or environmental remediation wells	
Casing type: _____	
Blank casing interval: _____ ft. to _____ ft.	
Blank casing diameter: _____ in.	
Casing joints: _____	
Weight: _____ lbs/ft.	
Wall thickness or gauge no.: _____	
Blank casing interval: _____ ft. to _____ ft.	
Blank casing diameter: _____ in.	
Casing joints: _____	
Weight: _____ lbs/ft.	
Wall thickness or gauge no.: _____	
Grout interval: _____ ft. to _____ ft.	
Grout material: _____	
Grout interval: _____ ft. to _____ ft.	
Grout material: _____	
Screen / perforation material: _____	
Screen / perforation openings: _____	
Screen / perforation intervals: From _____ ft. to _____ ft. Slot size _____ unit _____	
From _____ ft. to _____ ft. Slot size _____ unit _____	
Gravel pack intervals: Gravel pack not used:    Gravel size _____ in. From _____ ft. to _____ ft.	
Gravel pack not used:    Gravel size _____ in. From _____ ft. to _____ ft.	

**PERMIT & ID NUMBERS (AS REQUIRED)**

DWR Application No.: \_\_\_\_\_  
 KDHE / EPA Project Code: \_\_\_\_\_  
 Site Name: \_\_\_\_\_  
 KDHE UIC Class V Form Completed:    Yes    No  
 County Permit:    Yes    No    Permit ID: \_\_\_\_\_  
 Lease Name & Well #: \_\_\_\_\_  
 # of boreholes: \_\_\_\_\_    # of dewatering wells: \_\_\_\_\_

**LITHOLOGIC LOG**

FROM	TO	LITHOLOGY INTERVALS

**COMMENTS**

\_\_\_\_\_

**CONTRACTOR'S OR LANDOWNERS CERTIFICATION**

This water well was    constructed    reconstructed    pursuant to the stated water well contractor's license and was completed on \_\_\_\_\_. I certify that this record is true to the best of my knowledge and belief. This water well record was completed on \_\_\_\_\_ under the business name of \_\_\_\_\_, Kansas Water Well Contractor's License No. \_\_\_\_\_ under the authority of the designated person as defined in K.A.R. 28-30-2(j) and signed and certified by the electronic signature of the designated person at its submittal: \_\_\_\_\_.

Send one copy to WATER WELL OWNER and retain one for your records. Fee of \$5.00 for each constructed well.

# REMEDIAL SITE SURVEY

FORMER COLORADO OIL & GAS  
COFFEYVILLE, KANSAS

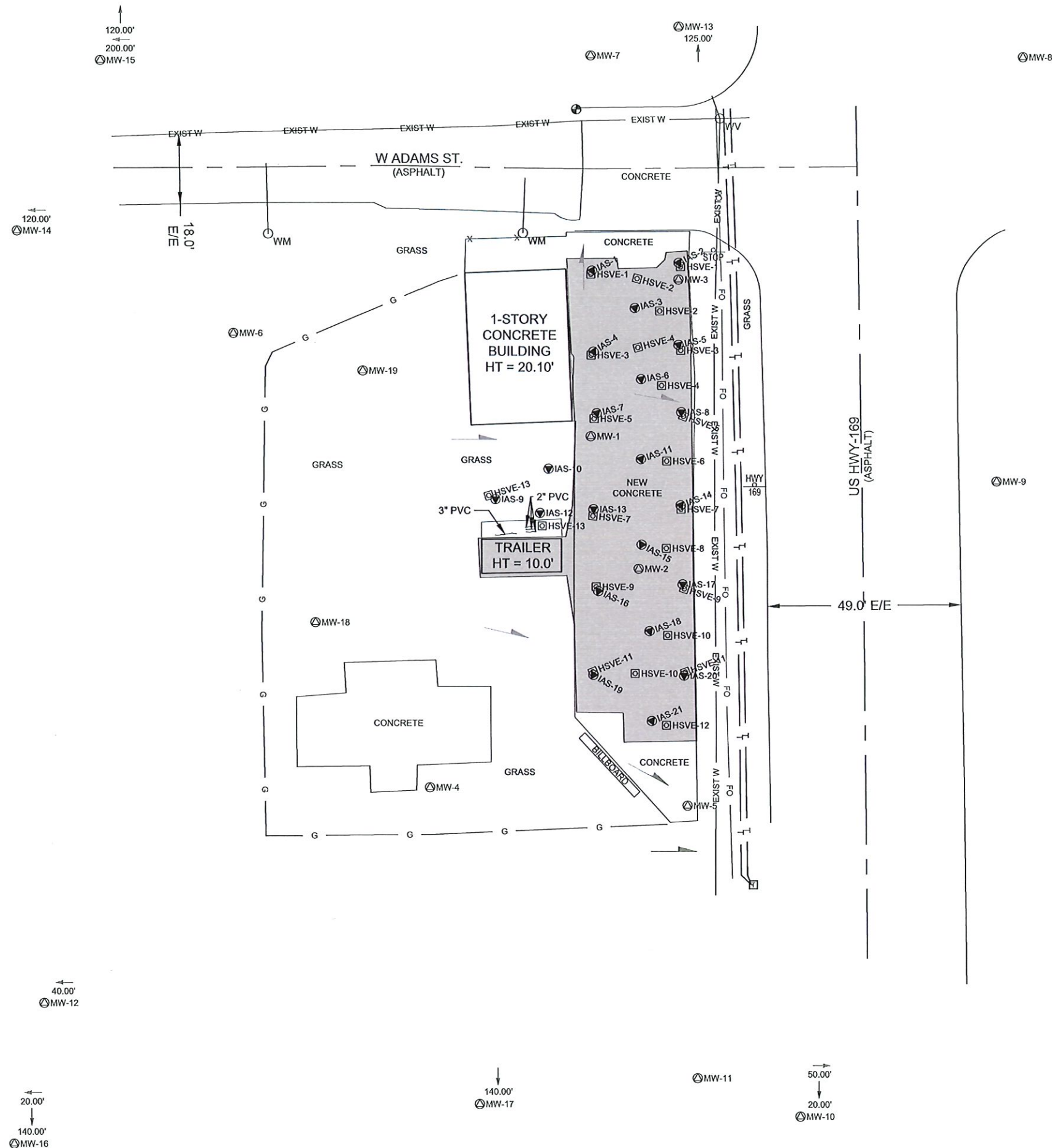

## LEGEND

- |         |                  |          |                                  |
|---------|------------------|----------|----------------------------------|
| FO      | FIBER OPTIC      | ⊕        | SITE BENCHMARK                   |
| T       | TELEPHONE LINE   | ↗        | DRAINAGE DIRECTION               |
| EXIST W | WATERLINE        | ⊙ MW-1   | MONITORING WELL                  |
| G       | GAS LINE         | ⊙ IAS-1  | INJECTION AIR SPARGE             |
| X-X     | CHAIN LINK FENCE | ⊙ HSVE-1 | HORIZONTAL SOIL VAPOR EXTRACTION |
| T       | TELEPHONE VAULT  | ⊙ WM     | WATER METER                      |
| ⊖       | STREET SIGN      | ⊙ WW     | WATER GATE VALVE                 |

SMH Consultants  
By: Tim Sloan

*Tim Sloan*  
Tim Sloan, P.S.  
Vice-President

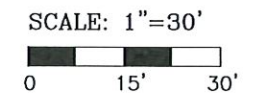
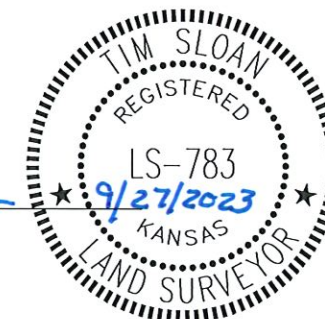

# SMH CONSULTANTS

Civil Engineering • Land Surveying • Landscape Architecture  
www.smhconsultants.com

Manhattan, KS - HQ P: (785) 776-0541 • Dodge City, KS P: (620) 255-1952  
Kansas City P: (913) 444-9615 • Colorado Springs, CO P: (719) 428-8677

Drawn By:RJC Project #2308-0287 TDS #94