



10022

Form 1014S
Application for Land Application
OAC 165: 5-3-1(b)(1)(M)-(N); OAC 165:10-1-7(b)(49)

OCC PERMIT No. 23-39365

PAYMENT REQUIRED

\$150.00 Non-Expedited; \$250.00 Expedited

Operator BCE-MACH III LLC			OCC No. 24485		
Address 14201 WIRELESS WAY STE 300			Phone No. 405-252-8100		
City OKLAHOMA CITY	State OK	Zip 73134-2521	Fax No.		
Well Name/No. ACHENBACH 14/11-35-12 1H <small>(List multiple wells below)</small>			API No.		
Location within Sec. 188' FSL - 1320' FWL	Sec. 14	Twp. 35S	Rge. 12W	County BARBER KS	

Land Application Area

OBM	WBM	Sec.	Twp.	Rge.	Location within Sec.	County
<input type="checkbox"/>	<input checked="" type="checkbox"/>	32	29N	14W	31 ACRES IN NW/4	WOODS
<input type="checkbox"/>	<input type="checkbox"/>					
<input type="checkbox"/>	<input type="checkbox"/>					
<input type="checkbox"/>	<input type="checkbox"/>					

The following facts are submitted:

Note: If the answer to A or B is "Yes", please attach written explanation

- A. Has land application area ever been used for this type of practice? YES NO
- B. Has pit received any materials except natural precipitation since sampling? YES NO
- C. Is this application for a closed system? If yes, answer C, D, and skip to H. YES NO
- D. Was the Field Inspector contacted to witness sampling? YES NO
- E. Dimensions of pit: Length _____ Width _____ Depth _____
- F. Total volume of liquids to be land applied: _____ bbls.
- G. Total volume of solids to be land applied: _____ bbls. or _____ cu. ft.
- H. Method of application: Spray irrigation gun Injection Tank truck with diffuser Other _____
- I. Number of acres in proposed application area: 31 Potential application area: 31

Attachments

- Copy of written permission from surface owner
- Map or diagram, drawn to scale, showing proposed and potential and application areas
- Site suitability
- Analysis of materials to be land applied (exempt for closed systems)
- Analysis of soil
- Investigation report and diagram (for containment soils only)
- Loading calculations (exempt for closed system)
- Manufacturer, model number, and specifications of testing equipment (for closed systems only)
- Other _____

To add attachments to this form, first download the form, then open the document "form 1014s attachments.docx" listed on the left side of the form, seen by clicking on the paperclip icon. This will only be visible form downloaded versions of the form. Attempting to fill out the form in a browser will result in incomplete functionality of the form.

Executed this 19TH day of DECEMBER, 2023

State of OKLAHOMA)

County of GRADY)

Signature of Affiant

Before me, the undersigned authority, on this day personally appeared ROBERT FOSTER known to me to be the person whose name is subscribed to the above instrument, who being by me duly sworn on oath, states that he is duly authorized to make the above report and that he has knowledge of the facts stated therein, and that said report is true and correct.

Subscribed and sworn to before me this 19TH day of DECEMBER, 2023

My commission expires: 1/13/2026

Notary Public

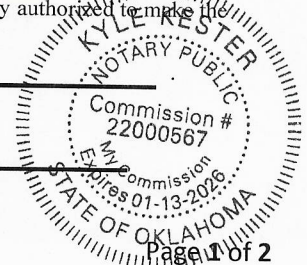

LIST MULTIPLE WELLS BELOW:

WELL NAME/API NUMBER	

Please be reminded that certain conditions or stipulations in OAC 165:10-7-19, 10-7-25, and 10-7-26 must be adhered to. Below are only some of them; please refer to the respective rules for others.

- A. The applicant shall notify the appropriate Field Inspector at least 24 hours prior to the commencement of land application to allow a Commission representative an opportunity to be present.
- B. A representative of the applicant shall be on the land application site at all times during which materials are being applied.
- C. Weather Restrictions:
Land applications, including incorporation, shall not be done:
 - 1. During precipitation events or when precipitation is imminent;
 - 2. When the soil moisture content is at a level such that the soil cannot readily take the addition of materials;
 - 3. When the ground is frozen; or
 - 4. By spray irrigation when the wind velocity is such that even distribution of materials cannot be accomplished or the buffer zones below cannot be maintained (drilling fluids only).

D. Buffer Zones:

Land application shall not be done within the following buffer zones:

- 1. 50 feet of a property line boundary;
- 2. 300 feet of any actively-producing water well used for domestic or irrigation purposes; and
- 3. One-quarter mile of any actively-producing water well used for municipal purposes.
- 4. Runoff or Ponding Prohibited:
No runoff or ponding of land applied materials shall be allowed during application.
- 5. Time Period:

Land application shall be completed within 90 days from the date of the permit. At the end of the 90-day period, the permit shall expire by its own terms.

To renew the permit, the applicant shall resample the fluids and/or cuttings to be land applied, submit a new analysis, and receive a notification of renewal from a Field Operations office.

Permit No.	23-39365
LA	

FOR OCC USE ONLY			
Maximum application rate	bbls/ac	Minimum acreage required	
Additional requirements			
This application for land application has been: <input type="checkbox"/> APPROVED <input type="checkbox"/> DISAPPROVED			
Expiration Date:	CLOSED	<i>Bell Krivanek</i>	12.20.23
		OCC Representative	Date

The reason for disapproval is:

- Application incomplete _____
- Laboratory analysis incomplete _____
- Size of potential land application area too small _____
- Other _____

Spreading Company AG & OIL FIELD LLC

Email/Fax KKESTER@AGANDOIL.COM

Phone 405-888-7670



COMPLIANCE AGREEMENT / ONE-TIME LAND APPLICATION

OAC 165:10-7-19(h)(2) and 165:10-7-26(h)(2)

I, AG&Oil Field LLC/Robert Foster, hereby acknowledge that, as

contractor agent employee

acting on behalf of BCE-Mach III LLC (OPERATOR),

I will be responsible for supervising land application at the site identified by legal description on the attached application. Furthermore, I certify that I have read and am familiar with Corporation Commission Rule(s)

OAC 165:10-7-19 OAC 165:10-7-26

and agree to comply with all provisions of the Rule before, during and after the land application.

Telephone Number 405-888-7670

Executed this 19th of December, 2023



Signature of Contractor, Agent, or Employee

State of Oklahoma)
County of Grady)

ss

Before me, the undersigned authority, on this day personally appeared Robert Foster known to me to be the person whose name is subscribed to the above instrument, who being by me duly sworn on oath, states that he is duly authorized to make the above report and that he has knowledge of the facts stated herein and that said report is true and correct.

Subscribed and sworn to before me this 19th day of December, 2023

My Commission expires: 1/13/2026 Commission Number: 22000567

12/19/23

Notary Public

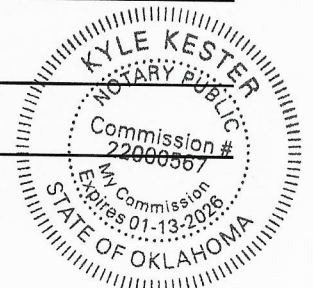



Surface Owner Permission For Land Application
OAC 165:10-7-19(f)(2)(A) and 165:10-7-26(g)(2)(A)

I, Heslie Rhodes, (SURFACE OWNER) hereby give permission to BCE-Moosh III / Ag's Oil Field, (OPERATOR) or his contractor or agent to land apply:

- Water based drilling fluids and/or cuttings
Initial HR
- Petroleum hydrocarbon-based drill cuttings
Initial _____
- Soils contaminated by salt or crude oil
Initial _____

under the regulations of the Oklahoma Corporation Commission to 320 of 320 acres of property of which I have legal ownership.

This property is described as follows:

1/4	1/4	1/4	Section	Township	Range	County
		<u>W1/2</u>	<u>32</u>	<u>29N</u>	<u>14W</u>	<u>Wagon</u>

Furthermore, if the drill cuttings, oil base drilling mud or crude oil contaminated soil are spread on the land the material shall be incorporated into the soil by disking, chiseling or another method and fertilizer applied.

Heslie E. Rhodes
Signature _____ Date 12/18/23

Telephone Number 580/327/7331

Note: In the event a problem or concern develops as a result of this land application, please contact the OCC Manager of Field Operations at (405) 521-2240. Retain a copy for your records.

DISTRICT I 115 West 6th Street Bristow, OK 74010 (918) 367-3396 OGBristowOffice@occ.ok.gov	DISTRICT II 101 South 6th Street Kingfisher, OK 73750 (405) 375-5570 OGBKingfisherOffice@occ.ok.gov	DISTRICT III 1111 W. Willow, Suite 100 Duncan, OK 73533 (580) 255-0103 OGBDuncanOffice@occ.ok.gov	DISTRICT IV 1318 Craddock Rd. Ada, Oklahoma 74820 (580) 332-3441 OGBAdaOffice@occ.ok.gov
---	--	--	--

Kyle Kester
3241 California Ave
Chickasha, OK 73018

December 18, 2023

Enclosed is the site suitability report for a proposed land application site in the below referenced location in the state of Oklahoma. Also, find a copy of an aerial photograph and a topographical map with boundaries marked

Site Inspection: December 19, 2023
County: Woods County
Location: NW/4 Sec 32-29N-14W
Company: BCE-Mach III LLC
Lease Name: Achenbach 14/11-35-12 1H
Field Type: 31 acres pasture

This report includes the results of my investigation of the proposed location. Map units meeting the criteria for land application are identified in this report.

Burford Silt Loam, 3-5% Slope
Devol Fine Sandy Loam, 1-3% Slope

These map units qualify for land application. Qualifying areas are shown on the maps. Qualifying areas are outlined on the accompanying maps. The qualifying areas have thickness, depth, and texture that meet the criteria for land application and only those areas with the slope less than 8% will be used.

If any further assistance is needed, please call (405) 888-7670

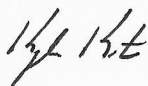

Kyle Kester
Soil Specialist

SOIL RATING GUIDE FOR LAND APPLICATION OF DRILLING FLUIDS IN OKLAHOMA

Lease Name: Achenbach 14/11-35-12 1H
County: Woods County
Legal Description: NW/4 Sec 32-29N-14W

Soil Map Units: Burford Silt Loam, 3-5% Slope
Devol Fine Sandy Loam, 1-3% Slope

Devol Fine Sandy Loam

Maximum Slope: 5%
Minimum Depth to Bedrock: More Than 80 inches
Texture of Surface Soil: Fine Sandy Loam
Texture of Subsoil: Fine Sandy Loam
Salinity: None to Slight
Depth to Water Table: More Than 6 feet
Distance to Nearest Water Body: More Than 100 feet
Distance to Nearest Intermittent Stream: More Than 50 feet
Dominant Soil Type: Devol Fine Sandy Loam

Soil Profile: Surface: 0-8 inches, Fine Sandy Loam
Subsoil: 8-51 inches, Fine Sandy Loam

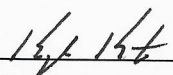

Kyle Kester
Soil Specialist

December 19, 2023

Soil Map—Woods County, Oklahoma
(BCE-Mach III Achenbach 14/11-35-12 1H NW/4 Sec 32-29N-14W)



Soil Map may not be valid at this scale.

Map Scale: 1:12,300 if printed on A portrait (8.5" x 11") sheet.

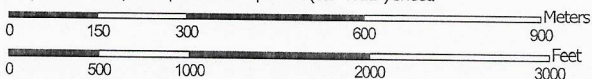

Map projection: Web Mercator Corner coordinates: WGS84 Edge tics: UTM Zone 14N WGS84



Natural Resources
Conservation Service

Web Soil Survey
National Cooperative Soil Survey

12/19/2023
Page 1 of 4

Soil Map—Woods County, Oklahoma
(BCE-Mach III Achenbach 14/11-35-12 1H NW/4 Sec 32-29N-14W)

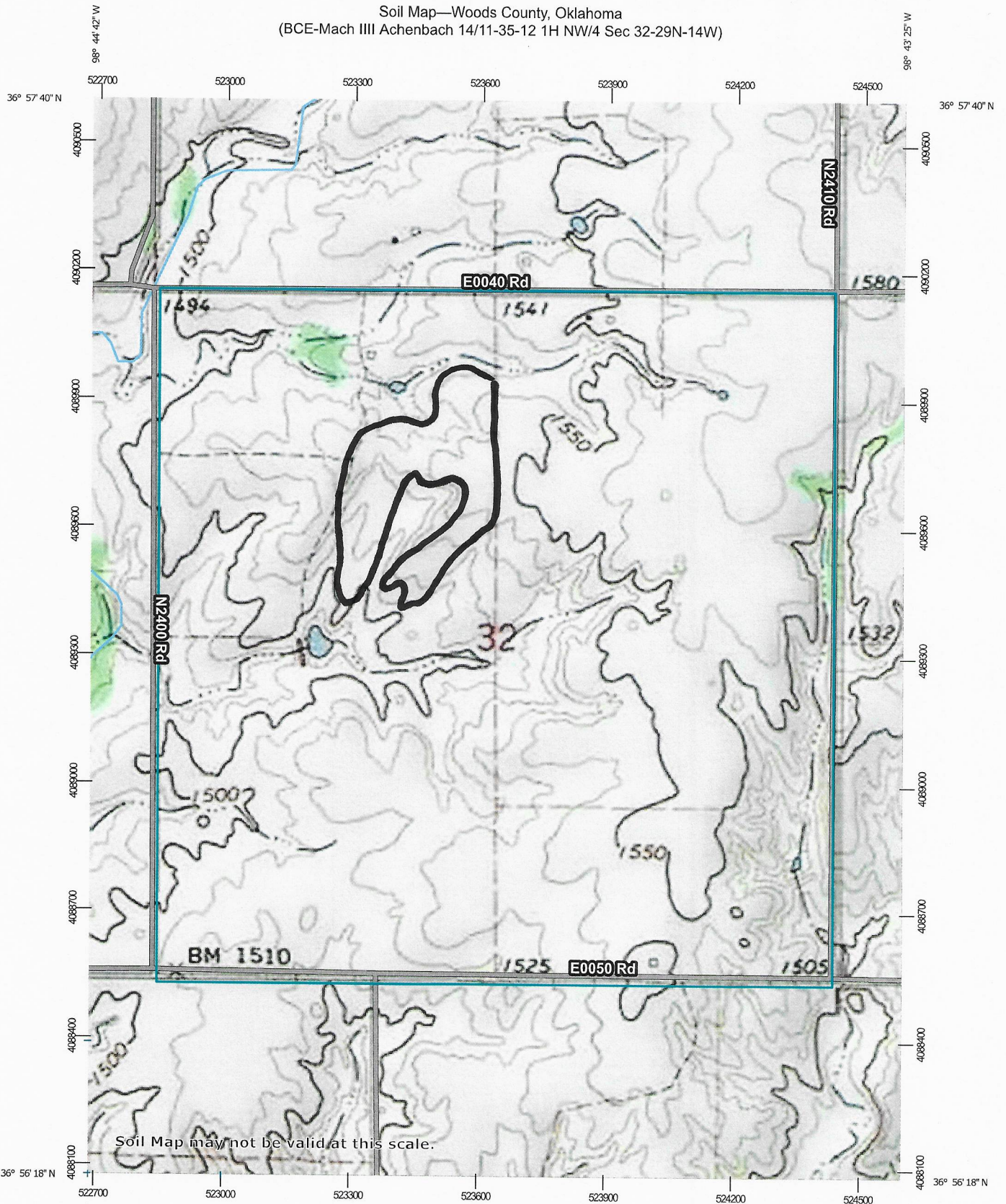

Map Scale: 1:12,300 if printed on A portrait (8.5" x 11") sheet.

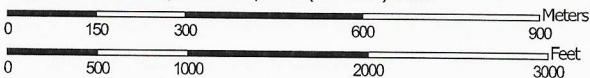

Map projection: Web Mercator Corner coordinates: WGS84 Edge tics: UTM Zone 14N WGS84



Natural Resources
Conservation Service

Web Soil Survey
National Cooperative Soil Survey

12/19/2023
Page 1 of 4

Total Dissolved Solids

EC of Receiving Soil **413** x 0.64 = 264.32 ppm TDS in Receiving Soil

TDS in Receiving Soil 264.32 ppm x 2 = 528.64 lbs/acre TDS in Receiving Soil.

6,000 lbs/acre TDS - 528.64 lbs/ac TDS in Receiving Soil = 5471 Maximum TDS (lbs/ac) to be applied

EC of Materials to be applied **5000** micromhos/cm x 0.64 = 3200 ppm TDS

Maximum TDS to be applied 5471.36 divided by 0.005 1094272 equals Max. weight of materials to be applied

FOR LIQUID MATERIALS

Max weight of materials to be applied 1094272 lbs/ ac / (samples weight **10.4** lbs/gal x 42) = 2505 Maximum loading bbls/ac

Total Volume of materials to be applied **15,000** bbls / Maximum loading 2505 bbls/ac = Minimum Ares Required **5.99**

FOR SOLID MATERIALS

Max weight of materials to be applied 1094272 lbs/ac / (samples weight **11** lbs/gal x 202) = 492 Max loading cubic yards/acre.

Total volume of materials to be applied **3,500** bbls = 19651 cubic feet 728 cubic yards

Volume of materials to be applied 728 cubic yards / max loading 492 cu yds/ac = Minimum Ares Required **1.48**

Change values in YELLOW and SILVER cells ONLY!



1227 Main St. Lamont, Oklahoma 74643

580-382-1800 | Enviroaglabs.com | info@enviroaglabs.com

Soil Analysis Results

Method		1:1 Soil to Water Extraction											Calculated	
Field	Sample ID	Sample Depth	EC us/cm	TDS ppm	pH units	Na ppm	Ca ppm	Mg ppm	K ppm	Cl- ppm	SO4- ppm	B ppm	SAR unit	ESP %
Achenbach 14 11-35-12 1H	1	0-6 in.	413	273		2.7	35.1	3.7					0.1	-1.10
Achenbach 14 11-35-12 1H	2	0-6 in.	243	160										
Achenbach 14 11-35-12 1H	3	0-6 in.	94	62										
Achenbach 14 11-35-12 1H	4	0-6 in.	103	68										

Customer Information		
Customer:	Ag & Oil Soil Farming	
Address:	4584 S. Hwy 81, Rush Springs, OK 73082	
Email:	kkester@agandoil.com	Phone # 405-320-2300

Sample Information		
Client:	BCE-Mach III LLC	Date Received: 12/19/2023
Invoice #:	23. 3112-3115	Date Complete: 12/20/2023

MS

Ag & Oilfield LLC
4584 S. Hwy 81
Rush Springs, OK 73082
(405)-320-2300
kkester@agandoil.com



NORMAL TURNAROUND 24 HOUR STAT

COMPANY NAME		RECEIVING SITE LEGALS		STATION LOCATION		ANALYSIS REQUESTED		LOG NO:		
WELL NAME AND LEGALS		RECEIVING SITE LEGALS		STATION LOCATION		ANALYSIS REQUESTED		SAMPLE TYPE		
WELL NAME AND LEGALS		RECEIVING SITE LEGALS		STATION LOCATION		ANALYSIS REQUESTED		SAMPLE TYPE		
NUMBER	DATE	TIME	STATION LOCATION	ESP on the highest EC	COND OF SAMPLE	REMARKS	COND OF SAMPLE	REMARKS		
1	12/18/23	15:45	SW NE NW	0-6"	X	X	X	X	SOIL	
2			SE NE NW	0-6"	X	X	X	X	SOIL	
3			NW SE NW	0-6"	X	X	X	X	SOIL	
4			NE SE NW	0-6"	X	X	X	X	SOIL	
				0-6"	X	X	X	X	SOIL	
				0-6"	X	X	X	X	SOIL	
				0-6"	X	X	X	X	SOIL	
				0-6"	X	X	X	X	SOIL	
				0-6"	X	X	X	X	SOIL	
				0-6"	X	X	X	X	SOIL	
				0-6"	X	X	X	X	SOIL	
				0-6"	X	X	X	X	SOIL	
				0-6"	X	X	X	X	SOIL	
SAMPLER: (SIGNATURE) <i>12/18/23</i>				REPORT TO:		TOTAL NUMBER OF CONTAINERS:		INVOICE TO:		
RELINQUISHED BY: <i>MATHEN BRUSH</i>		DATE: <i>12-08</i>	TIME: <i>17:00</i>	RECEIVED FOR LAB BY:		DATE:	TIME:	DATE:	TIME:	
METHOD OF SHIPMENT: <i>12/19/23</i>				SHIPPED BY:		COURIER: (SIGNATURE)		RECEIVED BY:		
DISPOSED OF OR STORED BY:		DATE:	TIME:	METHOD:		RECEIVED BY:		RECEIVED BY:		

BCE - Mach III
Achenbach 14/11-35-12w
Sec 14-355-12w
Barber County KS
NW/4 Sec 32-29 N-12w
Woods County