

KANSAS CORPORATION COMMISSION
OIL & GAS CONSERVATION DIVISION

Form ACO-4
Form must be typed
March 2009

APPLICATION FOR COMMINGLING OF PRODUCTION (K.A.R. 82-3-123) OR FLUIDS (K.A.R. 82-3-123a) *Commingling ID #* _____

OPERATOR: License # _____ API No. 15 - _____
Name: _____ Spot Description: _____
Address 1: _____ - - - - - Sec. _____ Twp. _____ S. R. _____ East West
Address 2: _____ Feet from North / South Line of Section
City: _____ State: _____ Zip: _____ + _____ Feet from East / West Line of Section
Contact Person: _____ County: _____
Phone: (_____) _____ Lease Name: _____ Well #: _____

1. Name and upper and lower limit of each production interval to be commingled:
Formation: _____ (Perfs): _____
Formation: _____ (Perfs): _____
Formation: _____ (Perfs): _____
Formation: _____ (Perfs): _____
Formation: _____ (Perfs): _____

2. Estimated amount of fluid production to be commingled from each interval:
Formation: _____ BOPD: _____ MCFPD: _____ BWPD: _____
Formation: _____ BOPD: _____ MCFPD: _____ BWPD: _____
Formation: _____ BOPD: _____ MCFPD: _____ BWPD: _____
Formation: _____ BOPD: _____ MCFPD: _____ BWPD: _____
Formation: _____ BOPD: _____ MCFPD: _____ BWPD: _____

3. Plat map showing the location of the subject well, all other wells on the subject lease, and all wells on offsetting leases within a 1/2 mile radius of the subject well, and for each well the names and addresses of the lessee of record or operator.

4. Signed certificate showing service of the application and affidavit of publication as required in K.A.R. 82-3-135a.

For Commingling of PRODUCTION ONLY, include the following:

- 5. Wireline log of subject well. Previously Filed with ACO-1: Yes No
- 6. Complete Form ACO-1 (*Well Completion form*) for the subject well.

For Commingling of FLUIDS ONLY, include the following:

- 7. Well construction diagram of subject well.
- 8. Any available water chemistry data demonstrating the compatibility of the fluids to be commingled.

AFFIDAVIT: I am the affiant and hereby certify that to the best of my current information, knowledge and personal belief, this request for commingling is true and proper and I have no information or knowledge, which is inconsistent with the information supplied in this application.

Submitted Electronically

KCC Office Use Only
 Denied Approved
15-Day Periods Ends: _____
Approved By: _____ Date: _____

Protests may be filed by any party having a valid interest in the application. Protests must be in writing and comply with K.A.R. 82-3-135b and must be filed within 15 days of publication of the notice of application.



DownHole SAT®
FORMATION WATER CHEMISTRY INPUT

Mull Drilling
Carter Johnson 1-1
Wellhead

Pro-Stim Chemicals
Lindi Dwyer

Report Date: 10-04-2023 Sampled: 09-25-2023 at 1644
Sample #: 17404 Sample ID: WBaten

CATIONS

Calcium (as Ca)	1733
Magnesium (as Mg)	437.00
Barium (as Ba)	3.00
Strontium (as Sr)	0.00
Sodium (as Na)	15943
Potassium (as K)	0.00
Lithium (as Li)	0.00
Ammonia (as NH ₃)	0.00
Aluminum (as Al)	0.00
Iron (as Fe)	3.06
Manganese (as Mn)	0.227
Zinc (as Zn)	0.00
Lead (as Pb)	0.00

ANIONS

Chloride (as Cl)	27936
Sulfate (as SO ₄)	2046
Bromine (as Br)	0.00
Dissolved CO ₂ (as CO ₂)	51.00
Bicarbonate (as HCO ₃)	342.00
Carbonate (as CO ₃)	0.00
Oxalic acid (as C ₂ O ₄)	0.00
Silica (as SiO ₂)	0.00
Phosphate(as PO ₄)	0.00
H ₂ S (as H ₂ S)	0.00
Fluoride (as F)	0.00
Nitrate (as NO ₃)	0.00
Boron (as B)	0.00

PARAMETERS

Calculated T.D.S.	48092
Molar Conductivity	63749
Resistivity	15.69
Sp.Gr.(g/mL)	1.03
Pressure(psia)	14.70
pCO ₂ (psia)	0.0180
pH ₂ S(atm)	0.00
Temperature (°F)	72.00
pH	7.12

CORROSION RATE PREDICTION

CO ₂ - H ₂ S Rate(mpy)	0.00732
--	---------

COMMENTS All anions and cations are in mg/l

SGB Solutions
5918 S County Road 1273, Midland, TX 79706



DownHole SAT®
FORMATION WATER
DEPOSITION POTENTIAL INDICATORS

Mull Drilling
 Carter Johnson 1-1
 Wellhead

Pro-Stim Chemicals
 Lindi Dwyer

Report Date: 10-04-2023
 Sample #: 17404

Sampled: 09-25-2023 at 1644
 Sample ID: WBaten

SATURATION LEVEL

Calcite (CaCO ₃)	3.40
Aragonite (CaCO ₃)	3.18
Witherite (BaCO ₃)	0.00227
Strontianite (SrCO ₃)	0.00
Calcium oxalate (CaC ₂ O ₄)	0.00
Magnesite (MgCO ₃)	0.731
Anhydrite (CaSO ₄)	0.471
Gypsum (CaSO ₄ *2H ₂ O)	0.758
Barite (BaSO ₄)	87.67
Celestite (SrSO ₄)	0.00
Fluorite (CaF ₂)	0.00
Calcium phosphate	0.00
Hydroxyapatite	0.00
Silica (SiO ₂)	0.00
Brucite (Mg(OH) ₂)	< 0.001
Magnesium silicate	0.00
Iron hydroxide (Fe(OH) ₃)	66.23
Strengite (FePO ₄ *2H ₂ O)	0.00
Siderite (FeCO ₃)	8.70
Halite (NaCl)	0.00642
Thenardite (Na ₂ SO ₄)	< 0.001
Iron sulfide (FeS)	0.00

FREE ION MOMENTARY EXCESS (ppm)

Calcite (CaCO ₃)	0.565
Aragonite (CaCO ₃)	0.548
Witherite (BaCO ₃)	-51.82
Strontianite (SrCO ₃)	-17.32
Calcium oxalate (CaC ₂ O ₄)	-0.114
Magnesite (MgCO ₃)	-0.248
Anhydrite (CaSO ₄)	-1260
Gypsum (CaSO ₄ *2H ₂ O)	-453.58
Barite (BaSO ₄)	5.04
Celestite (SrSO ₄)	-103.14
Fluorite (CaF ₂)	-19.36
Calcium phosphate	>-0.001
Hydroxyapatite	-965.93
Silica (SiO ₂)	-104.33
Brucite (Mg(OH) ₂)	0.00936
Magnesium silicate	-293.42
Iron hydroxide (Fe(OH) ₃)	< 0.001
Strengite (FePO ₄ *2H ₂ O)	>-0.001
Siderite (FeCO ₃)	0.803
Halite (NaCl)	-490857
Thenardite (Na ₂ SO ₄)	-195827
Iron sulfide (FeS)	-0.407

SIMPLE INDICES

Langelier	0.726
Ryznar	5.67
Puckorius	4.69
Larson-Skold Index	150.31
Stiff Davis Index	0.0961
Oddo-Tomson	-0.0519

BOUND IONS

Calcium	1733	1549
Barium	3.00	3.00
Carbonate	4.53	0.480
Phosphate	0.00	0.00
Sulfate	2046	1246

OPERATING CONDITIONS

Temperature (°F)	72.00
Time(mins)	3.00

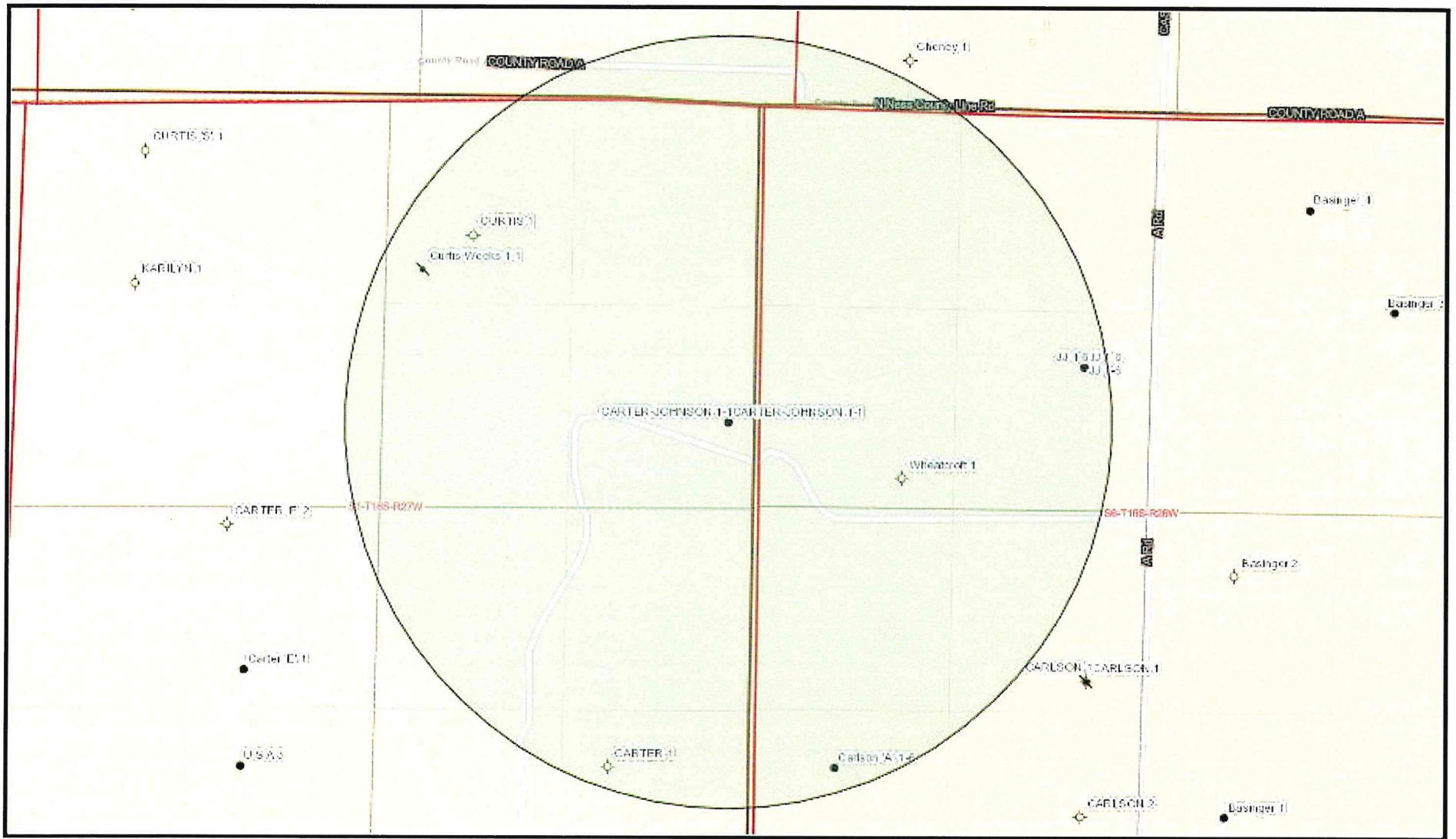

Oil and Gas Wells

- | | | | | |
|---------------------------------------|--|--------------------------------|----------------------------------|--|
| ● Coal Bed Methane | ✕ Enhanced Oil Recovery, Plugged-Abandoned | ✕ Injection, Plugged-Abandoned | ✕ Oil and Gas, Plugged-Abandoned | ⊗ Other, Plugged-Abandoned |
| ● Coal Bed Methane, Plugged-Abandoned | ⊕ Gas | ○ Intent | ● Oil | ▲ Salt Water Disposal |
| ✧ Dry and Abandoned | ✕ Gas, Plugged-Abandoned | ○ Location | ✕ Oil, Plugged-Abandoned | ✕ Salt Water Disposal, Plugged-Abandoned |
| ✕ Enhanced Oil Recovery | ✕ Injection | ★ Oil and Gas | ⊙ Other | |

10/11/2023

<https://maps.kgs.ku.edu/oilgas>



DRILLING COMPANY, INC.
WICHITA, KANSAS

**ATTACHMENT TO ACO-4
APPLICATION FOR COMMINGLING OF PRODUCTION**

**Signed Certificate of Notice to Offset Operators and Unleased Mineral Holders
Mull Drilling Company, Inc.
Carter-Johnson #1-1
SE/4 NE/4 Section 1-16S-27W
Lane County, Kansas
API No. 15-101-22672**

Names and addresses of each operator or lessee of record and each unleased mineral owner within one half mile of the subject well:

T15S-R27W

Section 31: SE/4
Section 32: SW/4
Gove Co., KS

Mull Drilling Company, Inc.
1700 N Waterfront Pkwy, Bldg. 1200
Wichita, KS 67206

T16S-R26W

Section 6: W/2
Ness Co., KS

Mull Drilling Company, Inc.
1700 N Waterfront Pkwy, Bldg. 1200
Wichita, KS 67206

T16S-R27W

Section 1: N/2N/2

Pickrell Drilling Company, Inc.
929 W. Douglas Avenue
Wichita, KS 67213

Section 1: S/2N/2

Mull Drilling Company, Inc.
1700 N Waterfront Pkwy, Bldg. 1200
Wichita, KS 67206

Section 1: SW/4, W/2SE/4

Vess Oil Corporation
1700 Waterfront Pkwy, Bldg. 500
Wichita, KS 67206

Section 1: E/2SE/4

Charles R. Carter Jr. and Ethel Mae Carter
109 NE 22nd St.
Guymon, Oklahoma 73942

The Herbert Lee Carter and Judith Ann Carter
Revocable Trust, dated April 5, 2002
746 Progress Drive
Fountain, Colorado 80817

Mull Drilling Company, Inc's Carter-Johnson #1-1
SE/4 NE/4 Section 1-16S-27W
Lane County, Kansas
Page 2

Section 1: E/2SE/4 cont.

Kelle S. Tillitson
826 N. Main St.
WaKeeney, Kansas 67642

Larry D. Weeks Living Trust, dated May 23, 2013
24387 AA Road
Brownell, Kansas 67521

Shirley K. Weeks Living Trust, dated May 23, 2013
24387 AA Road
Brownell, Kansas 67521

Copy of the ACO-4 was mailed to the above listed companies/individuals on **November 7, 2023.**

Signed this 7th day of November, 2023.

MULL DRILLING COMPANY, INC.



Risa O'Bryhim
Production Specialist

STATE OF KANSAS

ACKNOWLEDGEMENT FOR INDIVIDUAL

COUNTY OF SEDGWICK

Before me, the undersigned, a Notary Public, within and for said county and state, on this 7th day of **November, 2023**, personally appeared **Risa O'Bryhim, Production Specialist of Mull Drilling Company, Inc.,** to me personally known to be the identical person who executed the within and foregoing Certificate of Service Form and acknowledged to me that she executed the same as her free and voluntary act and deed for the uses and purposes therein set forth.

IN WITNESS WHEREOF, I have hereunto set my hand and official seal the day and year last above written.

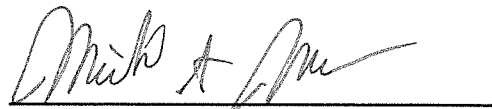
Michael A. Massaglia, Notary Public

My commission expires: 10/25/26

Proof of Publication

State of Kansas,
County of Lane, ss:

Kimberly George

of lawful age, being duly sworn upon oath states that he/she is the editor of THE DIGHTON HERALD.

THAT said newspaper has been published at least weekly 50 times a year and has been so published for at least five years prior to the first publication of the attached notice.

THAT said newspaper was entered as second class matter at the post office of its publication;

THAT said newspaper has a general paid circulation on a daily, weekly, monthly, or yearly basis in LANE County, Kansas and is NOT a trade, religious or fraternal publication and has been printed and published in LANE County, Kansas.

THE ATTACHED was published on the following dates in a regular issue of said newspaper:

- 1st Publication was made on the 15th day of Nov, 2023
- 2nd Publication was made on the ___ day of ___, 20__
- 3rd Publication was made on the ___ day of ___, 20__
- 4th Publication was made on the ___ day of ___, 20__
- 5th Publication was made on the ___ day of ___, 20__
- 6th Publication was made on the ___ day of ___, 20__

Publication fee \$ 65.00
 Affidavit, Notary's Fees \$ _____
 Additional Copies _____ \$ _____
 Total Publication Fee \$ 65.00

Kimberly George
(Signed)

Witness my hand this 16 day of November, 2023

SUBSCRIBED and SWORN to before me this 16

day of November, 2023.

Kelli James
(Notary Public)

My commission expires 10/21/24



LEGAL

First Published in the Dighton Herald on 11/15/23

BEFORE THE STATE CORPORATION COMMISSION OF THE STATE OF KANSAS NOTICE OF FILING APPLICATION

Re: Mull Drilling Company, Inc. - Application for order to permit commingling of production of the

Carter-Johnson #1-1, located in Lane County, Kansas.

To: All Oil & Gas Producers, Unleased Mineral Interest Owners, Landowners, and all persons whosever concerned.

You, and each of you, are hereby notified that Mull Drilling Company, Inc. has filed an application to commingle production of the LKC "H", LKC "J", and Mississippi formations on the Carter-Johnson #1-1, located SE/4 NE/4 1-16S-27W, Lane County, Kansas.

Any persons who object to or protest this application shall be required to file their

objections or protests with the Conservation Division of the State Corporation Commission of the State of Kansas within fifteen (15) days from the date of the publication.

These protests shall be filed pursuant to Commission regulations and must state specific reasons why the grant of the application may cause waste, violate correlative rights or pollute the natural resources of the state of Kansas.

If no protests are received, this application may be granted through a summary proceeding. If valid protests are received, this matter will be set for hearing.

All persons interested or concerned shall take notice of the foregoing and shall govern themselves accordingly.

Mull Drilling Company, Inc.

1700 N. Waterfront Parkway, Building 1200

Wichita, KS 67206
316-264-6366



The Beaufort Gazette
 The Belleville News-Democrat
 Bellingham Herald
 Centre Daily Times
 Sun Herald
 Idaho Statesman
 Bradenton Herald
 The Charlotte Observer
 The State
 Ledger-Enquirer

Durham | The Herald-Sun
 Fort Worth Star-Telegram
 The Fresno Bee
 The Island Packet
 The Kansas City Star
 Lexington Herald-Leader
 The Telegraph - Macon
 Merced Sun-Star
 Miami Herald
 El Nuevo Herald

The Modesto Bee
 The Sun News - Myrtle Beach
 Raleigh News & Observer
 Rock Hill | The Herald
 The Sacramento Bee
 San Luis Obispo Tribune
 Tacoma | The News Tribune
 Tri-City Herald
 The Wichita Eagle
 The Olympian

AFFIDAVIT OF PUBLICATION

Account #	Order Number	Identification	Order PO	Amount	Cols	Depth
38629	488138	Print Legal Ad-IPL01472780 - IPL0147278	Carter-Johnson #1-1	\$328.68	1	52 L

Attention: Risa O'Bryhim
 MULL DRILLING COMPANY, INC.
 1700 N. WATERFRONT PKWY, BUILDING 1200
 WICHITA, KS 67206

LEGAL PUBLICATION
 BEFORE THE STATE CORPORATION COMMISSION OF THE STATE OF KANSAS
 NOTICE OF FILING APPLICATION

Re: Mull Drilling Company, Inc. - Application for order to permit commingling of production of the Carter-Johnson #1-1, located in Lane County, Kansas.

To: All Oil & Gas Producers, Unleased Mineral Interest Owners, Landowners, and all persons whosoever concerned.

You, and each of you, are hereby notified that Mull Drilling Company, Inc. has filed an application to commingle production of the LKC "H", LKC "J", and Mississippi formations on the Carter-Johnson #1-1, located SE/4 NE/4 1-16S-27W, Lane County, Kansas.

Any persons who object to or protest this application shall be required to file their objections or protests with the Conservation Division of the State Corporation Commission of the State of Kansas within fifteen (15) days from the date of the publication. These protests shall be filed pursuant to Commission regulations and must state specific reasons why the grant of the application may cause waste, violate correlative rights or pollute the natural resources of the state of Kansas. If no protests are received, this application may be granted through a summary proceeding. If valid protests are received, this matter will be set for hearing.

All persons interested or concerned shall take notice of the foregoing and shall govern themselves accordingly.
 Mull Drilling Company, Inc.
 1700 N. Waterfront Parkway, Building 1200
 Wichita, KS 67206
 316-264-6366
 IPL0147278
 Nov 9 2023

In The STATE OF KANSAS
 In and for the County of Sedgwick
 1 insertion(s) published on:
 11/09/23

STATE OF KANSAS)
 SS
 County of Sedgwick)

Stefani Beard, of lawful age, being first duly sworn, deposeth and saith: That he is Record Clerk of The Wichita Eagle, a daily newspaper published in the City of Wichita, County of Sedgwick, State of Kansas, and having a general paid circulation on a daily basis in said County, which said newspaper has been continuously and uninterruptedly published in said County for more than one year prior to the first publication of the notice hereinafter mentioned, and which said newspaper has been entered as second class mail matter at the United States Post Office in Wichita, Kansas, and which said newspaper is not a trade, religious or fraternal publication and that a notice of a true copy is hereto attached was published in the regular and entire Morning issue of said The Wichita Eagle from 11/09/2023 to 11/09/2023.

Stefani Beard

I certify (or declare) under penalty of perjury that the foregoing is true and correct.
 DATED: 11/09/2023

Stephanie Hatcher

Notary Public in and for the state of Texas, residing in Dallas County

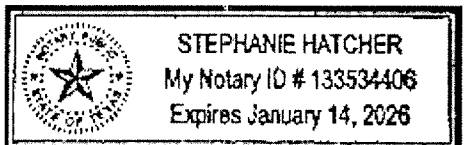

Extra charge for lost or duplicate affidavits.
 Legal document please do not destroy!

Conservation Division
266 N. Main St., Ste. 220
Wichita, KS 67202-1513



Phone: 316-337-6200
Fax: 316-337-6211
<http://kcc.ks.gov/>

Andrew J. French, Chairperson
Dwight D. Keen, Commissioner
Annie Kuether, Commissioner

Laura Kelly, Governor

December 28, 2023

Bryan Neuhaus
Mull Drilling Co., Inc.
1700 N Waterfront Pkwy, Bldg 1200
Wichita, KS 67206

RE: Approved Commingling CO122303
Carter-Johnson 1-1
API No. 15-101-22672-00-01

Dear Mr. Neuhaus:

Your Application for Commingling (ACO-4) for the above described well has been reviewed and approved by the Kansas Corporation Commission (KCC) per K.A.R. 82-3-123. Notice was examined and found to be proper per K.A.R. 82-3-135a. No protest had been filed within the 15-day protest period.

Based upon the depth of the Mississippi formation perforations, total oil production shall not exceed 200 BOPD and total gas production shall not exceed 50% of the absolute open flow (AOF).

Sincerely,

Production Department Supervisor