

WATER WELL RECORD (WWC-5)

KOLAR DOC ID _____ WELL ID _____
 Original Record Correction Change in Well Use

LOCATION OF WATER WELL

Latitude		Longitude		Section		Township		Range		E W	Fraction	¼	¼	¼
Datum		Elevation		County										

WATER WELL OWNER

Name	
Business	
Address	
Well location at owner's address	

WELL WATER USE

--

COMPLETION

Depth of completed well: _____ ft.
Depth(s) groundwater encountered: (1) _____ ft.; (2) _____ ft.; (3) _____ ft.; (4) dry well
Static water level in well: _____ ft. measured below land surface on (mm/dd/yy): _____ measured above land surface on (mm/dd/yy): _____
Estimated yield: _____ gpm
Water level was: _____ ft. after _____ hours pumping _____ gpm
Pump installed? Yes No
Water well disinfected? Yes No
Date disinfected (mm/dd/yy): _____
Aquifer, if known:

NEAREST SOURCE OF POTENTIAL CONTAMINATION

Source: _____
Distance from well: _____ Direction from well: _____
Source description: _____
Source: _____
Distance from well: _____ Direction from well: _____
Source description: _____
No potential source of contamination within 100 feet.

CONSTRUCTION

Borehole interval: from _____ to _____ ft.	Borehole diameter: _____ in.
from _____ to _____ ft.	_____ in.
Casing height above land surface: _____ in.	
If casing height is less than 12 in. has a variance been approved? * Yes No	
*variance not required for monitoring or environmental remediation wells	
Casing type: _____	
Blank casing interval: _____ ft. to _____ ft.	
Blank casing diameter: _____ in.	
Casing joints: _____	
Weight: _____ lbs/ft.	
Wall thickness or gauge no.: _____	
Blank casing interval: _____ ft. to _____ ft.	
Blank casing diameter: _____ in.	
Casing joints: _____	
Weight: _____ lbs/ft.	
Wall thickness or gauge no.: _____	
Grout interval: _____ ft. to _____ ft.	
Grout material: _____	
Grout interval: _____ ft. to _____ ft.	
Grout material: _____	
Screen / perforation material: _____	
Screen / perforation openings: _____	
Screen / perforation intervals: From _____ ft. to _____ ft.	
Slot size _____ unit _____	
From _____ ft. to _____ ft.	
Slot size _____ unit _____	
Gravel pack intervals: Gravel pack not used: Gravel size _____ in	
From _____ ft. to _____ ft.	
Gravel pack not used: Gravel size _____ in	
From _____ ft. to _____ ft.	

PERMIT & ID NUMBERS (AS REQUIRED)

DWR Application No.: _____
KDHE / EPA Project Code: _____
Site Name: _____
KDHE UIC Class V Form Completed: Yes No
County Permit: Yes No Permit ID: _____
Lease Name & Well #: _____
of boreholes: _____ # of dewatering wells: _____

LITHOLOGIC LOG

FROM	TO	LITHOLOGY INTERVALS

COMMENTS

--

CONTRACTOR'S OR LANDOWNERS CERTIFICATION

This water well was constructed reconstructed pursuant to the stated water well contractor's license and was completed on _____. I certify that this record is true to the best of my knowledge and belief. This water well record was completed on _____ under the business name of _____, Kansas Water Well Contractor's License No. _____ under the authority of the designated person as defined in K.A.R. 28-30-2(j) and signed and certified by the electronic signature of the designated person at its submittal: _____.

Send one copy to WATER WELL OWNER and retain one for your records. Fee of \$5.00 for each constructed well.

NOTE: Figures exhibited within this report are only to be used within the context of this report. Placement of property lines, wells, structures, and roads is based on the available information from county appraiser maps, surveys, site visits, and/or previous vendor reports and should be considered approximate.

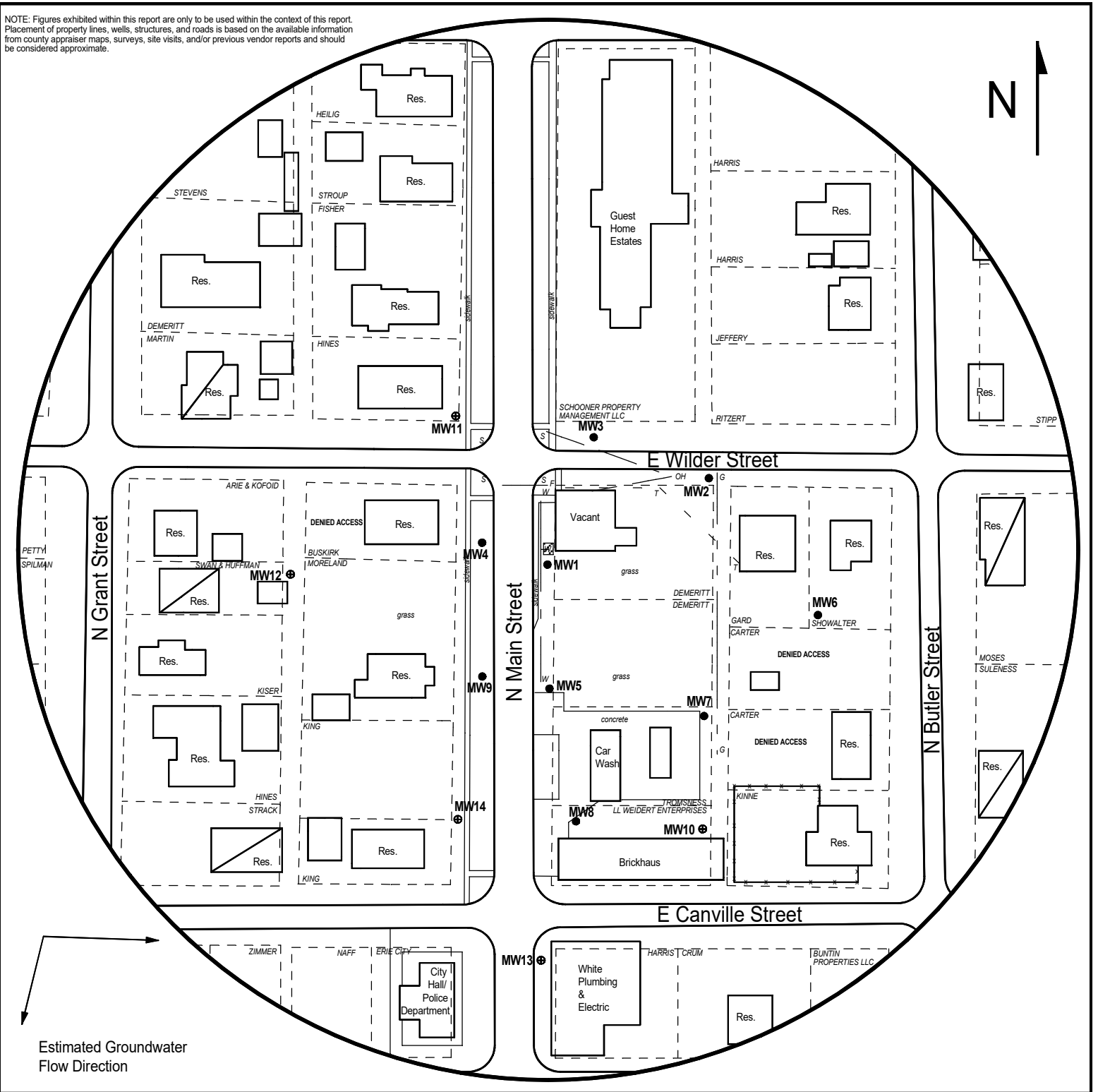

FIGURE 2.1 - 500 FT RADIUS AREA BASE MAP

LEGEND:

- Approximate Location of Former UST Basin
- Building with Basement
- Proposed Monitoring Well
- X Soil Boring (Drilled 8/30-31/23)
- F Fire Hydrant
- OH Overhead Lines (25-40 ft high)
- S Sewer (2 - 6 ft BGS)
- T Telephone (2 - 6 ft BGS)
- G Gas (2 - 6 ft BGS)
- W Water (2 - 6 ft BGS)

NOTE: SB5 & SB6 were drilled to collect hydrological samples.
NOTE: Utility depths, heights and locations are approximate.



PROJECT:

City of Erie
226 N. Main
Erie, KS
KDHE ID: U3-067-15295
Date: 8/30-31/23



1311 E 25th St., Suite B (785) 841-8707 office
Lawrence, KS 66046 (785) 865-4282 fax

DENNIS L HANDKE

1820 NW 59th Terrace
TOPEKA, KANSAS 66618
785-286-4047 Home

Jess Chapman
Larsen & Associates
1311 E. 25th Street, Suite B
Lawrence, Kansas, 66046

February 27, 2024

RE: Monitor Well Elevation Survey
226 N. Main St., Erie, Kansas

Proj. 24-00I
City of Erie
U3-067-15295

Bench Mark: Chisled Sq. on West edge of concrete floor at the entrance door to the storage unit at the approximate center of the car wash.

Elev:	896.83	North	4060.22	West	2545.79	(from SE Cor. Sec. 32-28-20E
MW-10 rim	896.22	North	4023.45	SW1/4,SW1/4,NW1/4,NE1/4		
top pipe	895.78	West	2453.83	Lat= 37.56907	Long = 95.24284	
MW-11 rim	894.58	North	4386.86	NE1/4,SE1/4,NE1/4,NW1/4		
top pipe	894.05	West	2675.94	Lat= 37.57007	Long = 95.24360	
MW-12 rim	896.20	North	4241.44	SE1/4,SE1/4,NE1/4,NW1/4		
top pipe	895.76	West	2837.30	Lat= 37.56967	Long = 95.24416	
MW-13 rim	896.51	North	3867.51	NW1/4,NW1/4,SW1/4,NE1/4		
top pipe	896.10	West	2592.32	Lat= 37.56863	Long = 95.24332	
MW-14 rim	896.63	North	4046.39	SE1/4,SE1/4,NE1/4,NW1/4		
top pipe	896.07	West	2675.75	Lat= 37.56913	Long = 95.24361	

Lat & Long derived from Erie 7.5' quad map. WGS 84.

Elevation established from existing project. NAVD 88.

If you have any questions, please feel free to call me. Thank you for the opportunity to be of service to you.

