

**WATER WELL RECORD (WWC-5)**

KOLAR DOC ID \_\_\_\_\_ WELL ID \_\_\_\_\_

**LOCATION OF WATER WELL**

Latitude		Longitude		Section		Township		Range		E W	Fraction	¼	¼	¼
Datum		Elevation		County										

**WATER WELL OWNER**

Name	
Business	
Address	
Well location at owner's address	

**WELL WATER USE**

--

**WELL INFORMATION**

Depth of well: _____ ft.
Dry well
Static water level in well: _____ ft. measured below land surface on (mm/dd/yy): _____
measured above land surface on (mm/dd/yy): _____

**PERMIT & ID NUMBERS (AS REQUIRED)**

DWR Application No.: _____
KDHE / EPA Project Code: _____
Site Name: _____
KDHE UIC Class V Form Completed: Yes No
County Permit: Yes No Permit ID: _____
Lease Name & Well #: _____
# of boreholes: _____ # of dewatering wells: _____

**CASING**

Type of blank casing used: _____
Casing type details: _____
Blank casing diameter: _____ inches
Was casing removed? Yes No
Top of casing is currently _____ feet _____ ground
Reason required if top of casing is now less than 5 feet below ground surface for a hand dug well or less than 3 feet below ground surface for all other types of wells.

**GROUT & PLUGGING MATERIALS**

Grout or Plugging interval (ft.)		Material	Description
From	To		

**COMMENTS**

--

**CONTRACTOR'S OR LANDOWNERS CERTIFICATION**

<p>This water well was plugged pursuant to the stated water well contractor's license and was completed on _____. I certify that this record is true to the best of my knowledge and belief. This water well record was completed on _____ under the business name of _____, Kansas Water Well Contractor's License No. _____ under the authority of the designated person as defined in K.A.R. 28-30-2(j) and signed and certified by the electronic signature of the designated person at its submittal _____.</p>
--

Send one copy to WATER WELL OWNER and retain one for your records.

PLOTTED: 4/8/2024 1:14 PM  
 G:\Projects\257\257-P2-01\Plugged Well Map\Figure 1.dwg  
 G:\Projects\257\257-P2-01\Plugged Well Map\Figure 1.dwg  
 Brian S. Fahrenbruch  
 4/8/2024 1:11 PM  
 SAVED: 4/8/2024 1:11 PM  
 1:14 PM

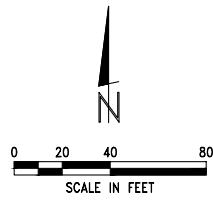

**CB. & Q. RAILROAD**

**JACKSON ST.**

**LEGEND**

- ◆ = MONITORING WELL (2")
- = SVE WELL (4")
- = LEAK DETECTION WELL (4")  
CONNECTED TO SVE SYSTEM
- ▲ = AS WELL (2")
- ☆ = PLUGGED WELL
- x— = FENCE
- - - = APPROXIMATE ROW LINES

REVISIONS	BY

**MILCO**  
**Environmental**  
**Services, Inc.**  
 Kearney, NE (308) 237-5923  
 McCook, NE (308) 345-4741

**ST. FRANCIS MERC. EQUITY EXCHANGE**  
**SITE MAP**  
**ST. FRANCIS, KANSAS U6-012-13119**

SCALE:	1"=80
PROJECT NO.	M257-P2-01
DATE:	APRIL, 2024
FIELD BOOK	M&A DWG NO.
DRAWN BY:	APRV'D BY:
BSF	
SHEET	

**FIGURE 1**

This document, and the ideas and designs incorporated herein, as an instrument of professional service, is the property of MILCO and is not to be used in whole or in part, for any other project without the written authorization of © 2009 MILCO.

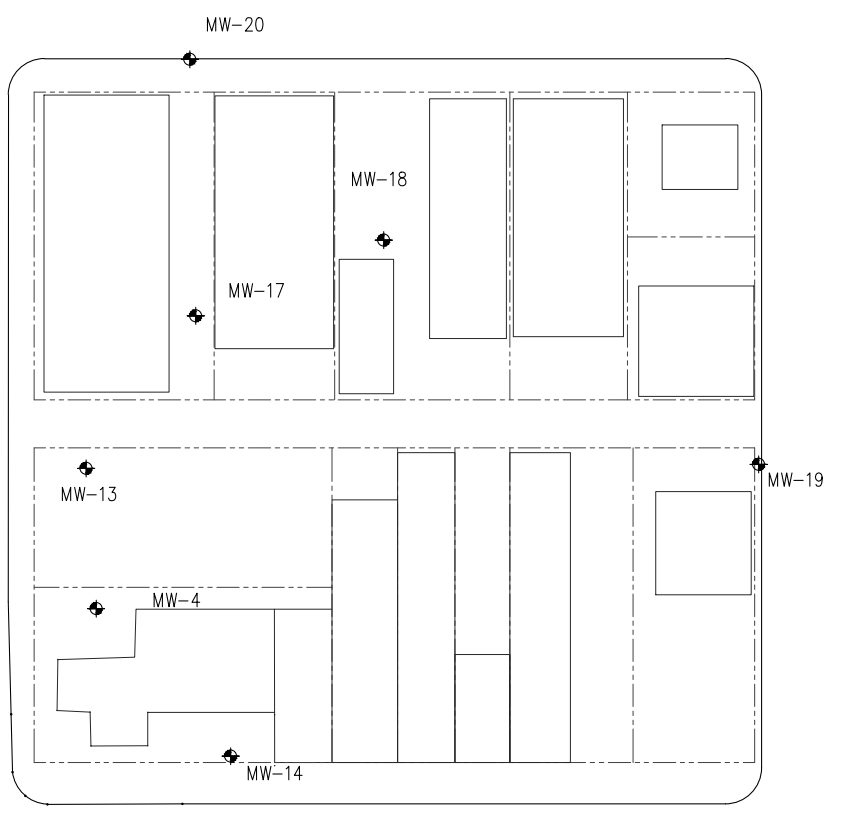
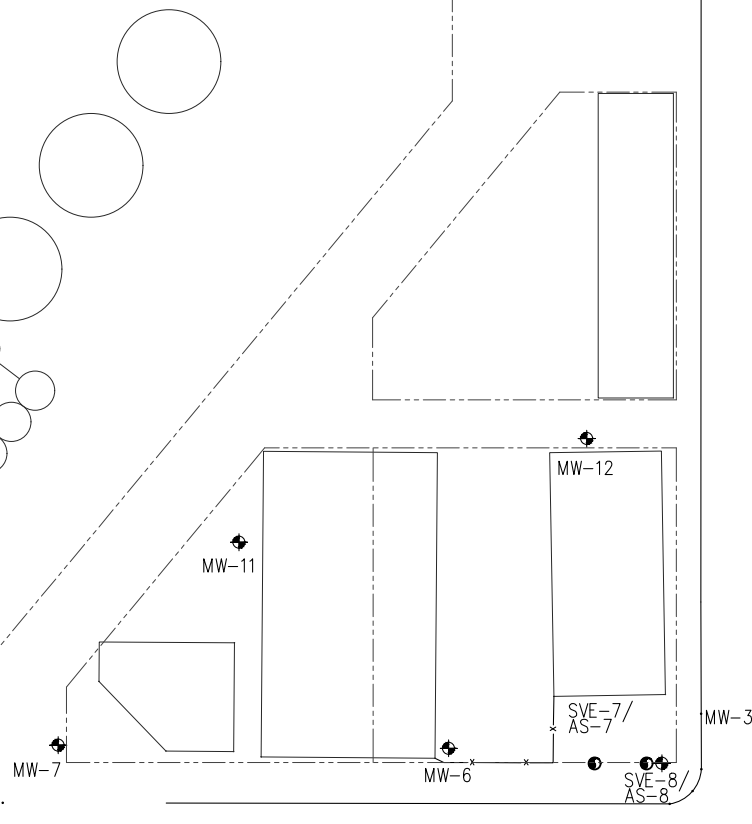

**WASHINGTON ST.**

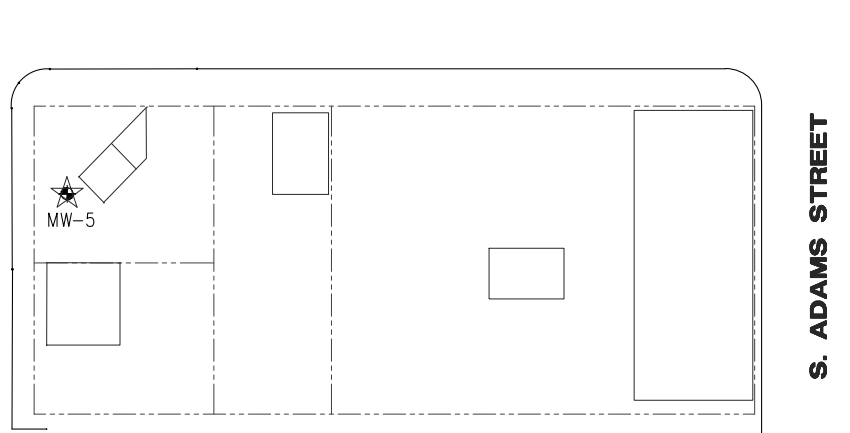
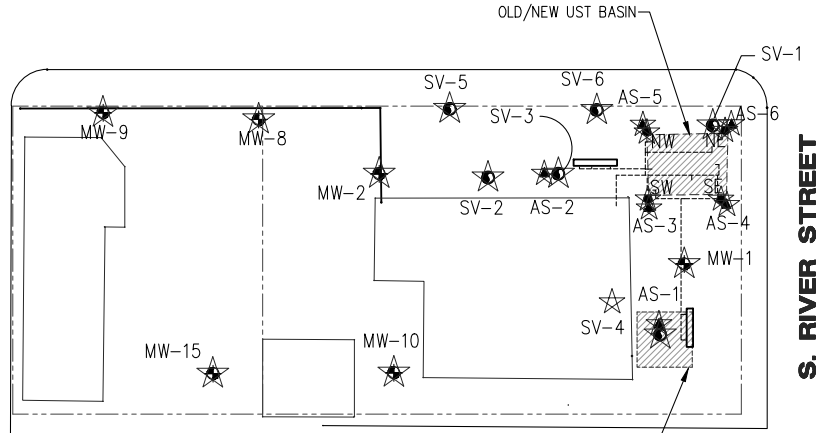

**S. VALLEY STREET**

**S. RIVER STREET**

**S. ADAMS STREET**

**WEBSTER ST.**