

**WATER WELL RECORD (WWC-5)**

KOLAR DOC ID \_\_\_\_\_ WELL ID \_\_\_\_\_  
 Original Record      Correction      Change in Well Use

**LOCATION OF WATER WELL**

|          |  |           |  |         |  |          |  |       |  |        |          |   |   |   |
|----------|--|-----------|--|---------|--|----------|--|-------|--|--------|----------|---|---|---|
| Latitude |  | Longitude |  | Section |  | Township |  | Range |  | E<br>W | Fraction | ¼ | ¼ | ¼ |
| Datum    |  | Elevation |  | County  |  |          |  |       |  |        |          |   |   |   |

**WATER WELL OWNER**

|   |  |
|---|--|
| Name                                    |  |
| Business                                |  |
| Address                                 |  |
| Well location<br><br>at owner's address |  |

**WELL WATER USE**

|  |
|--|
|  |
|--|

**COMPLETION**

|   |
|---|
| Depth of completed well: _____ ft.  |
| Depth(s) groundwater encountered:<br>(1) _____ ft.; (2) _____ ft.;<br>(3) _____ ft.; (4) dry well   |
| Static water level in well: _____ ft.<br>measured below land surface<br>on (mm/dd/yy): _____<br>measured above land surface<br>on (mm/dd/yy): _____ |
| Estimated yield: _____ gpm  |
| Water level was: _____ ft. after _____ hours<br>pumping _____ gpm   |
| Pump installed?    Yes    No  |
| Water well disinfected?    Yes    No  |
| Date disinfected (mm/dd/yy): _____  |
| Aquifer, if known:  |

**NEAREST SOURCE OF POTENTIAL CONTAMINATION**

|   |
|---|
| Source: _____   |
| Distance from well: _____      Direction from well: _____ |
| Source description: _____                                 |
| Source: _____   |
| Distance from well: _____      Direction from well: _____ |
| Source description: _____                                 |
| No potential source of contamination within 100 feet.     |

**CONSTRUCTION**

|  |                                 |
|--|---------------------------------|
| Borehole interval:<br>from _____ to _____ ft.                                    | Borehole diameter:<br>_____ in. |
| from _____ to _____ ft.  | _____ in.                       |
| Casing height above land surface: _____ in.                                      |                                 |
| If casing height is less than 12 in. has a variance been approved?*    Yes    No |                                 |
| *variance not required for monitoring or environmental remediation wells         |                                 |
| Casing type: _____   |                                 |
| Blank casing interval: _____ ft. to _____ ft.                                    |                                 |
| Blank casing diameter: _____ in.   |                                 |
| Casing joints: _____   |                                 |
| Weight: _____ lbs/ft.  |                                 |
| Wall thickness or gauge no.: _____   |                                 |
| Blank casing interval: _____ ft. to _____ ft.                                    |                                 |
| Blank casing diameter: _____ in.   |                                 |
| Casing joints: _____   |                                 |
| Weight: _____ lbs/ft.  |                                 |
| Wall thickness or gauge no.: _____   |                                 |
| Grout interval: _____ ft. to _____ ft.   |                                 |
| Grout material: _____  |                                 |
| Grout interval: _____ ft. to _____ ft.   |                                 |
| Grout material: _____  |                                 |
| Screen / perforation material: _____   |                                 |
| Screen / perforation openings: _____   |                                 |
| Screen / perforation intervals:<br>From _____ ft. to _____ ft.                   |                                 |
| Slot size _____ unit _____   |                                 |
| From _____ ft. to _____ ft.  |                                 |
| Slot size _____ unit _____   |                                 |
| Gravel pack intervals:<br>Gravel pack not used:    Gravel size _____ in          |                                 |
| From _____ ft. to _____ ft.  |                                 |
| Gravel pack not used:    Gravel size _____ in                                    |                                 |
| From _____ ft. to _____ ft.  |                                 |

**PERMIT & ID NUMBERS (AS REQUIRED)**

|   |
|---|
| DWR Application No.: _____                            |
| KDHE / EPA Project Code: _____                        |
| Site Name: _____                                      |
| KDHE UIC Class V Form Completed:    Yes    No         |
| County Permit:    Yes    No    Permit ID: _____       |
| Lease Name & Well #: _____                            |
| # of boreholes: _____    # of dewatering wells: _____ |

**LITHOLOGIC LOG**

| FROM | TO | LITHOLOGY INTERVALS |
|------|----|---------------------|
|      |    |                     |
|      |    |                     |
|      |    |                     |
|      |    |                     |
|      |    |                     |
|      |    |                     |
|      |    |                     |
|      |    |                     |
|      |    |                     |
|      |    |                     |

**COMMENTS**

|  |
|--|
|  |
|--|

**CONTRACTOR'S OR LANDOWNERS CERTIFICATION**

|   |
|---|
| This water well was    constructed    reconstructed    pursuant to the stated water well contractor's license and was completed on _____. I certify that this record is true to the best of my knowledge and belief. This water well record was completed on _____ under the business name of _____, Kansas Water Well Contractor's License No. _____ under the authority of the designated person as defined in K.A.R. 28-30-2(j) and signed and certified by the electronic signature of the designated person at its submittal: _____. |
|---|

Send one copy to WATER WELL OWNER and retain one for your records. Fee of \$5.00 for each constructed well.

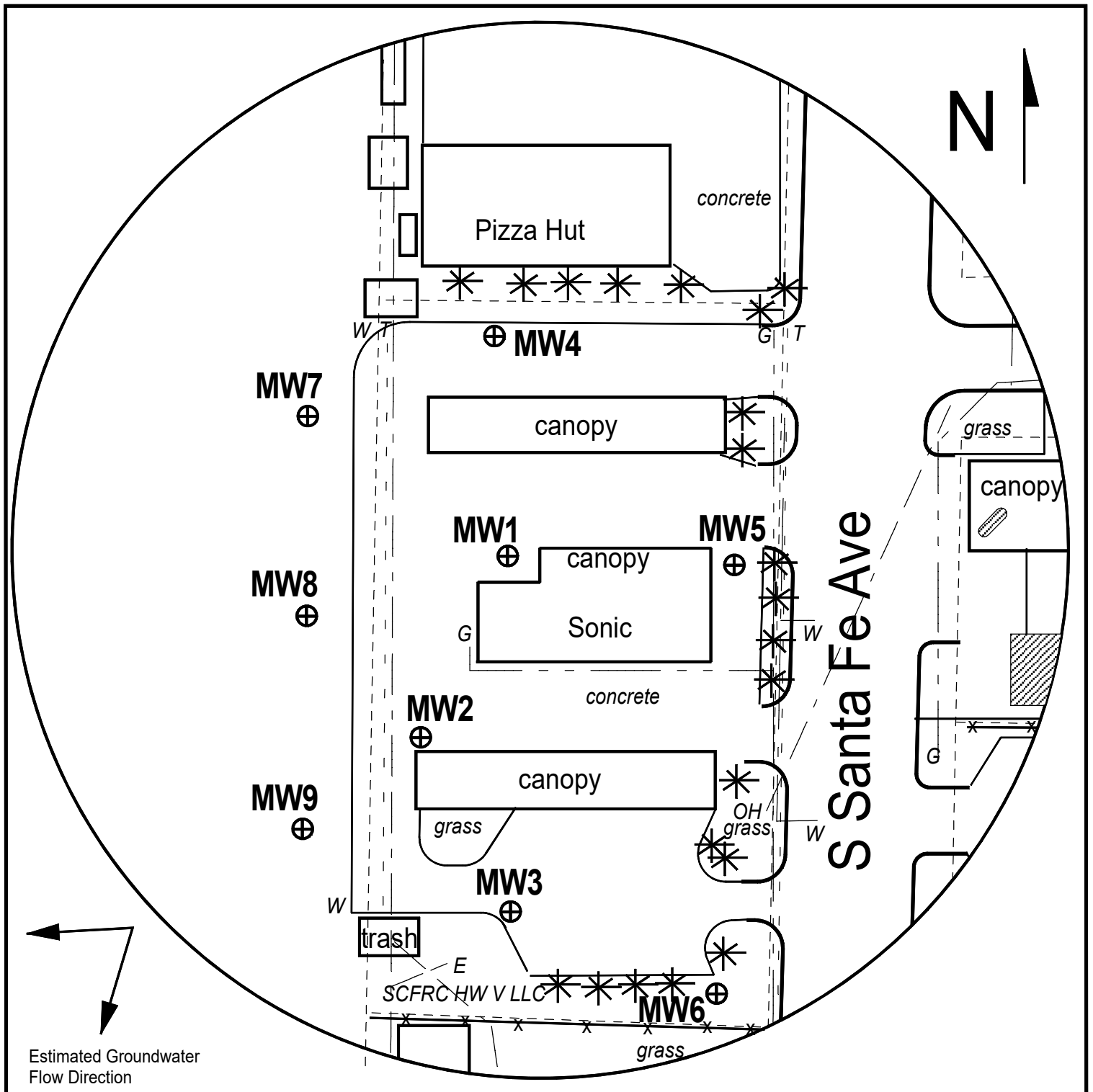

FIGURE 3 - DETAILED SITE BASE MAP



**PROJECT:**

Craig's Vickers Service  
1717 S Santa Fe,  
Chanute, KS  
KDHE ID: U3-067-15601  
Date: 2/7/24



**LEGEND:**

- Approximate Location of Active UST Basin, Product Lines, and Pump Island
- Proposed Monitoring Well
- Proposed Soil Boring
- OH ——— Overhead Lines
- G - - - Gas (2 - 6 ft BGS)
- W - - - Water (2 - 6 ft BGS)
- E - - - Electric (2 - 6 ft BGS)
- T - - - Telephone (2 - 6 ft BGS)

Note: Utility depths and locations are approximate.  
Note: SB5 & SB6 will be drilled to collected hydrologic samples.

# DENNIS L HANDKE

1820 NW 59th Terrace  
TOPEKA, KANSAS 66618  
785-286-4047 Home

Jess Chapman  
Larson & Assoc.  
1311 E. 25<sup>th</sup> St., Suite B  
Lawrence, Kansas, 66046

April 22, 2024

RE: Monitor Well Elevation Survey  
1717 South Santa Fe, Chanute, Kansas

Proj. 24-00R  
Craig's Vickers Service  
U3-067-15601

Bench Mark: Chisled X on top NE bolt of concrete light base East of the trash dumpster enclosure near the SW corner of property.

Elev: 960.19      North 1126.69      West 133.68      (from SE Cor. Sec. 29-27-18E)

|      |          |        |       |         |                               |
|------|----------|--------|-------|---------|-------------------------------|
| MW-1 | rim      | 958.46 | North | 1269.91 | NE1/4,NE1/4,SE1/SE1/4         |
|      | top pipe | 958.14 | West  | 119.93  | Lat= 37.66354 Long = 95.45298 |
| MW-2 | rim      | 958.76 | North | 1195.96 | NE1/4,NE1/4,SE1/4,SE1/4       |
|      | top pipe | 958.47 | West  | 151.54  | Lat= 37.66334 Long = 95.45310 |
| MW-3 | rim      | 957.82 | North | 1132.46 | NE1/4,NE1/4,SE1/4,SE1/4       |
|      | top pipe | 957.50 | West  | 129.53  | Lat= 37.66317 Long = 95.45303 |
| MW-4 | rim      | 959.21 | North | 1345.68 | SE1/4,SE1/4,NE1/4,SE1/4       |
|      | top pipe | 958.64 | West  | 128.73  | Lat= 37.66375 Long = 95.45301 |
| MW-5 | rim      | 958.37 | North | 1259.51 | NE1/4,NE1/4,SE1/4,SE1/4       |
|      | top pipe | 958.04 | West  | 38.53   | Lat= 37.66351 Long = 95.45270 |
| MW-6 | rim      | 957.71 | North | 1115.14 | NE1/4,NE1/4,SE1/4,SE1/4       |
|      | top pipe | 957.19 | West  | 47.10   | Lat= 37.66311 Long = 95.45274 |
| MW-7 | rim      | 956.00 | North | 1307.46 | NE1/4,NE1/4,SE1/4,SE1/4       |
|      | top pipe | 955.73 | West  | 204.06  | Lat= 37.66365 Long = 95.45327 |
| MW-8 | rim      | 954.76 | North | 1238.74 | NE1/4,NE1/4,SE1/4,SE1/4       |
|      | top pipe | 954.47 | West  | 207.23  | Lat= 37.66346 Long = 95.45329 |
| MW-9 | rim      | 954.10 | North | 1166.66 | NE1/4,NE1/4,SE1/4,SE1/4       |
|      | top pipe | 953.61 | West  | 203.58  | Lat= 37.66327 Long = 95.45328 |

Lat & Long derived from Chanute 7.5' quad map. WGS 84.

Elevation established from NGS BM H 246, NAVD 88.

If you have any questions, please feel free to call me. Thank you for the opportunity to be

