

WATER WELL RECORD (WWC-5)

KOLAR DOC ID _____ WELL ID _____
 Original Record Correction Change in Well Use

LOCATION OF WATER WELL

Latitude		Longitude		Section		Township		Range		E W	Fraction	¼	¼	¼
Datum		Elevation		County										

WATER WELL OWNER

Name	
Business	
Address	
Well location at owner's address	

WELL WATER USE

--

COMPLETION

Depth of completed well: _____ ft.
 Depth(s) groundwater encountered:
 (1) _____ ft.; (2) _____ ft.;
 (3) _____ ft.; (4) dry well

Static water level in well: _____ ft.
 measured below land surface
 on (mm/dd/yy): _____
 measured above land surface
 on (mm/dd/yy): _____

Estimated yield: _____ gpm
 Water level was: _____ ft. after _____ hours
 pumping _____ gpm
 Pump installed? Yes No

Water well disinfected? Yes No
 Date disinfected (mm/dd/yy): _____

Aquifer, if known: _____

NEAREST SOURCE OF POTENTIAL CONTAMINATION

Source: _____
 Distance from well: _____ Direction from well: _____
 Source description: _____

Source: _____
 Distance from well: _____ Direction from well: _____
 Source description: _____

No potential source of contamination within 100 feet.

CONSTRUCTION

Borehole interval: from _____ to _____ ft.	Borehole diameter: _____ in.
from _____ to _____ ft.	_____ in.
Casing height above land surface: _____ in. If casing height is less than 12 in. has a variance been approved? * Yes No *variance not required for monitoring or environmental remediation wells	
Casing type: _____	
Blank casing interval: _____ ft. to _____ ft.	
Blank casing diameter: _____ in.	
Casing joints: _____	
Weight: _____ lbs/ft.	
Wall thickness or gauge no.: _____	
Blank casing interval: _____ ft. to _____ ft.	
Blank casing diameter: _____ in.	
Casing joints: _____	
Weight: _____ lbs/ft.	
Wall thickness or gauge no.: _____	
Grout interval: _____ ft. to _____ ft.	
Grout material: _____	
Grout interval: _____ ft. to _____ ft.	
Grout material: _____	
Screen / perforation material: _____	
Screen / perforation openings: _____	
Screen / perforation intervals: From _____ ft. to _____ ft. Slot size _____ unit _____	
From _____ ft. to _____ ft. Slot size _____ unit _____	
Gravel pack intervals: Gravel pack not used: Gravel size _____ in. From _____ ft. to _____ ft.	
Gravel pack not used: Gravel size _____ in. From _____ ft. to _____ ft.	

PERMIT & ID NUMBERS (AS REQUIRED)

DWR Application No.: _____
 KDHE / EPA Project Code: _____
 Site Name: _____
 KDHE UIC Class V Form Completed: Yes No
 County Permit: Yes No Permit ID: _____
 Lease Name & Well #: _____
 # of boreholes: _____ # of dewatering wells: _____

LITHOLOGIC LOG

FROM	TO	LITHOLOGY INTERVALS

COMMENTS

--

CONTRACTOR'S OR LANDOWNERS CERTIFICATION

This water well was constructed reconstructed pursuant to the stated water well contractor's license and was completed on _____. I certify that this record is true to the best of my knowledge and belief. This water well record was completed on _____ under the business name of _____, Kansas Water Well Contractor's License No. _____ under the authority of the designated person as defined in K.A.R. 28-30-2(j) and signed and certified by the electronic signature of the designated person at its submittal: _____.

Send one copy to WATER WELL OWNER and retain one for your records. Fee of \$5.00 for each constructed well.

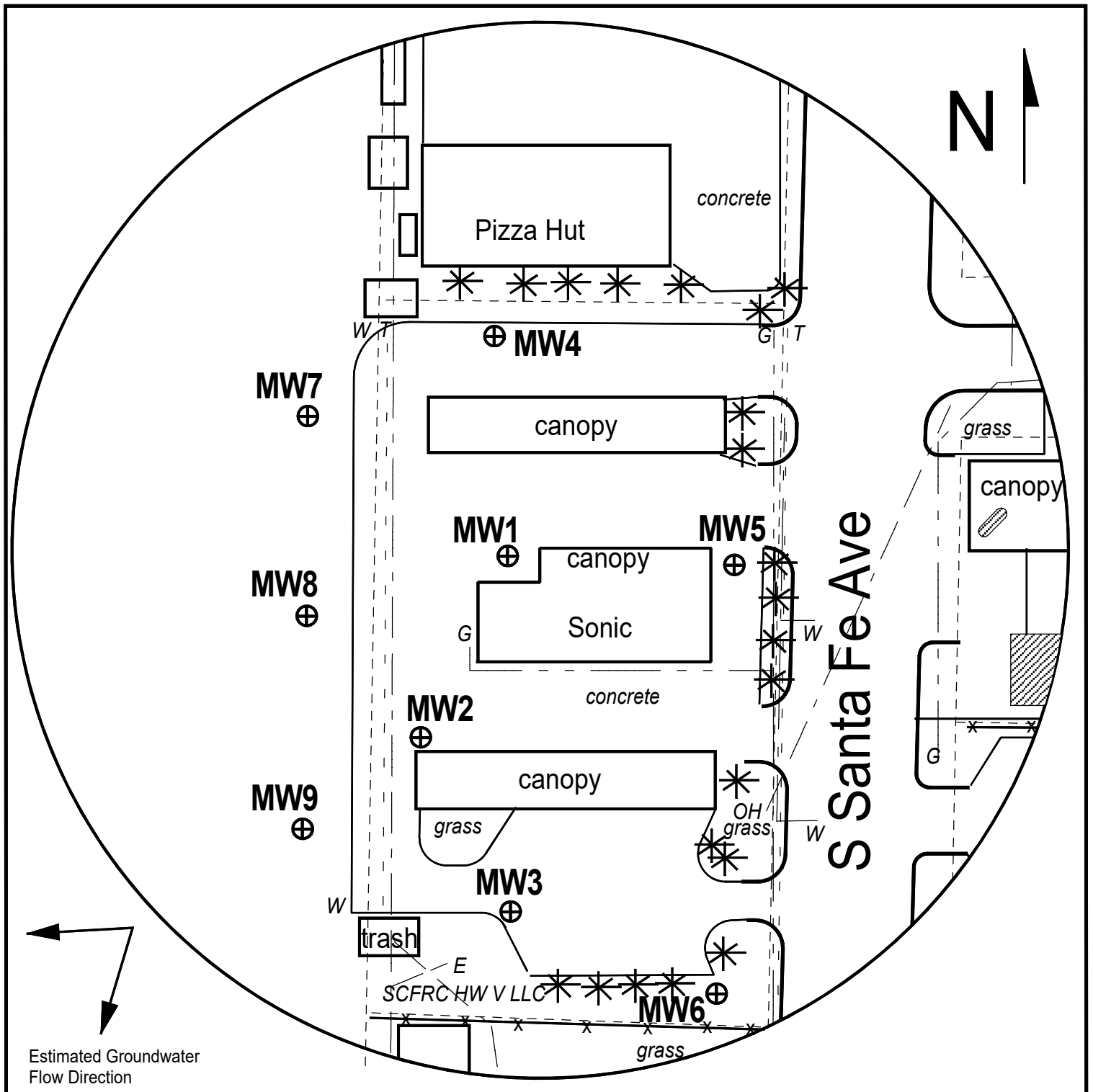





FIGURE 3 - DETAILED SITE BASE MAP

LEGEND:

-  Approximate Location of Active UST Basin, Product Lines, and Pump Island
-  Proposed Monitoring Well
-  Proposed Soil Boring
- OH ——— Overhead Lines
- G - - - Gas (2 - 6 ft BGS)
- W - - - Water (2 - 6 ft BGS)
- E - - - Electric (2 - 6 ft BGS)
- T - - - Telephone (2 - 6 ft BGS)

Note: Utility depths and locations are approximate.
 Note: SB5 & SB6 will be drilled to collected hydrologic samples.



PROJECT:

Craig's Vickers Service
 1717 S Santa Fe,
 Chanute, KS
 KDHE ID: U3-067-15601
 Date: 2/7/24



1311 E 25th St., Suite B
 Lawrence, KS 66046 (785) 841-8707 office

DENNIS L HANDKE

1820 NW 59th Terrace
TOPEKA, KANSAS 66618
785-286-4047 Home

Jess Chapman
Larson & Assoc.
1311 E. 25th St., Suite B
Lawrence, Kansas, 66046

April 22, 2024

RE: Monitor Well Elevation Survey
1717 South Santa Fe, Chanute, Kansas

Proj. 24-00R
Craig's Vickers Service
U3-067-15601

Bench Mark: Chisled X on top NE bolt of concrete light base East of the trash dumpster enclosure near the SW corner of property.

Elev: 960.19 North 1126.69 West 133.68 (from SE Cor. Sec. 29-27-18E)

MW-1	rim	958.46	North	1269.91	NE1/4,NE1/4,SE1/SE1/4
	top pipe	958.14	West	119.93	Lat= 37.66354 Long = 95.45298
MW-2	rim	958.76	North	1195.96	NE1/4,NE1/4,SE1/4,SE1/4
	top pipe	958.47	West	151.54	Lat= 37.66334 Long = 95.45310
MW-3	rim	957.82	North	1132.46	NE1/4,NE1/4,SE1/4,SE1/4
	top pipe	957.50	West	129.53	Lat= 37.66317 Long = 95.45303
MW-4	rim	959.21	North	1345.68	SE1/4,SE1/4,NE1/4,SE1/4
	top pipe	958.64	West	128.73	Lat= 37.66375 Long = 95.45301
MW-5	rim	958.37	North	1259.51	NE1/4,NE1/4,SE1/4,SE1/4
	top pipe	958.04	West	38.53	Lat= 37.66351 Long = 95.45270
MW-6	rim	957.71	North	1115.14	NE1/4,NE1/4,SE1/4,SE1/4
	top pipe	957.19	West	47.10	Lat= 37.66311 Long = 95.45274
MW-7	rim	956.00	North	1307.46	NE1/4,NE1/4,SE1/4,SE1/4
	top pipe	955.73	West	204.06	Lat= 37.66365 Long = 95.45327
MW-8	rim	954.76	North	1238.74	NE1/4,NE1/4,SE1/4,SE1/4
	top pipe	954.47	West	207.23	Lat= 37.66346 Long = 95.45329
MW-9	rim	954.10	North	1166.66	NE1/4,NE1/4,SE1/4,SE1/4
	top pipe	953.61	West	203.58	Lat= 37.66327 Long = 95.45328

Lat & Long derived from Chanute 7.5' quad map. WGS 84.

Elevation established from NGS BM H 246, NAVD 88.

If you have any questions, please feel free to call me. Thank you for the opportunity to be

