

WATER WELL RECORD (WWC-5)

KOLAR DOC ID _____ WELL ID _____
 Original Record Correction Change in Well Use

LOCATION OF WATER WELL

Latitude		Longitude		Section		Township		Range		E W	Fraction	¼	¼	¼
Datum		Elevation		County										

WATER WELL OWNER

Name	
Business	
Address	
Well location	
at owner's address	

WELL WATER USE

--

COMPLETION

Depth of completed well: _____ ft.
Depth(s) groundwater encountered:
(1) _____ ft.; (2) _____ ft.;
(3) _____ ft.; (4) dry well
Static water level in well: _____ ft.
measured below land surface
on (mm/dd/yy): _____
measured above land surface
on (mm/dd/yy): _____
Estimated yield: _____ gpm
Water level was: _____ ft. after _____ hours
pumping _____ gpm
Pump installed? Yes No
Water well disinfected? Yes No
Date disinfected (mm/dd/yy): _____
Aquifer, if known:

NEAREST SOURCE OF POTENTIAL CONTAMINATION

Source: _____
Distance from well: _____ Direction from well: _____
Source description: _____
Source: _____
Distance from well: _____ Direction from well: _____
Source description: _____
No potential source of contamination within 100 feet.

CONSTRUCTION

Borehole interval:	Borehole diameter:
from _____ to _____ ft.	_____ in.
from _____ to _____ ft.	_____ in.
Casing height above land surface: _____ in.	
If casing height is less than 12 in. has a variance been approved?*	
Yes No	
*variance not required for monitoring or environmental remediation wells	
Casing type: _____	
Blank casing interval: _____ ft. to _____ ft.	
Blank casing diameter: _____ in.	
Casing joints: _____	
Weight: _____ lbs/ft.	
Wall thickness or gauge no.: _____	
Blank casing interval: _____ ft. to _____ ft.	
Blank casing diameter: _____ in.	
Casing joints: _____	
Weight: _____ lbs/ft.	
Wall thickness or gauge no.: _____	
Grout interval: _____ ft. to _____ ft.	
Grout material: _____	
Grout interval: _____ ft. to _____ ft.	
Grout material: _____	
Screen / perforation material: _____	
Screen / perforation openings: _____	
Screen / perforation intervals:	
From _____ ft. to _____ ft.	
Slot size _____ unit _____	
From _____ ft. to _____ ft.	
Slot size _____ unit _____	
Gravel pack intervals:	
Gravel pack not used: Gravel size _____ in	
From _____ ft. to _____ ft.	
Gravel pack not used: Gravel size _____ in	
From _____ ft. to _____ ft.	

PERMIT & ID NUMBERS (AS REQUIRED)

DWR Application No.: _____
KDHE / EPA Project Code: _____
Site Name: _____
KDHE UIC Class V Form Completed: Yes No
County Permit: Yes No Permit ID: _____
Lease Name & Well #: _____
of boreholes: _____ # of dewatering wells: _____

LITHOLOGIC LOG

FROM	TO	LITHOLOGY INTERVALS

COMMENTS

--

CONTRACTOR'S OR LANDOWNERS CERTIFICATION

This water well was constructed reconstructed pursuant to the stated water well contractor's license and was completed on _____. I certify that this record is true to the best of my knowledge and belief. This water well record was completed on _____ under the business name of _____, Kansas Water Well Contractor's License No. _____ under the authority of the designated person as defined in K.A.R. 28-30-2(j) and signed and certified by the electronic signature of the designated person at its submittal: _____.

Send one copy to WATER WELL OWNER and retain one for your records. Fee of \$5.00 for each constructed well.

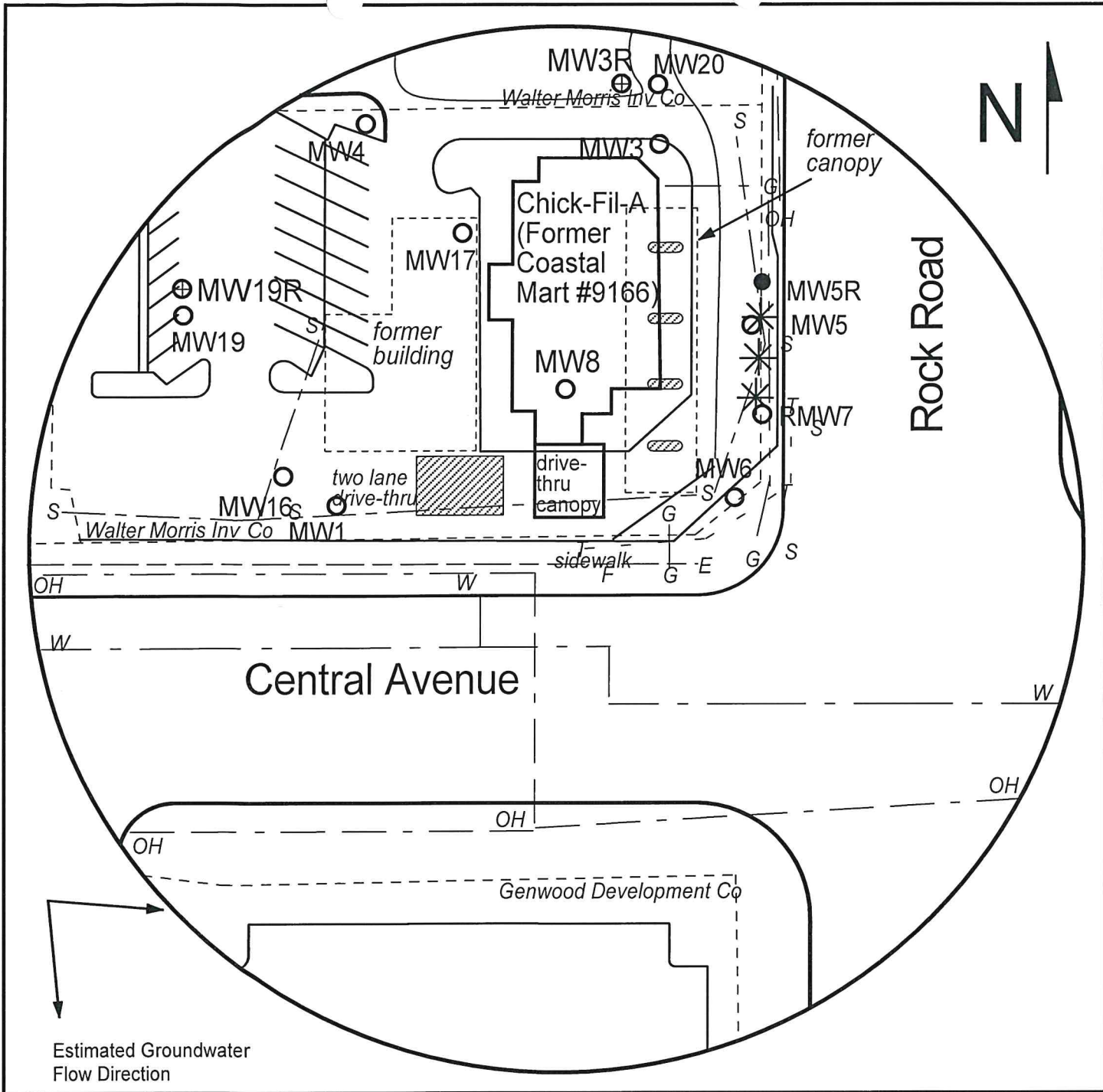

FIGURE 2 - DETAILED SITE BASE MAP

LEGEND

- Approximate Location of Former UST Basin & Pump Islands
- Approximate Location of Property Line
- Existing Monitoring Well
- Plugged Well
- New Monitoring Well
- F** Fire Hydrant
- E** ——— Electric Lines (2-6 ft bgs)
- G** ——— Gas Lines (2-6 ft bgs)
- OH** ——— Overhead Lines (25'-40' high)
- S** ——— Sewer Lines (2-6 ft bgs)
- T** - - - Telephone Lines (2-6 ft bgs)
- W** ——— Water Lines (2-6 ft bgs)

NOTE: Utility depths, heights and locations are approximate.



PROJECT:
 Coastal Mart #9166
 7990 E Central
 Wichita, KS
 KDHE ID: U2-087-13081
 Date: 4/28/24



(785) 841-8707 office
 1311 E 25th St., Suite B, Lawrence, KS 66046

DENNIS L HANDKE

1820 NW 59th Terrace
TOPEKA, KANSAS 66618
785-286-4047 Home
785-286-1990 Fax

Jess Chapman
Larsen & Associates
1311 E. 25th Street, Suite B
Lawrence, Kansas, 66046

May 11, 2024

RE: Monitor Well Elevation Survey
7990 E. Central, Wichita, Kansas

Proj. 24-00T
Coastal Mart #9166
U2-087-13081

Bench Mark: Chisled Square on SE corner of concrete electrical pad at North center of property.
Elev: 1358.47 North 174.25 West 153.02 (from SE Cor. Sec. 18-27-2E)

MW-3R rim	1356.74	North	226.30	SE1/4,SE1/4,SE1/4,SE1/4
top pipe	1356.49	West	102.25	Lat= 37.69446 Long = 97.24491

MW-19R rim	1356.91	North	141.87	SE1/4,SE1/4,SE1/4,SE1/4
top pipe	1356.51	West	253.70	Lat= 37.69423 Long = 97.24543

Lat & Long derived from Andover 7.5' quad map. WGS 84.

Elevation established from existing project. NAVD 29.

If you have any questions, please feel free to call me. Thank you for the opportunity to be of service to you.

