

KANSAS CORPORATION COMMISSION  
OIL & GAS CONSERVATION DIVISION

Form ACO-4  
Form must be typed  
March 2009

**APPLICATION FOR COMMINGLING OF PRODUCTION (K.A.R. 82-3-123) OR FLUIDS (K.A.R. 82-3-123a)**      *Commingling ID #* \_\_\_\_\_

OPERATOR: License # \_\_\_\_\_ API No. 15 - \_\_\_\_\_  
Name: \_\_\_\_\_ Spot Description: \_\_\_\_\_  
Address 1: \_\_\_\_\_ - - - - - Sec. \_\_\_\_\_ Twp. \_\_\_\_\_ S. R. \_\_\_\_\_  East  West  
Address 2: \_\_\_\_\_ Feet from  North /  South Line of Section  
City: \_\_\_\_\_ State: \_\_\_\_\_ Zip: \_\_\_\_\_ + \_\_\_\_\_ Feet from  East /  West Line of Section  
Contact Person: \_\_\_\_\_ County: \_\_\_\_\_  
Phone: ( \_\_\_\_\_ ) \_\_\_\_\_ Lease Name: \_\_\_\_\_ Well #: \_\_\_\_\_

1. Name and upper and lower limit of each production interval to be commingled:  
Formation: \_\_\_\_\_ (Perfs): \_\_\_\_\_  
Formation: \_\_\_\_\_ (Perfs): \_\_\_\_\_  
Formation: \_\_\_\_\_ (Perfs): \_\_\_\_\_  
Formation: \_\_\_\_\_ (Perfs): \_\_\_\_\_  
Formation: \_\_\_\_\_ (Perfs): \_\_\_\_\_

2. Estimated amount of fluid production to be commingled from each interval:  
Formation: \_\_\_\_\_ BOPD: \_\_\_\_\_ MCFPD: \_\_\_\_\_ BWPD: \_\_\_\_\_  
Formation: \_\_\_\_\_ BOPD: \_\_\_\_\_ MCFPD: \_\_\_\_\_ BWPD: \_\_\_\_\_  
Formation: \_\_\_\_\_ BOPD: \_\_\_\_\_ MCFPD: \_\_\_\_\_ BWPD: \_\_\_\_\_  
Formation: \_\_\_\_\_ BOPD: \_\_\_\_\_ MCFPD: \_\_\_\_\_ BWPD: \_\_\_\_\_  
Formation: \_\_\_\_\_ BOPD: \_\_\_\_\_ MCFPD: \_\_\_\_\_ BWPD: \_\_\_\_\_

3. Plat map showing the location of the subject well, all other wells on the subject lease, and all wells on offsetting leases within a 1/2 mile radius of the subject well, and for each well the names and addresses of the lessee of record or operator.

4. Signed certificate showing service of the application and affidavit of publication as required in K.A.R. 82-3-135a.

**For Commingling of PRODUCTION ONLY, include the following:**

- 5. Wireline log of subject well. Previously Filed with ACO-1:  Yes  No
- 6. Complete Form ACO-1 (*Well Completion form*) for the subject well.

**For Commingling of FLUIDS ONLY, include the following:**

- 7. Well construction diagram of subject well.
- 8. Any available water chemistry data demonstrating the compatibility of the fluids to be commingled.

**AFFIDAVIT:** I am the affiant and hereby certify that to the best of my current information, knowledge and personal belief, this request for commingling is true and proper and I have no information or knowledge, which is inconsistent with the information supplied in this application.

**Submitted Electronically**

**KCC Office Use Only**  
 Denied  Approved  
15-Day Periods Ends: \_\_\_\_\_  
Approved By: \_\_\_\_\_ Date: \_\_\_\_\_

*Protests may be filed by any party having a valid interest in the application. Protests must be in writing and comply with K.A.R. 82-3-135b and must be filed within 15 days of publication of the notice of application.*



The Beaufort Gazette  
 The Belleville News-Democrat  
 Bellingham Herald  
 Centre Daily Times  
 Sun Herald  
 Idaho Statesman  
 Bradenton Herald  
 The Charlotte Observer  
 The State  
 Ledger-Enquirer

Durham | The Herald-Sun  
 Fort Worth Star-Telegram  
 The Fresno Bee  
 The Island Packet  
 The Kansas City Star  
 Lexington Herald-Leader  
 The Telegraph - Macon  
 Merced Sun-Star  
 Miami Herald  
 El Nuevo Herald

The Modesto Bee  
 The Sun News - Myrtle Beach  
 Raleigh News & Observer  
 Rock Hill | The Herald  
 The Sacramento Bee  
 San Luis Obispo Tribune  
 Tacoma | The News Tribune  
 Tri-City Herald  
 The Wichita Eagle  
 The Olympian

## AFFIDAVIT OF PUBLICATION

Account #	Order Number	Identification	Order PO	Amount	Cols	Depth
24452	534733	Print Legal Ad-IPL01657900 - IPL0165790		\$246.92	1	37 L

**Attention:** Karen Hopper  
 RITCHIE EXPLORATION INC  
 P O BOX 783188  
 WICHITA, KS 672783188

khopper@ritchie-exp.com

**LEGAL NOTICE**

You, and each of you, are hereby notified that Ritchie Exploration, Inc. has filed an application to commence the commingling of production from the Lansing/Kansas City and Arbuckle sources of supply for the #3 Wyrill 19A well located approx. W of S/2 NW NE of Section 19-6S-201W, Rooks County, Kansas.

Any persons who object to or protest this application shall be required to file their objections or protests with the Conservation Division of the State Corporation Commission of the State of Kansas within fifteen (15) days from the date of the publication. These protests shall be filed pursuant to Commission regulations and must state specific reasons why the grant of the application may cause waste, violate correlative rights or pollute the natural resources of the state of Kansas.

If no protests are received, this application may be granted through a summary proceeding. If valid protests are received, this matter will be set for hearing.

All persons interested or concerned shall take notice of the foregoing and shall govern themselves accordingly.

RITCHIE EXPLORATION, INC.  
 P.O. Box 783188  
 Wichita, KS 67278-3188  
 (316) 691-9500  
 IPL0165790  
 Mar 26 2024

In The STATE OF KANSAS  
 In and for the County of Sedgwick

1 insertion(s) published on:  
 03/26/24

STATE OF KANSAS)

SS

County of Sedgwick)

Mary Castro, of lawful age, being first duly sworn, depose and saith: That he is Record Clerk of The Wichita Eagle, a daily newspaper published in the City of Wichita, County of Sedgwick, State of Kansas, and having a general paid circulation on a daily basis in said County, which said newspaper has been continuously and uninterruptedly published in said County for more than one year prior to the first publication of the notice hereinafter mentioned, and which said newspaper has been entered as second class mail matter at the United States Post Office in Wichita, Kansas, and which said newspaper is not a trade, religious or fraternal publication and that a notice of a true copy is hereto attached was published in the regular and entire Morning issue of said The Wichita Eagle from 03/26/2024 to 03/26/2024.

*Mary Castro*

I certify (or declare) under penalty of perjury that the foregoing is true and correct.  
 DATED: 04/19/2024

*Stephanie Hatcher*

Notary Public in and for the state of Texas, residing in Dallas County

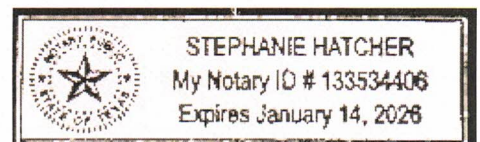

Extra charge for lost or duplicate affidavits.  
 Legal document please do not destroy!

STATE OF KANSAS

Rooks

COUNTY

SS. Affidavit of Publication

Frank Mercer, being first duly sworn, deposes and says: That he is publisher of the Plainville Times, a weekly newspaper printed in the State of Kansas, and published in and of general circulation in Rooks County, Kansas, with a general paid circulation on a weekly basis in Rooks County, Kansas, and that said newspaper is not a trade, religious or fraternal publication.

Said newspaper is a weekly published one day a week and has been published continuously and uninterruptedly in said county and state for a period of more than five years prior to the first publication of said notice; and has been admitted at the post office of Plainville, Kansas, in said county as second class matter.

That the attached notice is a true copy thereof and was published in the regular and entire issue of said newspaper for one consecutive week, the first publication thereof being made as aforesaid on the 28th day of March, 2024, with subsequent publications being made on the following dates:

Three lines for dates: \_\_\_\_\_, 20\_\_\_\_, \_\_\_\_\_, 20\_\_\_\_, \_\_\_\_\_, 20\_\_\_\_

Signed: [Signature]

Subscribed and sworn to before me this 28th day of March, 2024.

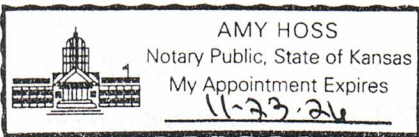

[Signature] Notary Public's Signature

Publication Fee \$ 58.05
Affidavit, Notary's Fee \$ 1.00
Additional copies @ \$ ~

LEGAL NOTICE (Published in the Plainville Times, March 28, 2024) 11

You, and each of you, are hereby notified that Ritchie Exploration, Inc. has filed an application to commence the commingling of production from the Lansing/Kansas City and Arbuckle sources of supply for the #3 Wyrill 19A well located approx. W of S/2 NW NE of Section 19-6S-20W, Rooks County, Kansas.

Any persons who object to or protest this application shall be required to file their objections or protests with the Conservation Division of the State Corporation Commission of the State of Kansas within fifteen (15) days from the date of the publication. These protests shall be filed pursuant to Commission regulations and must state specific reasons why the grant of the application may cause waste, violate correlative rights or pollute the natural resources of the state of Kansas. If no protests are received, this application may be granted through a summary proceeding. If valid protests are received, this matter will be set for hearing.

All persons interested or concerned shall take notice of the foregoing and shall govern themselves accordingly.

RITCHIE EXPLORATION, INC.
P.O. Box 783188
Wichita, KS. 67278-3188
(316) 691-9500

AFFIDAVIT OF PUBLICATION

STATE OF KANSAS, ROOKS COUNTY: ss:

ROBERT L. HAMILTON, being first duly sworn, deposes and says: That he is the publisher of the STOCKTON SENTINEL, a weekly newspaper printed in the State of Kansas, and published in and of general circulation in Rooks County, Kansas, with a general paid circulation on a weekly basis in Rooks County, Kansas, and that said newspaper is not a trade, religious or fraternal publication.

Said newspaper is a weekly published at least weekly 50 times a year; and has been admitted at the post office of Stockton, Kansas, in said County as second class matter.

That the attached notice is a true copy thereof and was published in the regular and entire issue of said newspaper one consecutive week(s), the first publication thereof being made as aforesaid on the 28<sup>th</sup> day of March, 2024, with subsequent publication being made on the following dates:

\_\_\_\_\_, 20\_\_\_\_, \_\_\_\_\_, 20\_\_\_\_  
\_\_\_\_\_, 20\_\_\_\_, \_\_\_\_\_, 20\_\_\_\_  
\_\_\_\_\_, 20\_\_\_\_, \_\_\_\_\_, 20\_\_\_\_

*Robert L. Hamilton*

Subscribed and sworn to before me this 28<sup>th</sup> day of March, 2024

*Bart A. Hamilton*  
\_\_\_\_\_  
- Clerk of the District Court / Notary Public

My Commission Expires: 01-30-2028

Printer's Fees: \$ 29<sup>32</sup>

Additional Copies: \$ \_\_\_\_\_

**PUBLIC NOTICE**

You, and each of you, are hereby notified that Ritchie Exploration, Inc. has filed an application to commence the commingling of production from the Lansing/Kansas City and Arbuckle sources of supply for the #3 Wyrill 19A well located approx. W of S/2 NW NE of Section 19-6S-20W, Rooks County, Kansas.

Any persons who object to or protest this application shall be required to file their objections or protests with the Conservation Division of the State Corporation Commission of the State of Kansas within fifteen (15) days from the date of the publication. These protests shall be filed pursuant to Commission regulations and must state specific reasons why the grant of the application may cause waste, violate correlative rights or pollute the natural resources of the state of Kansas.

If no protests are received, this application may be granted through a summary proceeding. If valid protests are received, this matter will be set for hearing.

All persons interested or concerned shall take notice of the foregoing and shall govern themselves accordingly.

RITCHIE EXPLORATION, INC.  
P.O. Box 783188  
Wichita, KS 67278-3188  
(316)691-9500  
(First Published in the Stockton Sentinel March 28, 2024—11)

 **BART A. HAMILTON**  
Notary Public - State of Kansas  
My Appt. Expires 01-30-2028

# APPLICATION FOR COMMINGLING OF PRODUCTION OR FLUIDS

## Operator, Lessee or Unleased Mineral Owner within a ½ mile radius of Ritchie Exploration, Inc.'s

**#3 Wyrill 19A  
1,053' FNL & 2,092' FEL  
Section 19-6S-20W  
Rooks Co., KS**

### Township 6 South, Range 20 West

Section 17:	SW/4, less a 1-acre square in SE/c SW/4	David Layne Manuel 2310 Soyaris Circle Ruston, LA 71270	Mineral Owner
Section 18:	S/2	Phillip Craig Brumbaugh Revocable Trust, dated 9/28/2010 Phillip Craig Brumbaugh & Barbara A. Brumbaugh, Trustees 320 3 Road Logan, KS 67646	Mineral Owner
Section 19:	NE/4	Ritchie Exploration, Inc. PO Box 783188 Wichita, KS 67278-3188	Operator: #1 Wyrill 19A, #3 Wyrill 19A
		Wyrill Farming, Inc. PO Box 166 Kirwin, KS 67644	Surface/Mineral Owner
	NW/4, SE/4	Wyrill Farming, Inc.	Mineral Owners
	SW/4	States Ag., L.P. Alan E. States, President of States, Inc., Managing Partner 921 W. Main Street Logan, KS 67646	Mineral Owner
Section 20:	N/2NW/4	Bach Oil Production, Inc. PO Box 723 Alma, NE 68920	Operator: #1 Wyrill Farms, #2 Wyrill Farms
	S/2NW/4	DaMar Development Co. a Partnership PO Box 70 Hays, KS 67601	Lessee
	SW/4	Wyrill Farming, Inc.	Mineral Owner

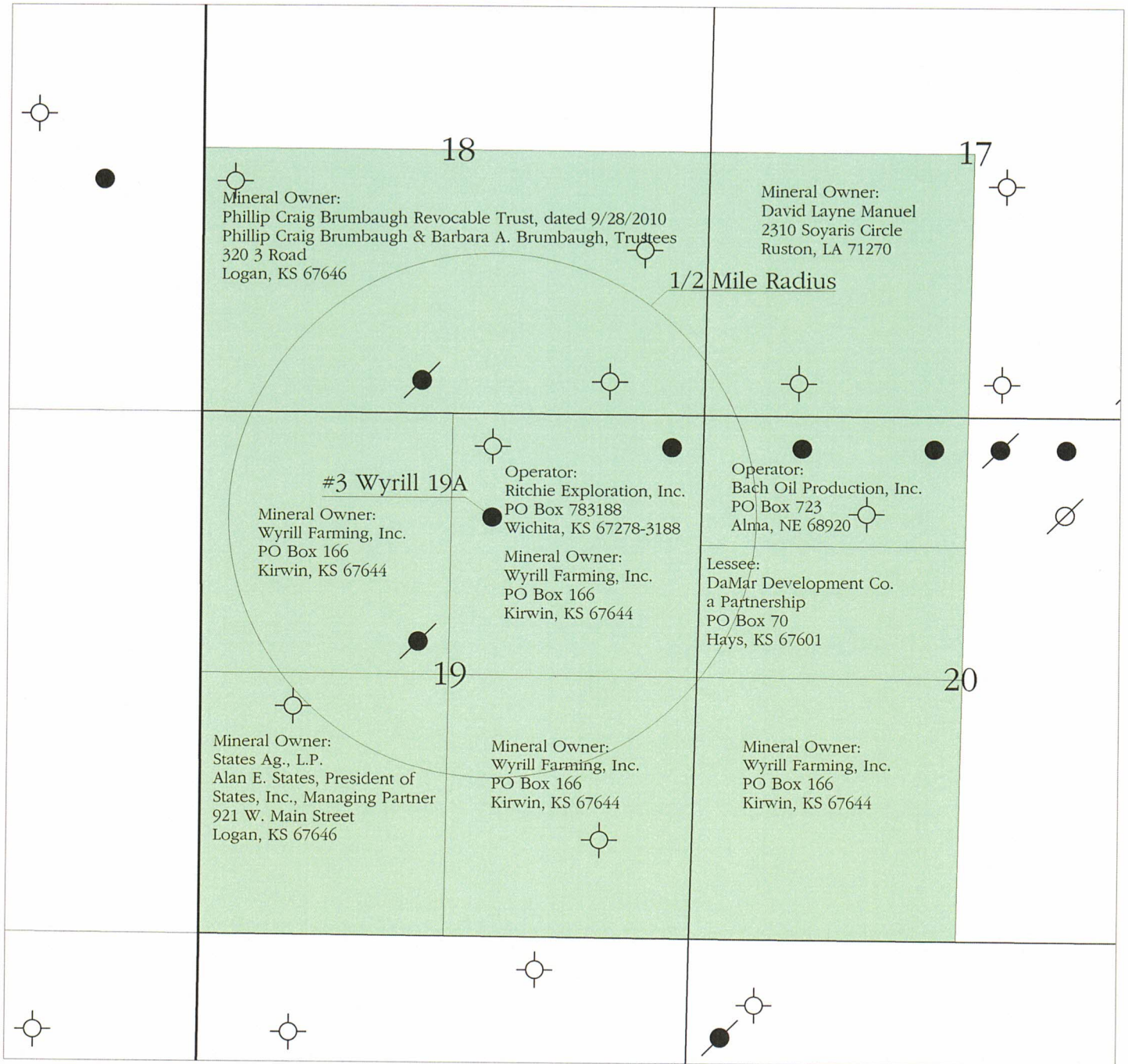

Legend

- Oil Well
- / Abandoned Oil Well
- ⊕ Dry and Abandoned Well



ACO-4: Application  
for Commingling of  
Production or Fluids

Applicant Well: #3 Wyrill 19A  
API: 15-163-24446-0000

All Wells on Offsetting Leases within a 1/2 Mile Radius  
Name and Address of Lessee of Record, Operator, or  
Unleased Mineral Owner

Rooks County, Kansas

Prepared By:  
Justin Clegg

Scale:  
1 : 18,000

Date:  
March 12, 2024

**AFFIDAVIT**

STATE OF KANSAS        )  
                                      - SS.  
County of Sedgwick        )

Peter Fiorini, of lawful age, being first duly sworn, depose and saith: That he is Vice President/Production/Geologist of Ritchie Exploration, County of Sedgwick, State of Kansas, and that notice was given to all lessee of record or operator within ½ mile radius of the Wyrill 19A #3 well located in the County of Rooks (see attached plat map). This notice included a letter and a copy of the Commingle Application (ACO-4). All notices were mailed on March 21, 2024.

made as aforesaid on the 21<sup>st</sup> of

**March A.D. 2024**

And affiant further says that he has personal knowledge of the statements above set forth and that they are true.

  
\_\_\_\_\_

Subscribed and sworn to before me this

**21<sup>st</sup> day of March 2024**

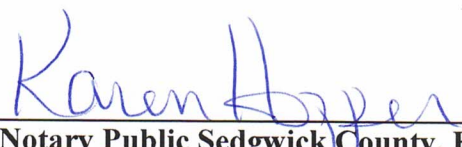
  
\_\_\_\_\_  
Notary Public Sedgwick County, Kansas



Conservation Division  
266 N. Main St., Ste. 220  
Wichita, KS 67202-1513



Phone: 316-337-6200  
Fax: 316-337-6211  
<http://kcc.ks.gov/>

Andrew J. French, Chairperson  
Dwight D. Keen, Commissioner  
Annie Kuether, Commissioner

Laura Kelly, Governor

August 28, 2024

Peter Fiorini  
Ritchie Exploration, Inc.  
P.O. Box 783188  
Wichita, KS 67278-3188

RE: Approved Commingling CO082401  
Wyrill 19A 3  
API No. 15-163-24446-00-00

Dear Mr. Fiorini:

Your Application for Commingling (ACO-4) for the above described well has been reviewed and approved by the Kansas Corporation Commission (KCC) per K.A.R. 82-3-123. Notice was examined and found to be proper per K.A.R. 82-3-135a. No protest had been filed within the 15-day protest period.

Based upon the depth of the Arbuckle formation perforations, total oil production shall not exceed 100 BOPD and total gas production shall not exceed 50% of the absolute open flow (AOF).

Sincerely,

Production Department Supervisor