

Confidentiality Requested:

Yes  No

KANSAS CORPORATION COMMISSION  
OIL & GAS CONSERVATION DIVISION

Form ACO-1

January 2018

Form must be Typed

Form must be Signed

All blanks must be Filled

WELL COMPLETION FORM  
WELL HISTORY - DESCRIPTION OF WELL & LEASE

OPERATOR: License # \_\_\_\_\_

Name: \_\_\_\_\_

Address 1: \_\_\_\_\_

Address 2: \_\_\_\_\_

City: \_\_\_\_\_ State: \_\_\_\_\_ Zip: \_\_\_\_\_ + \_\_\_\_\_

Contact Person: \_\_\_\_\_

Phone: ( \_\_\_\_\_ ) \_\_\_\_\_

CONTRACTOR: License # \_\_\_\_\_

Name: \_\_\_\_\_

Wellsite Geologist: \_\_\_\_\_

Purchaser: \_\_\_\_\_

Designate Type of Completion:

New Well  Re-Entry  Workover

Oil  WSW  SWD

Gas  DH  EOR

OG  GSW

CM (Coal Bed Methane)

Cathodic  Other (Core, Expl., etc.): \_\_\_\_\_

If Workover/Re-entry: Old Well Info as follows:

Operator: \_\_\_\_\_

Well Name: \_\_\_\_\_

Original Comp. Date: \_\_\_\_\_ Original Total Depth: \_\_\_\_\_

Deepening  Re-perf.  Conv. to EOR  Conv. to SWD

Plug Back  Liner  Conv. to GSW  Conv. to Producer

Commingled Permit #: \_\_\_\_\_

Dual Completion Permit #: \_\_\_\_\_

SWD Permit #: \_\_\_\_\_

EOR Permit #: \_\_\_\_\_

GSW Permit #: \_\_\_\_\_

Spud Date or Date Reached TD Completion Date or Recompletion Date

API No.: \_\_\_\_\_

Spot Description: \_\_\_\_\_

\_\_\_\_\_ - \_\_\_\_\_ - \_\_\_\_\_ Sec. \_\_\_\_\_ Twp. \_\_\_\_\_ S. R. \_\_\_\_\_  East  West

\_\_\_\_\_ Feet from  North /  South Line of Section

\_\_\_\_\_ Feet from  East /  West Line of Section

Footages Calculated from Nearest Outside Section Corner:

NE  NW  SE  SW

GPS Location: Lat: \_\_\_\_\_, Long: \_\_\_\_\_  
(e.g. xx.xxxxx) (e.g. -xxx.xxxxx)

Datum:  NAD27  NAD83  WGS84

County: \_\_\_\_\_

Lease Name: \_\_\_\_\_ Well #: \_\_\_\_\_

Field Name: \_\_\_\_\_

Producing Formation: \_\_\_\_\_

Elevation: Ground: \_\_\_\_\_ Kelly Bushing: \_\_\_\_\_

Total Vertical Depth: \_\_\_\_\_ Plug Back Total Depth: \_\_\_\_\_

Amount of Surface Pipe Set and Cemented at: \_\_\_\_\_ Feet

Multiple Stage Cementing Collar Used?  Yes  No

If yes, show depth set: \_\_\_\_\_ Feet

If Alternate II completion, cement circulated from: \_\_\_\_\_

feet depth to: \_\_\_\_\_ w/ \_\_\_\_\_ sx cmt.

Drilling Fluid Management Plan

(Data must be collected from the Reserve Pit)

Chloride content: \_\_\_\_\_ ppm Fluid volume: \_\_\_\_\_ bbls

Dewatering method used: \_\_\_\_\_

Location of fluid disposal if hauled offsite:

Operator Name: \_\_\_\_\_

Lease Name: \_\_\_\_\_ License #: \_\_\_\_\_

Quarter \_\_\_\_\_ Sec. \_\_\_\_\_ Twp. \_\_\_\_\_ S. R. \_\_\_\_\_  East  West

County: \_\_\_\_\_ Permit #: \_\_\_\_\_

AFFIDAVIT

I am the affiant and I hereby certify that all requirements of the statutes, rules and regulations promulgated to regulate the oil and gas industry have been fully complied with and the statements herein are complete and correct to the best of my knowledge.

Submitted Electronically

KCC Office Use ONLY

Confidentiality Requested

Date: \_\_\_\_\_

Confidential Release Date: \_\_\_\_\_

Wireline Log Received  Drill Stem Tests Received

Geologist Report / Mud Logs Received

UIC Distribution

ALT  I  II  III Approved by: \_\_\_\_\_ Date: \_\_\_\_\_

Operator Name: \_\_\_\_\_ Lease Name: \_\_\_\_\_ Well #: \_\_\_\_\_

Sec. \_\_\_\_\_ Twp. \_\_\_\_\_ S. R. \_\_\_\_\_  East  West County: \_\_\_\_\_

**INSTRUCTIONS:** Show important tops of formations penetrated. Detail all cores. Report all final copies of drill stems tests giving interval tested, time tool open and closed, flowing and shut-in pressures, whether shut-in pressure reached static level, hydrostatic pressures, bottom hole temperature, fluid recovery, and flow rates if gas to surface test, along with final chart(s). Attach extra sheet if more space is needed.

Final Radioactivity Log, Final Logs run to obtain Geophysical Data and Final Electric Logs must be emailed to [kcc-well-logs@kcc.ks.gov](mailto:kcc-well-logs@kcc.ks.gov). Digital electronic log files must be submitted in LAS version 2.0 or newer AND an image file (TIFF or PDF).

Drill Stem Tests Taken <input type="checkbox"/> Yes <input type="checkbox"/> No <i>(Attach Additional Sheets)</i>  Samples Sent to Geological Survey <input type="checkbox"/> Yes <input type="checkbox"/> No  Cores Taken <input type="checkbox"/> Yes <input type="checkbox"/> No Electric Log Run <input type="checkbox"/> Yes <input type="checkbox"/> No Geologist Report / Mud Logs <input type="checkbox"/> Yes <input type="checkbox"/> No  List All E. Logs Run:	<input type="checkbox"/> Log Formation (Top), Depth and Datum <input type="checkbox"/> Sample  Name Top Datum
--	---

CASING RECORD <input type="checkbox"/> New <input type="checkbox"/> Used							
Report all strings set-conductor, surface, intermediate, production, etc.							
Purpose of String	Size Hole Drilled	Size Casing Set (In O.D.)	Weight Lbs. / Ft.	Setting Depth	Type of Cement	# Sacks Used	Type and Percent Additives

ADDITIONAL CEMENTING / SQUEEZE RECORD				
Purpose:	Depth Top Bottom	Type of Cement	# Sacks Used	Type and Percent Additives
<input type="checkbox"/> Perforate <input type="checkbox"/> Protect Casing <input type="checkbox"/> Plug Back TD <input type="checkbox"/> Plug Off Zone				

1. Did you perform a hydraulic fracturing treatment on this well?  Yes  No *(If No, skip questions 2 and 3)*
2. Does the volume of the total base fluid of the hydraulic fracturing treatment exceed 350,000 gallons?  Yes  No *(If No, skip question 3)*
3. Was the hydraulic fracturing treatment information submitted to the chemical disclosure registry?  Yes  No *(If No, fill out Page Three of the ACO-1)*

Date of first Production/Injection or Resumed Production/Injection:	Producing Method: <input type="checkbox"/> Flowing <input type="checkbox"/> Pumping <input type="checkbox"/> Gas Lift <input type="checkbox"/> Other <i>(Explain)</i> _____				
Estimated Production Per 24 Hours	Oil Bbls.	Gas Mcf	Water Bbls.	Gas-Oil Ratio	Gravity

DISPOSITION OF GAS: <input type="checkbox"/> Vented <input type="checkbox"/> Sold <input type="checkbox"/> Used on Lease <i>(If vented, Submit ACO-18.)</i>	METHOD OF COMPLETION: <input type="checkbox"/> Open Hole <input type="checkbox"/> Perf. <input type="checkbox"/> Dually Comp. <input type="checkbox"/> Commingled <i>(Submit ACO-5)</i> <i>(Submit ACO-4)</i>	PRODUCTION INTERVAL: Top Bottom
---	---	------------------------------------

Shots Per Foot	Perforation Top	Perforation Bottom	Bridge Plug Type	Bridge Plug Set At	Acid, Fracture, Shot, Cementing Squeeze Record <i>(Amount and Kind of Material Used)</i>

TUBING RECORD:	Size:	Set At:	Packer At:	
----------------	-------	---------	------------	--





**GEOLOGIST'S REPORT** DRILLING TIME AND SAMPLE LOG

COMPANY CASTLE RESOURCES INC.

LEASE KENNEDY #1

FIELD \_\_\_\_\_

LOCATION T160FSL 925FWL

SEC 32 TWP 8S RGE 27W

COUNTY SHERIDAN STATE KS.

CONTRACTOR WHITE KNIGHT DRLG.

SPUD 5-30-24 COMP 6-6-24

RTD 3990 LTD 3990

MUD UP 3300' TYPE MUD CHEM.

SAMPLES SAVED FROM 3300' TO TD.

DRILLING TIME KEPT FROM 3300' TO TD.

SAMPLES EXAMINED FROM 3300' TO TD.

GEOLOGICAL SUPERVISION FROM 3300' TO TD.

GEOLOGIST ON WELL 3300'

FORMATION TOPS	LOG	SAMPLES
ANHY.	2198-2281	3692202-36 365
HIEBNER	3672-1105	3670-1103
TORONTO	3693-1126	3692-1125
LKC	3709-1142	3706-1139
BKC.	3936-1369	3932-1365
RTD.	3990-1423	3990-1423

ELEVATIONS

KB 2567

DF \_\_\_\_\_

GL 2562

Measurements Are All From \_\_\_\_\_

CASING \_\_\_\_\_

SURFACE @ 207

PRODUCTION \_\_\_\_\_

ELECTRICAL SURVEYS \_\_\_\_\_

STACK/MICRO \_\_\_\_\_

REMARKS

**LEGEND**

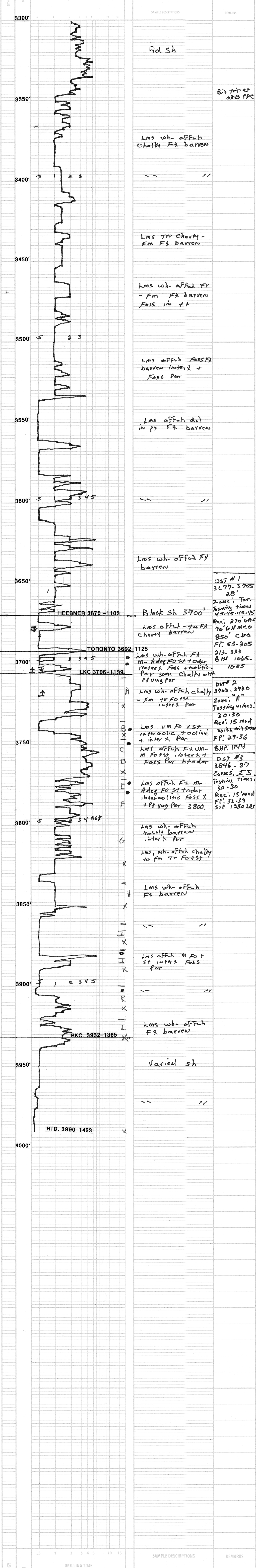
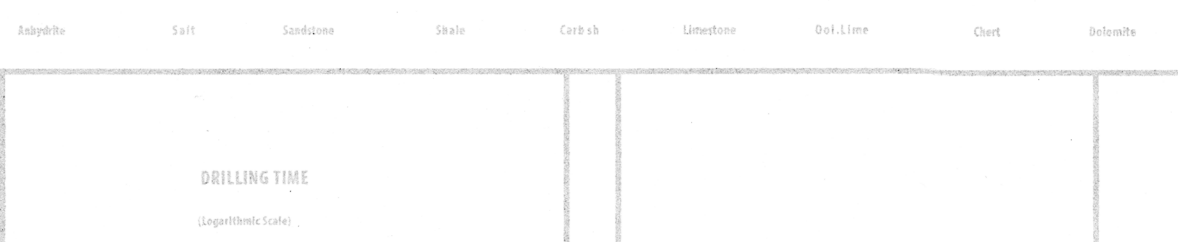









# FRANKS Oilfield Service

◆ 815 Main Street Victoria, KS 67671 ◆ 24 Hour Phone (785) 639-7269  
 ◆ Office Phone (785) 639-3949 ◆ Email: franksoilfield@yahoo.com

TICKET NUMBER 1257  
 LOCATION HOXXE  
 FOREMAN Tom Williams

## FIELD TICKET & TREATMENT REPORT CEMENT

DATE	CUSTOMER #	WELL NAME & NUMBER	SECTION	TOWNSHIP	RANGE	COUNTY
10-20-24	9969	Kennedy V	32	8	27	Sheridan
CUSTOMER <u>Castle Resources</u>			TRUCK #			
MAILING ADDRESS			DRIVER			
CITY			TRUCK #			
STATE			DRIVER			
ZIP CODE			TRUCK #			
			DRIVER			

JOB TYPE Port Collier HOLE SIZE \_\_\_\_\_ HOLE DEPTH \_\_\_\_\_ CASING SIZE & WEIGHT \_\_\_\_\_  
 CASING DEPTH \_\_\_\_\_ DRILL PIPE \_\_\_\_\_ TUBING \_\_\_\_\_ OTHER \_\_\_\_\_  
 SLURRY WEIGHT \_\_\_\_\_ SLURRY VOL \_\_\_\_\_ WATER gal/sk \_\_\_\_\_ CEMENT LEFT in CASING \_\_\_\_\_  
 DISPLACEMENT \_\_\_\_\_ DISPLACEMENT PSI \_\_\_\_\_ MIX PSI \_\_\_\_\_ RATE \_\_\_\_\_

REMARKS: Safety meeting & set up on well.  
Crew set plug at 2900' - circulate oil out of hole & spot  
2-600s sand. Spilled up & found port collar. Spot gel at port collar  
Pressure up & spot gel. Opened port collar. Lost pressure. Mixed  
180s & lost circulation? Pump another 20 s to empty tub. Spill on  
circulation. Shut valve & wasted 30 min. Displace cement w/ 10 BBL  
. Spot port collar & ran T joints. Washed down. Shut down to run  
& survey tool to see where cement was.  
Back up & moved on. Thanks Tom & crew

ACCOUNT CODE	QUANTITY or UNITS	DESCRIPTION of SERVICES or PRODUCT	UNIT PRICE	TOTAL
PL003	1	PUMP CHARGE <u>Port Collier 2197'</u>	\$1150.00	\$1150.00
M001	8	MILEAGE	\$65.00	\$520.00
M002	9.2 tons	Trip Mileage Delivery	\$600.00	\$5480.00
CB021	200 sk	60/40 89 gal 1/4" Stoscol	\$179.50	\$3590.00
CP017	100 lbs	sand	\$7.50	\$750.00
CP003	500 lbs	gel	\$1.30	\$650.00
			subtotal	\$5592.00
			less 5% disc.	\$5312.40
			subtotal	\$5312.40
			SALES TAX	306.04
			ESTIMATED TOTAL	5618.44

AUTHORIZATION \_\_\_\_\_ TITLE \_\_\_\_\_ DATE \_\_\_\_\_

I acknowledge that the payment terms, unless specifically amended in writing on the front of the form or in the customer's account records, at our office, and conditions of service on the back of this form are in effect for services identified on this form.



# FRANKS Oilfield Service

◆ 815 Main Street Victoria, KS 67671 ◆ 24 Hour Phone (785) 639-7269  
 ◆ Office Phone (785) 639-3949 ◆ Email: franksoilfield@yahoo.com

TICKET NUMBER 1258  
 LOCATION Hoxie  
 FOREMAN Tom Williams

## FIELD TICKET & TREATMENT REPORT CEMENT

DATE	CUSTOMER #	WELL NAME & NUMBER	SECTION	TOWNSHIP	RANGE	COUNTY
6-21-24	9460	Kennedy 1	32	S	27	Shelby
CUSTOMER <u>Castle Resources</u>			TRUCK #			
MAILING ADDRESS			DRIVER			
CITY			TRUCK #			
STATE			DRIVER			
ZIP CODE			TRUCK #			
			DRIVER			

JOB TYPE Port collar HOLE SIZE \_\_\_\_\_ HOLE DEPTH \_\_\_\_\_ CASING SIZE & WEIGHT \_\_\_\_\_  
 CASING DEPTH \_\_\_\_\_ DRILL PIPE \_\_\_\_\_ TUBING \_\_\_\_\_ OTHER port - 1550'  
 SLURRY WEIGHT \_\_\_\_\_ SLURRY VOL \_\_\_\_\_ WATER gal/sk \_\_\_\_\_ CEMENT LEFT in CASING \_\_\_\_\_  
 DISPLACEMENT \_\_\_\_\_ DISPLACEMENT PSI \_\_\_\_\_ MIX PSI \_\_\_\_\_ RATE \_\_\_\_\_

REMARKS: Safety meeting + set up on well. Rig crew non planed 1455' set pkr + put 500 lbs on back side. Pump 30 Bbls + had no flow on annulus. Mixed 25% 39ack + squeezed off eye port at 1550', 30 min hold - released pressure. Crew pulled out pkr. Perforated 1340' Ran pkr to 1200' lost circulation around annulus. Mix 350% + lost circulation. Mix 30% 39ack + displaced 9.5 Bbl. Stage on it for 45 min - hold - bleed off. Washed around pkr. Rock up + move off.

*Thanks Tom Williams*

ACCOUNT CODE	QUANTITY or UNITS	DESCRIPTION of SERVICES or PRODUCT	UNIT PRICE	TOTAL
PUMP		PUMP CHARGE	\$1150.00	\$1150.00
MILE	4	MILEAGE	\$12.50	\$50.00
MILE	15.94	ton Mileage Delivery	\$38.00	\$607.72
CR002	3054	Class A 39ack	\$24.55	\$7496.50
CR021	38034	60/40 89ack 1/4" 5/16" steel	\$17.95	\$6821.53
			subtotal	\$9,359.50
			less 5% disc	\$467.97
			subtotal	\$8,891.53
			SALES TAX	610.27
			ESTIMATED TOTAL	9501.80

AUTHORIZATION \_\_\_\_\_ TITLE \_\_\_\_\_ DATE \_\_\_\_\_

I acknowledge that the payment terms, unless specifically amended in writing on the front of the form or in the customer's account records, at our office, and conditions of service on the back of this form are in effect for services identified on this form.



## DRILL STEM TEST REPORT

Prepared For: **Castle Resources Inc**

P.O. Box 583  
Russell, KS 67665

ATTN: Jerry Green

### **Kennedy #1**

#### **32-8S.-27W. Sheridan, KS**

Start Date: 2024.06.04 @ 17:40:00

End Date: 2024.06.05 @ 02:07:39

Job Ticket #: 71804                      DST #: 1

Trilobite Testing, Inc

PO Box 362 Hays, KS 67601

ph: 785-625-4778 fax: 785-625-5620

Printed: 2024.06.07 @ 09:42:34



**TRILOBITE TESTING, INC**

# DRILL STEM TEST REPORT

Castle Resources Inc

**32-8S.-27W. Sheridan,KS**

P.O. Box 583  
Russell,KS 67665

**Kennedy #1**

Job Ticket: 71804

**DST#: 1**

ATTN: Jerry Green

Test Start: 2024.06.04 @ 17:40:00

## GENERAL INFORMATION:

Formation: **Toronto**

Deviated: No Whipstock: ft (KB)

Time Tool Opened: 20:03:40

Time Test Ended: 02:07:39

Test Type: Conventional Bottom Hole (Initial)

Tester: Martine Salinas

Unit No: 82

**Interval: 3677.00 ft (KB) To 3705.00 ft (KB) (TVD)**

Reference Elevations: 2567.00 ft (KB)

Total Depth: 3705.00 ft (KB) (TVD)

2562.00 ft (CF)

Hole Diameter: 7.88 inches Hole Condition: Good

KB to GR/CF: 5.00 ft

**Serial #: 8734 Outside**

Press@RunDepth: 333.42 psig @ 3678.00 ft (KB)

Capacity: 8000.00 psig

Start Date: 2024.06.04 End Date: 2024.06.05

Last Calib.: 2024.06.05

Start Time: 17:40:01 End Time: 02:07:40

Time On Btm: 2024.06.04 @ 20:03:20

Time Off Btm: 2024.06.04 @ 23:06:20

**TEST COMMENT:** 45-IF-B.O.B (11 inches) @ 5 mins (Blow increased to 60 1/2")  
45-ISI-Return blow @ 3 mins built to 3 1/4"  
45-FF-B.O.B @ 9 mins (Blow increased to 30 3/4")  
45-FSI-Return blow built to 4 1/4"

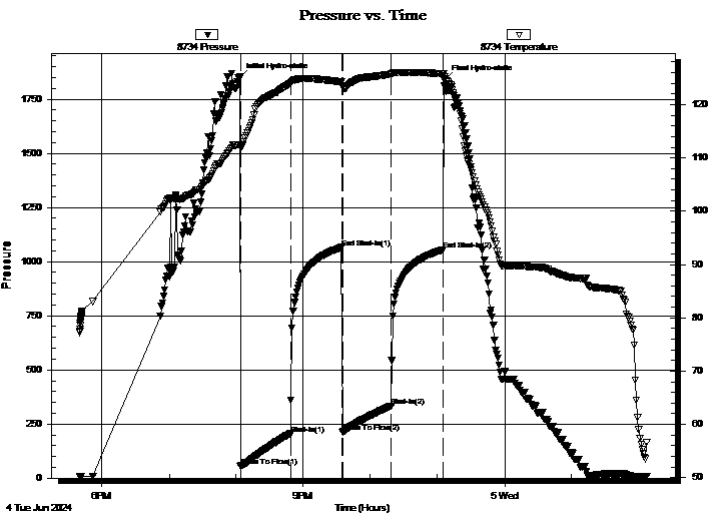

## PRESSURE SUMMARY

Time (Min.)	Pressure (psig)	Temp (deg F)	Annotation
0	1847.22	112.47	Initial Hydro-static
1	53.38	111.93	Open To Flow (1)
46	204.71	124.03	Shut-In(1)
91	1065.19	124.26	End Shut-In(1)
92	212.59	123.36	Open To Flow (2)
136	333.42	125.72	Shut-In(2)
183	1055.28	125.72	End Shut-In(2)
184	1840.37	125.34	Final Hydro-static

## Recovery

Length (ft)	Description	Volume (bbl)
70.00	GHMCO 21%G,37%M, 42%O	0.98
850.00	CGO 25%G, 75%O	11.92
0.00	270' GIP	0.00

## Gas Rates

	Choke (inches)	Pressure (psig)	Gas Rate (Mcf/d)







**TRILOBITE  
TESTING, INC**

# DRILL STEM TEST REPORT

**TOOL DIAGRAM**

Castle Resources Inc

**32-8S.-27W. Sheridan,KS**

P.O. Box 583  
Russell,KS 67665

**Kennedy #1**

Job Ticket: 71804

**DST#: 1**

ATTN: Jerry Green

Test Start: 2024.06.04 @ 17:40:00

## Tool Information

Drill Pipe:	Length: 3677.00 ft	Diameter: 3.80 inches	Volume: 51.58 bbl	Tool Weight:	2500.00 lb
Heavy Wt. Pipe:	Length: 0.00 ft	Diameter: 2.75 inches	Volume: 0.00 bbl	Weight set on Packer:	25000.00 lb
Drill Collar:	Length: 0.00 ft	Diameter: 2.25 inches	Volume: 0.00 bbl	Weight to Pull Loose:	65000.00 lb
			<u>Total Volume: 51.58 bbl</u>	Tool Chased	0.00 ft
Drill Pipe Above KB:	33.00 ft			String Weight: Initial	57000.00 lb
Depth to Top Packer:	3677.00 ft			Final	61000.00 lb
Depth to Bottom Packer:	ft				
Interval between Packers:	28.00 ft				
Tool Length:	61.00 ft				
Number of Packers:	2	Diameter: 6.75 inches			

Tool Comments:

## Tool Description

Tool Description	Length (ft)	Serial No.	Position	Depth (ft)	Accum. Lengths
Change Over Sub	1.00			3645.00	
Shut In Tool	5.00			3650.00	
Hydraulic tool	5.00	1113		3655.00	
Jars	5.00	01-07		3660.00	
EM Tool	5.00			3665.00	
Safety Joint	3.00	-001		3668.00	
Packer	5.00			3673.00	33.00 Bottom Of Top Packer
Packer	4.00			3677.00	
Stubb	1.00			3678.00	
Recorder	0.00	8959	Inside	3678.00	
Recorder	0.00	8734	Outside	3678.00	
Perforations	22.00			3700.00	
Bullnose	5.00			3705.00	28.00 Bottom Packers & Anchor

**Total Tool Length: 61.00**



**TRILOBITE  
TESTING, INC**

# DRILL STEM TEST REPORT

**FLUID SUMMARY**

Castle Resources Inc

**32-8S.-27W. Sheridan,KS**

P.O. Box 583  
Russell,KS 67665

**Kennedy #1**

Job Ticket: 71804

**DST#: 1**

ATTN: Jerry Green

Test Start: 2024.06.04 @ 17:40:00

## Mud and Cushion Information

Mud Type: Gel Chem

Cushion Type:

Oil API:

29.8 deg API

Mud Weight: 9.00 lb/gal

Cushion Length:

ft

Water Salinity:

ppm

Viscosity: 41.00 sec/qt

Cushion Volume:

bbbl

Water Loss: 11.98 in<sup>3</sup>

Gas Cushion Type:

Resistivity: ohm.m

Gas Cushion Pressure:

psig

Salinity: 3000.00 ppm

Filter Cake: 1.00 inches

## Recovery Information

Recovery Table

Length ft	Description	Volume bbl
70.00	GHMCO 21%G,37%M, 42%O	0.982
850.00	CGO 25%G, 75%O	11.923
0.00	270' GIP	0.000

Total Length: 920.00 ft      Total Volume: 12.905 bbl

Num Fluid Samples: 0

Num Gas Bombs: 0

Serial #:

Laboratory Name:

Laboratory Location:

Recovery Comments: Gravity of oil = 29.8 @ 60 degs



### Pressure vs. Time

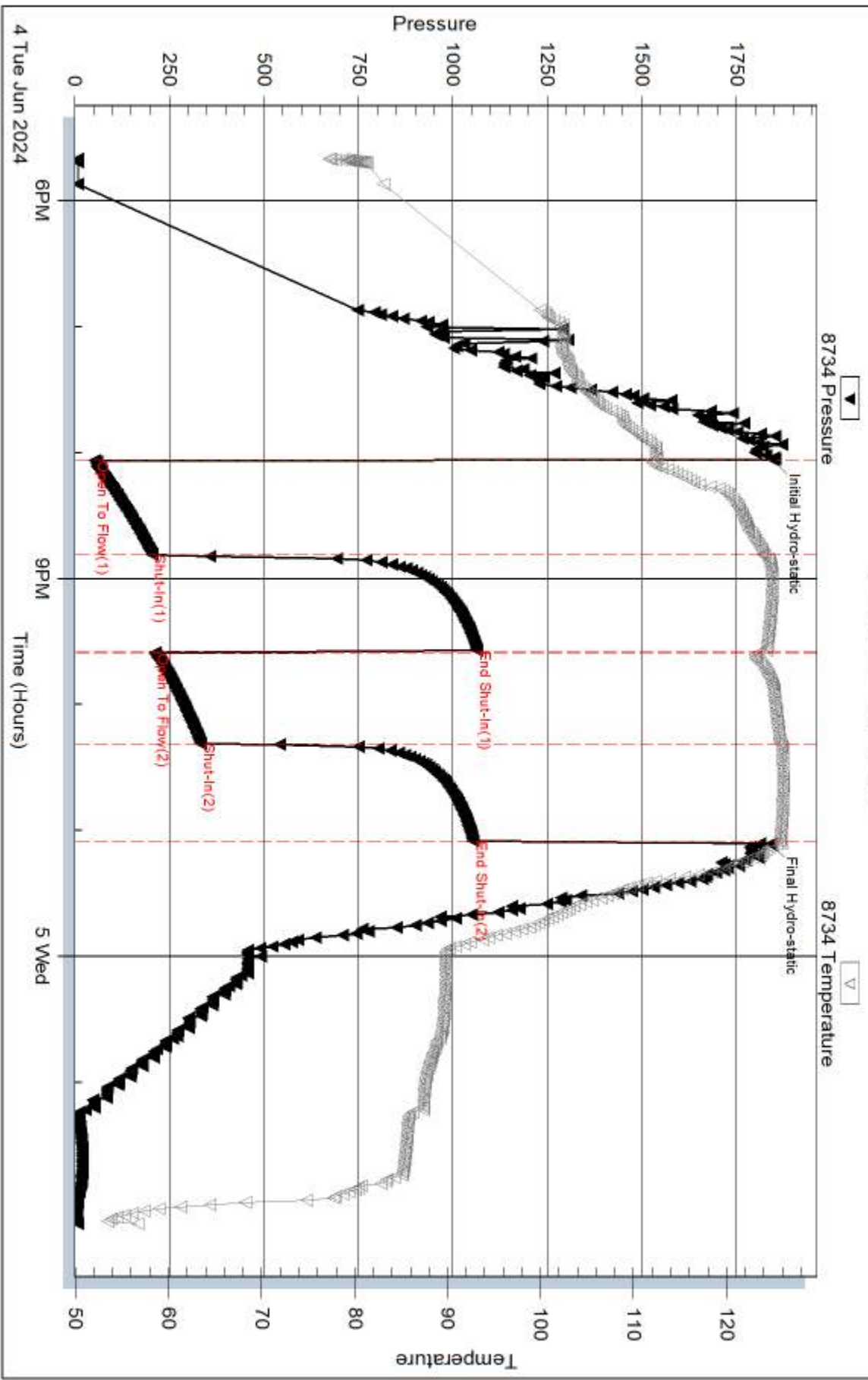

Serial #: 8959

Inside

Castle Resources Inc

Kennedy #1

DST Test Number: 1

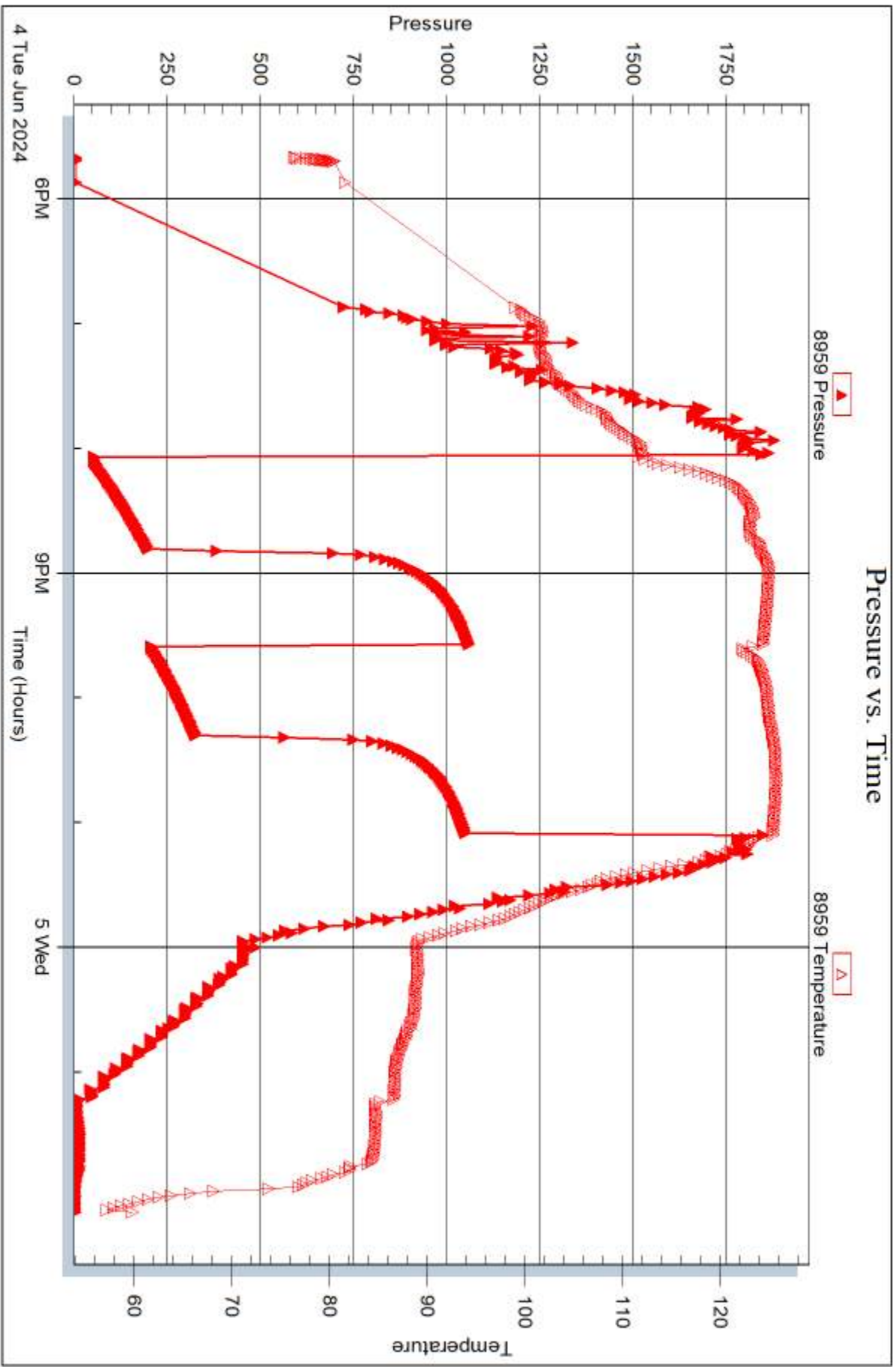

Triobite Testing, Inc

Ref. No: 71804

Printed: 2024.06.07 @ 09:42:35



## DRILL STEM TEST REPORT

Prepared For: **Castle Resources Inc**

P.O. Box 583  
Russell, KS 67665

ATTN: Jerry Green

### **Kennedy #1**

#### **32-8S.-27W. Sheridan, KS**

Start Date: 2024.06.06 @ 03:05:00

End Date: 2024.06.06 @ 09:37:30

Job Ticket #: 71805                      DST #: 2

Trilobite Testing, Inc

PO Box 362 Hays, KS 67601

ph: 785-625-4778 fax: 785-625-5620

Printed: 2024.06.07 @ 09:41:45





**TRILOBITE TESTING, INC**

# DRILL STEM TEST REPORT

Castle Resources Inc

**32-8S.-27W. Sheridan,KS**

P.O. Box 583  
Russell,KS 67665

**Kennedy #1**

Job Ticket: 71805

**DST#: 2**

ATTN: Jerry Green

Test Start: 2024.06.06 @ 03:05:00

## GENERAL INFORMATION:

Formation: **LKC " A "**

Deviated: No Whipstock: ft (KB)

Time Tool Opened: 06:53:20

Time Test Ended: 09:37:30

Test Type: Conventional Straddle (Reset)

Tester: Martine Salinas

Unit No: 82

**Interval: 3702.00 ft (KB) To 3720.00 ft (KB) (TVD)**

Total Depth: 3900.00 ft (KB) (TVD)

Hole Diameter: 7.88 inches Hole Condition: Good

Reference Elevations: 2567.00 ft (KB)

2562.00 ft (CF)

KB to GR/CF: 5.00 ft

**Serial #: 8734 Outside**

Press@RunDepth: 35.63 psig @ 3703.00 ft (KB)

Start Date: 2024.06.06

End Date:

2024.06.06

Start Time: 03:05:01

End Time:

09:37:30

Capacity: 8000.00 psig

Last Calib.: 2024.06.06

Time On Btm: 2024.06.06 @ 06:53:10

Time Off Btm: 2024.06.06 @ 07:57:39

TEST COMMENT: 30-IF- Blow built to 1 1/4"

30-ISI-No return

Pull tool

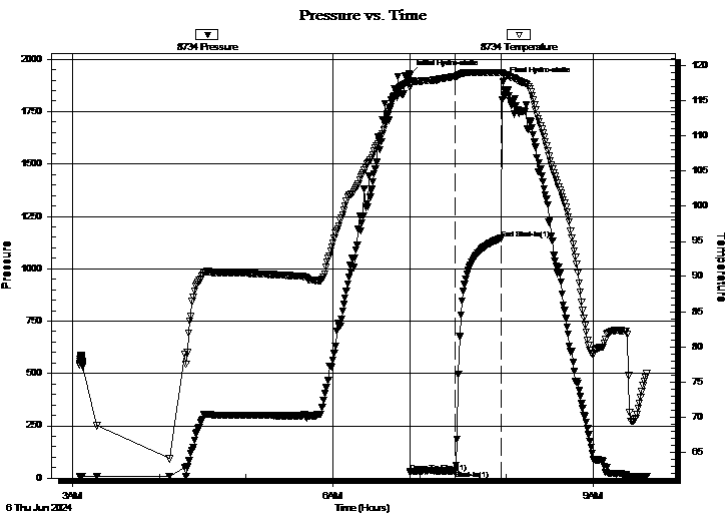

## PRESSURE SUMMARY

Time (Min.)	Pressure (psig)	Temp (deg F)	Annotation
0	1924.71	117.90	Initial Hydro-static
1	29.22	116.87	Open To Flow (1)
32	35.63	118.42	Shut-In(1)
63	1144.42	118.97	End Shut-In(1)
65	1890.85	118.81	Final Hydro-static

## Recovery

Length (ft)	Description	Volume (bbl)
15.00	100% Mud w /Oil Scum	0.21
0.00	Oil spots in tool	0.00

## Gas Rates

	Choke (inches)	Pressure (psig)	Gas Rate (Mcf/d)

\* Recovery from multiple tests







**TRILOBITE  
TESTING, INC**

# DRILL STEM TEST REPORT

**TOOL DIAGRAM**

Castle Resources Inc

**32-8S.-27W. Sheridan,KS**

P.O. Box 583  
Russell,KS 67665

**Kennedy #1**

Job Ticket: 71805

**DST#: 2**

ATTN: Jerry Green

Test Start: 2024.06.06 @ 03:05:00

## Tool Information

Drill Pipe:	Length: 3677.00 ft	Diameter: 3.80 inches	Volume: 51.58 bbl	Tool Weight:	3000.00 lb
Heavy Wt. Pipe:	Length: 0.00 ft	Diameter: 2.75 inches	Volume: 0.00 bbl	Weight set on Packer:	30000.00 lb
Drill Collar:	Length: 0.00 ft	Diameter: 2.25 inches	Volume: 0.00 bbl	Weight to Pull Loose:	60000.00 lb
			<u>Total Volume: 51.58 bbl</u>	Tool Chased	0.00 ft
Drill Pipe Above KB:	8.00 ft			String Weight: Initial	53000.00 lb
Depth to Top Packer:	3702.00 ft			Final	53000.00 lb
Depth to Bottom Packer:	3716.00 ft				
Interval between Packers:	14.00 ft				
Tool Length:	322.00 ft				
Number of Packers:	3	Diameter: 6.75 inches			

Tool Comments:

## Tool Description

Tool Description	Length (ft)	Serial No.	Position	Depth (ft)	Accum. Lengths
Change Over Sub	1.00			3670.00	
Shut In Tool	5.00			3675.00	
Hydraulic tool	5.00	1113		3680.00	
Jars	5.00	01-07		3685.00	
EM Tool	5.00			3690.00	
Safety Joint	3.00	-001		3693.00	
Packer	5.00			3698.00	33.00 Bottom Of Top Packer
Packer	4.00			3702.00	
Stubb	1.00			3703.00	
Recorder	0.00	8959	Inside	3703.00	
Recorder	0.00	8734	Outside	3703.00	
Perforations	12.00			3715.00	
Blank Off Sub	1.00			3716.00	14.00 Tool Interval
Packer	5.00			3721.00	
Packer - Shale	0.00			3721.00	
Stubb	1.00			3722.00	
Recorder	0.00	8520	Below	3722.00	
Perforations	8.00			3730.00	
Change Over Sub	1.00			3731.00	
Drill Pipe	254.00			3985.00	
Change Over Sub	1.00			3986.00	
Bullnose	5.00			3991.00	275.00 Bottom Packers & Anchor

**Total Tool Length: 322.00**





**TRILOBITE  
TESTING, INC**

# DRILL STEM TEST REPORT

**FLUID SUMMARY**

Castle Resources Inc

**32-8S.-27W. Sheridan,KS**

P.O. Box 583  
Russell,KS 67665

**Kennedy #1**

Job Ticket: 71805

**DST#: 2**

ATTN: Jerry Green

Test Start: 2024.06.06 @ 03:05:00

## Mud and Cushion Information

Mud Type: Gel Chem

Cushion Type:

Oil API:

deg API

Mud Weight: 9.00 lb/gal

Cushion Length:

ft

Water Salinity:

ppm

Viscosity: 41.00 sec/qt

Cushion Volume:

bbf

Water Loss: 8.79 in<sup>3</sup>

Gas Cushion Type:

Resistivity: ohm.m

Gas Cushion Pressure:

psig

Salinity: 2000.00 ppm

Filter Cake: 1.00 inches

## Recovery Information

Recovery Table

Length ft	Description	Volume bbf
15.00	100% Mud w /Oil Scum	0.210
0.00	Oil spots in tool	0.000

Total Length: 15.00 ft      Total Volume: 0.210 bbf

Num Fluid Samples: 0

Num Gas Bombs: 0

Serial #:

Laboratory Name:

Laboratory Location:

Recovery Comments:

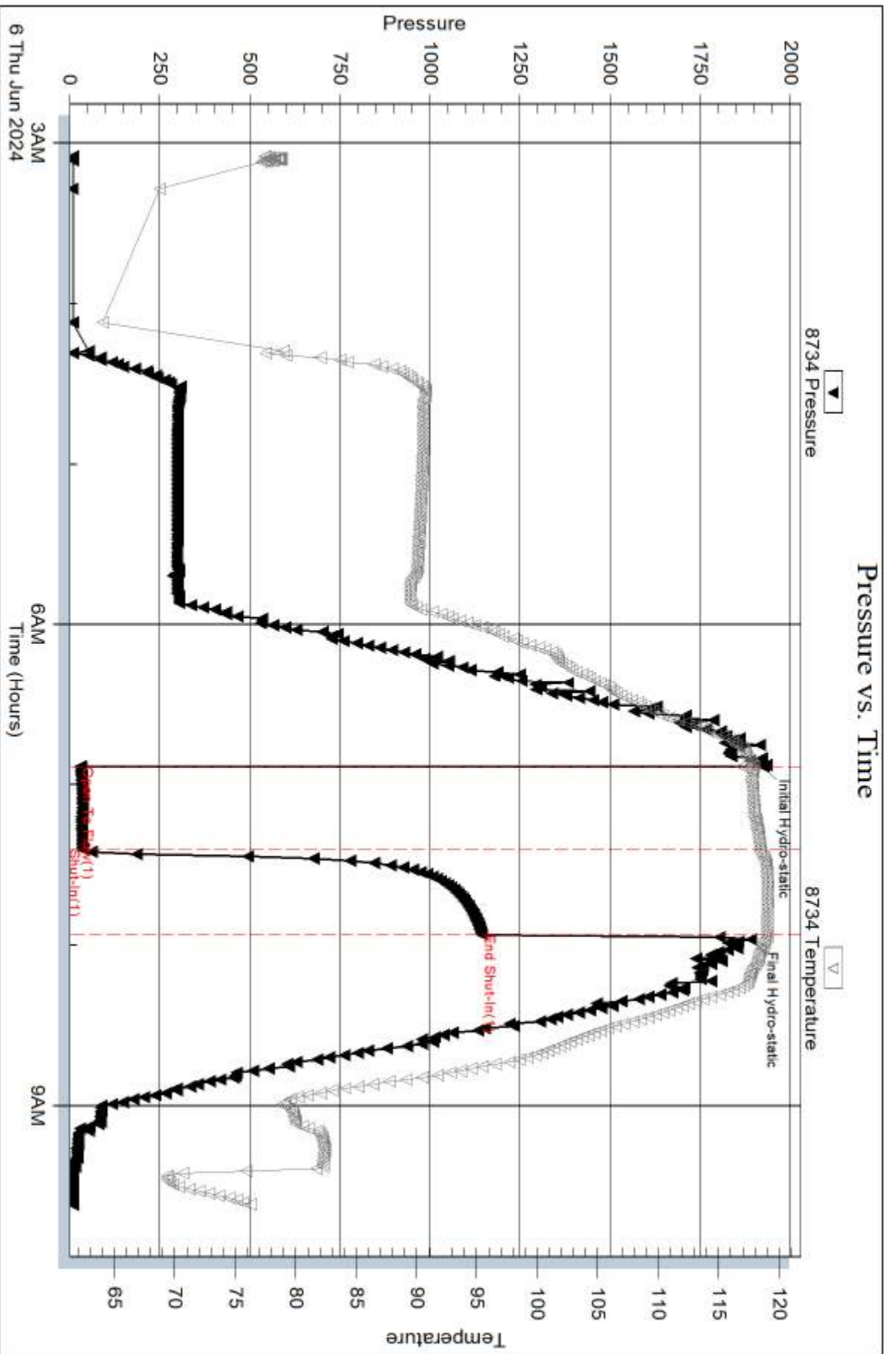

Serial #: 8959

Inside

Castle Resources Inc

Kennedy #1

DST Test Number: 2

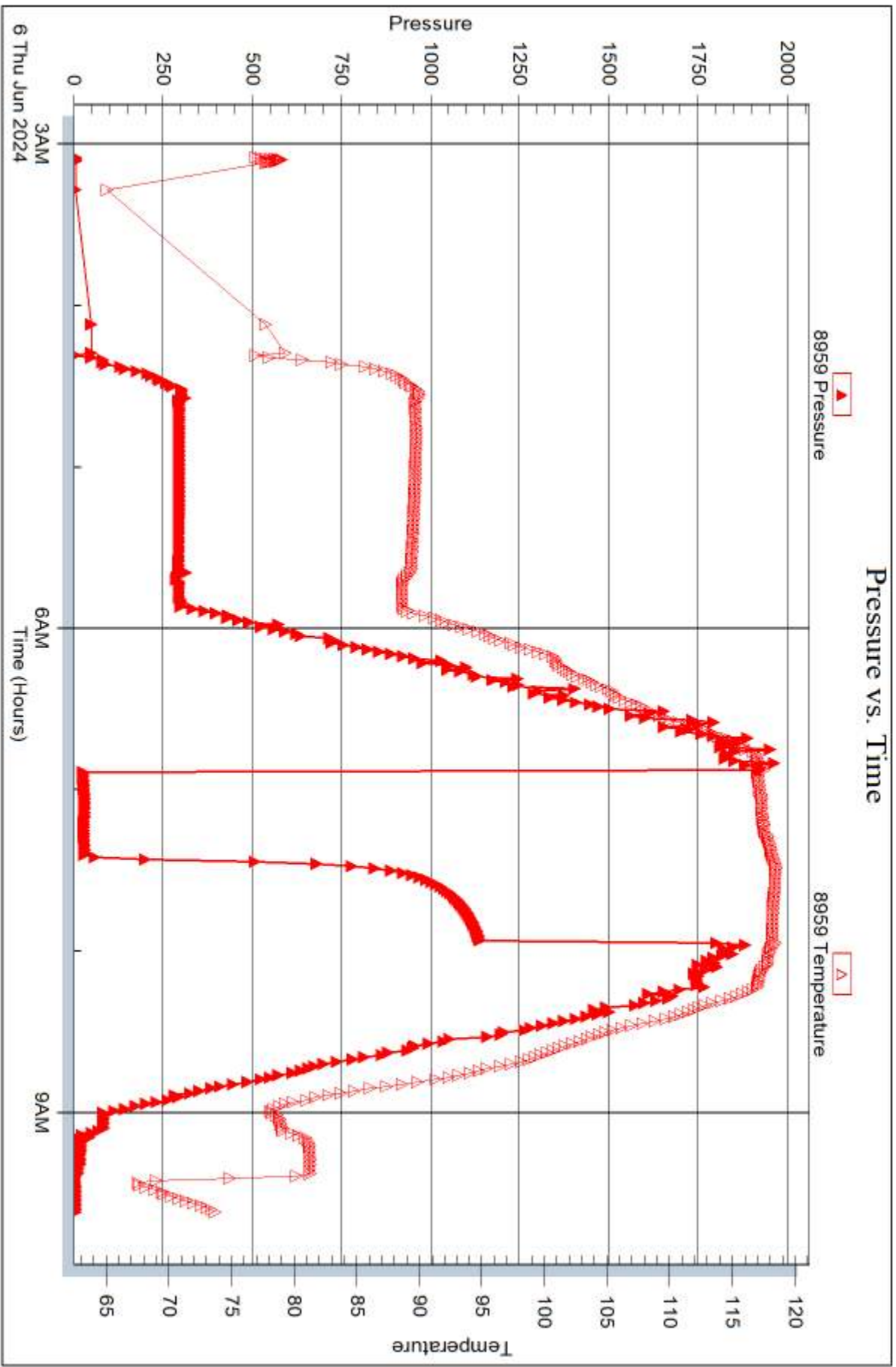

Trilobite Testing, Inc

Ref. No: 71805

Printed: 2024.06.07 @ 09:41:46

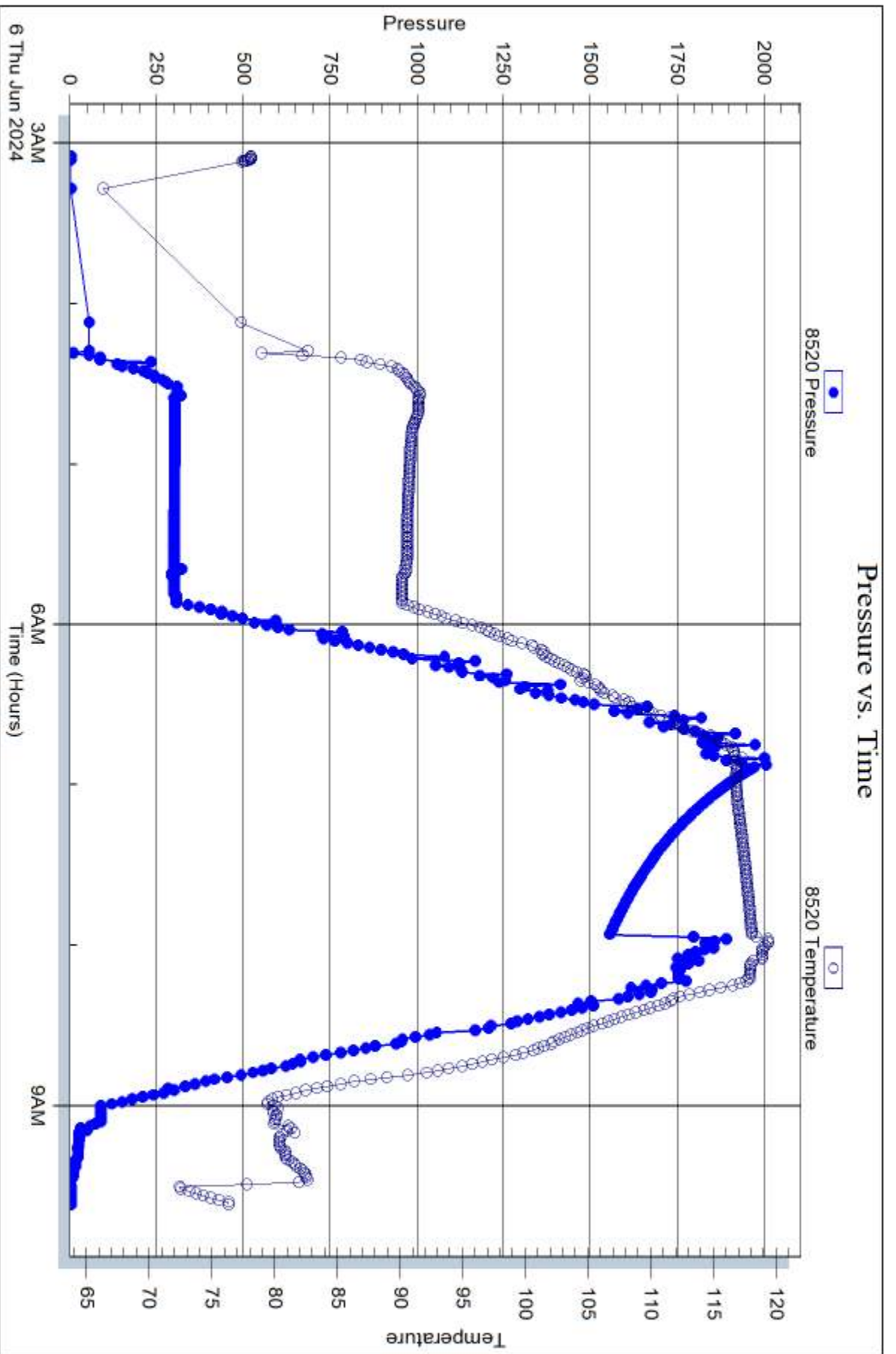



## DRILL STEM TEST REPORT

Prepared For: **Castle Resources INC**

P.O. Box 583  
Russell, KS 67665

ATTN: Jerry Green

### **Kennedy #1**

#### **32-8S.-27W. Sheridan, KS**

Start Date: 2024.06.06 @ 10:10:00

End Date: 2024.06.06 @ 14:44:50

Job Ticket #: 71806                      DST #: 3

Trilobite Testing, Inc

PO Box 362 Hays, KS 67601

ph: 785-625-4778 fax: 785-625-5620

Printed: 2024.06.07 @ 09:41:05





**TRILOBITE  
TESTING, INC**

# DRILL STEM TEST REPORT

Castle Resources INC

**32-8S.-27W. Sheridan,KS**

P.O. Box 583  
Russell,KS 67665

**Kennedy #1**

Job Ticket: 71806

**DST#: 3**

ATTN: Jerry Green

Test Start: 2024.06.06 @ 10:10:00

## GENERAL INFORMATION:

Formation: **LKC " J "**

Deviated: No Whipstock: ft (KB)

Time Tool Opened: 11:52:40

Time Test Ended: 14:44:50

Test Type: Conventional Straddle (Reset)

Tester: Martine Salinas

Unit No: 82

**Interval: 3846.00 ft (KB) To 3887.00 ft (KB) (TVD)**

Reference Elevations: 2567.00 ft (KB)

Total Depth: 3990.00 ft (KB) (TVD)

2562.00 ft (CF)

Hole Diameter: 7.88 inches Hole Condition: Good

KB to GR/CF: 5.00 ft

**Serial #: 8734 Outside**

Press@RunDepth: 39.38 psig @ 3847.00 ft (KB)

Capacity: 8000.00 psig

Start Date: 2024.06.06

End Date:

2024.06.06

Last Calib.:

2024.06.06

Start Time: 10:10:01

End Time:

14:44:50

Time On Btm:

2024.06.06 @ 11:52:30

Time Off Btm:

2024.06.06 @ 12:58:40

**TEST COMMENT:** 30-IF- Blow built to 1" @ 10 mins and maintained  
30-ISI-No return  
Pull tools

## PRESSURE SUMMARY

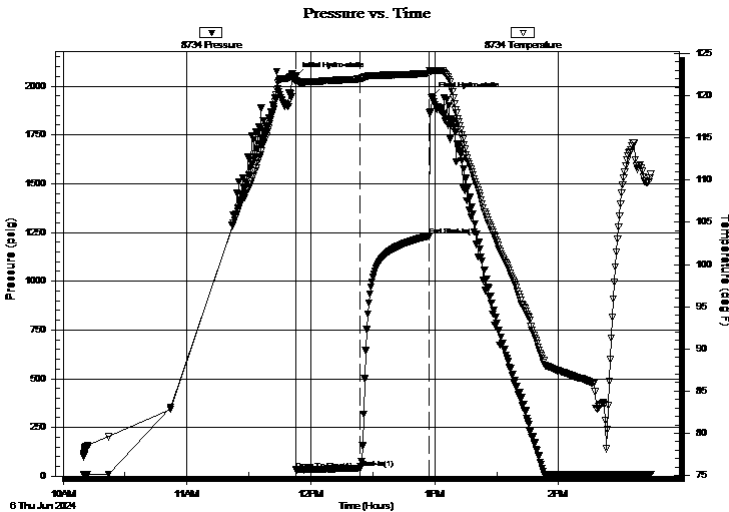

Time (Min.)	Pressure (psig)	Temp (deg F)	Annotation
0	2046.83	122.39	Initial Hydro-static
1	32.13	121.70	Open To Flow (1)
32	39.38	121.98	Shut-In(1)
65	1230.44	122.66	End Shut-In(1)
67	1948.17	122.97	Final Hydro-static

## Recovery

Length (ft)	Description	Volume (bbl)
15.00	100% Mud	0.21

## Gas Rates

	Choke (inches)	Pressure (psig)	Gas Rate (Mcf/d)

\* Recovery from multiple tests







**TRILOBITE  
TESTING, INC**

# DRILL STEM TEST REPORT

**TOOL DIAGRAM**

Castle Resources INC

**32-8S.-27W. Sheridan,KS**

P.O. Box 583  
Russell,KS 67665

**Kennedy #1**

Job Ticket: 71806

**DST#: 3**

ATTN: Jerry Green

Test Start: 2024.06.06 @ 10:10:00

## Tool Information

Drill Pipe:	Length: 3838.00 ft	Diameter: 3.80 inches	Volume: 53.84 bbl	Tool Weight: 3000.00 lb
Heavy Wt. Pipe:	Length: 0.00 ft	Diameter: 2.75 inches	Volume: 0.00 bbl	Weight set on Packer: 30000.00 lb
Drill Collar:	Length: 0.00 ft	Diameter: 2.25 inches	Volume: 0.00 bbl	Weight to Pull Loose: 62000.00 lb
			<u>Total Volume: 53.84 bbl</u>	Tool Chased 0.00 ft
Drill Pipe Above KB:	25.00 ft			String Weight: Initial 53000.00 lb
Depth to Top Packer:	3846.00 ft			Final 53000.00 lb
Depth to Bottom Packer:	3883.00 ft			
Interval between Packers:	37.00 ft			
Tool Length:	178.00 ft			
Number of Packers:	3	Diameter: 6.75 inches		

Tool Comments:

## Tool Description

**Length (ft) Serial No. Position Depth (ft) Accum. Lengths**

Change Over Sub	1.00			3814.00	
Shut In Tool	5.00			3819.00	
Hydraulic tool	5.00	1113		3824.00	
Jars	5.00	01-07		3829.00	
EM Tool	5.00			3834.00	
Safety Joint	3.00	-001		3837.00	
Packer	5.00			3842.00	33.00 Bottom Of Top Packer
Packer	4.00			3846.00	
Stubb	1.00			3847.00	
Recorder	0.00	8959	Inside	3847.00	
Recorder	0.00	8734	Outside	3847.00	
Perforations	35.00			3882.00	
Blank Off Sub	1.00			3883.00	37.00 Tool Interval
Packer	5.00			3888.00	
Packer - Shale	0.00			3888.00	
Stubb	1.00			3889.00	
Perforations	1.00			3890.00	
Change Over Sub	1.00			3891.00	
Recorder	0.00	8520	Below	3891.00	
Drill Pipe	94.00			3985.00	
Change Over Sub	1.00			3986.00	
Bullnose	5.00			3991.00	108.00 Bottom Packers & Anchor

**Total Tool Length: 178.00**



**TRILOBITE  
TESTING, INC**

# DRILL STEM TEST REPORT

## FLUID SUMMARY

Castle Resources INC

**32-8S.-27W. Sheridan,KS**

P.O. Box 583  
Russell,KS 67665

**Kennedy #1**

Job Ticket: 71806

**DST#: 3**

ATTN: Jerry Green

Test Start: 2024.06.06 @ 10:10:00

### Mud and Cushion Information

Mud Type: Gel Chem

Cushion Type:

Oil API:

deg API

Mud Weight: 9.00 lb/gal

Cushion Length:

ft

Water Salinity:

ppm

Viscosity: 41.00 sec/qt

Cushion Volume:

bbbl

Water Loss: 8.79 in<sup>3</sup>

Gas Cushion Type:

Resistivity: ohm.m

Gas Cushion Pressure:

psig

Salinity: 2000.00 ppm

Filter Cake: 1.00 inches

### Recovery Information

Recovery Table

Length ft	Description	Volume bbl
15.00	100% Mud	0.210

Total Length: 15.00 ft      Total Volume: 0.210 bbl

Num Fluid Samples: 0

Num Gas Bombs: 0

Serial #:

Laboratory Name:

Laboratory Location:

Recovery Comments:

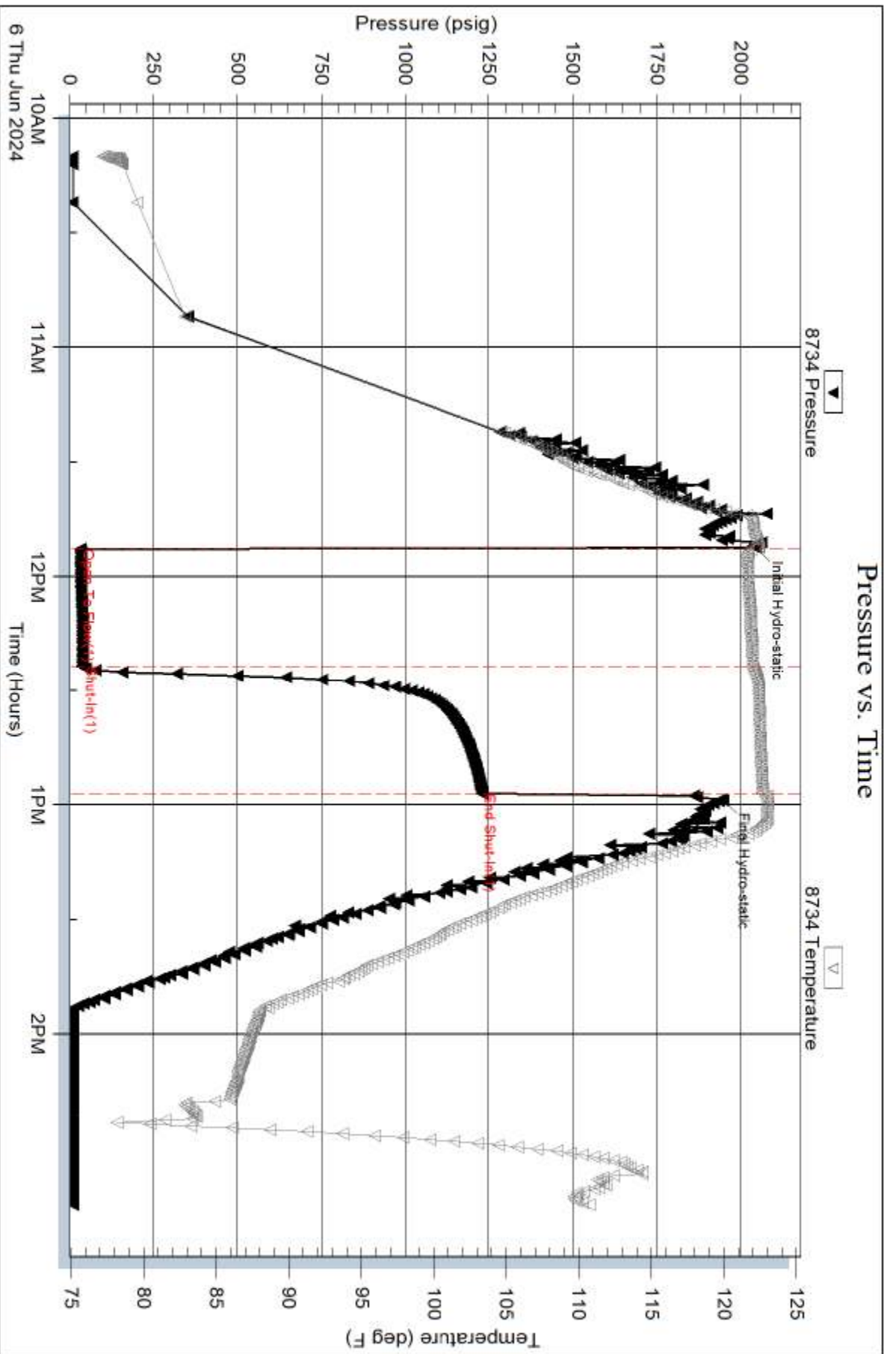



Serial #: 8959

Inside

Castle Resources INC

Kennedy #1

DST Test Number: 3

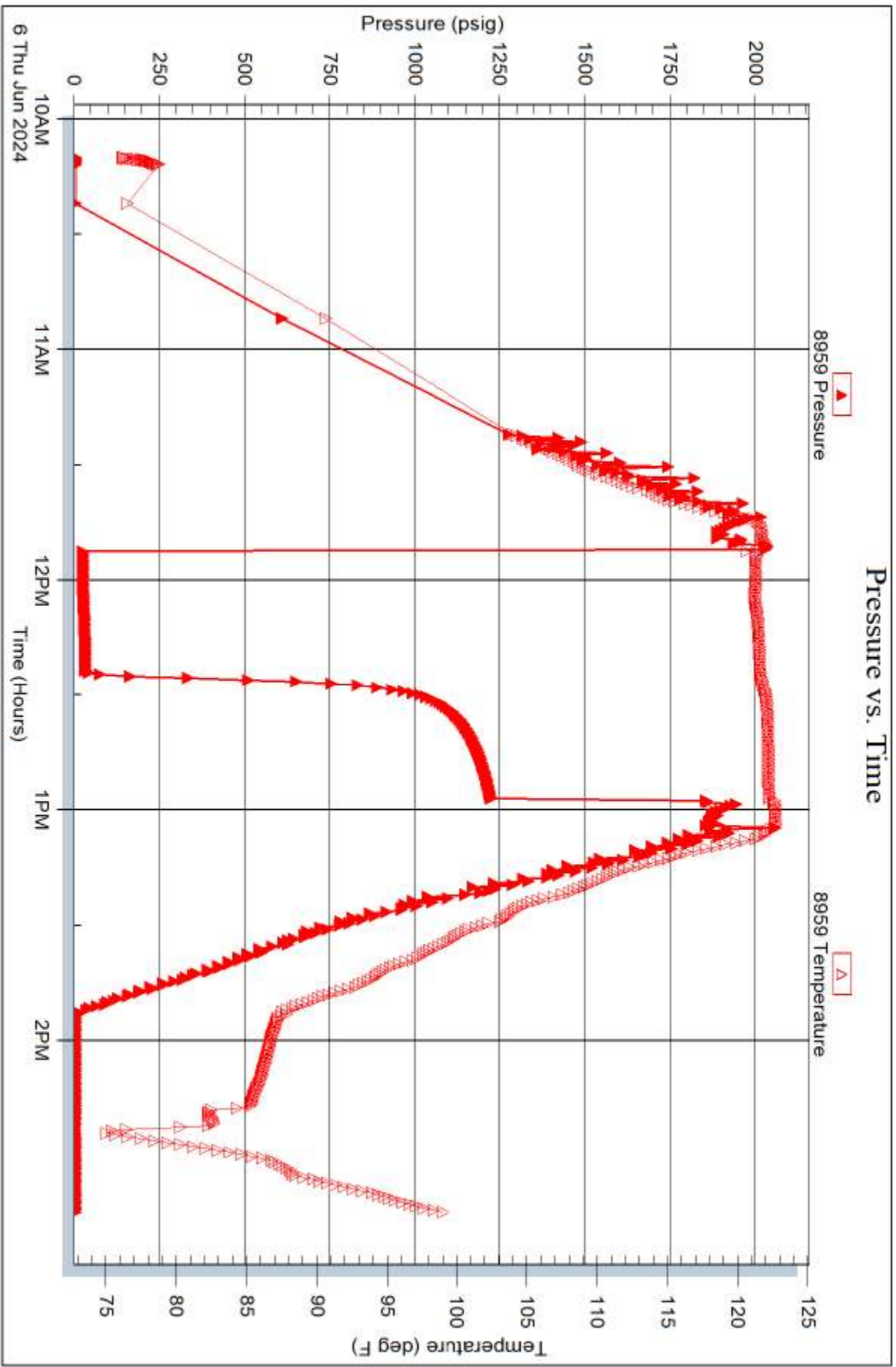

Trilobite Testing, Inc

Ref. No: 71806

Printed: 2024.06.07 @ 09:41:06

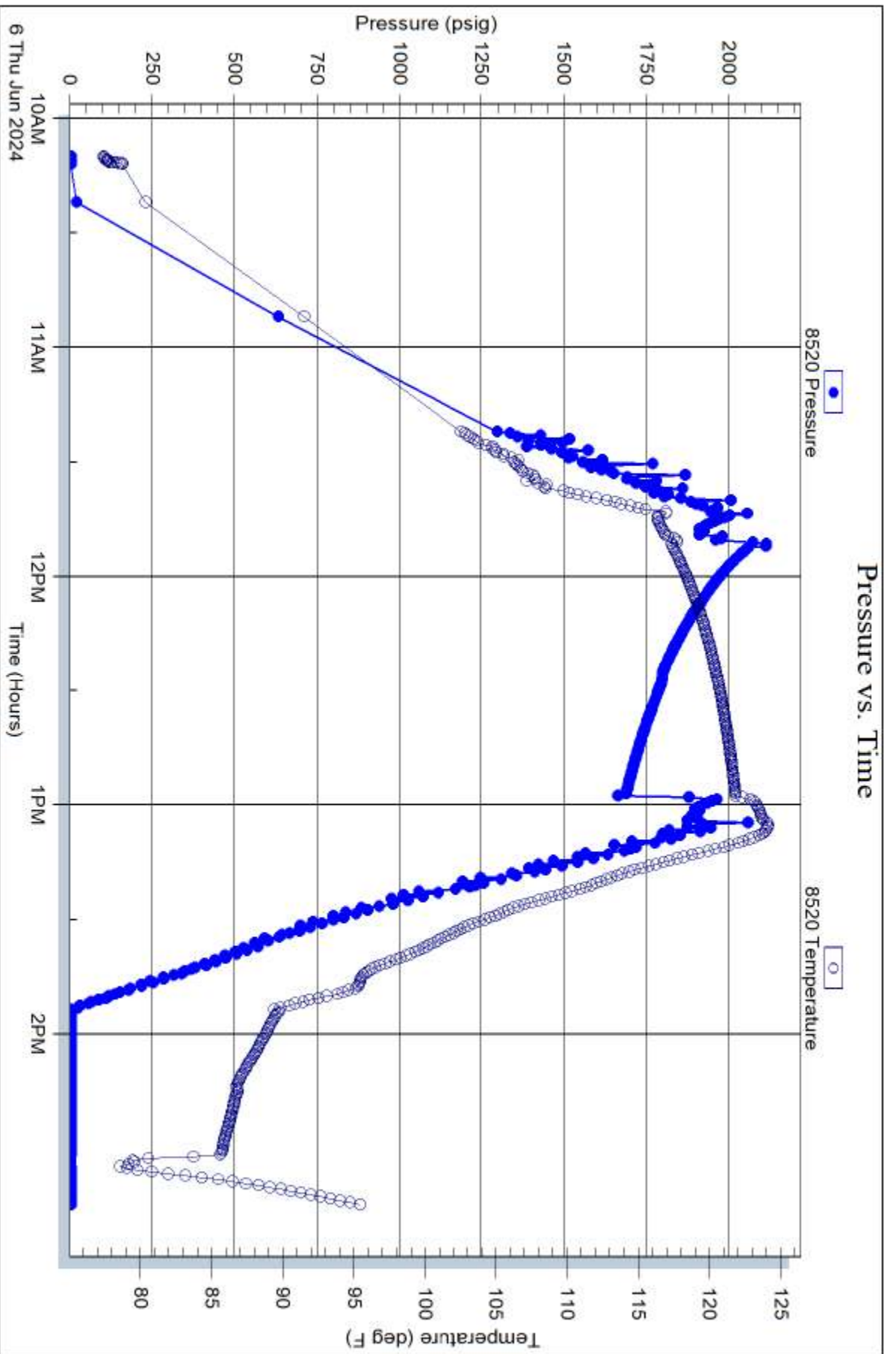



# TRILOBITE TESTING INC.

1515 Commerce Parkway • Hays, Kansas 67601

## Test Ticket

NO. **71804**

Well Name & No. Kennedy A1 Test No. 1 Date 6-4-24  
 Company Castle Resources INC Elevation 2567 KB 2562 GL  
 Address P.O. Box 583 Russell, KS 67665  
 Co. Rep / Geo Jerry Green Rig White Knight  
 Location: Sec. 32 Twp 35. Rge. 27W Co. Sheridan State KS

Interval Tested 3677-3705 Zone Tested Turonto  
 Anchor Length 28' Drill Pipe Run 3677 Mud Wt. 9.2  
 Top Packer Depth 3672 Drill Collars Run — Vis 41.  
 Bottom Packer Depth 3677 Wt. Pipe Run — WL 12.0  
 Total Depth 3705 Chlorides 3000 ppm System LCM 1#

Blow Description IF - B.O.B (11 inches) @ 5 mins (60 1/2")  
ISI - Return blow @ 3 mins built to 3 1/4"  
FF - B.O.B @ 9 mins (blow increased to 30 3/4")  
ESI - Return blow built to 4 1/4"

Rec	Feet of	%gas	%oil	%water	%mud
<u>70</u>	<u>GHMC0</u>	<u>21</u>	<u>40</u>	<u>37</u>	
<u>850</u>	<u>CGG</u>	<u>25</u>	<u>75</u>		
<u>0</u>	<u>270' GIP</u>				

Rec Total 920 BHT 125 Gravity 29.8 API RW — @ — °F Chlorides — ppm  
 Initial Hydrostatic 1847  Test 1800  Ruined Shale Packer  
 Initial Flow 53 to 205  Jars 300  Ruined Packer  
 Initial Shut-In 1065  Circ Sub  Hotel  
 Final Flow 213 to 333  Hourly Standby  EM Tool Successful  
 Final Shut-In 1055  Mileage 175 RT 92rt 161  Accessibility  
 Final Hydrostatic 1840  Sampler  Gas Sample  
 T-On Location 16:00  Straddle  Oversized Hole  
 Initial Flow 45 T-Started 17:40  Shale Packer  Sub Total 0  
 Initial Shut-In 45 T-Open 20:03  Extra Packer  Total 2261  
 Final Flow 45 T-Pulled 23:03  Extra Recorder  Tool Loaded @  
 Final Shut-In 45 T-Out 02:08  Day Standby  MP/DST Disc't

Comments \_\_\_\_\_

Approved By \_\_\_\_\_ Our Representative [Signature]

Trilobite Testing Inc. shall not be liable for damage of any kind of property or personnel of the one for whom a test is made, or for any loss suffered or sustained, directly or indirectly, through the use of its equipment, or its statements or opinion concerning the results of any test. Tools lost or damaged in the hole shall be paid for at cost by the party for whom the test is made.





# TRILOBITE TESTING INC.

1515 Commerce Parkway • Hays, Kansas 67601

## Test Ticket

NO. **71805**

Well Name & No. Kennedy #1 Test No. 2 Date 6-6-84  
 Company Castle Resources INC Elevation 2567 KB 2562 GL  
 Address P.O. Box 583 Russell, KS 67665  
 Co. Rep / Geo Jerry Green Rig White Knight  
 Location: Sec. 3a Twp 8S. Rge. 27W. Co. Sheridan State KS

Interval Tested 3702-3720 Zone Tested LKC "A"  
 Anchor Length 18' Anchor 270' T. pipe Drill Pipe Run 3677 Mud Wt. 9.2  
 Top Packer Depth 3698-3702 Drill Collars Run — Vis 41  
 Bottom Packer Depth 3720 (Shale) Wt. Pipe Run — WL 8.8  
 Total Depth 3990 Chlorides 2000 ppm System LCM 1#  
 Blow Description IF - Blow built to 1/4"

ISI - No return.

IF - pull tools.

ESI

Rec	Feet of	%gas	%oil	%water	%mud
<u>15</u>	<u>Mud w/oil scum.</u>				
<u>0</u>	<u>Oil spots in tool</u>				

Rec Total 15 BHT 119 Gravity — API RW — @ — \*F Chlorides — ppm  
 Initial Hydrostatic 1925  Test 1800  Ruined Shale Packer —  
 Initial Flow 29 to 36  Jars 300  Ruined Packer —  
 Initial Shut-In 1144  Circ Sub —  Hotel —  
 Final Flow — to —  Hourly Standby —  EM Tool Successful —  
 Final Shut-In —  Mileage 175 RT 80.50  Accessibility —  
 Final Hydrostatic 1891  Sampler —  Gas Sample —  
 T-On Location 01:45  Straddle 800  Oversized Hole —  
 Initial Flow 30 T-Started 03:05  Shale Packer 250  Sub Total 0  
 Initial Shut-In 30 T-Open 06:54  Extra Packer —  Total 3230.50  
 Final Flow — T-Pulled 07:54  Extra Recorder —  Tool Loaded — @ —  
 Final Shut-In — T-Out 09:38  Day Standby —  MP/DST Disc't —

Comments \_\_\_\_\_

Approved By \_\_\_\_\_ Our Representative Matt Jahn

Trilobite Testing Inc. shall not be liable for damage of any kind of property or personnel of the one for whom a test is made, or for any loss suffered or sustained, directly or indirectly, through the use of its equipment, or its statements or opinion concerning the results of any test. Tools lost or damaged in the hole shall be paid for at cost by the party for whom the test is made.





# TRILOBITE TESTING INC.

1515 Commerce Parkway • Hays, Kansas 67601

## Test Ticket

NO. **71806**

Well Name & No. Kennedy #1 Test No. 3 Date 6-6-24  
 Company Castle Resources INC Elevation 2567 KB 2562 GL  
 Address P.O. Box 583 Russell, KS 67665  
 Co. Rep / Geo Jerry Green Rig White Knight  
 Location: Sec. 32 Twp B.S. Rge. 27W. Co. Sheridan State KS

Interval Tested 3846-3887 Zone Tested LKC "5"  
 Anchor Length 41' Anchor 103' T. pipe. Drill Pipe Run 3838 Mud Wt. 9.2  
 Top Packer Depth 3841 - 3846 Drill Collars Run --- Vis 41  
 Bottom Packer Depth 3887 (Shale) Wt. Pipe Run --- WL 8.8  
 Total Depth 3990 Chlorides 2000 ppm System LCM 1#

Blow Description IF - Blow built to 1" @ 10 mins + maintained  
ISI - No return.

Rec	Feet of	%gas	%oil	%water	%mud
<u>15</u>	<u>Mud</u>				
Rec	Feet of	%gas	%oil	%water	%mud
Rec	Feet of	%gas	%oil	%water	%mud
Rec	Feet of	%gas	%oil	%water	%mud
Rec	Feet of	%gas	%oil	%water	%mud
Rec	Feet of	%gas	%oil	%water	%mud
Rec	Feet of	%gas	%oil	%water	%mud

Rec Total 15 BHT 123 Gravity --- API RW --- @ --- \*F Chlorides --- ppm

Initial Hydrostatic 2047  Test 1800  Ruined Shale Packer  
 Initial Flow 32 to 39  Jars 300  Ruined Packer  
 Initial Shut-In 1230  Circ Sub  Hotel  
 Final Flow --- to ---  Hourly Standby  EM Tool Successful  
 Final Shut-In ---  Mileage 175 RT 80.50  Accessibility  
 Final Hydrostatic 1948  Sampler  Gas Sample  
 T- On Location 09:38  Straddle 800  Oversized Hole  
 Initial Flow 30 T-Started 10:10  Shale Packer 250  Sub Total 0  
 Initial Shut-In 30 T-Open 11:53  Extra Packer  Total 3230.50  
 Final Flow --- T-Pulled 12:53  Extra Recorder  Tool Loaded 6-6 @ 16:00  
 Final Shut-In --- T-Out 14:45  Day Standby  MP/DST Disc't

Comments \_\_\_\_\_

Approved By \_\_\_\_\_ Our Representative [Signature]

Trilobite Testing Inc. shall not be liable for damage of any kind of property or personnel of the one for whom a test is made, or for any loss suffered or sustained, directly or indirectly, through the use of its equipment, or its statements or opinion concerning the results of any test. Tools lost or damaged in the hole shall be paid for at cost by the party for whom the test is made.