

**WATER WELL RECORD (WWC-5)**

KOLAR DOC ID \_\_\_\_\_ WELL ID \_\_\_\_\_

Original Record      Correction      Change in Well Use

**LOCATION OF WATER WELL**

Latitude		Longitude		Section		Township		Range		E W	Fraction	¼	¼	¼
Datum		Elevation		County										

**WATER WELL OWNER**

Name	
Business	
Address	
Well location at owner's address	

**WELL WATER USE**

--

**COMPLETION**

Depth of completed well: _____ ft.
Depth(s) groundwater encountered:
(1) _____ ft.; (2) _____ ft.;
(3) _____ ft.; (4) dry well
Static water level in well: _____ ft.
measured below land surface
on (mm/dd/yy): _____
measured above land surface
on (mm/dd/yy): _____
Estimated yield: _____ gpm
Water level was: _____ ft. after _____ hours
pumping _____ gpm
Pump installed?    Yes    No
Water well disinfected?    Yes    No
Date disinfected (mm/dd/yy): _____
Aquifer, if known:

**NEAREST SOURCE OF POTENTIAL CONTAMINATION**

Source: _____
Distance from well: _____      Direction from well: _____
Source description: _____
Source: _____
Distance from well: _____      Direction from well: _____
Source description: _____
No potential source of contamination within 100 feet.

**CONSTRUCTION**

Borehole interval:	Borehole diameter:
from _____ to _____ ft.	_____ in.
from _____ to _____ ft.	_____ in.
Casing height above land surface: _____ in.	
If casing height is less than 12 in. has a variance been approved?*	Yes    No
*variance not required for monitoring or environmental remediation wells	
Casing type: _____	
Blank casing interval: _____ ft. to _____ ft.	
Blank casing diameter: _____ in.	
Casing joints: _____	
Weight: _____ lbs/ft.	
Wall thickness or gauge no.: _____	
Blank casing interval: _____ ft. to _____ ft.	
Blank casing diameter: _____ in.	
Casing joints: _____	
Weight: _____ lbs/ft.	
Wall thickness or gauge no.: _____	
Grout interval: _____ ft. to _____ ft.	
Grout material: _____	
Grout interval: _____ ft. to _____ ft.	
Grout material: _____	
Screen / perforation material: _____	
Screen / perforation openings: _____	
Screen / perforation intervals:	
From _____ ft. to _____ ft.	
Slot size _____ unit _____	
From _____ ft. to _____ ft.	
Slot size _____ unit _____	
Gravel pack intervals:	
Gravel pack not used:      Gravel size _____ in	
From _____ ft. to _____ ft.	
Gravel pack not used:      Gravel size _____ in	
From _____ ft. to _____ ft.	

**PERMIT & ID NUMBERS (AS REQUIRED)**

DWR Application No.: _____
KDHE / EPA Project Code: _____
Site Name: _____
KDHE UIC Class V Form Completed:    Yes    No
County Permit:    Yes    No    Permit ID: _____
Lease Name & Well #: _____
# of boreholes: _____    # of dewatering wells: _____

**LITHOLOGIC LOG**

FROM	TO	LITHOLOGY INTERVALS

**COMMENTS**

--

**CONTRACTOR'S OR LANDOWNERS CERTIFICATION**

This water well was    constructed    reconstructed    pursuant to the stated water well contractor's license and was completed on _____. I certify that this record is true to the best of my knowledge and belief. This water well record was completed on _____ under the business name of _____, Kansas Water Well Contractor's License No. _____ under the authority of the designated person as defined in K.A.R. 28-30-2(j) and signed and certified by the electronic signature of the designated person at its submittal: _____.
---

Send one copy to WATER WELL OWNER and retain one for your records. Fee of \$5.00 for each constructed well.

Form	WWC5.2 - Water Well Record
Doc ID	1802867
Well Owner	Clark County HWY DEPT
Contractor	Coranco Great Plains, Inc.

#### Lithology

From	To	Lithology Intervals
0	1	topsoil
1	3	silt,brown,loose
3	8	clay,silty,brown,dense
8	14	silt,light,brown,stiff
14	18	clay,silty,brown,dense
18	28	silt,light,brown,stiff
28	36	clay,silty,grayish,brown,dense
36	50	clay,silty,reddish,gray,stiff

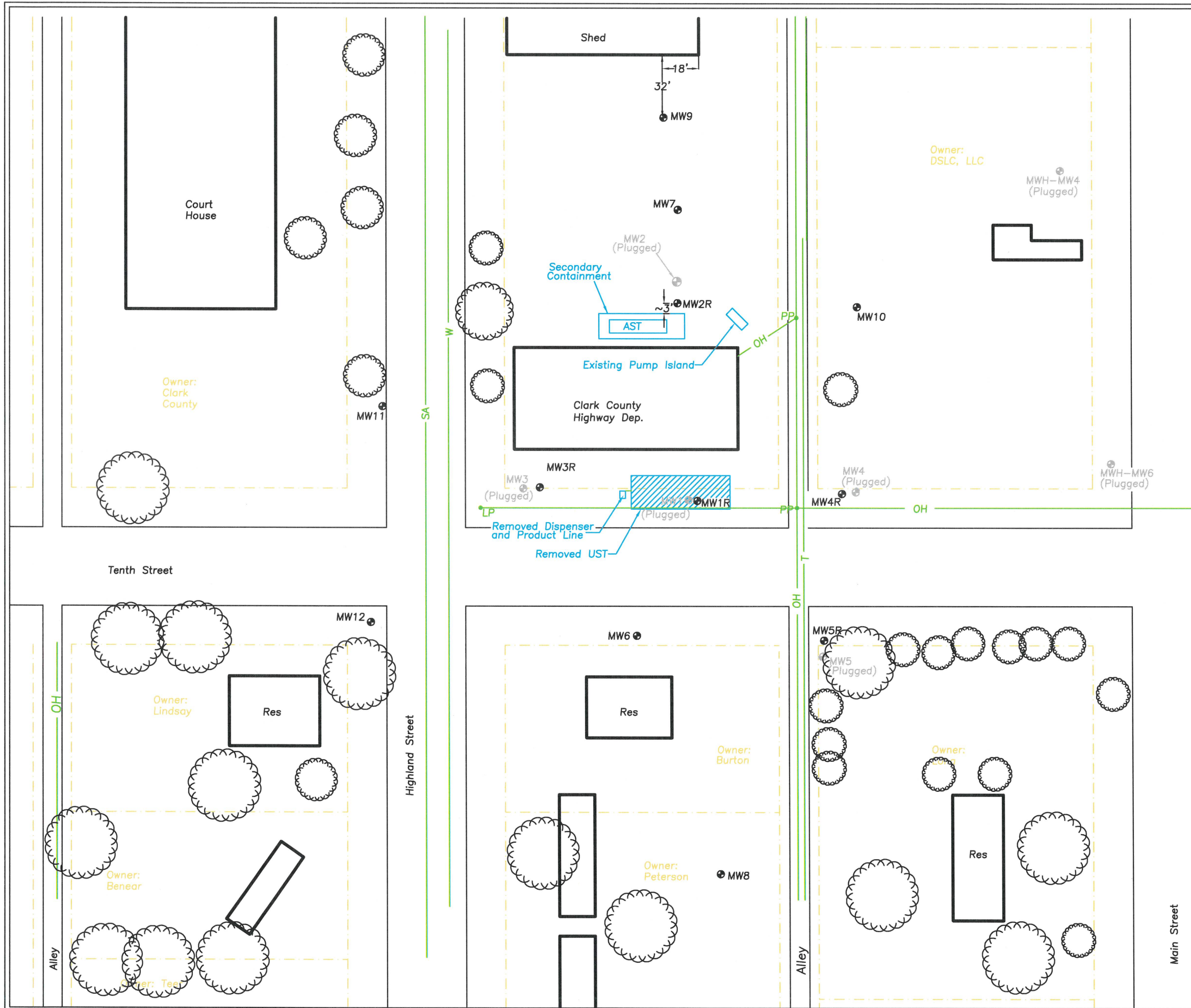

North Arrow

N

Legend

- MW1 - Monitoring Well Location
- MW2 - Plugged Monitoring Well Location
- MWH-MW6 - Monitoring well installed for MWH Incorporated.
- ST - Storm Sewer (~2' Deep)
- OH - Overhead Power Line
- SA - Sanitary Sewer Line (~4' deep)
- BT - Buried Telephone Line (~2' deep)
- W - Water Line (~3' deep)
- G - Gas Line (~3' deep)
- BE - Buried Electric Line (~2' deep)
- PP - Power Pole
- LP - Light Pole
- BP - Brace Pole
- Ped - Communications Pedestal
- WM - Water Meter
- EM - Electrical Meter
- GM - Gas Meter
- SB - Steel Bollard
- TS - Traffic Signal Manhole
- SS - Sanitary Sewer
- FH - Fire Hydrant
- Tree

Scale In Feet

0 50 100

Note- Product line locations are unknown unless marked.

Site Base Map
Clark County Highway Department
Ashland, KS
KDHE Project Code: U1-013-12418
Drilling Report
CGP Project #01242
Prepared By: TM Date: 11-12-2024
Reviewed By: MK Date: 11-13-2024
Figure 1
CGP, Inc. PO Box 23, Wahoo, NE 68066