



Sec. \_\_\_\_\_ Twp. \_\_\_\_\_ S. R. \_\_\_\_\_ ☐ East ☐ West      County: \_\_\_\_\_

Final Radioactivity Log, Final Logs run to obtain Geophysical Data and Final Electric Logs must be emailed to [kcc-well-logs@kcc.ks.gov](mailto:kcc-well-logs@kcc.ks.gov). Digital electronic log files must be submitted in LAS version 2.0 or newer AND an image file (TIFF or PDF).

Drill Stem Tests Taken <i>(Attach Additional Sheets)</i>	<input type="checkbox"/> Yes	<input type="checkbox"/> No	<input type="checkbox"/> Log	Formation (Top), Depth and Datum	<input type="checkbox"/> Sample
Samples Sent to Geological Survey	<input type="checkbox"/> Yes	<input type="checkbox"/> No	Name	Top	Datum
Cores Taken	<input type="checkbox"/> Yes	<input type="checkbox"/> No			
Electric Log Run	<input type="checkbox"/> Yes	<input type="checkbox"/> No			
Geologist Report / Mud Logs	<input type="checkbox"/> Yes	<input type="checkbox"/> No			
List All E. Logs Run:					

<div style="text-align: center;"> <b>CASING RECORD</b>      <input type="checkbox"/> New    <input type="checkbox"/> Used            Report all strings set-conductor, surface, intermediate, production, etc.         </div>							
Purpose of String	Size Hole Drilled	Size Casing Set (In O.D.)	Weight Lbs. / Ft.	Setting Depth	Type of Cement	# Sacks Used	Type and Percent Additives

ADDITIONAL CEMENTING / SQUEEZE RECORD				
Purpose:	Depth Top Bottom	Type of Cement	# Sacks Used	Type and Percent Additives
<input type="checkbox"/> Perforate				
<input type="checkbox"/> Protect Casing				
<input type="checkbox"/> Plug Back TD				
<input type="checkbox"/> Plug Off Zone				

1. Did you perform a hydraulic fracturing treatment on this well? ☐ Yes ☐ No (If No, skip questions 2 and 3)
2. Does the volume of the total base fluid of the hydraulic fracturing treatment exceed 350,000 gallons? ☐ Yes ☐ No (If No, skip question 3)
3. Was the hydraulic fracturing treatment information submitted to the chemical disclosure registry? ☐ Yes ☐ No (If No, fill out Page Three of the ACO-1)

Date of first Production/Injection or Resumed Production/Injection:		Producing Method: <input type="checkbox"/> Flowing <input type="checkbox"/> Pumping <input type="checkbox"/> Gas Lift <input type="checkbox"/> Other (Explain) _____			
Estimated Production Per 24 Hours	Oil      Bbls.	Gas      Mcf	Water	Bbls.	Gas-Oil Ratio      Gravity

<p>DISPOSITION OF GAS:</p> <p><input type="checkbox"/> Vented    <input type="checkbox"/> Sold    <input type="checkbox"/> Used on Lease</p> <p><i>(If vented, Submit ACO-18.)</i></p>	<p>METHOD OF COMPLETION:</p> <p><input type="checkbox"/> Open Hole    <input type="checkbox"/> Perf.    <input type="checkbox"/> Dually Comp.    <input type="checkbox"/> Commingled</p> <p><i>(Submit ACO-5)</i>                      <i>(Submit ACO-5)</i>                      <i>(Submit ACO-4)</i></p>	<p>PRODUCTION INTERVAL:</p> <p>Top                      Bottom</p>	

Shots Per Foot	Perforation Top	Perforation Bottom	Bridge Plug Type	Bridge Plug Set At	Acid, Fracture, Shot, Cementing Squeeze Record (Amount and Kind of Material Used)

TUBING RECORD:	Size:	Set At:	Packer At:	
----------------	-------	---------	------------	--

Form	ACO1 - Well Completion
Operator	ONEOK NGL Pipeline, LLC
Well Name	N-18 REPLACEMENT ZELLER 1
Doc ID	1805322

#### Casing

Purpose Of String	Size Hole Drilled	Size Casing Set	Weight	Setting Depth	Type Of Cement	Number of Sacks Used	Type and Percent Additives
Surface	16.75	10.75	8	40	Portland Cement	20	0

THANK YOU FOR SHOPPING AT  
JANTZ LUMBER  
(620) 241-4044

11/06/24 8:40AM AJK 551 SALE

PC 35 BG \$23.741BG Q  
PORTLAND CEMENT 94# BAG \$830.94  
1/PALLET  
TYPE 1 STANDARD

SUB-TOTAL:\$ 830.94 TAX: \$ 74.78  
TOTAL: \$ 905.72  
BC AMT: \$ 905.72

BK CARD#: XXXXXXXXXXXXX0644  
MID:\*\*\*\*\*7960TID:  
AUTH: 075468 AMT: \$ 905.72  
Host reference #:684248 Bat#0000

TID: 00340071

Chip Read  
CARD TYPE:VISA EXPR: XXXX

AID : A0000000031010

TVR : 8080008000

IAD : 06011203608000

TSI : 6800

ARC : 00

MODE : Issuer

CVM :

Name : VISA CREDIT

ATC :0033

AC : 9973DB8C3AE77EF0

TxnID/ValCode: 089518

Bank card USD\$ 905.72



==>> JRNL#G84248  
CUST NO:\*5

<<==

JOB NO: (10197)  
GPS: 38.369071  
-97.832329



1700 E Seward Rd.  
Guthrie, Ok. 73044  
PH:(405)293-9777 F:(405)293-9779

COMPANY:  
COMPANY REP.:  
INSTALLATION DATE:  
RECTIFIER LOCATION:  
LEGAL DESCRIPTION

ONEOK  
JOHN COOPER  
11.13.2024  
N-18  
STATE: OK  
COUNTY: MCPHERSON  
QTR:

DEPTH FT.	DRILLERS LOG	ANODE NO.	ELECTRIC LOG		
			T -S	R -	SEC -
0	TOP SOIL				
	TOP SOIL				
10	TOP SOIL				
	TOP SOIL				
20	CLAY/BEDROCK				
	CLAY/BEDROCK				
30	SHALE/SAND				
	SHALE/SAND				
40	CLAY				
	CLAY				
50	CLAY				2.50
	CLAY				
60	CLAY				2.30
	CLAY				
70	CLAY				2.10
	CLAY				
80	CLAY				2.00
	CLAY				
90	CLAY				2.10
	CLAY				
100	CLAY/SHALE				2.20
	CLAY/SHALE				
110	CLAY/SHALE				2.20
	CLAY/SHALE				
120	CLAY/SHALE				2.30
	CLAY/SHALE				
130	CLAY/SHALE				2.30
	CLAY/SHALE				
140	CLAY				2.30
	CLAY				
150	CLAY	1			2.40
	CLAY				
160	CLAY	2			2.60
	CLAY				
170	CLAY	3			2.70
	CLAY				
180	CLAY	4			2.50
	CLAY				
190	CLAY	5			2.10
	CLAY				
200	CLAY	6			2.00
	CLAY				

INSTALLED BY:  
CASING TYPE:  
DIAMETER:  
CASING DEPTH:  
NO. OF ANODES:  
ANODE TYPE:

C ROSE  
SDR 21  
10"  
40'  
10  
MMO  
#8

DIA. HOLE: 10"  
DEPTH: 250  
COKE TYPE: SC-3  
LBS INST'D: 5000  
HOLE PLUG: BENTONITE  
LOG VOLT: 13.7  
SOURCE: BATTERY

DEPTH FT.	DRILLERS LOG	ANODE NO.	ELECTRIC LOG		
			NATIVE	W/O COKE	W/COKE
210	CLAY	7		2.4	
	CLAY				
220	CLAY/SAND	8		2.2	
	CLAY/SAND				
230	CLAY/SAND	9		2.5	
	CLAY/SAND				
240	CLAY	10		2.4	
	CLAY				
250	CLAY			3.1	
260					
270					
280					
290					
300					
310					
320					
330					
340					
350					

DRILLER'S COMMENTS:



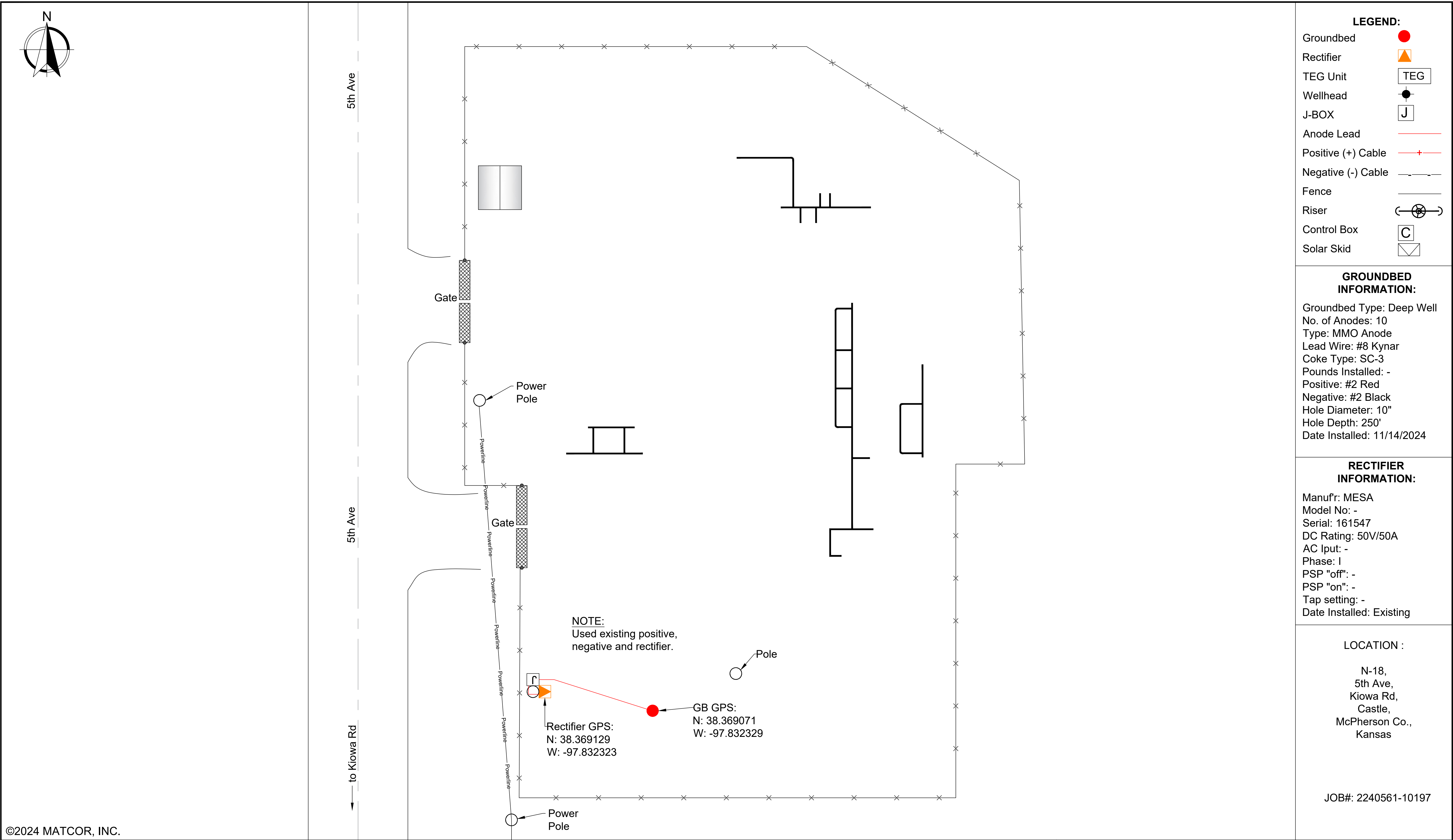

**NOTES:**

1. ALL GROUND BEDS MUST HAVE GPS
2. NOT DRAWN TO SCALE - SOME CABLE LENGTHS HAVE BEEN ADJUSTED TO FIT THIS PAGE.

REVISIONS						
0	AS BUILT	11/15/24	MRP	CR	JO	
NO.	DESCRIPTION	DATE	BY	CHK	APPR	



<p align="center"><b>CATHODIC PROTECTION SYSTEM FOR ONEOK, N-18, 5TH AVE, KIOWA RD, CASTLE, MCPHERSON CO., KANSAS</b></p>			
DRAWN BY:	MRP	<p align="center">1700 E. Seward Road Guthrie, Oklahoma 73044</p> <p align="right">PHONE: (405)293-9777</p>	
APPROVED BY:	JO		
CREATION DATE: 11/15/24		<p>DWG NO. <b>P-10197-PL-CP80</b></p>	
SCALE:	NTS		