

**KANSAS CORPORATION COMMISSION
OIL & GAS CONSERVATION DIVISION**

Form ACO-4
Form must be typed
March 2009

APPLICATION FOR COMMINGLING OF PRODUCTION (K.A.R. 82-3-123) OR FLUIDS (K.A.R. 82-3-123a) *Commingling ID # _____*

OPERATOR: License # _____ API No. 15 - _____
 Name: _____ Spot Description: _____
 Address 1: _____ - - - - - Sec. _____ Twp. _____ S. R. _____ ☐ East ☐ West
 Address 2: _____ Feet from ☐ North / ☐ South Line of Section
 City: _____ State: _____ Zip: _____ + _____ Feet from ☐ East / ☐ West Line of Section
 Contact Person: _____ County: _____
 Phone: (_____) _____ Lease Name: _____ Well #: _____

☐ 1. Name and upper and lower limit of each production interval to be commingled:

Formation: _____	(Perfs): _____
Formation: _____	(Perfs): _____
Formation: _____	(Perfs): _____
Formation: _____	(Perfs): _____
Formation: _____	(Perfs): _____

☐ 2. Estimated amount of fluid production to be commingled from each interval:

Formation: _____	BOPD: _____	MCFPD: _____	BWPD: _____
Formation: _____	BOPD: _____	MCFPD: _____	BWPD: _____
Formation: _____	BOPD: _____	MCFPD: _____	BWPD: _____
Formation: _____	BOPD: _____	MCFPD: _____	BWPD: _____
Formation: _____	BOPD: _____	MCFPD: _____	BWPD: _____

☐ 3. Plat map showing the location of the subject well, all other wells on the subject lease, and all wells on offsetting leases within a 1/2 mile radius of the subject well, and for each well the names and addresses of the lessee of record or operator.

☐ 4. Signed certificate showing service of the application and affidavit of publication as required in K.A.R. 82-3-135a.

For Commingling of PRODUCTION ONLY, include the following:

- ☐ 5. Wireline log of subject well. Previously Filed with ACO-1: ☐ Yes ☐ No
- ☐ 6. Complete Form ACO-1 (*Well Completion form*) for the subject well.

For Commingling of FLUIDS ONLY, include the following:

- ☐ 7. Well construction diagram of subject well.
- ☐ 8. Any available water chemistry data demonstrating the compatibility of the fluids to be commingled.

AFFIDAVIT: I am the affiant and hereby certify that to the best of my current information, knowledge and personal belief, this request for commingling is true and proper and I have no information or knowledge, which is inconsistent with the information supplied in this application.

Submitted Electronically

KCC Office Use Only

☐ Denied ☐ Approved

15-Day Periods Ends: _____

Approved By: _____ Date: _____

Protests may be filed by any party having a valid interest in the application. Protests must be in writing and comply with K.A.R. 82-3-135b and must be filed within 15 days of publication of the notice of application.

DODGE CITY DAILY GLOBE
AFFIDAVIT OF PUBLICATION

See Proof on Next Page

The State of Kansas
S.S.
County of Ford

I, Lori Sibley, being of lawful age, make oath and say that:
I am Newspaper Operations Manager for Cherry Road Media in the
state of Kansas.

Dodge City Daily Globe is a publication that is a "legal newspaper"
as that phrase is defined for the City of Dodge City, for the County
of Ford, in the State of Kansas. This affidavit is page 1 of 2 with the
full text of the sworn-to notice set forth on the pages that follow, and
the attachment hereto contains the correct copy of what was
published in said legal newspaper in consecutive issues on the
following dates.

PUBLICATION DATES:

Oct. 3, 2024

Notice ID: YhgBRoqr3RKlIXZe7nas
Publisher ID: 2727630
Notice Name: #2 Sanko well

PUBLICATION FEE: \$42.90

Lori Sibley

Lori Sibley, Newspaper Operations Manager, Cherry Road Media

VERIFICATION

STATE OF KANSAS
COUNTY OF FORD

Signed or attested before me on this

7 day of October, A.D. 2024

Rhonda Zinn

Rhonda, Zinn / Notary Public

My Commission Expires: June 6, 2026





The Beaufort Gazette
The Belleville News-Democrat
Bellingham Herald
Centre Daily Times
Sun Herald
Idaho Statesman
Bradenton Herald
The Charlotte Observer
The State
Ledger-Enquirer

Durham | The Herald-Sun
Fort Worth Star-Telegram
The Fresno Bee
The Island Packet
The Kansas City Star
Lexington Herald-Leader
The Telegraph - Macon
Merced Sun-Star
Miami Herald
El Nuevo Herald

The Modesto Bee
The Sun News - Myrtle Beach
Raleigh News & Observer
Rock Hill | The Herald
The Sacramento Bee
San Luis Obispo Tribune
Tacoma | The News Tribune
Tri-City Herald
The Wichita Eagle
The Olympian

AFFIDAVIT OF PUBLICATION

Account #	Order Number	Identification	Order PO	Amount	Cols	Depth
24452	601924	Print Legal Ad-IPL01991250 - IPL0199125	#2 Sanko	\$246.92	1	37 L

Attention: Karen Hopper

RITCHIE EXPLORATION INC

P O BOX 783188

WICHITA, KS 672783188

khopper@ritchie-exp.com

LEGAL NOTICE

You, and each of you, are hereby notified that Ritchie Exploration, Inc. has filed an application to commence the commingling of production from the Pawnee and Mississippian Spergen sources of supply for the #2 Sanko well located approx. NE SE NW of Section 17-28S-23 W, Ford County, Kansas.

Any persons who object to or protest this application shall be required to file their objections or protests with the Conservation Division of the State Corporation Commission of the State of Kansas within fifteen (15) days from the date of the publication. These protests shall be filed pursuant to Commission regulations and must state specific reasons why the grant of the application may cause waste, violate correlative rights or pollute the natural resources of the state of Kansas.

If no protests are received, this application may be granted through a summary proceeding. If valid protests are received, this matter will be set for hearing.

All persons interested or concerned shall take notice of the foregoing and shall govern themselves accordingly. RITCHIE EXPLORATION, INC.

P.O. Box 783188
Wichita, KS 67278-3188
(316) 691-9500
IPL0199125
Oct 13 2024

In The STATE OF KANSAS
In and for the County of Sedgwick

1 insertion(s) published on:

10/13/24

STATE OF KANSAS)

SS

County of Sedgwick)

Mary Castro, of lawful age, being first duly sworn, depose and saith: That he is Record Clerk of The Wichita Eagle, a daily newspaper published in the City of Wichita, County of Sedgwick, State of Kansas, and having a general paid circulation on a daily basis in said County, which said newspaper has been continuously and uninterruptedly published in said County for more than one year prior to the first publication of the notice hereinafter mentioned, and which said newspaper has been entered as second class mail matter at the United States Post Office in Wichita, Kansas, and which said newspaper is not a trade, religious or fraternal publication and that a notice of a true copy is hereto attached was published in the regular and entire Morning issue of said The Wichita Eagle from 10/13/2024 to 10/13/2024.

Mary Castro

I certify (or declare) under penalty of perjury that the foregoing is true and correct.

DATED: 10/21/2024

Margaret K. Wilson

Notary Public in and for the state of Texas, residing in Dallas County

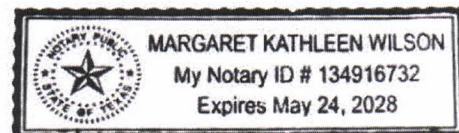

Extra charge for lost or duplicate affidavits.
Legal document please do not destroy!

AFFIDAVIT

STATE OF KANSAS)
 - SS.
County of Sedgwick)

Peter Fiorini, of lawful age, being first duly sworn, deposeth and saith: That he is Vice President/Production/Geologist of Ritchie Exploration, County of Sedgwick, State of Kansas, and that notice was given to all lessee of record or operator within ½ mile radius of the Sanko #2 well located in the County of Ford (see attached plat map). This notice included a letter and a copy of the Commingle Application (ACO-4). All notices were mailed on September 24, 2024.

made as aforesaid on the 24th of

September A.D. 2024

And affiant further says that he has personal knowledge of the statements above set forth and that they are true.



Subscribed and sworn to before me this

24th day of September 2024

Notary Public Sedgwick County, Kansas

R 23 W

T
28
S

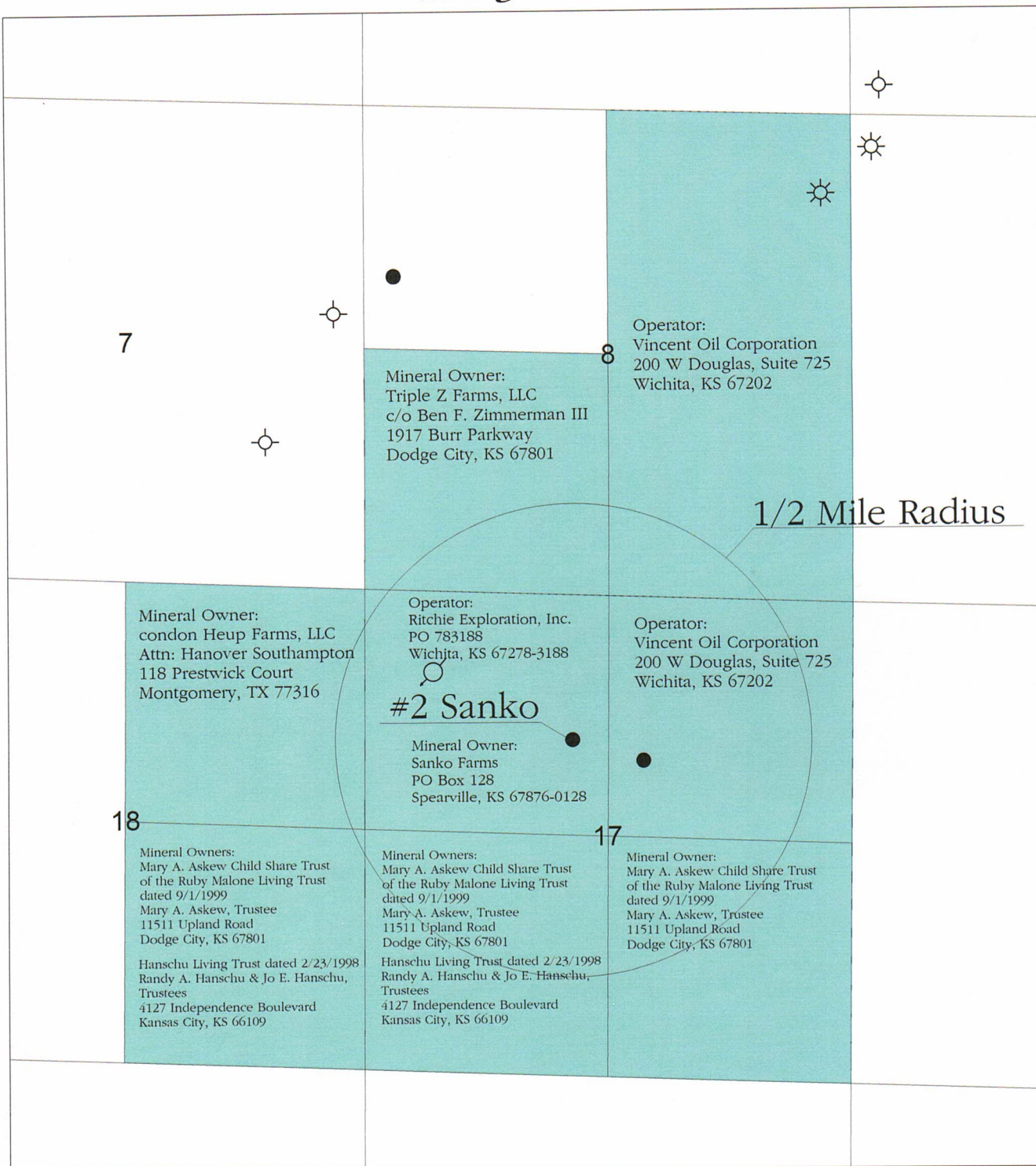

Legend

- Oil Well
- ☀ Gas Well
- ⊙ Dry and Abandoned Well
- ⊙ Injector

 RITCHIE EXPLORATION, INC. Wichita, Kansas			Application for Commingling of Production or Fluids		
Applicant Well: #2 Sanko API: 15-057-20830 All Wells Within 1/2 Mile Radius Name and Address of Lessee of Record, Operator or Unleased Mineral Rights Owner					
Ford County, Kansas					
Created By: Justin Clegg		Scale: 1 : 20,000		Date: September 23, 2024	

APPLICATION FOR COMMINGLING OF PRODUCTION OR FLUIDS

**Operator, Lessee or Unleased Mineral Owner
within a ½ mile radius of Ritchie Exploration, Inc.'s**

**#2 Sanko
1,620' FNL & 2,310' FWL
Section 17-28S-23W
Ford Co., KS**

Township 28 South, Range 23 West

Sec. 8:	SW/4	Triple Z Farms, LLC c/o Ben F. Zimmerman III 1917 Burr Parkway Dodge City, KS 67801	Mineral Owner
	E/2	Vincent Oil Corporation 200 W Douglas, Suite 725 Wichita, KS 67202	Operator: Zimmerman #2-8
Sec. 17:	NW/4	Ritchie Exploration, Inc. P.O. Box 783188 Wichita, KS 67278-3188	Operator: #1 Sanko, #2 Sanko
		Sanko Farms PO Box 128 Spearville, KS 67876-0128	Mineral/Surface Owner
	SW/4	Mary A. Askew Child Share Trust of the Ruby Malone Living Trust dated 9/1/1999 Mary A. Askew, Trustee 11511 Upland Road Dodge City, KS 67801	Mineral Owner
		Hansch Living Trust dated 2/23/1998 Randy A. Hanschu & Jo E. Hanschu, Trustees 4127 Independence Boulevard Kansas City, KS 66109	Mineral Owner
	SE/4	Mary A. Askew Child Share Trust of the Ruby Malone Living Trust dated 9/1/1999 Mary A. Askew, Trustee 11511 Upland Road Dodge City, KS 67801	Mineral Owner

Township 28 South, Range 23 West (continued)

Sec. 17:	NE/4	Vincent Oil Corporation 200 W Douglas, Suite 725 Wichita, KS 67202	Operator: Rinehart #1-17
----------	------	--	--------------------------

Sec. 18:	NE/4	Condon Heup Farms, LLC Attn: Hanover Southampton 118 Prestwick Court Montgomery, TX 77316	Mineral Owner
----------	------	--	---------------

SE/4	Mary A. Askew Child Share Trust of the Ruby Malone Living Trust dated 9/1/1999 Mary A. Askew, Trustee 11511 Upland Road Dodge City, KS 67801	Mineral Owner
------	--	---------------

Hanschu Living Trust dated 2/23/1998 Randy A. Hanschu & Jo E. Hanschu, Trustees 4127 Independence Boulevard Kansas City, KS 66109	Mineral Owner
--	---------------

Conservation Division
266 N. Main St., Ste. 220
Wichita, KS 67202-1513



Phone: 316-337-6200
Fax: 316-337-6211
<http://kcc.ks.gov/>

Andrew J. French, Chairperson
Dwight D. Keen, Commissioner
Annie Kuether, Commissioner

Laura Kelly, Governor

December 10, 2024

Peter Fiorini
Ritchie Exploration, Inc.
P.O. Box 783188
Wichita, KS 67278-3188

RE: Approved Commingling CO122401
Sanko 2
API No. 15-057-20830-00-01

Dear Mr. Fiorini:

Your Application for Commingling (ACO-4) for the above described well has been reviewed and approved by the Kansas Corporation Commission (KCC) per K.A.R. 82-3-123. Notice was examined and found to be proper per K.A.R. 82-3-135a. No protest had been filed within the 15-day protest period.

Based upon the depth of the Mississippi Spergen formation perforations, total oil production shall not exceed 200 BOPD and total gas production shall not exceed 50% of the absolute open flow (AOF).

Sincerely,

Production Department Supervisor