

WATER WELL RECORD (WWC-5)

KOLAR DOC ID _____ WELL ID _____

Original Record Correction Change in Well Use

LOCATION OF WATER WELL

Latitude		Longitude		Section		Township		Range		E W	Fraction	¼	¼	¼
Datum		Elevation		County										

WATER WELL OWNER

Name	
Business	
Address	
Well location at owner's address	

WELL WATER USE

--

COMPLETION

Depth of completed well: _____ ft.
Depth(s) groundwater encountered:
(1) _____ ft.; (2) _____ ft.;
(3) _____ ft.; (4) dry well
Static water level in well: _____ ft.
measured below land surface
on (mm/dd/yy): _____
measured above land surface
on (mm/dd/yy): _____
Estimated yield: _____ gpm
Water level was: _____ ft. after _____ hours
pumping _____ gpm
Pump installed? Yes No
Water well disinfected? Yes No
Date disinfected (mm/dd/yy): _____
Aquifer, if known:

NEAREST SOURCE OF POTENTIAL CONTAMINATION

Source: _____
Distance from well: _____ Direction from well: _____
Source description: _____
Source: _____
Distance from well: _____ Direction from well: _____
Source description: _____
No potential source of contamination within 100 feet.

CONSTRUCTION

Borehole interval:	Borehole diameter:
from _____ to _____ ft.	_____ in.
from _____ to _____ ft.	_____ in.
Casing height above land surface: _____ in.	
If casing height is less than 12 in. has a variance been approved?*	Yes No
*variance not required for monitoring or environmental remediation wells	
Casing type: _____	
Blank casing interval: _____ ft. to _____ ft.	
Blank casing diameter: _____ in.	
Casing joints: _____	
Weight: _____ lbs/ft.	
Wall thickness or gauge no.: _____	
Blank casing interval: _____ ft. to _____ ft.	
Blank casing diameter: _____ in.	
Casing joints: _____	
Weight: _____ lbs/ft.	
Wall thickness or gauge no.: _____	
Grout interval: _____ ft. to _____ ft.	
Grout material: _____	
Grout interval: _____ ft. to _____ ft.	
Grout material: _____	
Screen / perforation material: _____	
Screen / perforation openings: _____	
Screen / perforation intervals:	
From _____ ft. to _____ ft.	
Slot size _____ unit _____	
From _____ ft. to _____ ft.	
Slot size _____ unit _____	
Gravel pack intervals:	
Gravel pack not used: Gravel size _____ in	
From _____ ft. to _____ ft.	
Gravel pack not used: Gravel size _____ in	
From _____ ft. to _____ ft.	

PERMIT & ID NUMBERS (AS REQUIRED)

DWR Application No.: _____
KDHE / EPA Project Code: _____
Site Name: _____
KDHE UIC Class V Form Completed: Yes No
County Permit: Yes No Permit ID: _____
Lease Name & Well #: _____
of boreholes: _____ # of dewatering wells: _____

LITHOLOGIC LOG

FROM	TO	LITHOLOGY INTERVALS

COMMENTS

--

CONTRACTOR'S OR LANDOWNERS CERTIFICATION

This water well was constructed reconstructed pursuant to the stated water well contractor's license and was completed on _____. I certify that this record is true to the best of my knowledge and belief. This water well record was completed on _____ under the business name of _____, Kansas Water Well Contractor's License No. _____ under the authority of the designated person as defined in K.A.R. 28-30-2(j) and signed and certified by the electronic signature of the designated person at its submittal: _____.

Send one copy to WATER WELL OWNER and retain one for your records. Fee of \$5.00 for each constructed well.

Form	WWC5.2 - Water Well Record
Doc ID	1806351
Well Owner	Gordon K. Flower
Contractor	Larsen And Associates

Lithology

From	To	Lithology Intervals
0	.5	other, concrete
.5	13	clay, silty
13	16	silt, clayey
16	18	clay, sandy
18	19	sand & gravel, medium
19	22	clay, sandy, silty, gravelly
22	24	clay, sandy, silty

NOTE: Figures exhibited within this report are only to be used within the context of this report. Placement of property lines, wells, structures, and roads is based on the available information from county appraiser maps, surveys, site visits, and/or previous vendor reports and should be considered approximate.

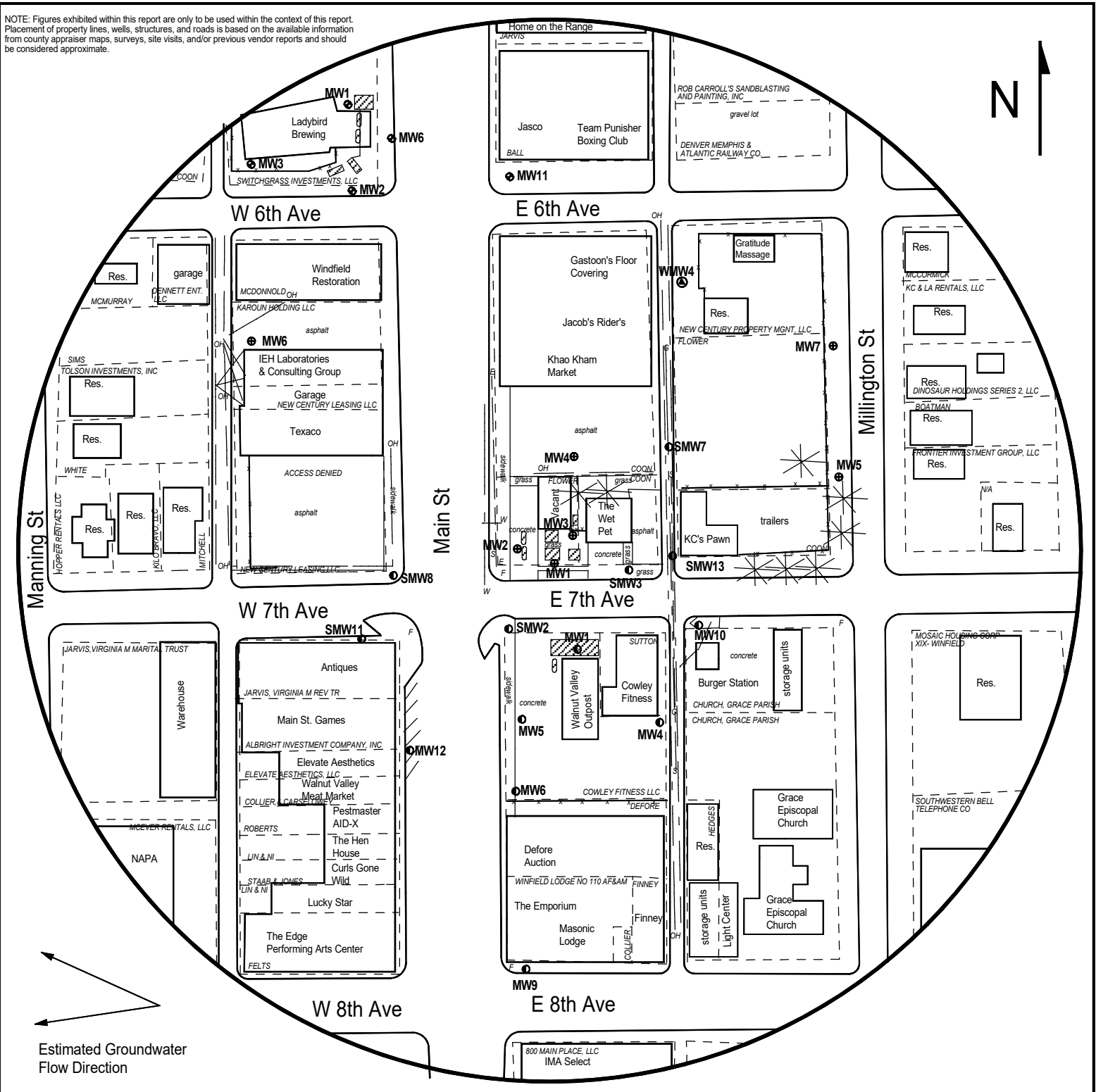

FIGURE 2 - 500 FT RADIUS AREA BASE MAP



1311 E 25th St., Suite B,
Lawrence, KS 66046
Office: (785) 841-8707

PROJECT:

Flower Petroleum
620 Main Street,
Winfield
KDHE ID: U2-018-15548
Date: 8/30/24

0 100 feet

LEGEND:

- Approximate Location of Former UST Basin, Product Lines, and Pump Islands
- * Tree/Shrub
- F Fire Hydrant
- OH — Overhead Lines (25-40 ft high)
- S — Sewer (2 - 6 ft BGS)
- G — Gas (2 - 6 ft BGS)
- E — Electric (2 - 6 ft BGS)
- Monitoring Well (Shryock Oil; U2-018-12636)
- ⊕ Monitoring Well (Lynes Conoco; U2-018-11515)
- ⊙ Monitoring Well (Winfield Cleaners; C2-018-72051)
- ⊕ Proposed Monitoring Well
- X Proposed Soil Boring

NOTE: Utility depths, heights and locations are approximate.
NOTE: SB5 and SB6 will be drilled to collect hydrological samples.

DENNIS L HANDKE

1820 NW 59th Terrace
TOPEKA, KANSAS 66618
785-286-4047 Home

Jess Chapman
Larsen & Associates
1311 E. 25th Street, Suite B
Lawrence, Kansas, 66046

December 6, 2024

RE: Monitor Well Elevation Survey
602 Main St., Winfield, Kansas

Proj. 24-00QQ
Flower Petroleum
U2-018-15548

Bench Mark: Chisled X on top SW bolt of abandond concrete sign base at Northwest corner of property.
Elev: 1131.39 North 4627.50 West 2867.63 (from SE Cor. Sec. 28-32-4E)

MW-1	rim	1129.09	North	4555.60	NE1/4,SE1/4,NE1/4,NW1/4
	top pipe	1128.58	West	2827.94	Lat= 37.24250 Long = 96.99693
MW-2	rim	1129.27	North	4579.32	NE1/4,SE1/4,NE1/4,NW1/4
	top pipe	1128.83	West	2859.04	Lat= 37.24257 Long = 96.99704
MW-3	rim	1129.59	North	4580.04	NE1/4,SE1/4,NE1/4,NW1/4
	top pipe	1129.07	West	2805.77	Lat= 37.24257 Long = 96.99685
MW-4	rim	1128.49	North	4652.39	SE1/4,NE1/4,NE1/4,NW1/4
	top pipe	1128.14	West	2808.69	Lat= 37.24277 Long = 96.99687
MW-5	rim	1126.27	North	4625.69	SW1/4,NW1/4,NW1/4,NE1/4
	top pipe	1125.89	West	2552.76	Lat= 37.24269 Long = 96.99599
MW-6	rim	1128.77	North	4763.94	SW1/4,NE1/4,NE1/4,NW1/4
	top pipe	1128.42	West	3109.11	Lat= 37.24305 Long = 96.99791
MW-7	rim	1125.20	North	4739.61	SW1/4,NW1/4,NW1/4,NE1/4
	top pipe	1124.65	West	2552.83	Lat= 37.24300 Long = 96.99599

Lat & Long derived from Winfield 7.5' quad map. WGS 84.

Elevation established from NGS BM C 242 NAVD 88.

If you have any questions, please feel free to call me. Thank you for the opportunity to be

