

WATER WELL RECORD (WWC-5)

KOLAR DOC ID _____ WELL ID _____

Original Record Correction Change in Well Use

LOCATION OF WATER WELL

Latitude		Longitude		Section		Township		Range		E W	Fraction	¼	¼	¼
Datum		Elevation		County										

WATER WELL OWNER

Name	
Business	
Address	
Well location at owner's address	

WELL WATER USE

--

COMPLETION

Depth of completed well: _____ ft.
Depth(s) groundwater encountered:
(1) _____ ft.; (2) _____ ft.;
(3) _____ ft.; (4) dry well
Static water level in well: _____ ft.
measured below land surface
on (mm/dd/yy): _____
measured above land surface
on (mm/dd/yy): _____
Estimated yield: _____ gpm
Water level was: _____ ft. after _____ hours
pumping _____ gpm
Pump installed? Yes No
Water well disinfected? Yes No
Date disinfected (mm/dd/yy): _____
Aquifer, if known:

NEAREST SOURCE OF POTENTIAL CONTAMINATION

Source: _____
Distance from well: _____ Direction from well: _____
Source description: _____
Source: _____
Distance from well: _____ Direction from well: _____
Source description: _____
No potential source of contamination within 100 feet.

CONSTRUCTION

Borehole interval:	Borehole diameter:
from _____ to _____ ft.	_____ in.
from _____ to _____ ft.	_____ in.
Casing height above land surface: _____ in.	
If casing height is less than 12 in. has a variance been approved?*	Yes No
*variance not required for monitoring or environmental remediation wells	
Casing type: _____	
Blank casing interval: _____ ft. to _____ ft.	
Blank casing diameter: _____ in.	
Casing joints: _____	
Weight: _____ lbs/ft.	
Wall thickness or gauge no.: _____	
Blank casing interval: _____ ft. to _____ ft.	
Blank casing diameter: _____ in.	
Casing joints: _____	
Weight: _____ lbs/ft.	
Wall thickness or gauge no.: _____	
Grout interval: _____ ft. to _____ ft.	
Grout material: _____	
Grout interval: _____ ft. to _____ ft.	
Grout material: _____	
Screen / perforation material: _____	
Screen / perforation openings: _____	
Screen / perforation intervals:	
From _____ ft. to _____ ft.	
Slot size _____ unit _____	
From _____ ft. to _____ ft.	
Slot size _____ unit _____	
Gravel pack intervals:	
Gravel pack not used: Gravel size _____ in	
From _____ ft. to _____ ft.	
Gravel pack not used: Gravel size _____ in	
From _____ ft. to _____ ft.	

PERMIT & ID NUMBERS (AS REQUIRED)

DWR Application No.: _____
KDHE / EPA Project Code: _____
Site Name: _____
KDHE UIC Class V Form Completed: Yes No
County Permit: Yes No Permit ID: _____
Lease Name & Well #: _____
of boreholes: _____ # of dewatering wells: _____

LITHOLOGIC LOG

FROM	TO	LITHOLOGY INTERVALS

COMMENTS

--

CONTRACTOR'S OR LANDOWNERS CERTIFICATION

This water well was constructed reconstructed pursuant to the stated water well contractor's license and was completed on _____. I certify that this record is true to the best of my knowledge and belief. This water well record was completed on _____ under the business name of _____, Kansas Water Well Contractor's License No. _____ under the authority of the designated person as defined in K.A.R. 28-30-2(j) and signed and certified by the electronic signature of the designated person at its submittal: _____.

Send one copy to WATER WELL OWNER and retain one for your records. Fee of \$5.00 for each constructed well.

NOTE: Figures exhibited within this report are only to be used within the context of this report. Placement of property lines, wells, structures, and roads is based on the available information from county appraiser maps, surveys, site visits, and/or previous vendor reports and should be considered approximate.

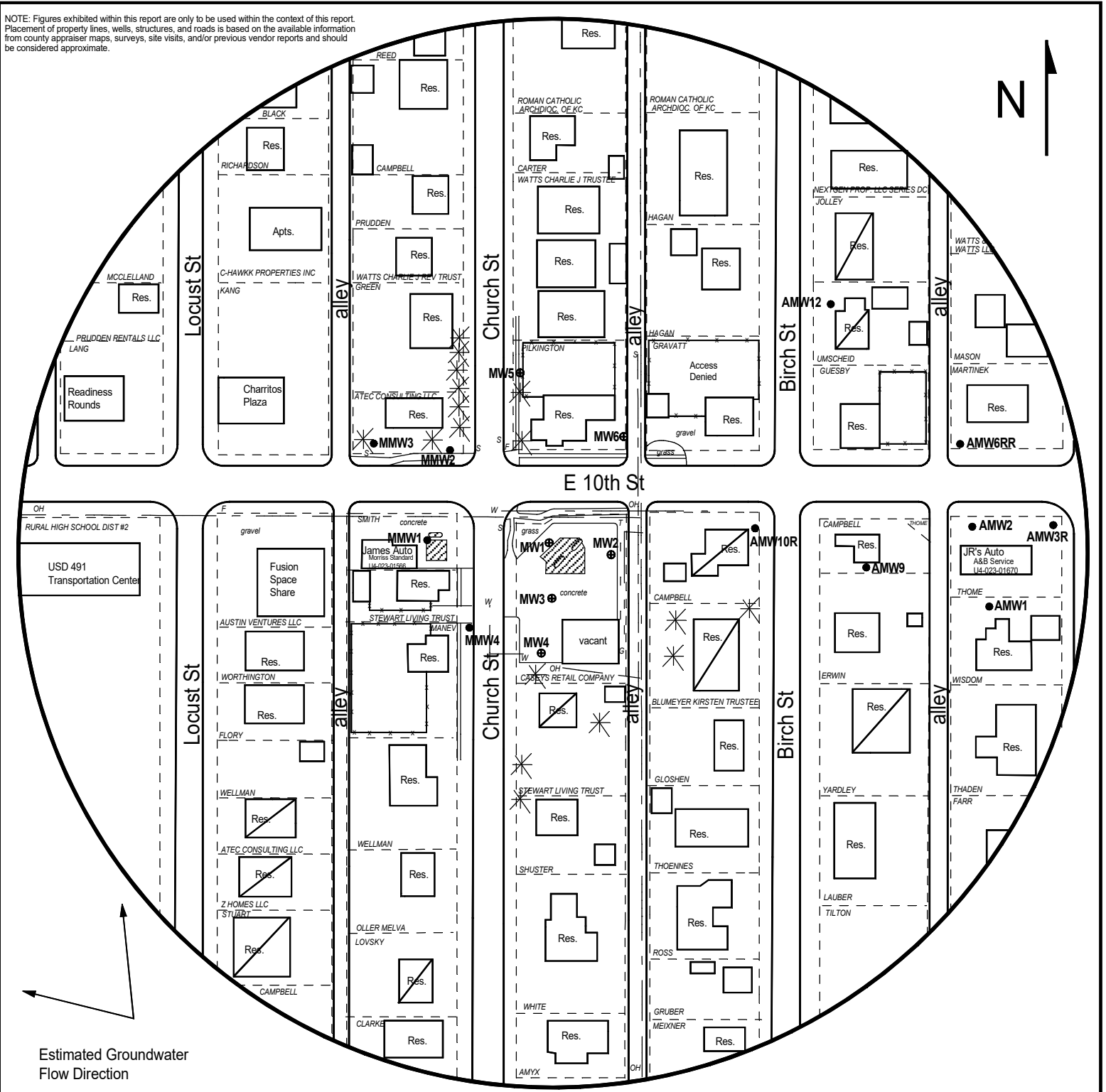

FIGURE 2 - 500 FT RADIUS AREA BASE MAP



1311 E 25th St., Suite B, Lawrence, KS 66046
Office: (785) 841-8707

PROJECT:

Casey's General Store #1199
303 E. 10th Street,
Eudora, KS
KDHE ID: U4-023-15513
Date: 10/18/24

0 100 feet

LEGEND:

- Approximate Location of Former UST Basin and Pump Island
 - Building with Basement
 - Existing Monitoring Well
 - Proposed Monitoring Well
 - Proposed Soil Boring
 - Fire Hydrant
 - Tree/Shrub
 - Overhead Lines (25-40 ft high)
 - Sewer (2 - 6 ft BGS)
 - Gas (2 - 6 ft BGS)
 - Telephone (2 - 6 ft BGS)
 - Water (2 - 6 ft BGS)
- NOTE: Utility depths, heights and locations are approximate.
NOTE: SB5 & SB6 will be drilled to collect hydrological samples.

DENNIS L HANDKE

1820 NW 59th Terrace
TOPEKA, KANSAS 66618
785-286-4047 Home

Jessica Chapman
Larsen & Associates
1311 E. 25th Street, Suite B
Lawrence, Kansas, 66046

December 10, 2024

RE: Monitor Well Elevation Survey
303 E. 10th., Eudora

Proj. 24-00WW
Casey's General Store #1199
U4-023-15513

Bench Mark: Chisled sq. on SW corner of concrete sign base near the NW corner of property.
Elev: 871.09 North 5114.97 West 655.67 (from SE Cor. Sec. 5-13-21E)

MW#1	rim	871.29	North	5100.84	NW1/4,NE1/4,NE1/4,NE1/4
	top pipe	870.92	West	632.09	Lat= 38.94177 Long = 95.09575
MW#2	rim	872.84	North	5086.92	NW1/4,NE1/4,NE1/4,NE1/4
	top pipe	872.59	West	577.00	Lat= 38.94173 Long = 95.09556
MW#3	rim	872.25	North	5055.57	NW1/4,NE1/4,NE1/4,NE1/4
	top pipe	871.97	West	626.24	Lat= 38.94165 Long = 95.09573
MW#4	rim	871.07	North	5010.41	NW1/4,NE1/4,NE1/4,NE1/4
	top pipe	870.79	West	649.75	Lat= 38.94152 Long = 95.09581
MW#5	rim	869.42	North	5248.63	NW1/4,NE1/4,NE1/4,NE1/4
	top pipe	869.10	West	662.55	Lat= 38.94218 Long = 95.09586
MW#6	rim	873.81	North	5210.27	NW1/4,NE1/4,NE1/4,NE1/4
	top pipe	873.41	West	561.96	Lat= 38.94207 Long = 95.09551

Lat & Long derived from Eudora 7.5' quad map. WGS84.

Elevation established from NGS BM W 368. NAVD 83.

If you have any questions, please feel free to call me. Thank you for the opportunity to be of service to you!

