

WATER WELL RECORD (WWC-5)

KOLAR DOC ID _____ WELL ID _____

Original Record Correction Change in Well Use

LOCATION OF WATER WELL

| | | | | | | | | | | | | | | |
|----------|--|-----------|--|---------|--|----------|--|-------|--|--------|----------|---|---|---|
| Latitude | | Longitude | | Section | | Township | | Range | | E W | Fraction | ¼ | ¼ | ¼ |
| Datum | | Elevation | | County | | | | | | | | | | |

WATER WELL OWNER

| | |
|-------------------------------------|--|
| Name | |
| Business | |
| Address | |
| Well location at owner's address | |

WELL WATER USE

| |
|--|
| |
|--|

COMPLETION

| |
|--|
| Depth of completed well: _____ ft. |
| Depth(s) groundwater encountered: |
| (1) _____ ft.; (2) _____ ft.; |
| (3) _____ ft.; (4) dry well |
| Static water level in well: _____ ft. |
| measured below land surface |
| on (mm/dd/yy): _____ |
| measured above land surface |
| on (mm/dd/yy): _____ |
| Estimated yield: _____ gpm |
| Water level was: _____ ft. after _____ hours |
| pumping _____ gpm |
| Pump installed? Yes No |
| Water well disinfected? Yes No |
| Date disinfected (mm/dd/yy): _____ |
| Aquifer, if known: |

NEAREST SOURCE OF POTENTIAL CONTAMINATION

| |
|---|
| Source: _____ |
| Distance from well: _____ Direction from well: _____ |
| Source description: _____ |
| Source: _____ |
| Distance from well: _____ Direction from well: _____ |
| Source description: _____ |
| No potential source of contamination within 100 feet. |

CONSTRUCTION

| | |
|--|--------------------|
| Borehole interval: | Borehole diameter: |
| from _____ to _____ ft. | _____ in. |
| from _____ to _____ ft. | _____ in. |
| Casing height above land surface: _____ in. | |
| If casing height is less than 12 in. has a variance been approved?* | Yes No |
| *variance not required for monitoring or environmental remediation wells | |
| Casing type: _____ | |
| Blank casing interval: _____ ft. to _____ ft. | |
| Blank casing diameter: _____ in. | |
| Casing joints: _____ | |
| Weight: _____ lbs/ft. | |
| Wall thickness or gauge no.: _____ | |
| Blank casing interval: _____ ft. to _____ ft. | |
| Blank casing diameter: _____ in. | |
| Casing joints: _____ | |
| Weight: _____ lbs/ft. | |
| Wall thickness or gauge no.: _____ | |
| Grout interval: _____ ft. to _____ ft. | |
| Grout material: _____ | |
| Grout interval: _____ ft. to _____ ft. | |
| Grout material: _____ | |
| Screen / perforation material: _____ | |
| Screen / perforation openings: _____ | |
| Screen / perforation intervals: | |
| From _____ ft. to _____ ft. | |
| Slot size _____ unit _____ | |
| From _____ ft. to _____ ft. | |
| Slot size _____ unit _____ | |
| Gravel pack intervals: | |
| Gravel pack not used: Gravel size _____ in | |
| From _____ ft. to _____ ft. | |
| Gravel pack not used: Gravel size _____ in | |
| From _____ ft. to _____ ft. | |

PERMIT & ID NUMBERS (AS REQUIRED)

| |
|---|
| DWR Application No.: _____ |
| KDHE / EPA Project Code: _____ |
| Site Name: _____ |
| KDHE UIC Class V Form Completed: Yes No |
| County Permit: Yes No Permit ID: _____ |
| Lease Name & Well #: _____ |
| # of boreholes: _____ # of dewatering wells: _____ |

LITHOLOGIC LOG

| FROM | TO | LITHOLOGY INTERVALS |
|------|----|---------------------|
| | | |
| | | |
| | | |
| | | |
| | | |
| | | |
| | | |

COMMENTS

| |
|--|
| |
|--|

CONTRACTOR'S OR LANDOWNERS CERTIFICATION

| |
|---|
| This water well was constructed reconstructed pursuant to the stated water well contractor's license and was completed on _____. I certify that this record is true to the best of my knowledge and belief. This water well record was completed on _____ under the business name of _____, Kansas Water Well Contractor's License No. _____ under the authority of the designated person as defined in K.A.R. 28-30-2(j) and signed and certified by the electronic signature of the designated person at its submittal: _____. |
|---|

Send one copy to WATER WELL OWNER and retain one for your records. Fee of \$5.00 for each constructed well.

NOTE: Figures exhibited within this report are only to be used within the context of this report. Placement of property lines, wells, structures, and roads is based on the available information from county appraiser maps, surveys, site visits, and/or previous vendor reports and should be considered approximate.

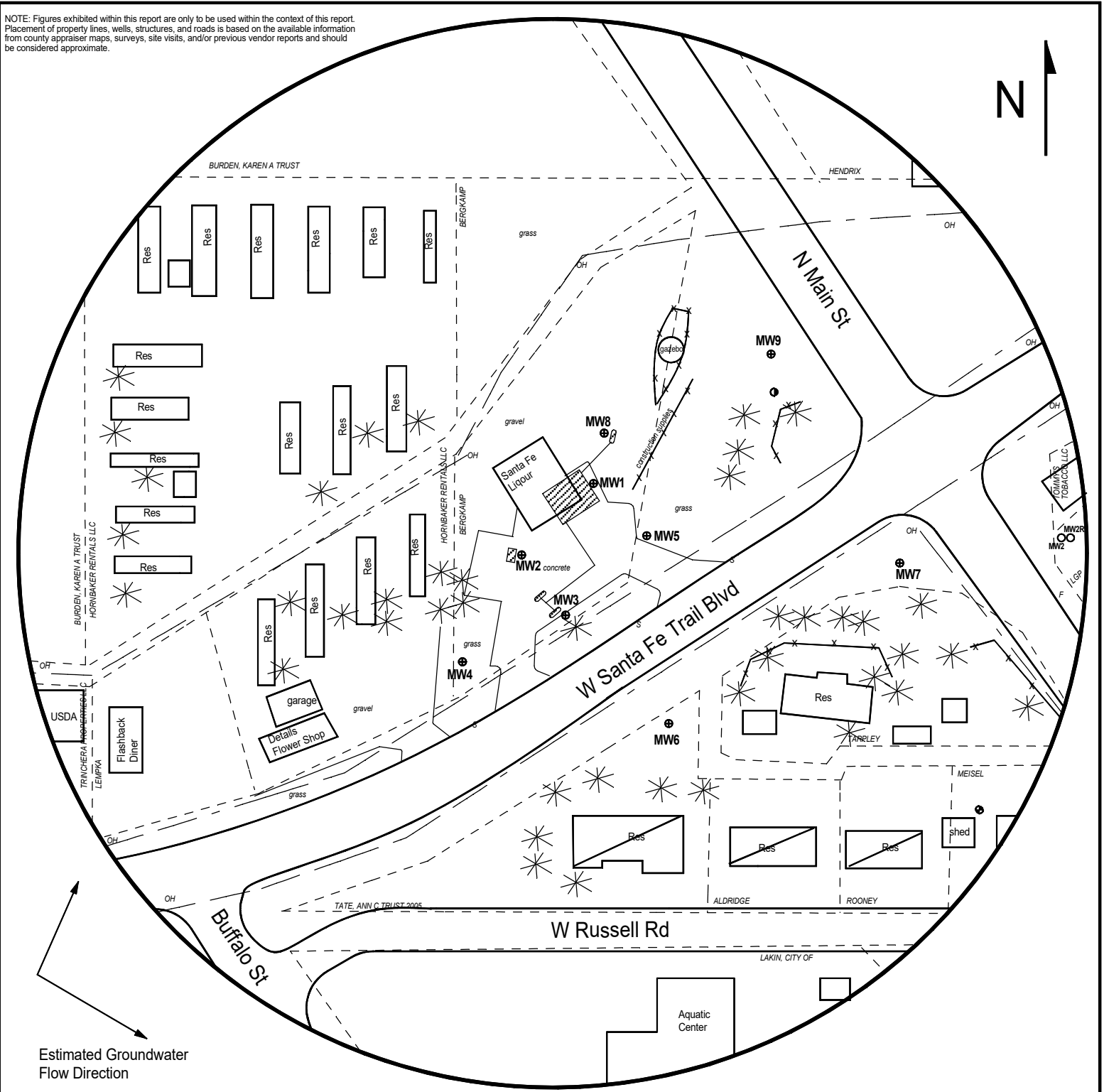

FIGURE 2 - 500 FT RADIUS AREA BASE MAP



1311 E 25th St., Suite B, Lawrence, KS 66046
Office: (785) 841-8707

PROJECT:

Burkamp - Abandoned Facility
108 W Santa Fe Trail Blvd.,
Lakin, KS
KDHE ID: U1-047-15527
Date: 11/11/24



LEGEND:

- Approximate Location of Former UST Basin, Product Lines, and Pump Island
- Building with Basement
- Plugged Monitoring Well
- Proposed Monitoring Well
- Domestic Well
- City Water Well Pump
- Proposed Soil Boring

OH ———— Overhead Lines (25-40 ft high)
S ———— Sewer (2 - 6 ft BGS)

NOTE: Utility depths and locations are approximate.
NOTE: SB9 & SB10 will be drilled to collect hydrologic samples.

DENNIS L HANDKE

1820 NW 59th Terrace
TOPEKA, KANSAS 66618
785-286-4047 Home

Jess Chapman
Larsen & Associates
1311 E. 25th Street, Suite B
Lawrence, Kansas, 66046

March 1, 2025

RE: Monitor Well Elevation Survey
108 W. Santa Fe Trail Blvd., Lakin, Kansas

Proj. 25-00C
Burkamp – Abandoned Facility
U1-047-15527

Bench Mark: Square cut on NE corner of concrete sign base on West side of East entrance to property.
Elev: 3011.35 North 334.06 West 3037.72 (from SE Cor. Sec. 22-24-36W)

| | | | | | |
|------|----------|---------|-------|---------|--------------------------------------|
| MW-1 | rim | 3011.48 | North | 428.12 | NW1/4,SE1/4,SE1/4,SW1/4 |
| | top pipe | 3011.07 | West | 3047.92 | Lat = 37.94528 Long = 101.25988 |
| MW-2 | rim | 3011.97 | North | 355.29 | NW1/4,SE1/4,SE1/4,SW1/4 |
| | top pipe | 3011.68 | West | 3132.58 | Lat = 37.94508 Long = 101.26017 |
| MW-3 | rim | 3011.37 | North | 292.40 | SW1/4,SE1/4,SE1/4,SW1/4 |
| | top pipe | 3011.04 | West | 3094.04 | Lat = 37.94490 Long = 101.26004 |
| MW-4 | rim | 3011.86 | North | 272.13 | SW1/4,SE1/4,SE1/4,SW1/4 |
| | top pipe | 3011.51 | West | 3159.14 | Lat = 37.94485 Long = 101.26026 |
| MW-5 | rim | 3011.00 | North | 368.85 | NW1/4,SE1/4,SE1/4,SW1/4 |
| | top pipe | 3010.64 | West | 3017.12 | Lat = 37.94512 Long = 101.25977 |
| MW-6 | rim | 3008.38 | North | 194.41 | SW1/4,SE1/4,SE1/4,SW1/4 |
| | top pipe | 3008.05 | West | 3001.66 | Lat = 37.94464 Long = 101.25971 |
| MW-7 | rim | 3008.17 | North | 326.80 | SE1/4,SE1/4,SE1/4,SW1/4 |
| | top pipe | 3007.77 | West | 2772.48 | Lat = 37.94501 Long = 101.25892 |
| MW-8 | rim | 3010.86 | North | 482.48 | NW1/4,SE1/4,SE1/4,SW1/4 |
| | top pipe | 3010.32 | West | 3030.95 | Lat = 37.94543 Long = 101.25983 |
| MW-9 | rim | 3008.48 | North | 520.01 | NE1/4,SE1/4,SE1/4,SW1/4 |
| | top pipe | 3008.13 | West | 2929.27 | Lat = 37.94553 Long = 101.25948 |

Lat & Long derived from Lakin 7.5' Quad Map NAD 29

Elevation derived from project NGS BM G 363. NAVD 1988.

If you have any questions, please feel free to call me. Thank you for the opportunity to be of service to you.

Dennis L Handke
LS-786

