

WATER WELL RECORD (WWC-5)

KOLAR DOC ID _____ WELL ID _____

LOCATION OF WATER WELL

Latitude		Longitude		Section		Township		Range		E W	Fraction	¼	¼	¼
Datum		Elevation		County										

WATER WELL OWNER

Name	
Business	
Address	
Well location at owner's address	

WELL WATER USE

--

WELL INFORMATION

Depth of well: _____ ft.
Dry well
Static water level in well: _____ ft. measured below land surface on (mm/dd/yy): _____ measured above land surface on (mm/dd/yy): _____

PERMIT & ID NUMBERS (AS REQUIRED)

DWR Application No.: _____
KDHE / EPA Project Code: _____
Site Name: _____
KDHE UIC Class V Form Completed: Yes No
County Permit: Yes No Permit ID: _____
Lease Name & Well #: _____
of boreholes: _____ # of dewatering wells: _____

CASING

Type of blank casing used: _____
Casing type details: _____
Blank casing diameter: _____ inches
Was casing removed? Yes No
Top of casing is currently _____ feet _____ ground
Reason required if top of casing is now less than 5 feet below ground surface for a hand dug well or less than 3 feet below ground surface for all other types of wells.

GROUT & PLUGGING MATERIALS

Grout or Plugging interval (ft.)		Material	Description
From	To		

COMMENTS

--

CONTRACTOR'S OR LANDOWNERS CERTIFICATION

<p>This water well was plugged pursuant to the stated water well contractor's license and was completed on _____. I certify that this record is true to the best of my knowledge and belief. This water well record was completed on _____ under the business name of _____, Kansas Water Well Contractor's License No. _____ under the authority of the designated person as defined in K.A.R. 28-30-2(j) and signed and certified by the electronic signature of the designated person at its submittal _____.</p>
--

Send one copy to WATER WELL OWNER and retain one for your records.

NOTE: Figures exhibited within this report are only to be used within the context of this report. Placement of property lines, wells, structures, and roads is based on the available information from county appraiser maps, surveys, site visits, and/or previous vendor reports and should be considered approximate.

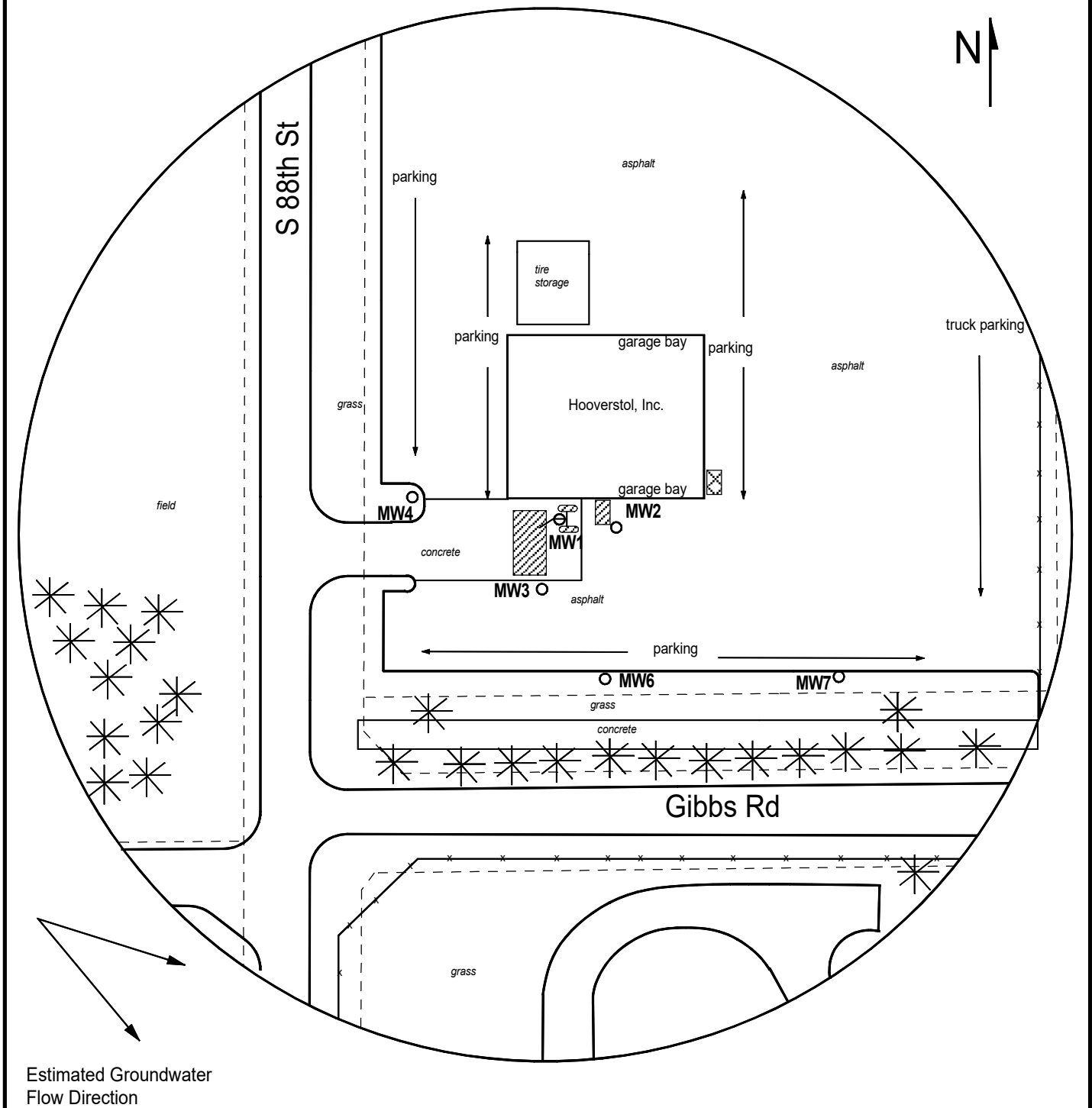

FIGURE 1 - 350 FT RADIUS AREA BASE MAP

LEGEND:

- Approximate Location of Former UST Basin, Product Lines, and Pump Island
- Approximate Location of Active Waste Oil AST
- Plugged Monitoring Well



PROJECT:
 Hoovestol Inc. -
 Kansas City Shop
 2205 S 88th St,
 Kansas City, KS
 KDHE ID: U4-105-15464
 Date: 5/8/25

0 100 ft

A scale bar showing a distance of 100 feet, with a zero mark at the beginning and a 100 ft mark at the end.

(785) 841-8707 office
 1311 E 25th St., Suite B, Lawrence, KS 66046