

WATER WELL RECORD (WWC-5)

KOLAR DOC ID _____ WELL ID _____

Original Record Correction Change in Well Use

LOCATION OF WATER WELL

Latitude		Longitude		Section		Township		Range		E W	Fraction	¼	¼	¼
Datum		Elevation		County										

WATER WELL OWNER

Name	
Business	
Address	
Well location at owner's address	

WELL WATER USE

--

COMPLETION

Depth of completed well: _____ ft.
Depth(s) groundwater encountered:
(1) _____ ft.; (2) _____ ft.;
(3) _____ ft.; (4) dry well
Static water level in well: _____ ft.
measured below land surface
on (mm/dd/yy): _____
measured above land surface
on (mm/dd/yy): _____
Estimated yield: _____ gpm
Water level was: _____ ft. after _____ hours
pumping _____ gpm
Pump installed? Yes No
Water well disinfected? Yes No
Date disinfected (mm/dd/yy): _____
Aquifer, if known:

NEAREST SOURCE OF POTENTIAL CONTAMINATION

Source: _____
Distance from well: _____ Direction from well: _____
Source description: _____
Source: _____
Distance from well: _____ Direction from well: _____
Source description: _____
No potential source of contamination within 100 feet.

CONSTRUCTION

Borehole interval:	Borehole diameter:
from _____ to _____ ft.	_____ in.
from _____ to _____ ft.	_____ in.
Casing height above land surface: _____ in.	
If casing height is less than 12 in. has a variance been approved?*	Yes No
*variance not required for monitoring or environmental remediation wells	
Casing type: _____	
Blank casing interval: _____ ft. to _____ ft.	
Blank casing diameter: _____ in.	
Casing joints: _____	
Weight: _____ lbs/ft.	
Wall thickness or gauge no.: _____	
Blank casing interval: _____ ft. to _____ ft.	
Blank casing diameter: _____ in.	
Casing joints: _____	
Weight: _____ lbs/ft.	
Wall thickness or gauge no.: _____	
Grout interval: _____ ft. to _____ ft.	
Grout material: _____	
Grout interval: _____ ft. to _____ ft.	
Grout material: _____	
Screen / perforation material: _____	
Screen / perforation openings: _____	
Screen / perforation intervals:	
From _____ ft. to _____ ft.	
Slot size _____ unit _____	
From _____ ft. to _____ ft.	
Slot size _____ unit _____	
Gravel pack intervals:	
Gravel pack not used: Gravel size _____ in	
From _____ ft. to _____ ft.	
Gravel pack not used: Gravel size _____ in	
From _____ ft. to _____ ft.	

PERMIT & ID NUMBERS (AS REQUIRED)

DWR Application No.: _____
KDHE / EPA Project Code: _____
Site Name: _____
KDHE UIC Class V Form Completed: Yes No
County Permit: Yes No Permit ID: _____
Lease Name & Well #: _____
of boreholes: _____ # of dewatering wells: _____

LITHOLOGIC LOG

FROM	TO	LITHOLOGY INTERVALS

COMMENTS

--

CONTRACTOR'S OR LANDOWNERS CERTIFICATION

This water well was constructed reconstructed pursuant to the stated water well contractor's license and was completed on _____. I certify that this record is true to the best of my knowledge and belief. This water well record was completed on _____ under the business name of _____, Kansas Water Well Contractor's License No. _____ under the authority of the designated person as defined in K.A.R. 28-30-2(j) and signed and certified by the electronic signature of the designated person at its submittal: _____.

Send one copy to WATER WELL OWNER and retain one for your records. Fee of \$5.00 for each constructed well.

DENNIS L HANDKE

1820 NW 59th Terrace
TOPEKA, KANSAS 66618
785-286-4047 Home

Jess Chapman
Larsen & Associates
1607 SW 41st Street
Lawrence, Kansas, 66609

April 24, 2025

RE: Monitor Well Elevation Survey
2300 10th St., Great Bend, Kansas

Proj. 25-00M
Ampride Convenience Store
U6-005-14701

Bnch Mark: Chisled X on South end concrete diesel pump island East of the building.

Elev: 1849.03 South 25.96 West 3858.98 (from SE Cor. Sec. 28-19-13W)

MW-9	rim	1848.50	South	44 65	NW1/4,NW1/4,NE1/4,NW1/4 (Sec 33-19-13W)
	top pipe	1848.19	West	3644.18	Lat= 38.36175 Long = 98.76861
MW-10	rim	1849.26	South	100 81	NE1/4,NE1/4,NW1/4,NW1/4 (Sec 33-19-13W)
	top pipe	1848.96	West	3973.15	Lat= 38.36161 Long = 98.76976
MW-11	rim	1848.49	South	136 41	NW1/4,NW1/4,NE1/4,NW1/4 (Sec 33-19-13W)
	top pipe	1848.07	West	3925.61	Lat= 38.36151 Long = 98.76959

Elevation derived from existing project.

Lat & Long derived from Great Bend 7.5' Quad Map. WGS84

If you have any questions, please feel free to call me. Thank you for the opportunity to be of service to you.

Dennis L Handke RLS

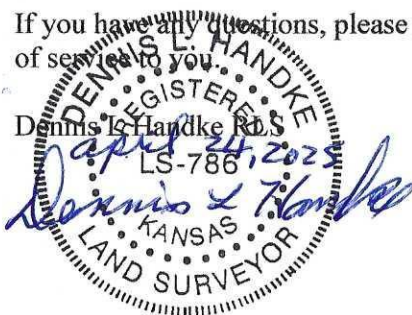

NOTE: Figures exhibited within this report are only to be used within the context of this report. Placement of property lines, wells, structures, and roads is based on the available information from county appraiser maps, surveys, site visits, and/or previous vendor reports and should be considered approximate.

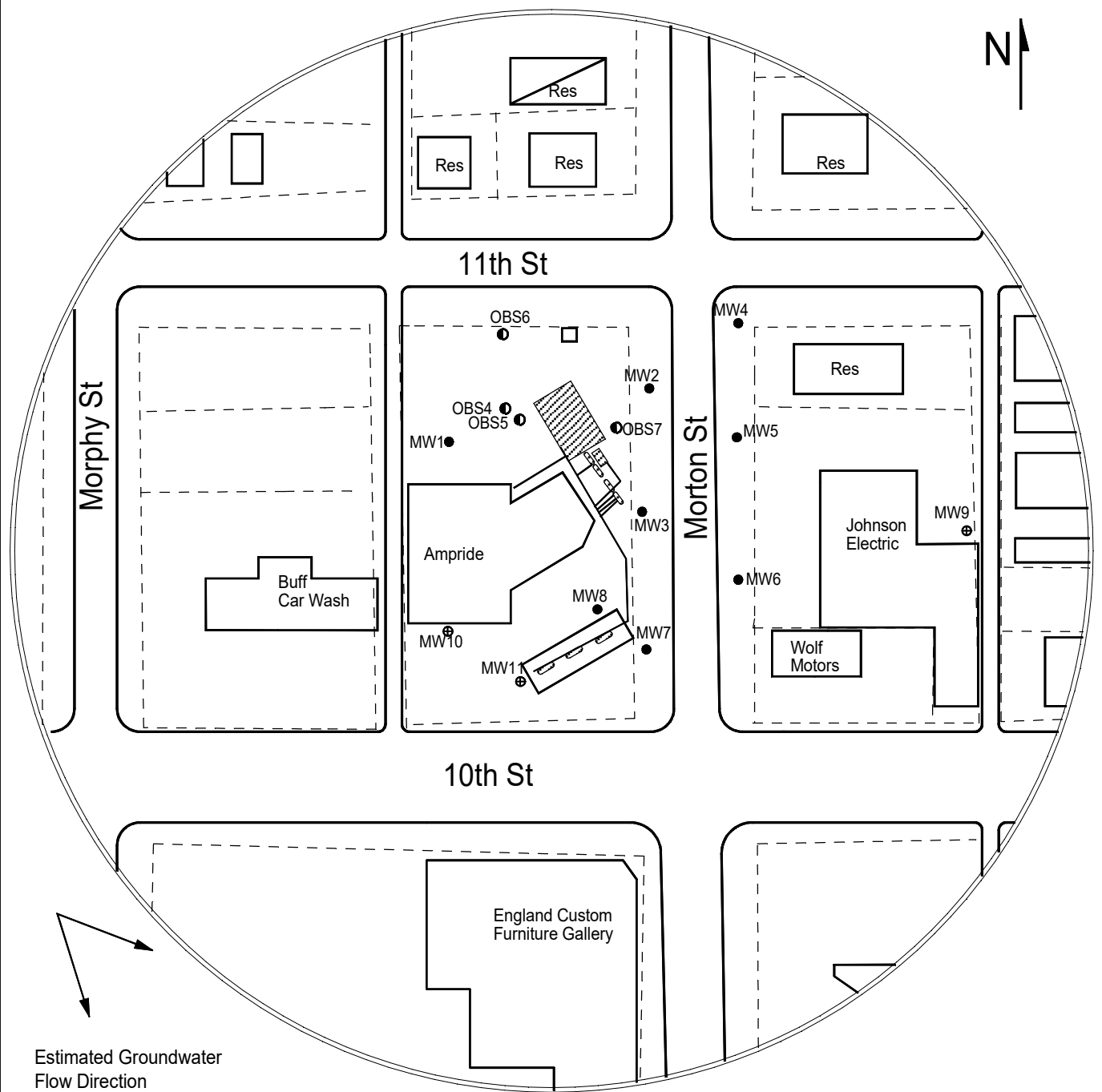

FIGURE 2.1 - 350 FT RADIUS AREA BASE MAP



1311 E 25th St., Suite B,
Lawrence, KS 66046
Office: (785) 841-8707

PROJECT:

Ampride Convenience Store
2300 10th St.,
Great Bend, KS
KDHE ID: U6-005-14701
Date: 4/2/25

0 100 ft

LEGEND:

- Approximate Location of Former UST Basin, Product Lines & Pump Islands
 - Building with Basement
 - - - Approximate Location of Property Line
 - New Monitoring Well (Drilled 4/1-2/25)
 - Monitoring Well
 - Observation Well
 - Soil Vapor Well
 - Air Sparge Well
 - Remedial System
 - Soil Boring (Drilled 4/1-2/25)
 - Fire Hydrant
 - Tree/Bush
 - Electric (1.5 - 3 ft bgs)
 - Sewer Lines (2 - 6 ft bgs)
 - Overhead Lines (25'-40' high)
 - Telephone (2 - 6 ft bgs)
 - Water Lines (1.5 - 3 ft bgs)
- NOTE: Utility depths, heights and locations are approximate.