

WATER WELL RECORD (WWC-5)

KOLAR DOC ID _____ WELL ID _____

Original Record Correction Change in Well Use

LOCATION OF WATER WELL

Latitude		Longitude		Section		Township		Range		E W	Fraction	¼	¼	¼
Datum		Elevation		County										

WATER WELL OWNER

Name	
Business	
Address	
Well location at owner's address	

WELL WATER USE

--

COMPLETION

Depth of completed well: _____ ft.
Depth(s) groundwater encountered:
(1) _____ ft.; (2) _____ ft.;
(3) _____ ft.; (4) dry well
Static water level in well: _____ ft.
measured below land surface
on (mm/dd/yy): _____
measured above land surface
on (mm/dd/yy): _____
Estimated yield: _____ gpm
Water level was: _____ ft. after _____ hours
pumping _____ gpm
Pump installed? Yes No
Water well disinfected? Yes No
Date disinfected (mm/dd/yy): _____
Aquifer, if known:

NEAREST SOURCE OF POTENTIAL CONTAMINATION

Source: _____
Distance from well: _____ Direction from well: _____
Source description: _____
Source: _____
Distance from well: _____ Direction from well: _____
Source description: _____
No potential source of contamination within 100 feet.

CONSTRUCTION

Borehole interval:	Borehole diameter:
from _____ to _____ ft.	_____ in.
from _____ to _____ ft.	_____ in.
Casing height above land surface: _____ in.	
If casing height is less than 12 in. has a variance been approved?*	Yes No
*variance not required for monitoring or environmental remediation wells	
Casing type: _____	
Blank casing interval: _____ ft. to _____ ft.	
Blank casing diameter: _____ in.	
Casing joints: _____	
Weight: _____ lbs/ft.	
Wall thickness or gauge no.: _____	
Blank casing interval: _____ ft. to _____ ft.	
Blank casing diameter: _____ in.	
Casing joints: _____	
Weight: _____ lbs/ft.	
Wall thickness or gauge no.: _____	
Grout interval: _____ ft. to _____ ft.	
Grout material: _____	
Grout interval: _____ ft. to _____ ft.	
Grout material: _____	
Screen / perforation material: _____	
Screen / perforation openings: _____	
Screen / perforation intervals:	
From _____ ft. to _____ ft.	
Slot size _____ unit _____	
From _____ ft. to _____ ft.	
Slot size _____ unit _____	
Gravel pack intervals:	
Gravel pack not used: Gravel size _____ in	
From _____ ft. to _____ ft.	
Gravel pack not used: Gravel size _____ in	
From _____ ft. to _____ ft.	

PERMIT & ID NUMBERS (AS REQUIRED)

DWR Application No.: _____
KDHE / EPA Project Code: _____
Site Name: _____
KDHE UIC Class V Form Completed: Yes No
County Permit: Yes No Permit ID: _____
Lease Name & Well #: _____
of boreholes: _____ # of dewatering wells: _____

LITHOLOGIC LOG

FROM	TO	LITHOLOGY INTERVALS

COMMENTS

--

CONTRACTOR'S OR LANDOWNERS CERTIFICATION

This water well was constructed reconstructed pursuant to the stated water well contractor's license and was completed on _____. I certify that this record is true to the best of my knowledge and belief. This water well record was completed on _____ under the business name of _____, Kansas Water Well Contractor's License No. _____ under the authority of the designated person as defined in K.A.R. 28-30-2(j) and signed and certified by the electronic signature of the designated person at its submittal: _____.

Send one copy to WATER WELL OWNER and retain one for your records. Fee of \$5.00 for each constructed well.

NOTE: Figures exhibited within this report are only to be used within the context of this report. Placement of property lines, wells, structures, and roads is based on the available information from county appraiser maps, surveys, site visits, and/or previous vendor reports and should be considered approximate.

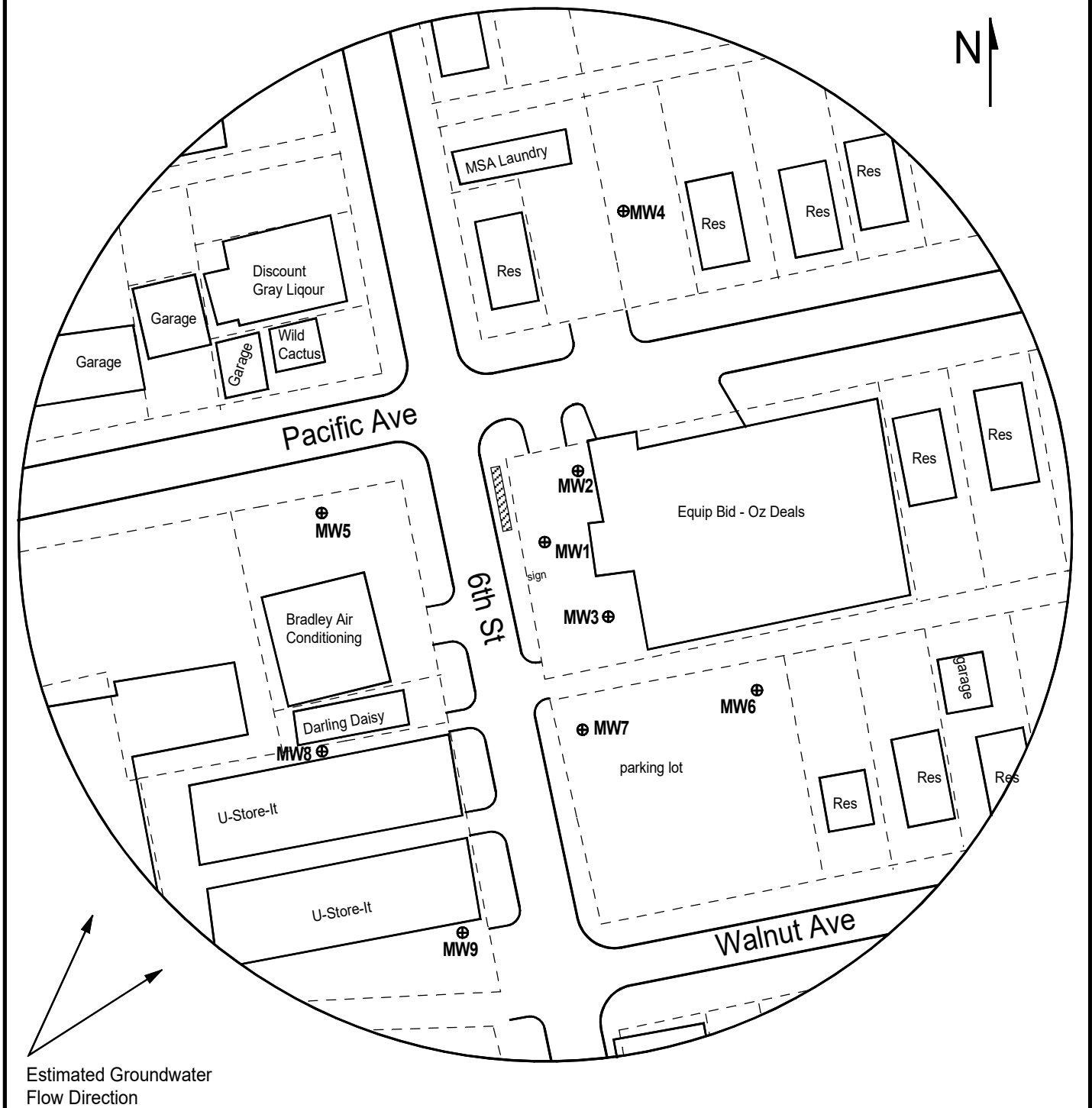

LEGEND:

- Approximate Location of Former UST Basin
- New Monitoring Well (Installed 3/10, 12-13/25)



PROJECT:

701 6th Street
701 6th Street
Osawatomie, KS
KDHE ID: U4-061-15646
Date: 3/13-14/25



1311 E 25th St., Suite B, Lawrence, KS 66046
Office: (785) 841-8707

DENNIS L HANDKE

1820 NW 59th Terrace
TOPEKA, KANSAS 66618
785-286-4047 Home

Jess Chapman
Larsen & Associates
1311 E. 25th Street, Suite B
Lawrence, Kansas, 66046

March 28, 2025

RE: Monitor Well Elevation Survey
701 6th Street, Osawatomie, Kansas

Proj. 25-00H
701 6th Street
U4-061-15646

Bench Mark: Chisled Sq. on East center of concrete sign base at West center of property.

Elev: 868.32 North 1946.06 West 3810.71 (from SE Cor. Sec. 11-18-22E)

MW-1	rim	867.11	North	1975.60	SW1/4,SW1/4,NE1/4,SW1/4
	top pipe	866.69	West	3812.62	Lat= 38.49659 Long = 94.95010
MW-2	rim	867.84	North	2016.22	SW1/4,NW1/4,NE1/4,SW1/4
	top pipe	867.48	West	3793.54	Lat= 38.49671 Long = 94.95003
MW-3	rim	867.34	North	1932.04	NW1/4,SW1/4,NE1/4,SW1/4
	top pipe	866.94	West	3775.93	Lat= 38.49647 Long = 94.94998
MW-4	rim	870.22	North	2177.13	SW1/4,SW1/4,NE1/4,SW1/4
	top pipe	869.91	West	3765.63	Lat= 38.49715 Long = 94.94993
MW-5	rim	867.12	North	1998.29	SW1/4,NW1/4,NE1/4,SW1/4
	top pipe	866.82	West	3962.27	Lat= 38.49666 Long = 94.95062
MW-6	rim	866.77	North	1881.09	NW1/4,SW1/4,NE1/4,SW1/4
	top pipe	866.36	West	3685.86	Lat= 38.49633 Long = 94.94966
MW-7	rim	864.77	North	1845.78	NW1/4,SW1/4,NE1/4,SW1/4
	top pipe	864.36	West	3781.69	Lat= 38.49624 Long = 94.95000
MW-8	rim	865.03	North	1837.27	NW1/4,SW1/4,NE1/4,SW1/4
	top pipe	864.58	West	3949.71	Lat= 38.49622 Long = 94.95059
MW-9	rim	864.30	North	1723.98	NW1/4,SW1/4,NE1/4,SW1/4
	top pipe	863.71	West	3858.48	Lat= 38.49591 Long = 94.95028

Lat & Long derived from Osawatomie 7.5' quad map. WGS 84.

Elevation established from NGS BM P 221. NAVD 88.

If you have any questions, please feel free to call me. Thank you for the opportunity to be of service to you.

